

P	LTR	DESCRIPTION	DATE	DWN	APVD
E3	OBSOLETE 1--2	ECR-16-003093	17AUG16	KF	HY

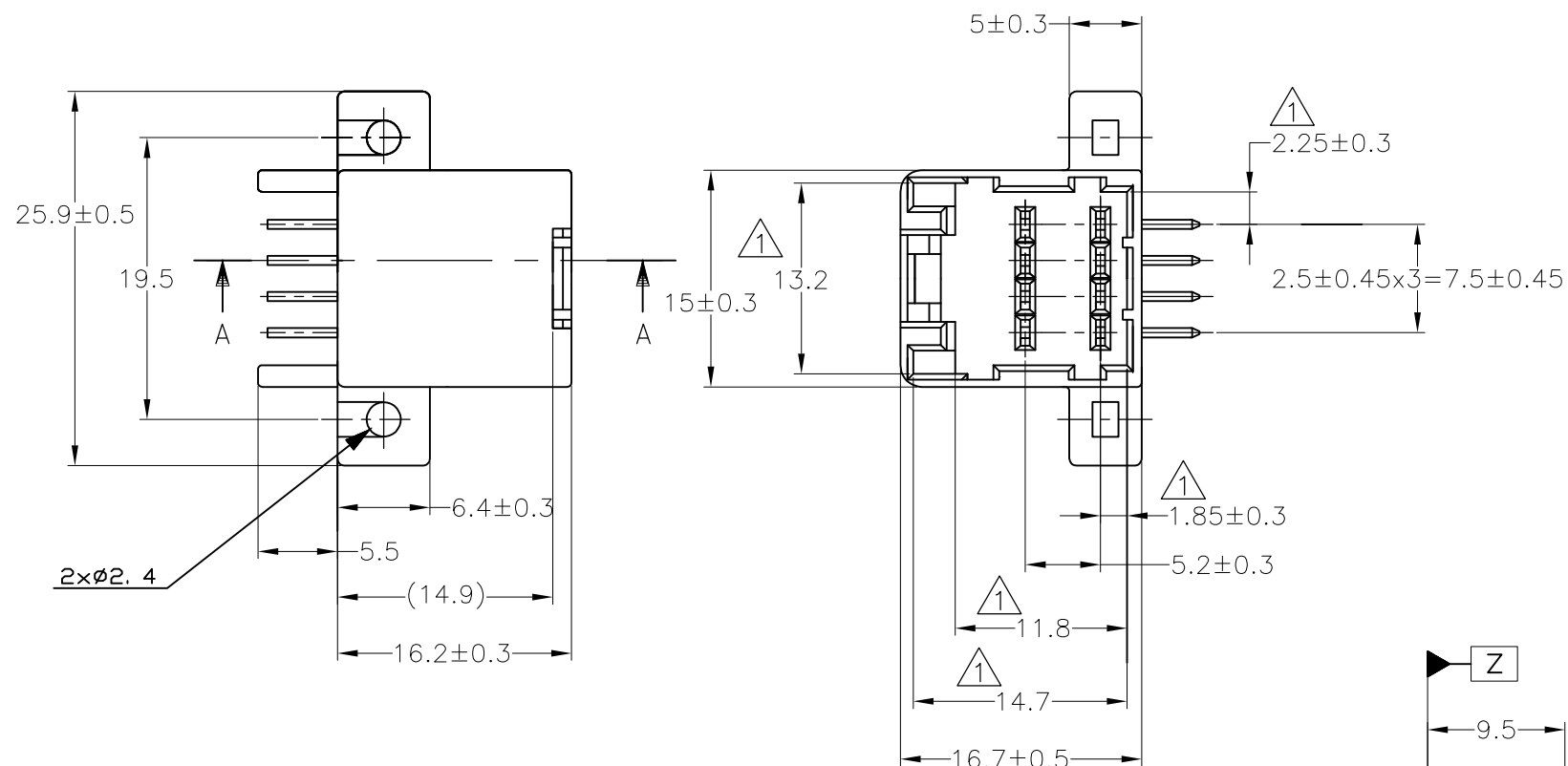

- ① Z面より2mmの範囲で測定。
 - 2. 適用プリント基板厚: 1.6mm
 - 3. 嵌合相手ハウジング型番: 174044
 - 4. 推奨取付けねじ: JIS B1115, B1122 タッピングねじ、なべ2種 呼び径3、長さ7mm以上(締付けトルク: 39.2N-cm以下)
- ① TO BE MEASURED WITHIN 2mm FROM Z
- 2. APPLICABLE P.C.BOARD THICKNESS: 1.6mm
 - 3. THE MATING PLUG HOUSING PART NUMBER: 174044
 - 4. RECOMMENDED MOUNTING SCREW: 3mm DIA, 7mm LENGTH (MIN.) PAN HEAD, CLASS 2 TAPPING SCREW SPECIFIED IN JIS B1115, B1122 (TIGHTENING TORQUE: 39.2N-cm MAX.)

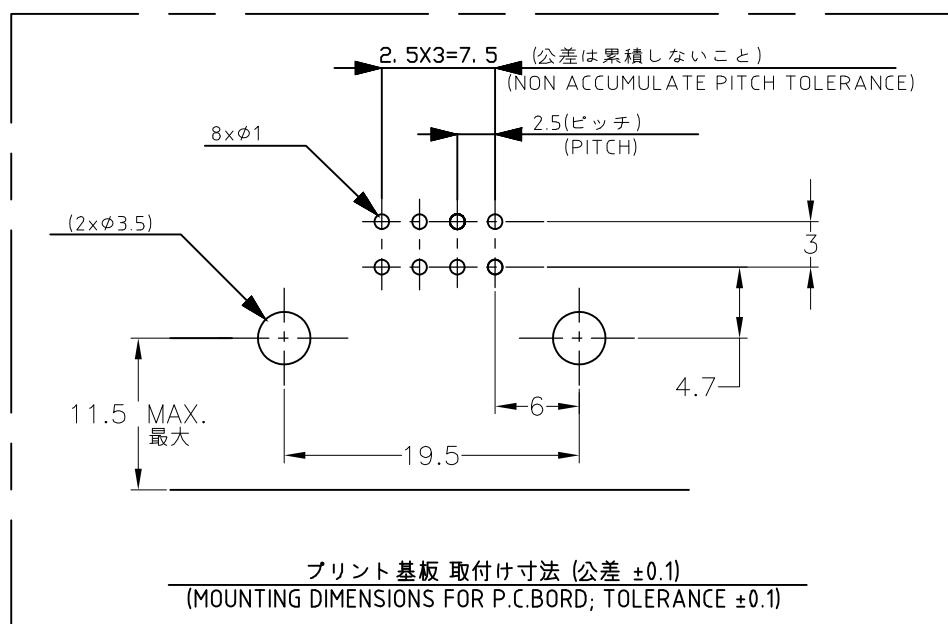
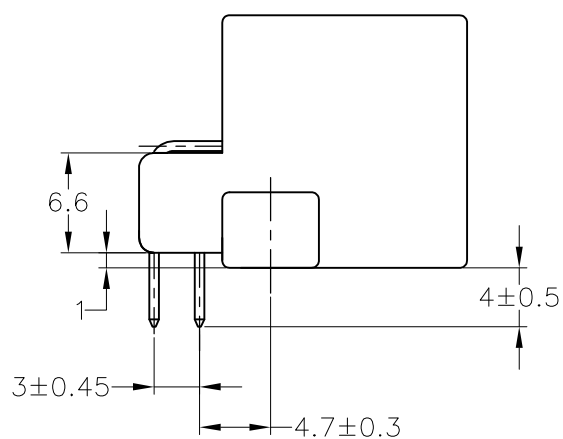

TOLERANCES UNLESS OTHERWISE SPECIFIED:

一般公差

0 < x < 10:	±0.2
10 < x < 30:	±0.25
30 < x < 100:	±0.3
ANGLE:	±3°

THIS DRAWING IS A CONTROLLED DOCUMENT.

DIMENSIONS:	TOLERANCES UNLESS OTHERWISE SPECIFIED:
mm	
0 PLC	±-
1 PLC	±-
2 PLC	±-
3 PLC	±-
4 PLC	±-
ANGLES	±-
FINISH	SEE TABLE

MATERIAL ハウジング: PBT
HOUSING
コンタクト: BRASS
CONTACT 黄銅

SELECTIVE TIN (MATTE)	SELECTIVE GOLD x 8	1~8	BLACK 黒色	1-5174049-2
OBSOLETE	TIN-LEAD	TIN-LEAD x 8	BLACK 黒色	2-174049-2
OBSOLETE	TIN-LEAD	SELECTIVE GOLD x 8	BLACK 黒色	1-174049-2
	PRE-TIN x 8	---	BLUE 青色	174049-5
	PRE-TIN x 8	---	BLACK 黒色	174049-2
SOLDERING SIDE 半田付け部	CONTACT SIDE 接触部側		GOLD PLATED CIRCUIT NO. 金めっき回路番号	COLOR 色
CONTACT FINISH コンタクト仕上				PART NUMBER 製品型番

THIS DRAWING IS A CONTROLLED DOCUMENT.

DWN	K.FURUYAMA	13APR2015	STE TE Connectivity
CHK	Y.MITO	13APR2015	
APVD	R.KOMIYAMA	13APR2015	
PRODUCT SPEC			
APPLICATION SPEC			NAME
WEIGHT 3.4 g			8 POSITION CAP HOUSING ASSMBLY .040 SERIES MULTI-LOCK I/O CONNECTOR (H-TYPE)
CUSTOMER DRAWING		SIZE A3	CAGE CODE 00779
SCALE 2:1		DRAWING NO. C-174049	RESTRICTED TO
SHEET 1 OF 1		REV E3	

X-ON Electronics

Largest Supplier of Electrical and Electronic Components

Click to view similar products for [Automotive Connectors](#) category:

Click to view products by [TE Connectivity](#) manufacturer:

Other Similar products are found below :

[003-018-000](#) [60403001](#) [60993906-B](#) [M902-2131](#) [M902-2161](#) [72.330.1035.1](#) [73.353.4028.0](#) [F119300-B](#) [F166900](#) [F258300-B](#) [F358300-B](#)
[F407400](#) [F444110](#) [F487000](#) [F509500B-B](#) [827153-1](#) [8N1515-32-24P](#) [9-1326729-8](#) [925474-1](#) [928905-1](#) [964562-4](#) [968782-1](#) [GT17SA-8DS-](#)
[HU](#) [98891-1012](#) [98947-1016](#) [12004147](#) [12004475-L](#) [12010290](#) [12010309-B](#) [12015454](#) [12020219-B](#) [12020308](#) [12041318-B](#) [12052225-L](#)
[12052466](#) [12059125](#) [12064869](#) [12004327-B](#) [12010503-B](#) [12015308](#) [12015384](#) [12015909](#) [1-21030-1](#) [12041254](#) [12041318](#) [12047946-B](#)
[12047957](#) [12047957-L](#) [12059473](#) [12066261](#)