

THIS DRAWING IS UNPUBLISHED. RELEASED FOR PUBLICATION
 © COPYRIGHT - By - ALL RIGHTS RESERVED.

LOC		DIST		REVISIONS			
P	LTR	DESCRIPTION		DATE	DWN	APVD	
GP	00	C2	REVISED PER ECR-20-000784		14FEB2020	WH	DZ

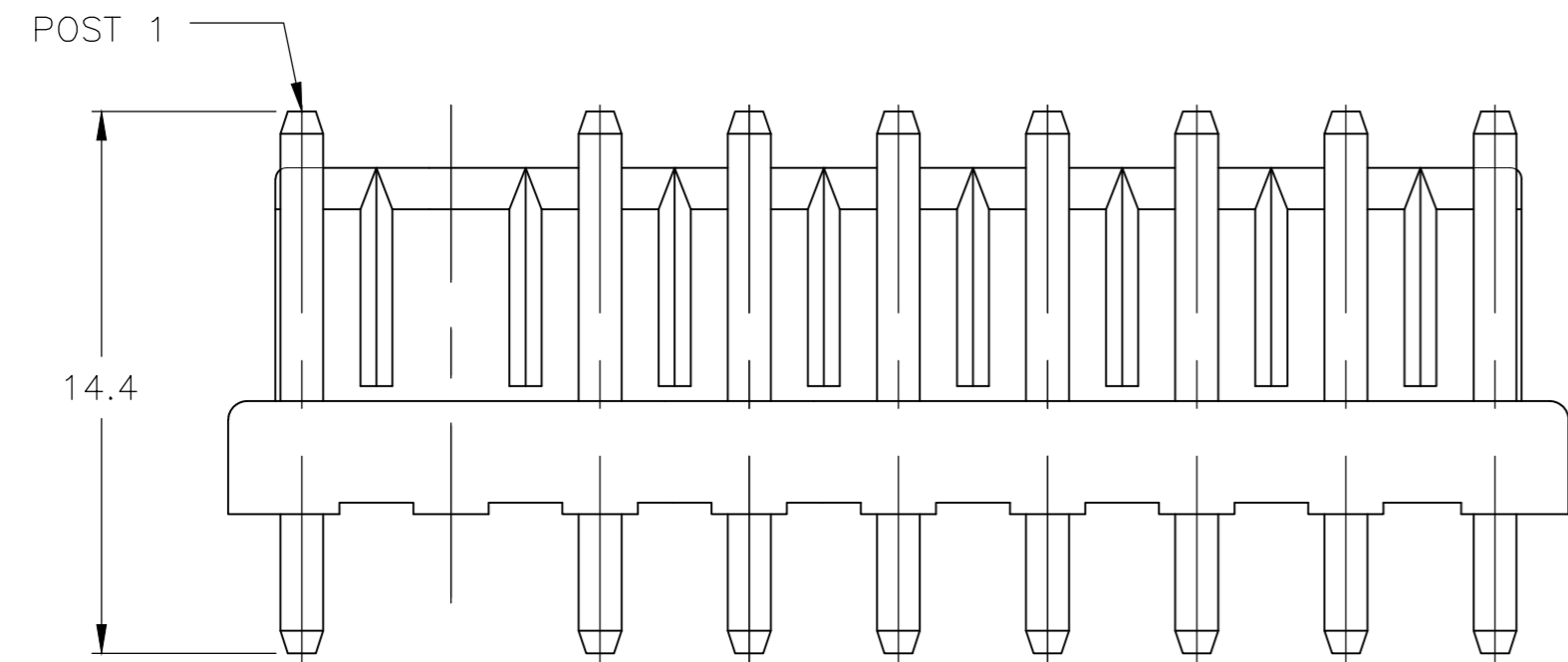

∅1.60^{+0.1}/_{0.0} (PUNCHED HOLE)
 ∅1.65^{+0.1}/_{0.0} (DRILLED HOLE)

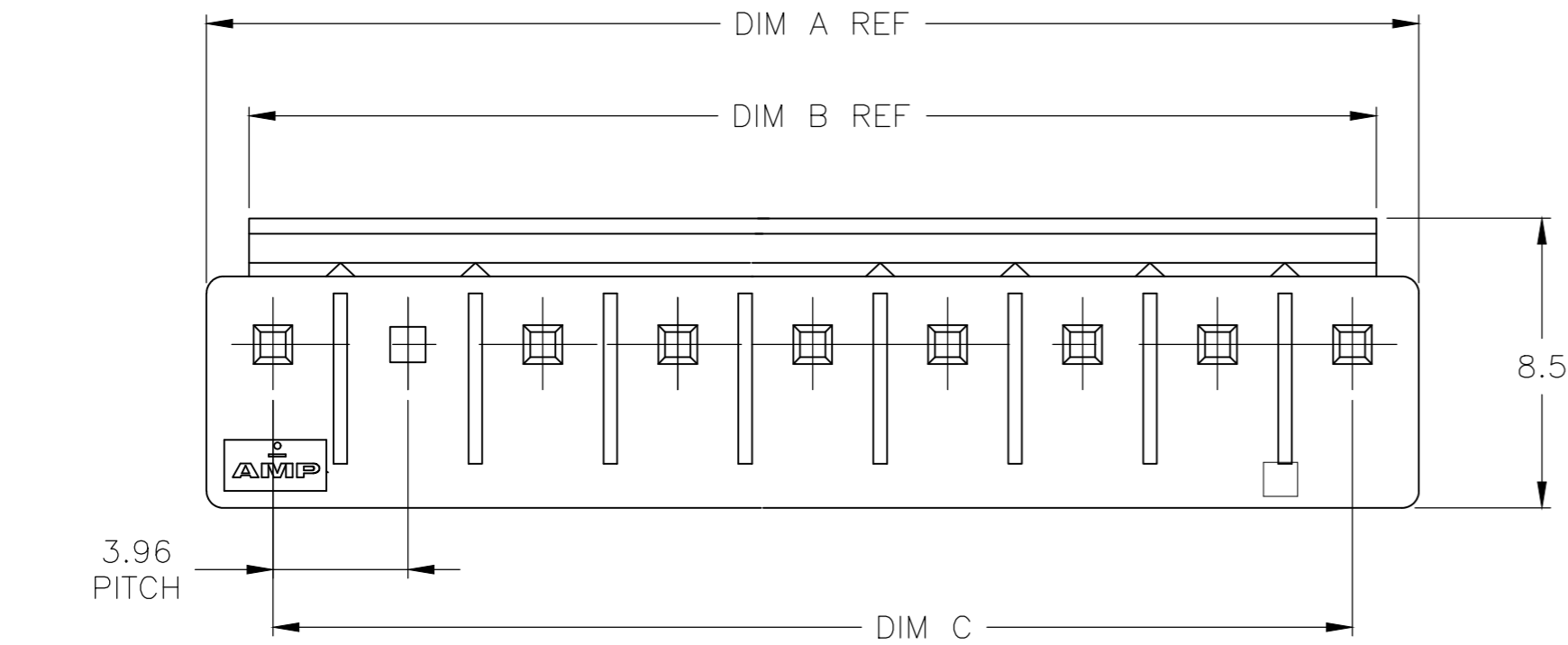
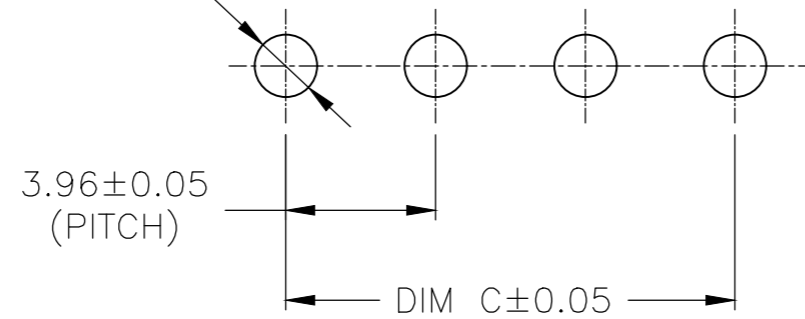

PCB LAYOUT
 THICKNESS: 1.60

- 1 MATERIAL: HOUSING- PBT, NATURAL
 POST- BRASS, 1MICROMETER MIN TIN OVER
 0.8 MICROMETER MIN NICKEL.
- 2. RECOMMENDED MATING PART: *-1123722-*
- 3 0 : WITH PIN,
 X : WITHOUT PIN.

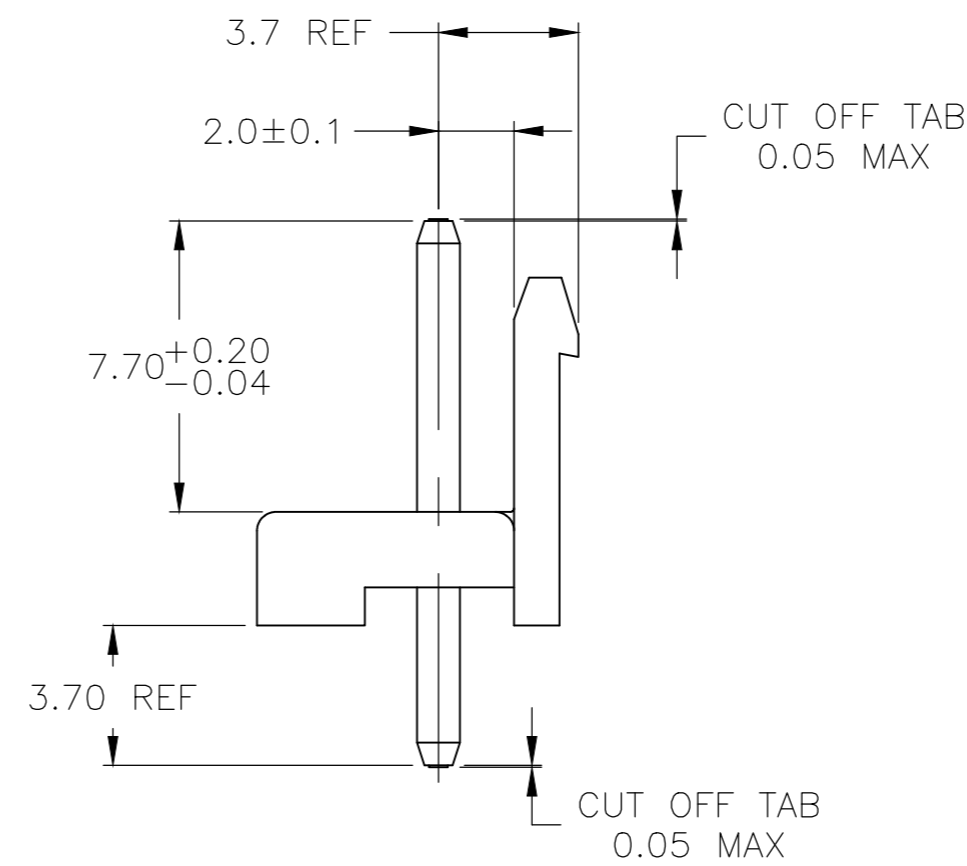

1744109-1 SHOWN

O	X	O	X	O	X	O	X	O	X	O	NATURAL	39.60	41.00	43.50	11	1-1744109-6
O	X	O	X	O	X	O	X	O	X	O	BLUE	31.68	33.08	35.58	9	3-1744109-5
O	X	O	X	O	X	O	X	O	X	O	NATURAL	31.68	33.08	35.58	9	1-1744109-5
O	X	O	X	O	X	O	O	O	O	O	NATURAL	31.68	33.08	35.58	9	1744109-5
O	O	O	O	O	O	O	8	O	O	O	BLUE	31.68	33.08	35.58	9	1744109-4
O	O	O	O	O	O	O	8	O	O	O	NATURAL	31.68	33.08	35.58	9	1744109-3
O	X	O	O	O	X	O	O	O	O	O	NATURAL	31.68	33.08	35.58	9	1744109-2
O	X	O	O	O	O	O	O	O	O	O	NATURAL	31.68	33.08	35.58	9	1744109-1
1	2	3	4	5	6	7	8	9	10	11	HOUSING COLOR	DIM C	DIM B	DIM A	NO. OF POSITIONS	ASSEMBLY PART NO.

OBSOLETE

3

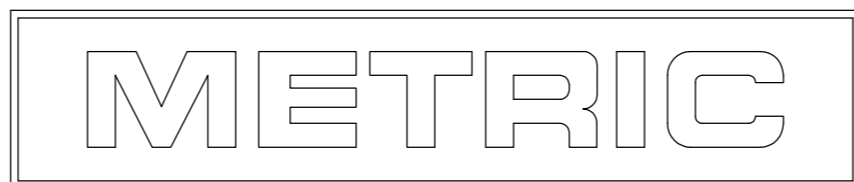

THIS DRAWING IS A CONTROLLED DOCUMENT.

DIMENSIONS: mm	TOLERANCES UNLESS OTHERWISE SPECIFIED: 0 PLC ± - 1 PLC ± 0.5 2 PLC ± 0.30 3 PLC ± - 4 PLC ± - ANGLES ± -	DWN K. WHITAKER 07JUN04	CHK D. BOSSI 07JUN04	APVD D. BOSSI 07JUN04	NAME D. BOSSI	PRODUCT SPEC 108-5609	APPLICATION SPEC -	WEIGHT -	SCALE N/A	SHEET 1 of 1	REV C2
-------------------	----------------------------------------------------------------------------------------------------------------------------	-------------------------------	----------------------------	-----------------------------	------------------	--------------------------	-----------------------	-------------	--------------	-----------------	-----------

MATERIAL 1 FINISH 1

CUSTOMER DRAWING

TE Connectivity
 HEADER ASSEMBLY, SPECIAL,
 OMITTED POST, 9 POSITION,
 ECONOMY POWER (EP)

SIZE A2 CAGE CODE 00779 DRAWING NO. C=1744109 RESTRICTED TO -

X-ON Electronics

Largest Supplier of Electrical and Electronic Components

Click to view similar products for [Headers & Wire Housings](#) category:

Click to view products by [TE Connectivity](#) manufacturer:

Other Similar products are found below :

[892-18-020-10-001101](#) [58102-G61-06LF](#) [582553-1](#) [0009485154](#) [009176003701906](#) [0050291907](#) [LY20-4P-DT1-P1E-BR](#) [02.125.8002.8](#)
[609-3404](#) [61062-3](#) [61082-181009](#) [622-3653LF](#) [63453-116](#) [636-1030](#) [636-1427](#) [636-3427](#) [636-4007](#) [641938-9](#) [641991-4](#) [644827-2](#) [65817-](#)
[010LF](#) [65817-015LF](#) [65863-015LF](#) [66207-023LF](#) [67095-007LF](#) [67601157](#) [68645-018](#) [68648-049](#) [70.362.1628.0](#) [70-4210](#) [70-4226B](#) [70-](#)
[4853B](#) [707-5020](#) [707-5028](#) [71.350.2428.0](#) [71918-208LF](#) [71961-016LF](#) [733-134](#) [733-162](#) [754199-000](#) [760-3052](#) [787-8014-00](#) [79531-3000](#)
[FCN-360C032-B](#) [FCN-367T-T012/H](#) [FCN-723D010/2](#) [80.063.4001.1](#) [800-90-001-10-001000](#) [800-90-010-10-002000](#) [801-43-002-10-013000](#)