

| REVISIONS | | | | | |
|-----------|---------|---------------|-----------|-----|------|
| REV | DATE | DESCRIPTION | BY | CHK | APPV |
| M8 | REVISED | ECR-16-003276 | 05SEP2016 | KF | HY |

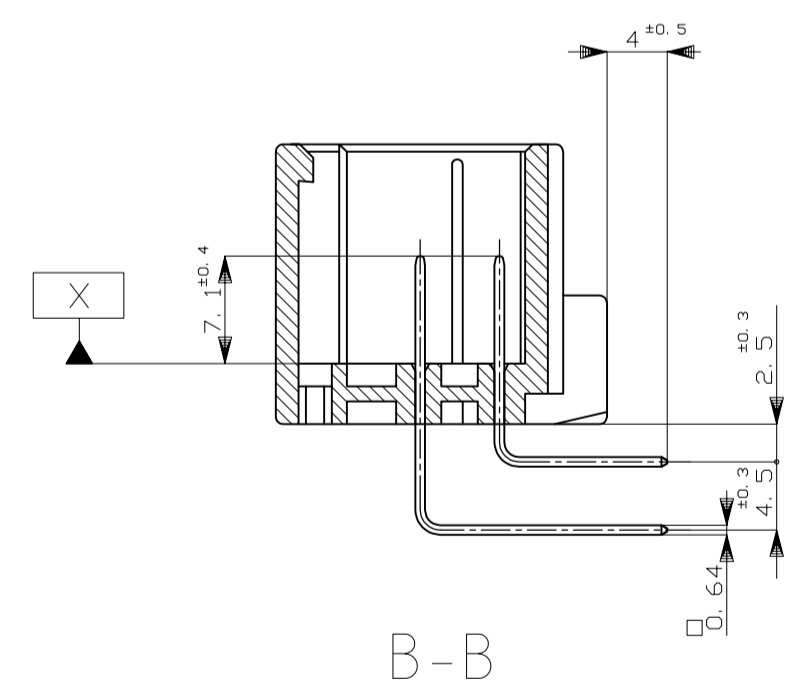

- △ X 面から2mmの範囲で測定
- 2. 嵌合相手ハウジング型 174515, 174516, 917989, 917992
- 3. 推奨取付ねじ: JIS B1115, B1112 タッピンねじ, なべ2種
呼び径3, 長さ6mm以下 (締付けトルク: 39N・cm (4kgf・cm) 以下)
- 4. 適用製品規格番号: 108-5280, 108-5342

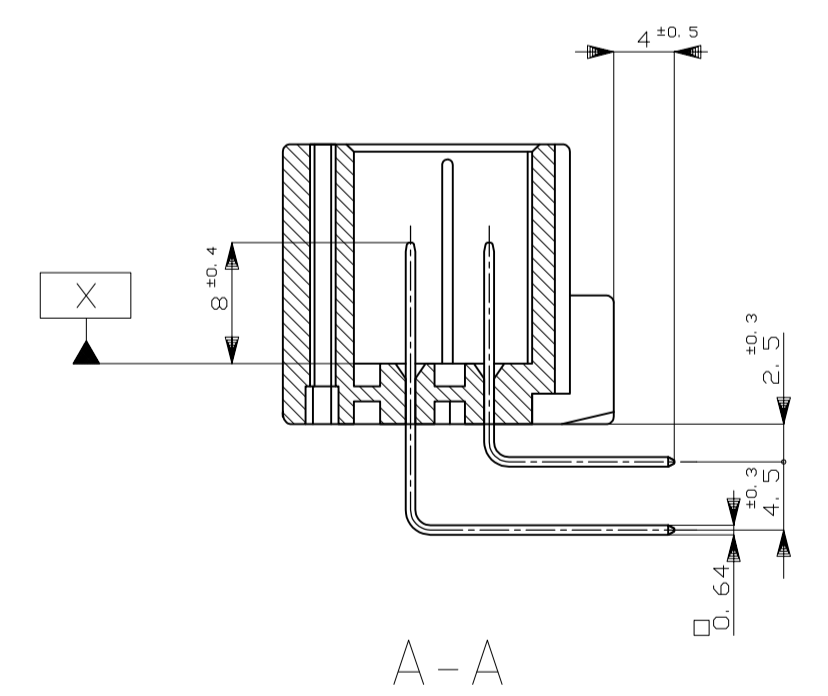
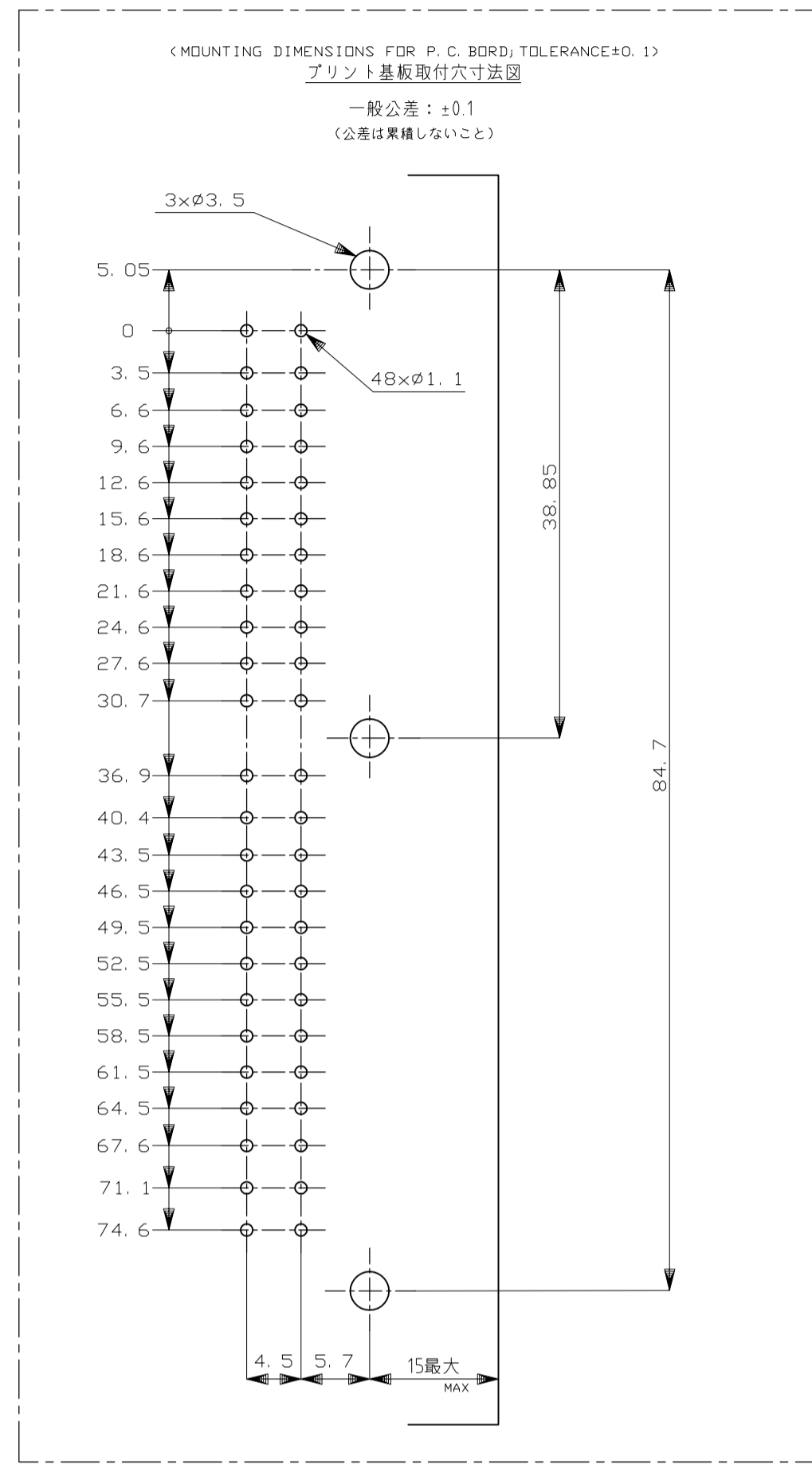
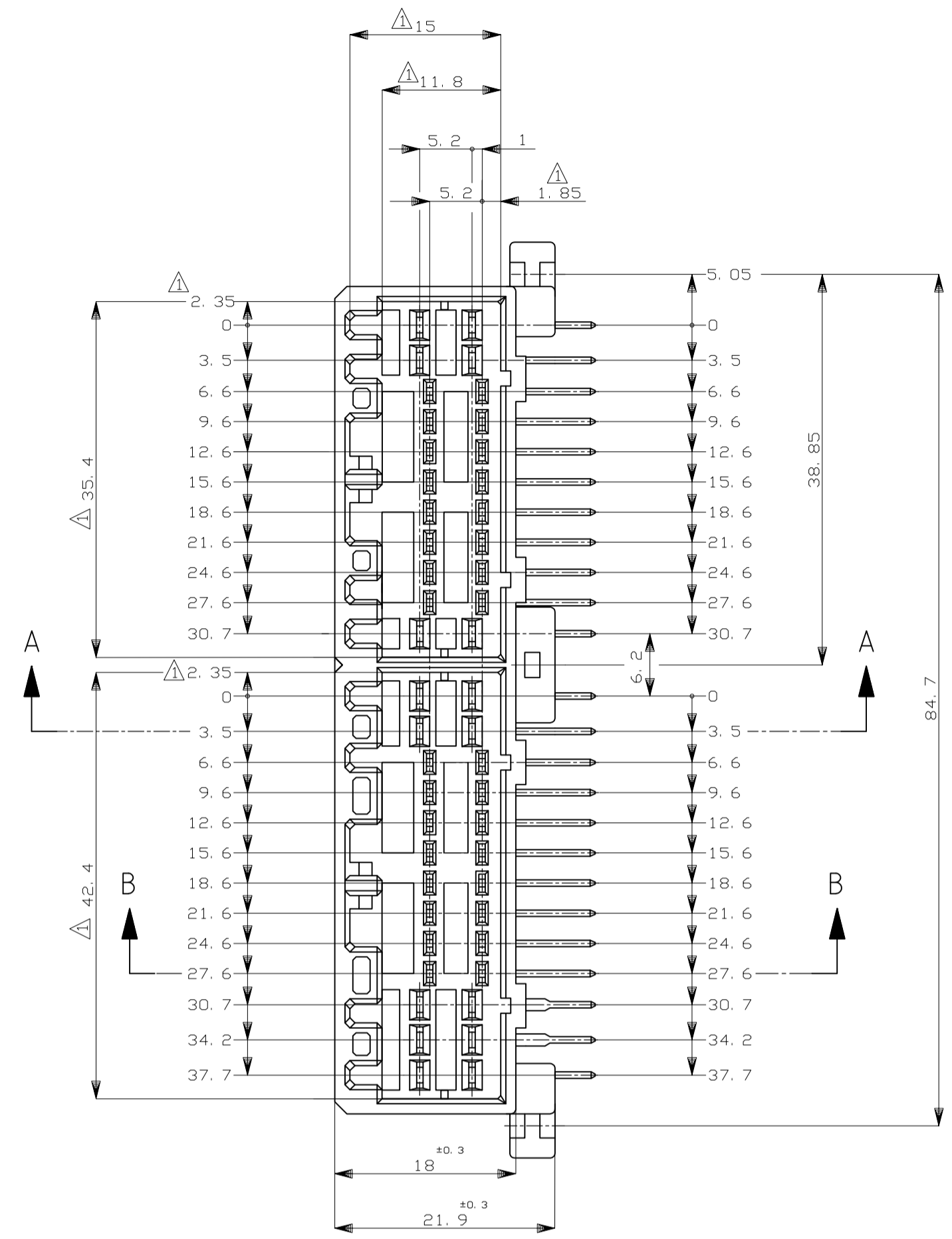
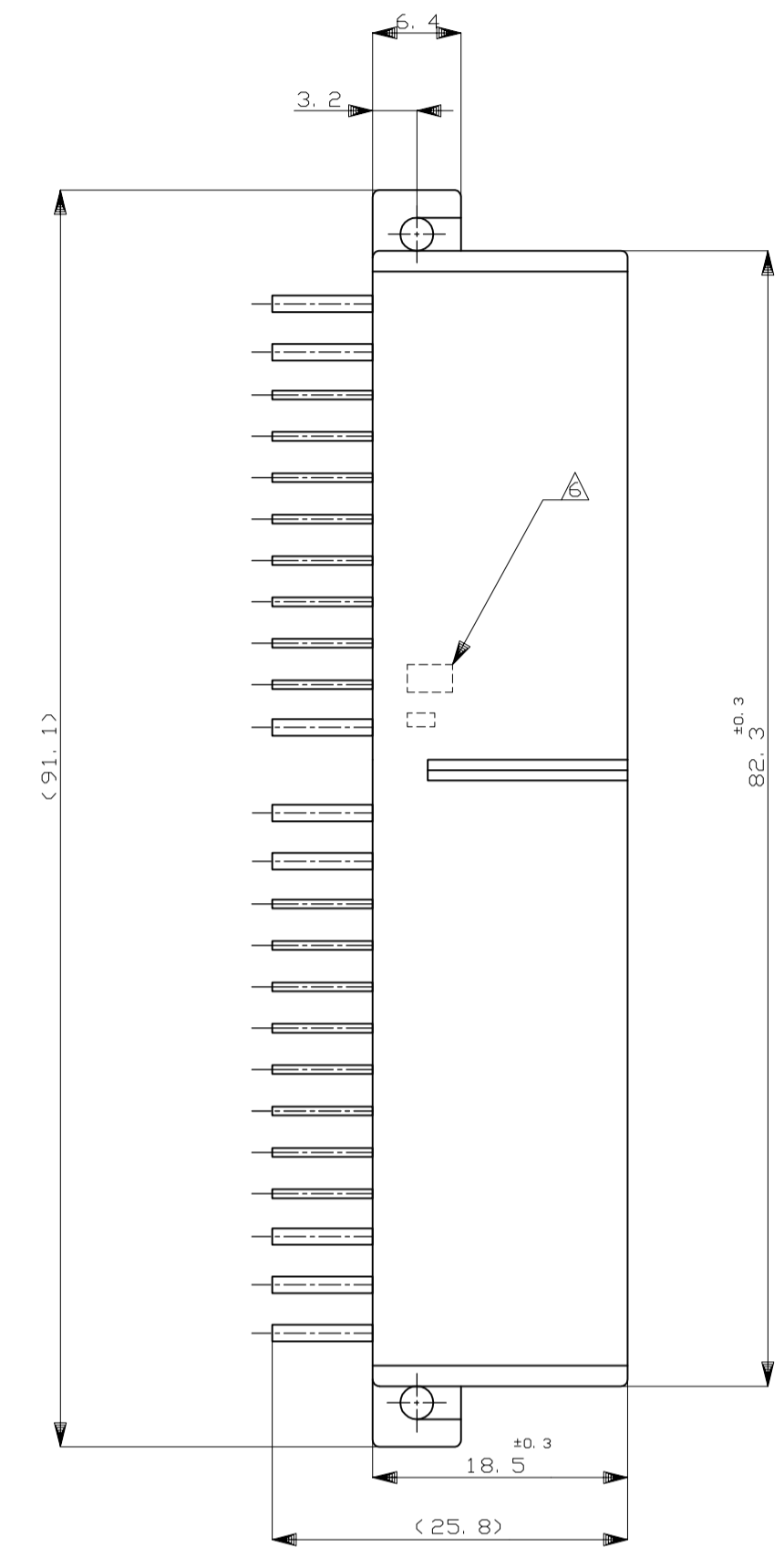
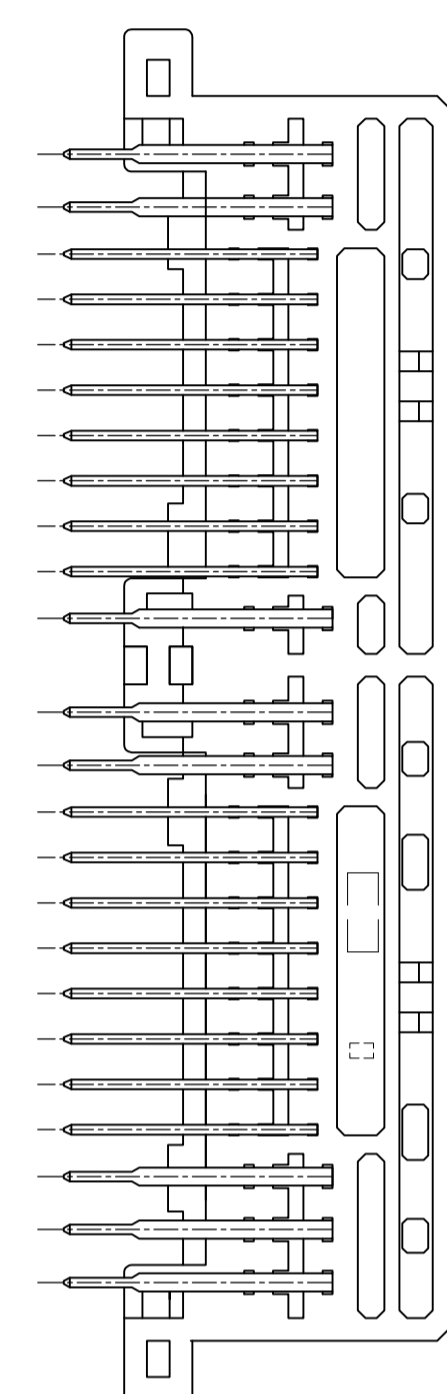
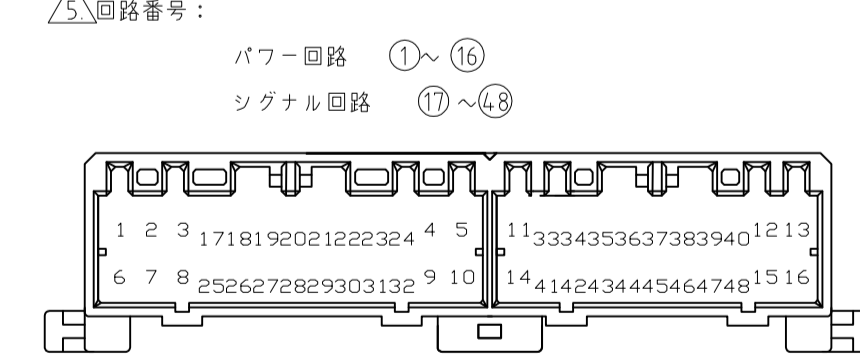

- △ 回路番号:
 パワー回路 ①~⑬
 シグナル回路 ⑭~④⑧
- △ 6. コンタクト仕上識別マーク
- △ MUST BE KEPT BETWEEN X AND 2
- 2. THE MATING PLUG HSG PART NUMBER, 174515, 174516, 917989, 917992
- 3. RECOMMENDED MOUNTING SCREW, 3mm DIA, 6mm LENGTH (MAX.)
 PAN HEAD, CLASS 2 TAPPING SCREW SPECIFIED IN JIS B1115, B1122
 (TIGHTENING TORQUE, 39.2N・cm (4kgf・cm) MAX.)
- 4. APPLICABLE PRODUCT SPEC NO.: 108-5280, 108-5342
- △ ⑤ CIRCUIT NUMBER
 POWER CIRCUIT NO. ①~⑬
 SIGNAL CIRCUIT NO. ⑭~④⑧
- △ MARKING FOR DISCERNMENT OF THE CONTACT FINISH

| NO. | FINISH | PLATING | CONTACT SIDE | POWER CIRCUIT NO. | SIGNAL CIRCUIT NO. | COLOR | PART NUMBER |
|-----|-----------------------|-----------------------------|--------------|---------------------------|--------------------|--------------|-------------|
| 54 | SELECTIVE-TIN (MATTE) | SELECTIVE GOLD x 16 | - | 33~40, 41~48 | - | YELLOW 黄色 | 4-5174917-7 |
| 57 | SELECTIVE-TIN (MATTE) | PRE-TIN x 32 | - | 19, 20, 27, 28, 36 | - | GRAY 灰色 | 7-5174917-6 |
| 56 | SELECTIVE-TIN (MATTE) | SELECTIVE GOLD x 7 | - | 21~23, 28~31 | - | YELLOW 黄色 | 6-5174917-7 |
| 58 | SELECTIVE-TIN (MATTE) | SELECTIVE GOLD x 10 | - | 19, 20, 27~31, 36, 44 | - | GRAY 灰色 | 8-5174917-6 |
| 59 | SELECTIVE-TIN (MATTE) | SELECTIVE GOLD x 8 | - | 19, 20, 27~31, 36 | - | GRAY 灰色 | 9-5174917-6 |
| 55 | SELECTIVE-TIN (MATTE) | SELECTIVE-TIN (BRIGHT) x 40 | - | 33~40 | - | YELLOW 黄色 | 5-5174917-7 |
| 52 | SELECTIVE-TIN (MATTE) | SELECTIVE-TIN (BRIGHT) x 40 | - | 18~24, 27~32, 36, 44 | - | YELLOW 黄色 | 2-5174917-7 |
| 8 | TIN-LEAD | SELECTIVE GOLD x 10 | - | 19, 20, 22, 28~32, 36, 44 | - | GRAY 灰色 | 8-174917-6 |
| 7 | TIN-LEAD | PRE-TIN x 38 | - | 19, 20, 27, 28, 36 | - | GRAY 灰色 | 7-174917-6 |
| 4 | TIN-LEAD | SELECTIVE GOLD x 16 | - | 33~40, 41~48 | - | YELLOW 黄色 | 4-174917-7 |
| 3 | TIN-LEAD | PRE-TIN x 32 | - | 17~24, 33~40 | - | NATURAL 自然色 | 3-174917-1 |
| 2 | TIN-LEAD | SELECTIVE GOLD x 15 | - | 18~24, 27~32, 36, 44 | - | YELLOW 黄色 | 2-174917-7 |
| 0 | PRE-TIN x 48 | - | - | - | - | ORANGE オレンジ色 | 174917-8 |
| 0 | PRE-TIN x 48 | - | - | - | - | YELLOW 黄色 | 174917-7 |
| 0 | PRE-TIN x 48 | - | - | - | - | GRAY 灰色 | 174917-6 |
| 0 | PRE-TIN x 48 | - | - | - | - | BLUE 青色 | 174917-5 |
| 0 | SELECTIVE-TIN (MATTE) | SELECTIVE-TIN (BRIGHT) x 48 | - | - | - | NATURAL 自然色 | 174917-2 |
| 0 | PRE-TIN x 48 | - | - | - | - | NATURAL 自然色 | 174917-1 |

THIS DRAWING IS A CONTROLLED DOCUMENT.

DIMENSIONS: 単位: 寸 (mm)
 TOLERANCES UNLESS OTHERWISE SPECIFIED:
 0 PLC ±
 1 PLC ±
 2 PLC ±
 3 PLC ±
 4 PLC ±
 ANGLES ±

MATERIAL: HOUSING: PBT CONTACT: BRASS
 FINISH: 仕上

GENERAL TOLERANCE:
 DC < 10 ± 0.2
 10 < DC < 30 ± 0.25
 30 < DC < 100 ± 0.3
 ANGLES ± 3°

THIS DRAWING IS A CONTROLLED DOCUMENT.
 DIN T. SHINOHARA
 CHK K. BETSUJI
 APVD K. BETSUJI
 PRODUCT SPEC 製品仕様
 APPLICATION SPEC 取付適用規格
 WEIGHT 24.1 g
 CUSTOMER DRAWING

08FEB08
 08FEB08
 NAME 氏名
 SIZE A1
 SCALE 2:1
 SHEET 1 of 1
 REV M8

48POSITION CAP HOUSING ASSEMBLY
 040/070 SERIES HYBRID I/O CONNECTOR
 00779
 174917

X-ON Electronics

Largest Supplier of Electrical and Electronic Components

Click to view similar products for [Automotive Connectors](#) category:

Click to view products by [TE Connectivity](#) manufacturer:

Other Similar products are found below :

[003-018-000](#) [60403001](#) [60993906-B](#) [M902-2131](#) [M902-2161](#) [M902-2344](#) [72.330.1035.1](#) [73.353.4028.0](#) [F119300-B](#) [F166900](#) [F258300-B](#)
[F358300-B](#) [F407400](#) [F444110](#) [F487000](#) [F509500B-B](#) [827153-1](#) [8N1515-32-24P](#) [9-1326729-8](#) [925474-1](#) [928905-1](#) [964562-4](#) [968782-1](#)
[GT17SA-8DS-HU](#) [98891-1012](#) [98947-1016](#) [12004147](#) [12004475-L](#) [12010290](#) [12015454](#) [12020219-B](#) [12041318-B](#) [12052225-L](#) [12052466](#)
[12064869](#) [12004327-B](#) [12015308](#) [12015384](#) [12015909](#) [1-21030-1](#) [12041254](#) [12041318](#) [12047946-B](#) [12047957](#) [12047957-L](#) [12059473](#)
[12066261](#) [12110546](#) [12110546-B](#) [12131792](#)