

| LOC | | DIST | | REVISIONS | | | |
|-----|-----|---------------|-----------|-----------|------|--|--|
| P | LTR | DESCRIPTION | DATE | DRN | APVD | | |
| A | | ECO-06-002586 | 03FEB2006 | LAM | MY | | |
| B | | ECO-06-005597 | 13MAR2006 | LAM | PR | | |
| C | | ECO-06-009340 | 21APR2006 | LAM | PR | | |
| D | | ECO-07-007895 | 27APR2007 | LAM | PR | | |

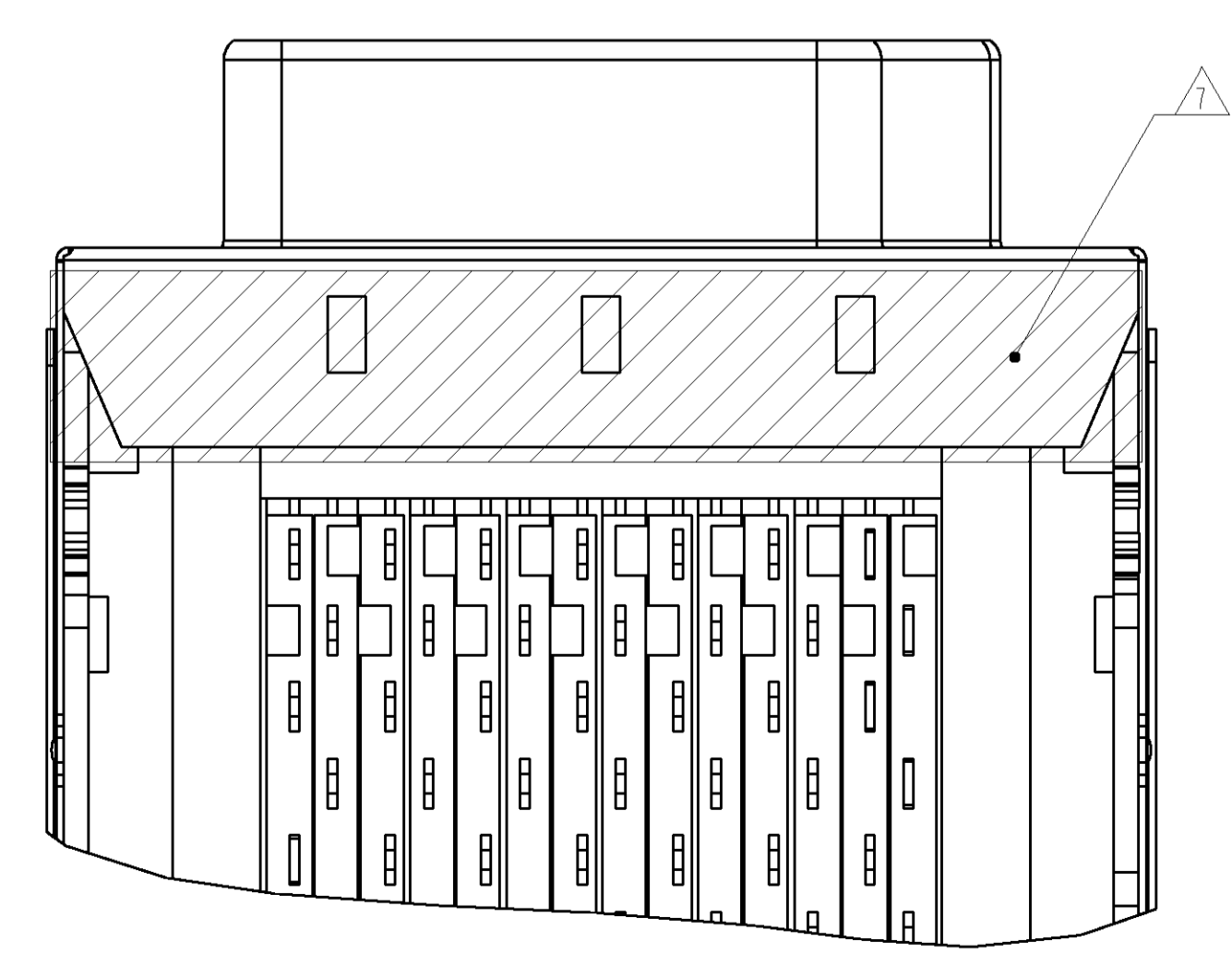
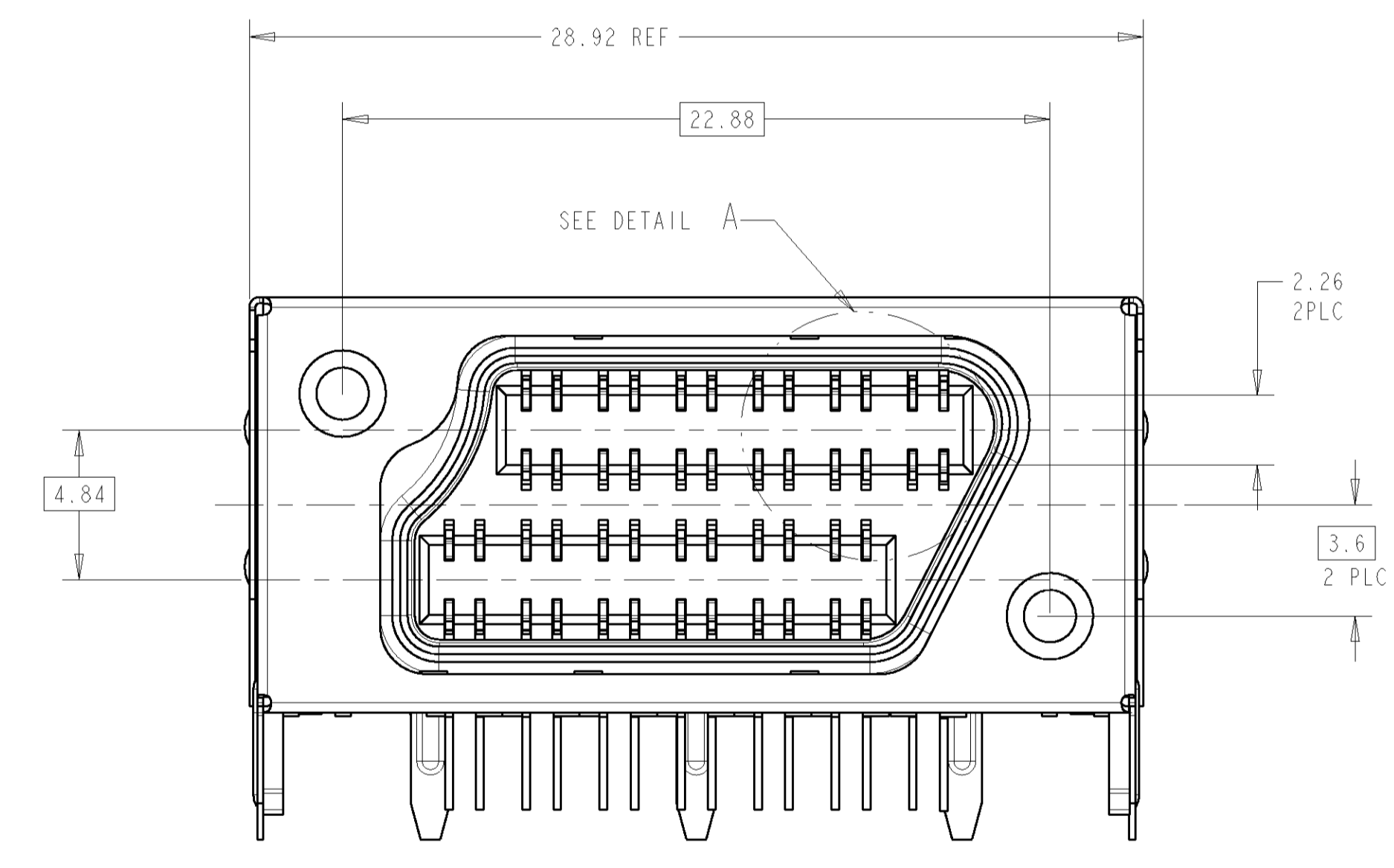
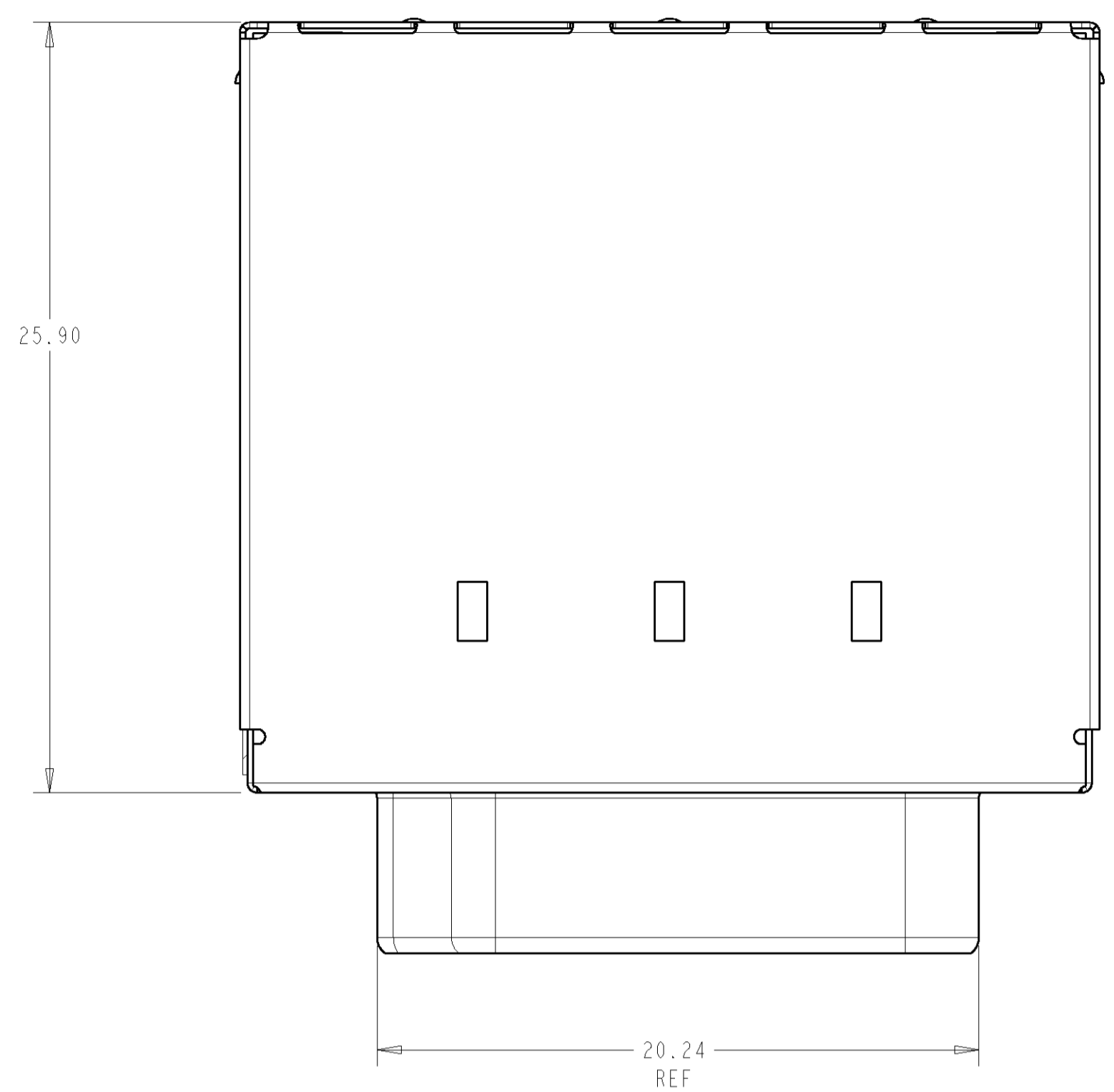

1. MATERIAL:
 HOUSING - BLACK THERMOPLASTIC, PBT FLAMMABILITY RATING UL 94V-0
 SHIELD - 0.2 MM THICK BRASS - PLATED WITH 1.98µm MIN THK. TIN. OVER 1.27µm MIN THK NICKEL
 FRONT DRAWN SHELL - CARBON STEEL - PLATED WITH 5.08µm MIN NICKEL
 BOARD LOCKS - BRASS PLATED WITH 1.27µm MIN TIN OVER 1.27µm MIN NICKEL
 CONTACTS - 0.254 MM THK. PHOSPHOR BRONZE - ENTIRE TERMINAL PLATED WITH 2.54µm MIN NICKEL. MATING AREA PLATED WITH GOLD FLASH OVER 0.76µm MIN Pd-Ni. SOLDER TAILS WITH PLATED 1.98µm MIN TIN
 INSERTS, THREADED - MILD STEEL
 SCREW LOCKS - STAINLESS STEEL

3 THE SCREW LOCKS ARE FOR USE WITH JACKSCREWS TO PROVIDE CABLE RETENTION.

4 RECOMMENDED TORQUE FOR SCREW LOCK IS 4 IN-LB. FOR PANEL MOUNTED VERSION, 1761715-1 AND 1761715-2.

5 SCREW LOCK DESIGNATION:
 SCREW LOCKS MUST BE ORDERED SEPARATELY FROM TABLE BELOW. SCREW LOCKS PACKAGED IN QUANTITIES OF 960 PIECES.

| | |
|-----------------|----------------|
| > 1mm - < 2mm | 1339381-2 |
| 0mm - ≤ 1mm | 1339381-1 |
| PANEL THICKNESS | SCREW LOCK P/N |

6 DATE CODE AND PART NUMBER LABEL IN APPROXIMATE AREA SHOWN.

7 0.05 THK. INSULATING TAPE WITH 0.05 MIN THK. ADHESIVE BACKING IN AREA SHOWN.

8 DATUM AND BASIC DIMENSIONS ESTABLISHED BY CUSTOMER

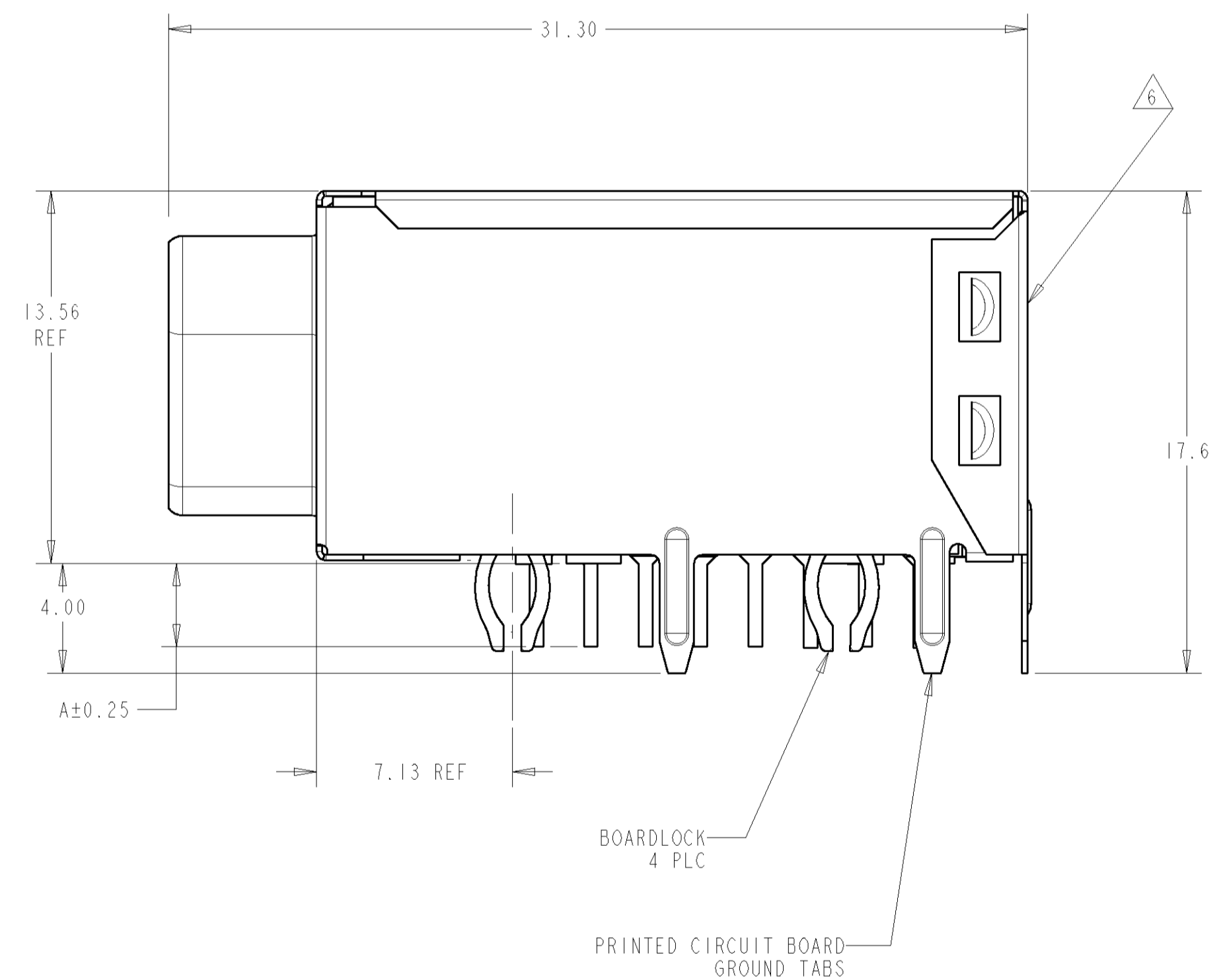

1761715-1 SHOWN

| | | |
|-------------|---------|-------------|
| PRESS-FIT | 3.04 | 1761715-2 |
| SOLDERTAIL | 4.54 | 1761715-1 |
| TERMINATION | DIM "A" | PART NUMBER |

| | | | | | | | |
|---------------------------------|--|--|--|--|--|---|--|
| DIMENSIONS: mm: | | TOLERANCES UNLESS OTHERWISE SPECIFIED: 0 PLC ± 1 PLC ±0.1 2 PLC ±0.10 3 PLC ± 4 PLC ± ANGLES ± | | DRN: R. GRZYBOWSKI ENR: M. YEOMANS APVD: S. FLICKINGER | | Tyco Electronics Harrisburg, PA 17105-3608 | |
| MATERIAL: SEE NOTE 1 FINISH: | | WEIGHT: | | SIZE: CAGE CODE: DRAWING NO: 00779 C=1761715 CUSTOMER DRAWING | | Tyco Electronics ASSEMBLY, RECEPTACLE, 48 POSITION, MR J21 RESTRICTED TO: | |
| SCALE: 6:1 | | SHEET: 1 OF 4 | | REV: D | | DATE: 03FEB2006 | |

| LOC | DIST | REVISIONS | | | | | |
|-----|------|-----------|-----|-------------|------|-----|------|
| AA | 00 | P | LTN | DESCRIPTION | DATE | DRN | APVD |
| - | - | - | - | SEE SHEET 1 | - | - | - |

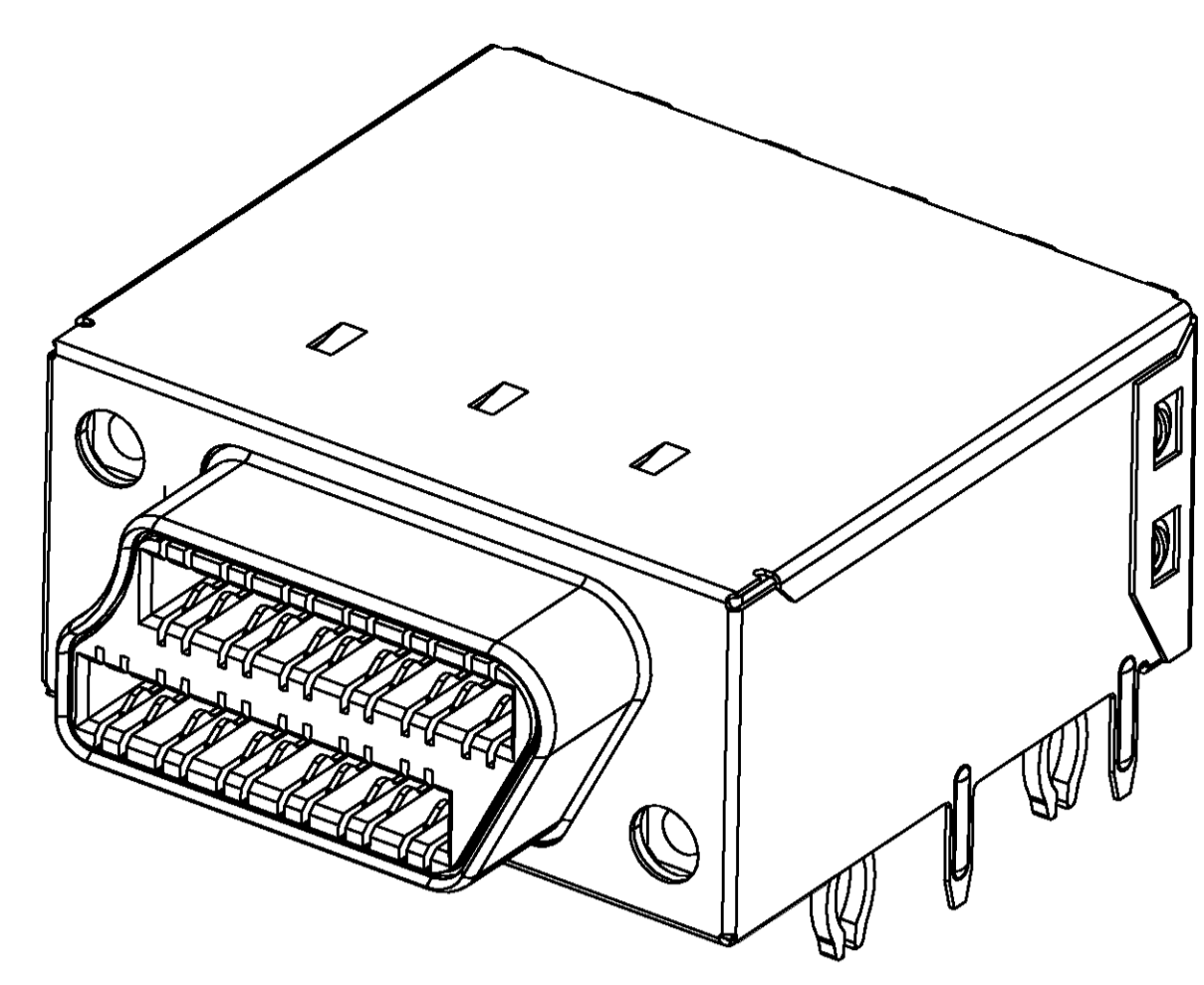

1761715-1
SCALE 4:1

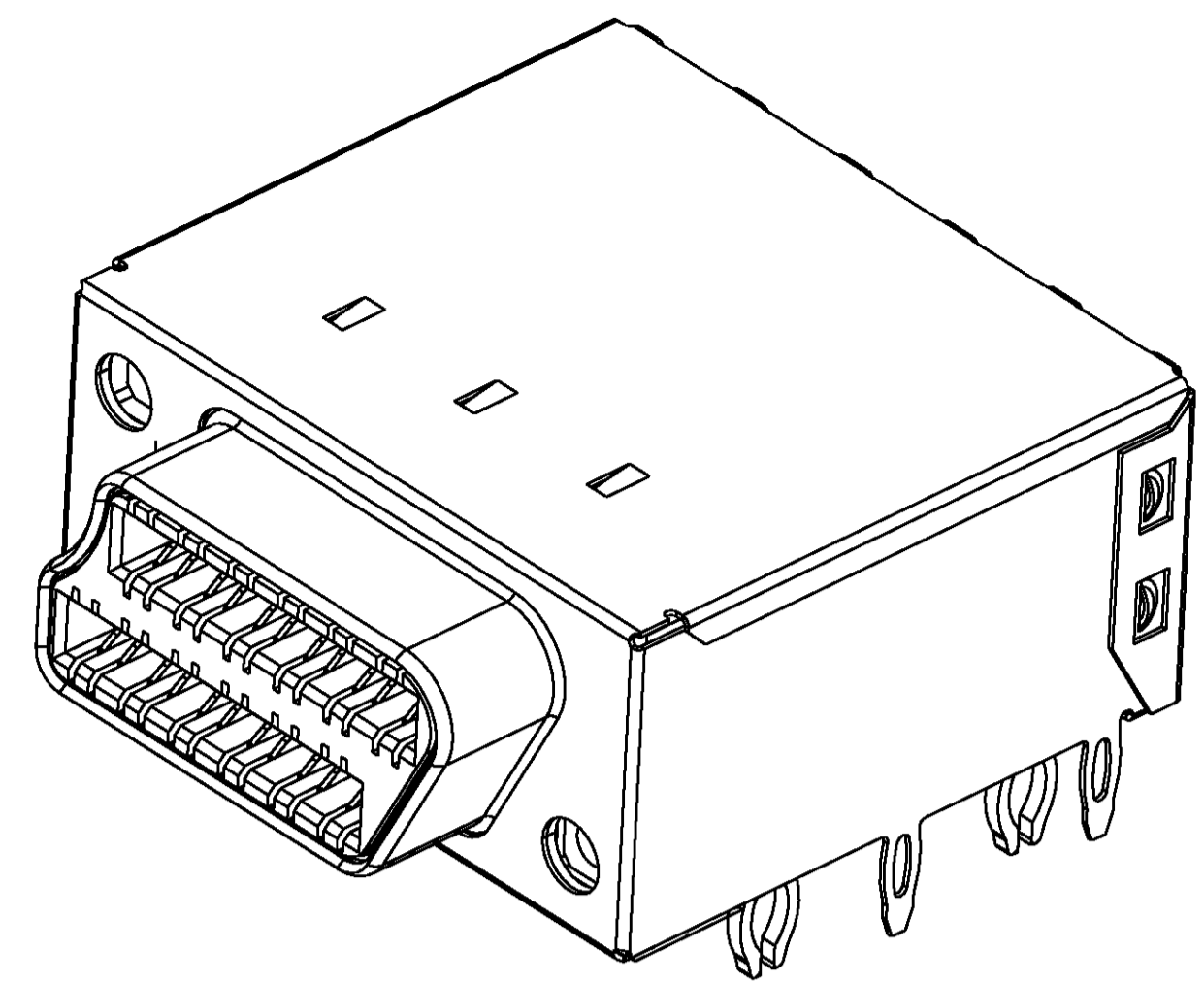

1761715-2
PRESS-FIT VERSION
SCALE 4:1

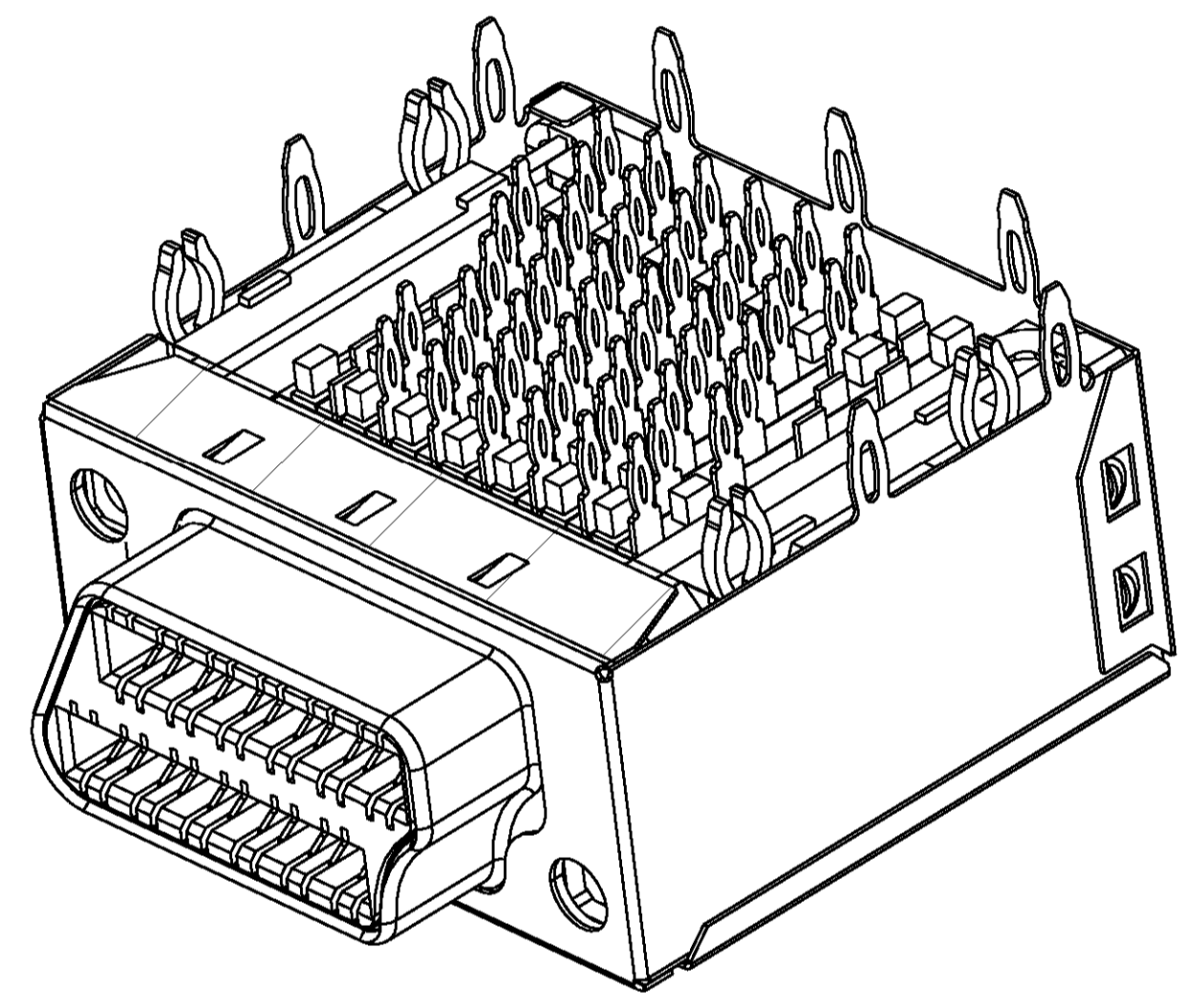

PRESS-FIT
BOTTOM VIEW
SCALE 4:1

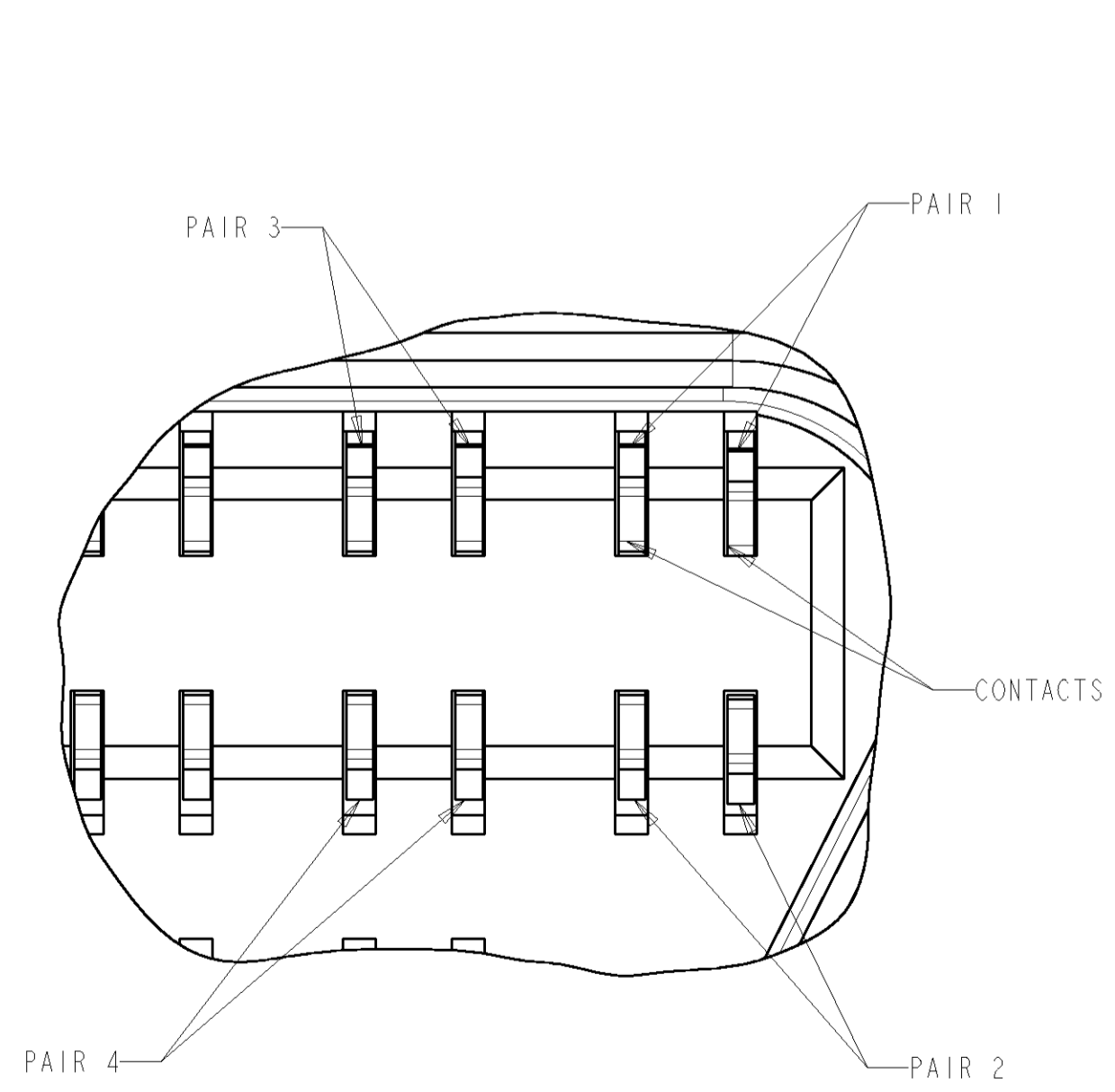

DETAIL A
SCALE 16:1

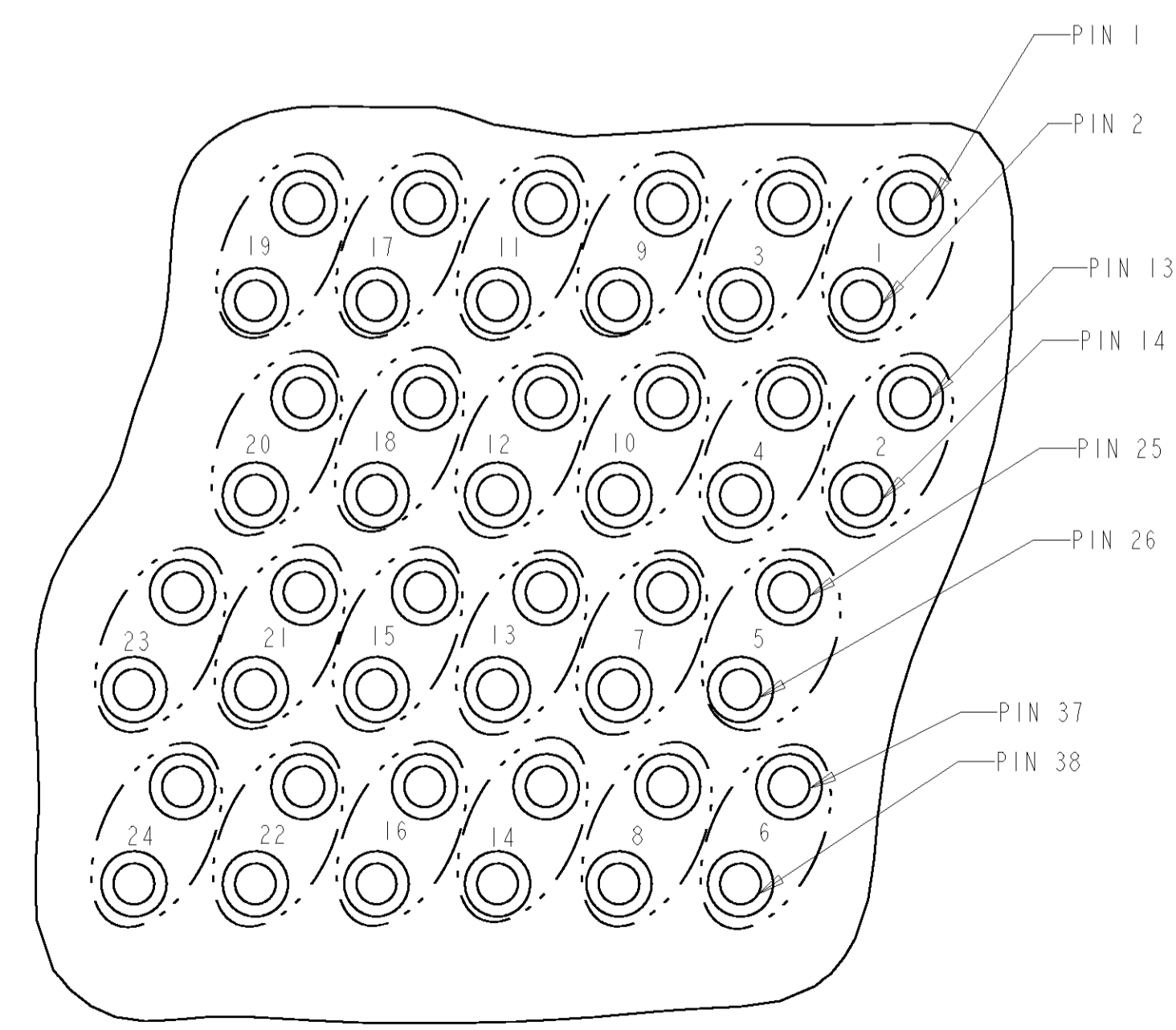

PROPOSED PAIR GROUPING

MODULAR PLUG AND RJ-21 PIN-OUT FOR USE IN 10/100/1000 BASE-T APPLICATIONS

| GIG ETHERNET PORT | PLUG POSN. | COLOR | 10/100 ETHERNET PORT | PLUG POSN. | COLOR | RJ-21 PIN | MRJ 21 PIN | MRJ 21 PAIR NUM | |
|-------------------|------------|---------|----------------------|------------|---------|-----------|------------|-----------------|----|
| 1 | 5 | WHT/BLU | 1 | 1 | WHT/BLU | 26 | 1 | 1 | |
| | 4 | BLU/WHT | | 2 | BLU/WHT | 1 | 2 | | |
| | 3 | WHT/ORG | | 3 | WHT/ORN | 27 | 13 | 2 | |
| | 6 | ORG/WHT | | 6 | ORN/WHT | 2 | 14 | | |
| | 2 | 1 | WHT/GRN | 2 | 1 | WHT/GRN | 28 | 3 | 3 |
| | | 2 | GRN/WHT | | 2 | GRN/WHT | 3 | 4 | |
| | | 7 | WHT/BRN | | 3 | WHT/BRN | 29 | 15 | 4 |
| | | 8 | BRN/WHT | | 6 | BRN/WHT | 4 | 16 | |
| 3 | | 5 | WHT/GRY | 3 | 1 | WHT/GRY | 30 | 25 | 5 |
| | | 4 | GRY/WHT | | 2 | GRY/WHT | 5 | 26 | |
| | | 3 | RED/BLU | | 3 | RED/BLU | 31 | 37 | 6 |
| | | 6 | BLU/RED | | 6 | BLU/RED | 6 | 38 | |
| | 4 | 1 | RED/ORG | 4 | 1 | RED/ORN | 32 | 27 | 7 |
| | | 2 | ORG/RED | | 2 | ORN/RED | 7 | 28 | |
| | | 7 | RED/GRN | | 3 | RED/GRN | 33 | 39 | 8 |
| | | 8 | GRN/RED | | 6 | GRN/RED | 8 | 40 | |
| 5 | | 5 | RED/BRN | 5 | 1 | RED/BRN | 34 | 5 | 9 |
| | | 4 | BRN/RED | | 2 | BRN/RED | 9 | 6 | |
| | | 3 | RED/GRY | | 3 | RED/GRAY | 35 | 17 | 10 |
| | | 6 | GRY/RED | | 6 | GRY/RED | 10 | 18 | |
| | 6 | 1 | BLK/BLU | 6 | 1 | BLK/BLU | 36 | 7 | 11 |
| | | 2 | BLU/BLK | | 2 | BLU/BLK | 11 | 8 | |
| | | 7 | BLK/ORG | | 3 | BLK/ORN | 37 | 19 | 12 |
| | | 8 | ORG/BLK | | 6 | ORN/BLK | 12 | 20 | |
| 7 | | 5 | BLK/GRN | 7 | 1 | BLK/GRN | 38 | 29 | 13 |
| | | 4 | GRN/BLK | | 2 | GRN/BLK | 13 | 30 | |
| | | 3 | BLK/BRN | | 3 | BLK/BRN | 39 | 41 | 14 |
| | | 6 | BRN/BLK | | 6 | BRN/BLK | 14 | 42 | |
| | 8 | 1 | BLK/GRY | 8 | 1 | BLK/GRY | 40 | 31 | 15 |
| | | 2 | GRY/BLK | | 2 | GRY/BLK | 15 | 32 | |
| | | 7 | YEL/BLU | | 3 | YEL/BLU | 41 | 43 | 16 |
| | | 8 | BLU/YEL | | 6 | BLU/YEL | 16 | 44 | |
| 9 | | 5 | YEL/ORG | 9 | 1 | YEL/ORN | 42 | 9 | 17 |
| | | 4 | ORG/YEL | | 2 | ORN/YEL | 17 | 10 | |
| | | 3 | YEL/GRN | | 3 | YEL/GRN | 43 | 21 | 18 |
| | | 6 | GRN/YEL | | 6 | GRN/YEL | 18 | 22 | |
| | 10 | 1 | YEL/BRN | 10 | 1 | YEL/BRN | 44 | 11 | 19 |
| | | 2 | BRN/YEL | | 2 | BRN/YEL | 19 | 12 | |
| | | 7 | YEL/GRY | | 3 | YEL/GRY | 45 | 23 | 20 |
| | | 8 | GRY/YEL | | 6 | GRY/YEL | 20 | 24 | |
| 11 | | 5 | VIO/BLU | 11 | 1 | VIO/BLU | 46 | 33 | 21 |
| | | 4 | BLU/VIO | | 2 | BLU/VIO | 21 | 34 | |
| | | 3 | VIO/ORG | | 3 | VIO/ORN | 47 | 45 | 22 |
| | | 6 | ORG/VIO | | 6 | ORN/VIO | 22 | 46 | |
| | 12 | 1 | VIO/GRN | 12 | 1 | VIO/GRN | 48 | 35 | 23 |
| | | 2 | GRN/VIO | | 2 | GRN/VIO | 23 | 36 | |
| | | 7 | VIO/BRN | | 3 | VIO/BRN | 49 | 47 | 24 |
| | | 8 | BRN/VIO | | 6 | BRN/VIO | 24 | 48 | |

| | | | | | | | |
|----------------------|---------|--|---------|------------------------------|----------------------------|---|--|
| DIMENSIONS: | | TOLERANCES UNLESS OTHERWISE SPECIFIED: | | DWG: R. GRZYBOWSKI 03FEB2006 | | Tyco Electronics Harrisburg, PA 17105-3608 | |
| mm | 0 PLC ± | 1 PLC ±0.10 | 3 PLC ± | 4 PLC ± | APVD: M. YEOMANS 03FEB2006 | NAME: ASSEMBLY, RECEPTACLE, 48 POSITION, MR J21 | |
| MATERIAL: SEE NOTE 1 | | FINISH: - | | PRODUCT SPEC: 108-2064 | | RESTRICTED TO: - | |
| CUSTOMER DRAWING | | SCALE: 6:1 | | SHEET: 2 OF 4 | | REV: D | |

| LOC | | DIST | | REVISIONS | | | |
|-----|-----|-------------|------|-----------|------|--|--|
| P | LTR | DESCRIPTION | DATE | DNW | APVD | | |
| - | - | SEE SHEET 1 | - | - | - | | |

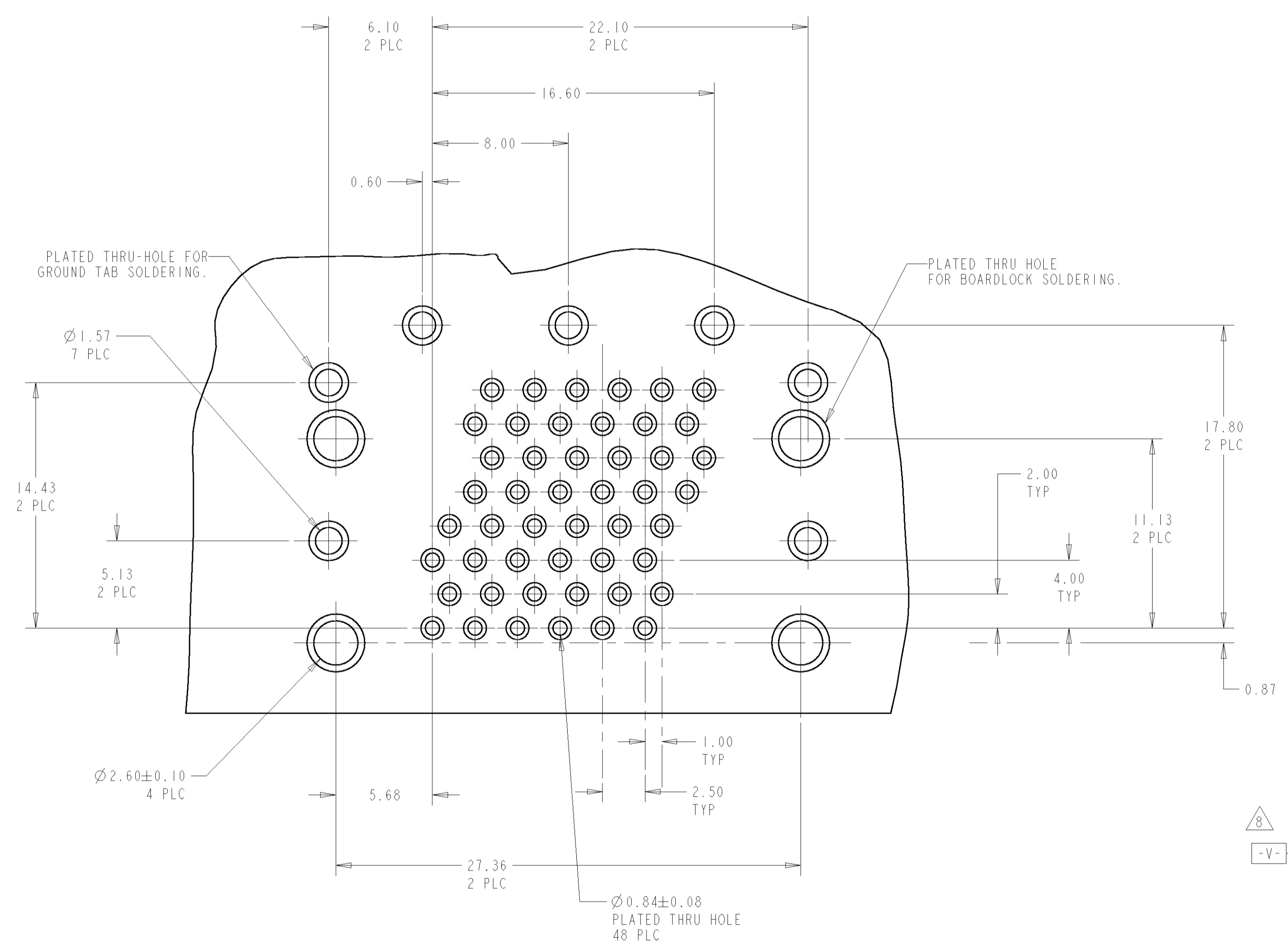

PCB LAYOUT
 FOR SOLDER TAILS
 COMPONENT SIDE
 SCALE 5:1

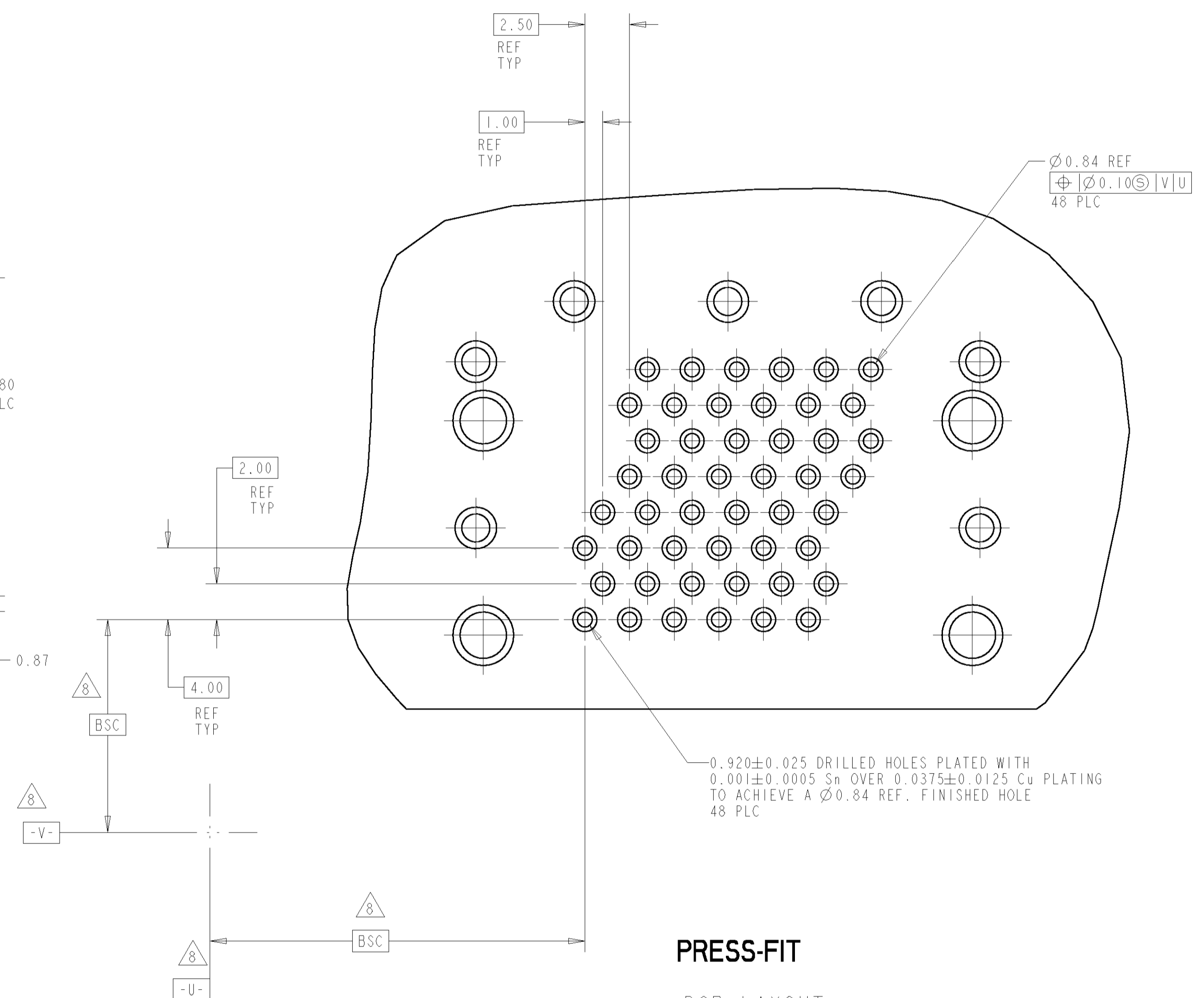

PRESS-FIT
 PCB LAYOUT
 SAME AS -1 EXCEPT AS NOTED
 SCALE 5:1

| | | | | | | | |
|----------------------|---|--|-------|-------------------------------|------------------|---|--|
| DIMENSIONS: | | TOLERANCES UNLESS OTHERWISE SPECIFIED: | | DWN: B. GRZYBOWSKI 03FEB2006 | | Tyco Electronics Tyco Electronics Harrisburg, PA 17105-3608 | |
| mm | Ø | 0 PLC | ± | ENR: M. YEOMANS 03FEB2006 | NAME | ASSEMBLY, RECEPTACLE, 48 POSITION, MR J21 | |
| | | 1 PLC | ±0.1 | APVD: S. FLICKINGER 03FEB2006 | PRODUCT SPEC | 108-2064 | |
| | | 2 PLC | ±0.10 | | APPLICATION SPEC | - | |
| | | 3 PLC | ± | | WEIGHT | - | |
| | | 4 PLC | ± | | FINISH | - | |
| | | ANGLES | ± | | SIZE | A 00779 C=1761715 | |
| | | | ± | | SCALE | 6:1 | |
| MATERIAL: SEE NOTE 1 | | | | | CUSTOMER DRAWING | SHEET 3 OF 4 REV D | |

| LOC | DIST | REV | DATE | BY | APPD |
|-----|------|-----|------|----|------|
| AA | 00 | | | | |

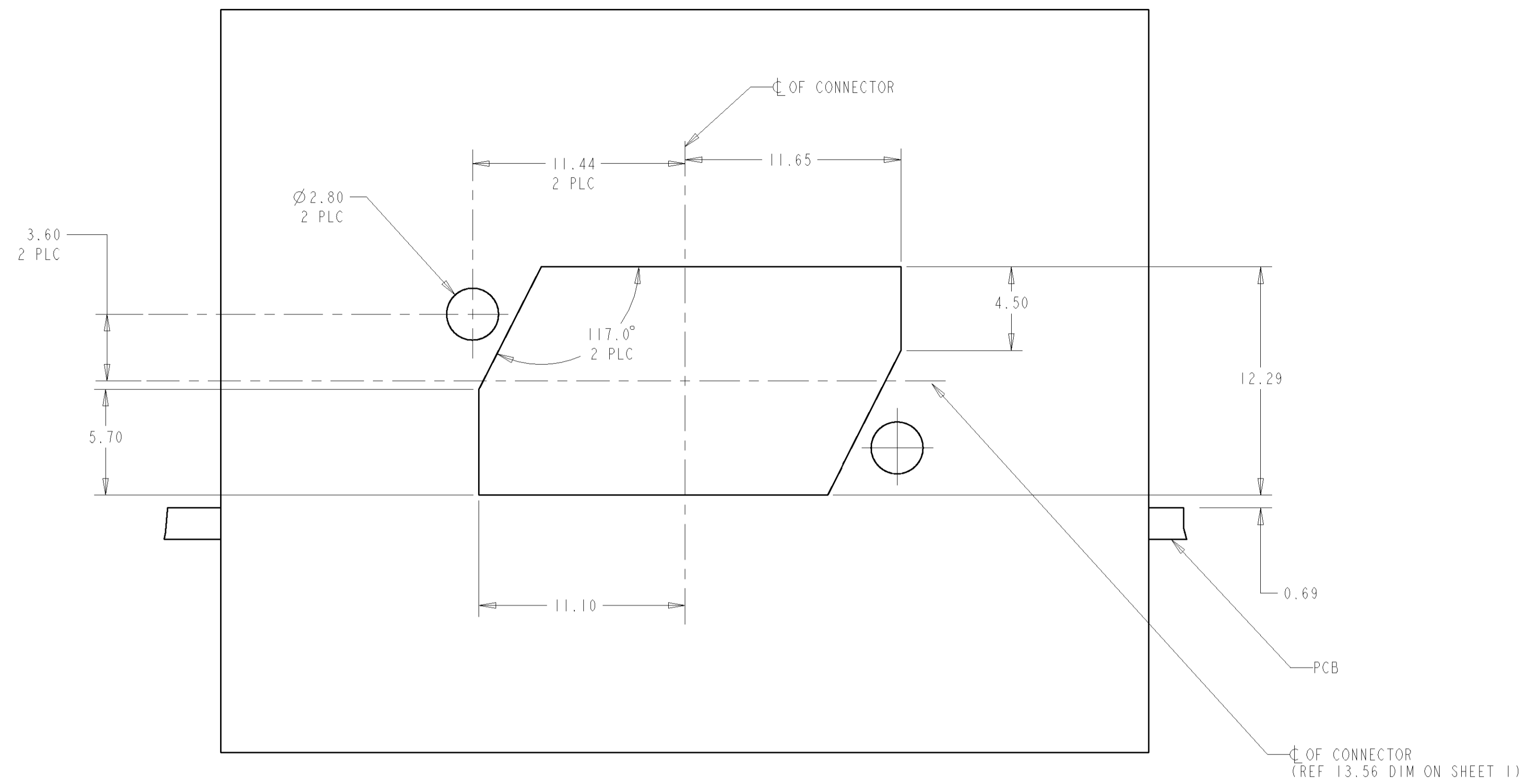

RECOMMENDED PANEL CUTOUT (NO PANEL GROUNDS)
 SCALE 5:1

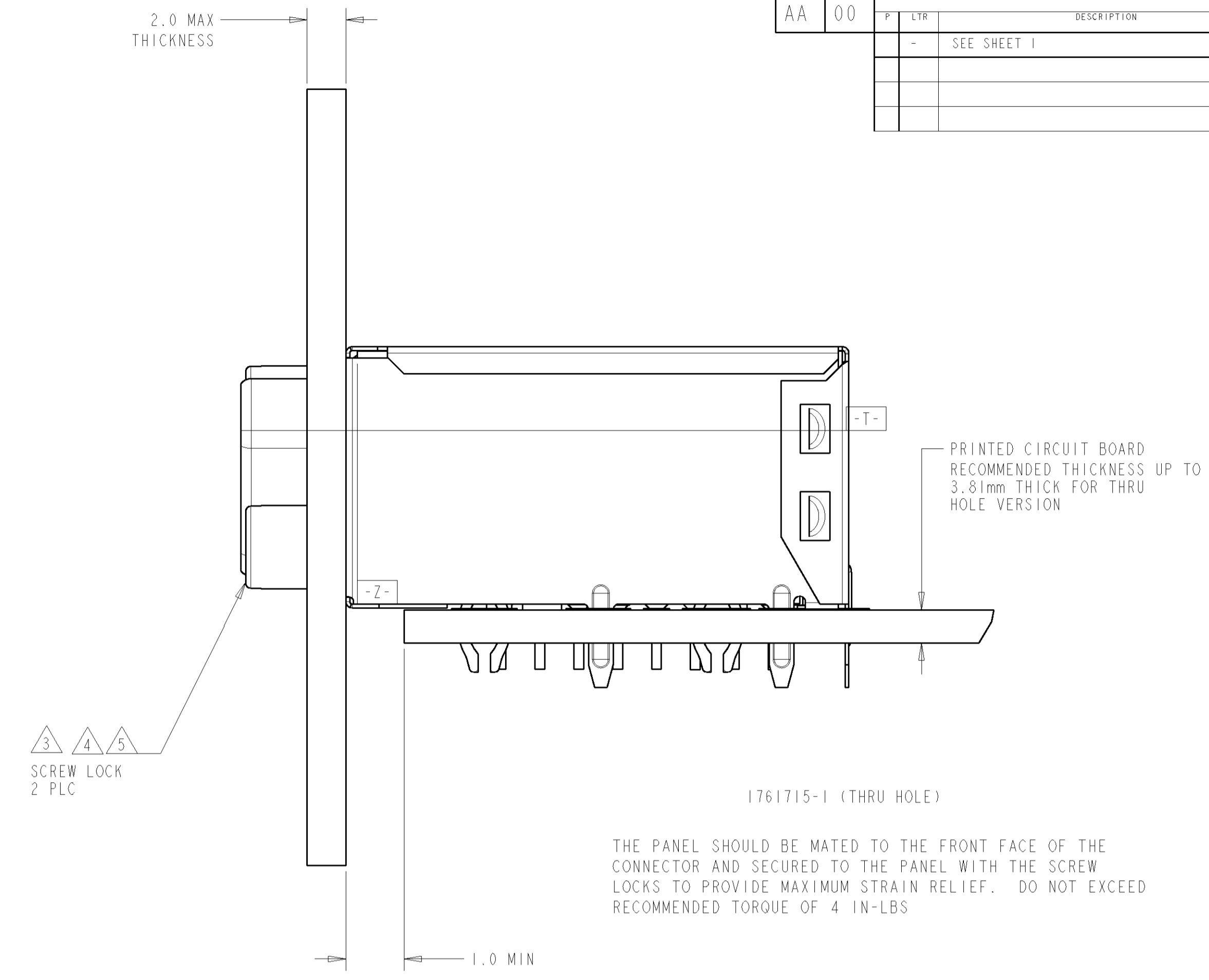

THE PANEL SHOULD BE MATED TO THE FRONT FACE OF THE CONNECTOR AND SECURED TO THE PANEL WITH THE SCREW LOCKS TO PROVIDE MAXIMUM STRAIN RELIEF. DO NOT EXCEED RECOMMENDED TORQUE OF 4 IN-LBS

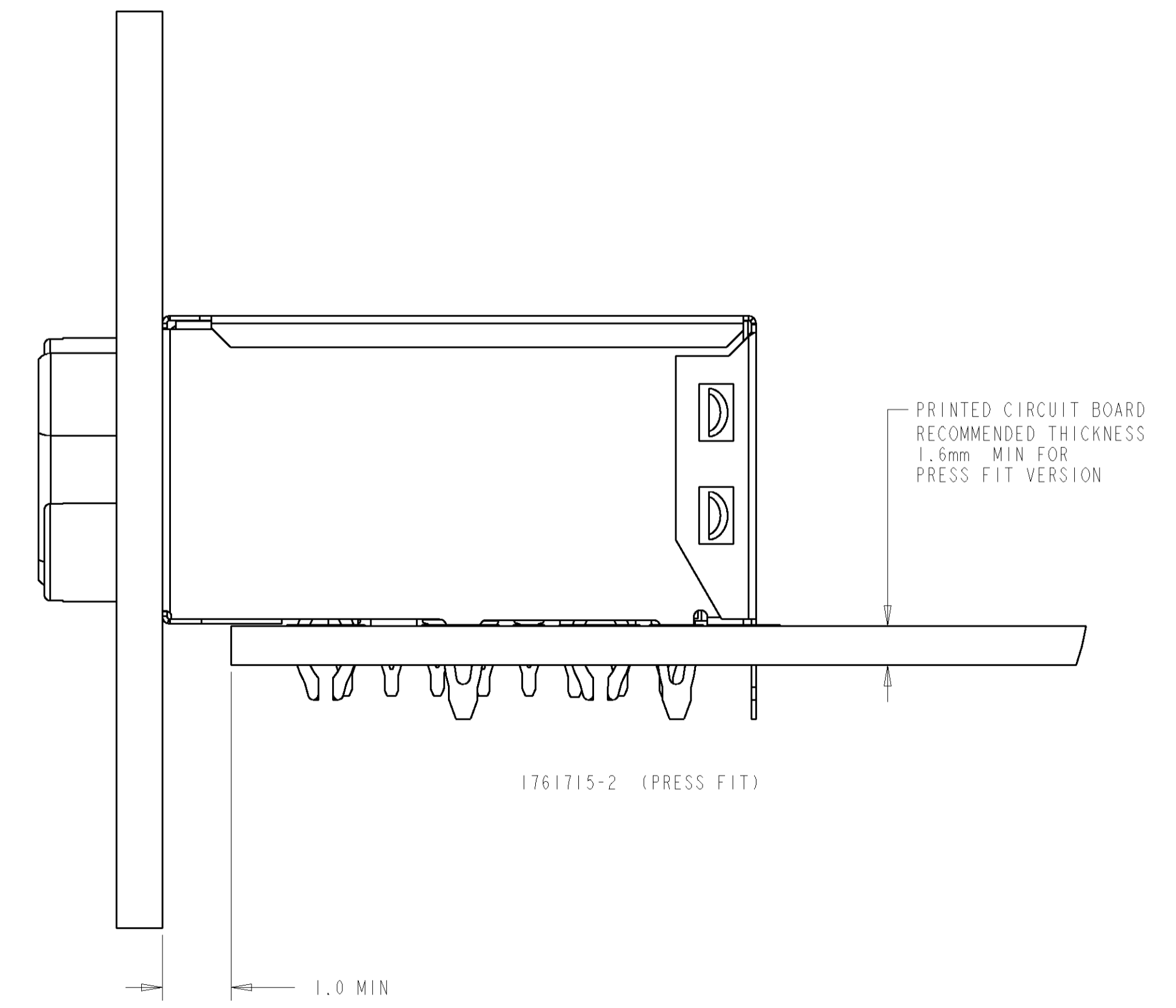

| | | | | | | | |
|---------------------------------|--|--|--|--|--|--|--|
| DIMENSIONS: mm | | TOLERANCES UNLESS OTHERWISE SPECIFIED: 0 PLC ± 1 PLC ±0.1 2 PLC ±0.10 3 PLC ± 4 PLC ± ANGLES ± | | DWN R. GRZYBOWSKI 03FEB2006 ENR M. YEOMANS 03FEB2006 APPD S. FLICKINGER 03FEB2006 | | Tyco Electronics Harrisburg, PA 17105-3608 | |
| MATERIAL SEE NOTE 1 FINISH - | | WEIGHT - CUSTOMER DRAWING | | PRODUCT SPEC 108-2064 APPLICATION SPEC - SIZE CAGE CODE DRAWING NO A1 00779 C-1761715 | | NAME ASSEMBLY RECEPTACLE, 48 POSITION, MR J21 RESTRICTED TO SCALE 6:1 SHEET 4 OF 4 REV D | |

X-ON Electronics

Largest Supplier of Electrical and Electronic Components

Click to view similar products for [Modular Connectors](#) / [Ethernet Connectors](#) category:

Click to view products by [TE Connectivity](#) manufacturer:

Other Similar products are found below :

[8949-H88/06BLKA/SN](#) [74441-0010/BKN](#) [PHP-6P6C-5](#) [GAX-3-66](#) [GAX-8-62](#) [GDCX-PN-66](#) [GLX-A-44](#) [GLX-N-1010M-BLK](#) [GMX-SMT4-N-88](#) [GSGX-N-2-88](#) [GSGX-N-4-88](#) [GSX-NS2-88-3.05](#) [GSX-NS-88-3.68](#) [PT-108A-8C-UL](#) [PTS-J531-8CS-50UL](#) [A-2014-0-4](#) [GWLX-S9-88-YG](#) [DC-1021-8-WH-6](#) [1300530003](#) [1324640-4](#) [RJ11FTVC2G](#) [RJ11FTVC2N](#) [RJFTVX2SA1G](#) [132764-001](#) [1413235](#) [MPS88RX-5000](#) [E5288-S000K3-L](#) [155302-001](#) [AX101050](#) [AX101063](#) [AX101065](#) [AX101072](#) [AX101307](#) [AX101315](#) [AX101318](#) [AX102271](#) [AX102288](#) [AX102651](#) [AX102660](#) [J0012D21NL](#) [J0026D01ENL](#) [PC4D0018P](#) [8949-B88/6](#) [2-6609208-5](#) [937-SP-3088-2PC-A192](#) [303066VFL](#) [303068V](#) [303088LFLSA](#) [303088SBL](#) [30-8603](#)