

| REVISIONS | | | | | |
|-----------|-----------|----|-----|------|-----------------------|
| REV. | DATE | BY | CHK | APPV | DESCRIPTION |
| P8 | 25OCT2016 | KF | HY | | REVISED ECR-16-003344 |

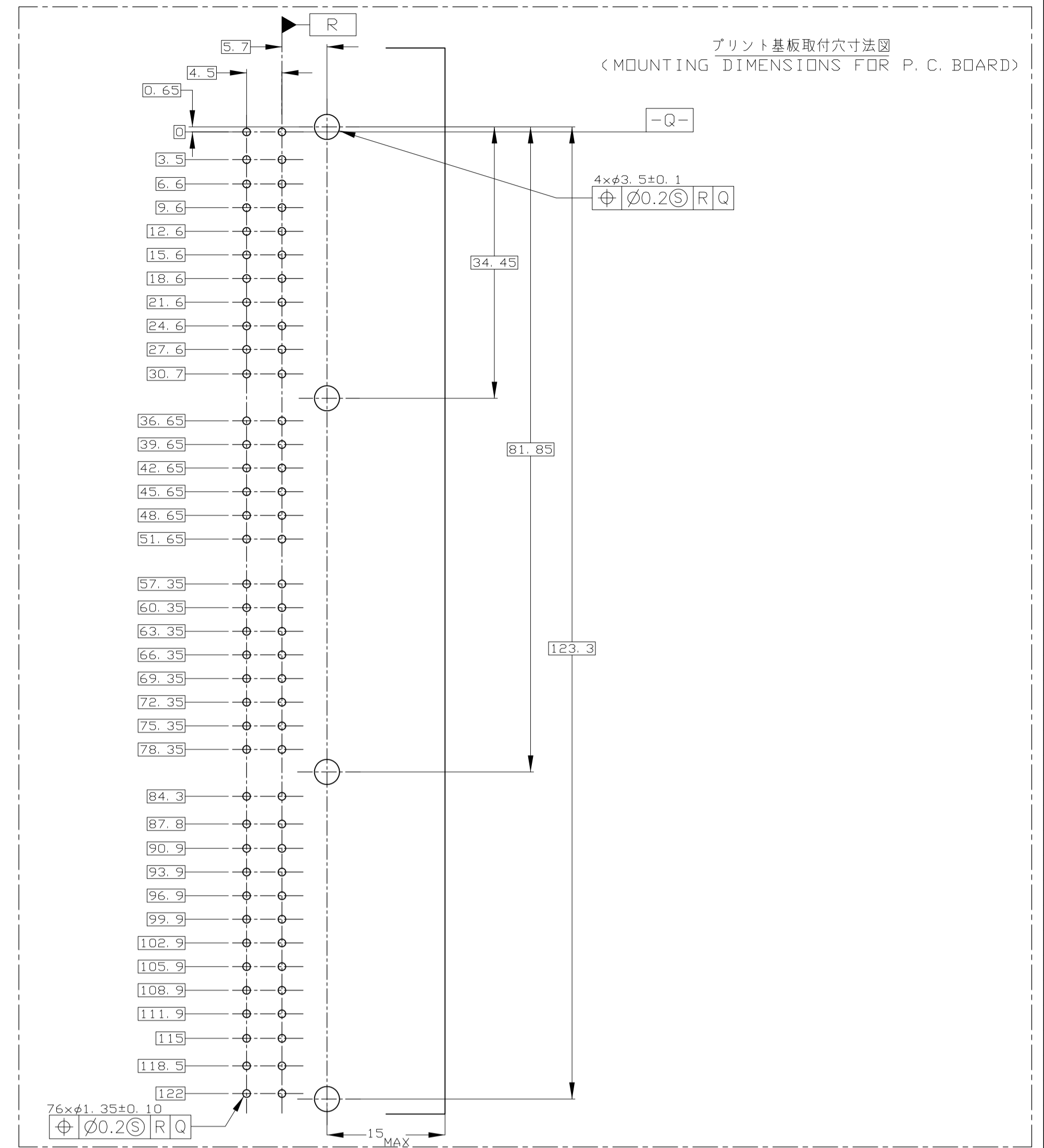

- △ X 面から2mmの範囲で測定
- 2. 嵌合相手ハウジング型: 174516, 174515, 174514, 174913
917992, 917989, 917981, 917975
- 3. 推奨取付ねじ: JIS B1115, B1122 タッピングねじ, なべ2種
呼び径3, 長さ6mm以下 (締付けトルク: 0.4N-cm以下)
- 4. 適用製品規格番号: 108-5280, 108-5342
- △ 回路番号: 右図参照のこと
- パワ回路 ① ~ ⑩
- シグナル回路 ⑪ ~ ⑯
- △ 適用製品規格のグラフィックス及びIDマークを
カマネットマークにて表示

- △ MUST BE KEPT BETWEEN X AND 2
- 2 THE MATING PLUG HSG. PART NUMBER; 174516, 174515, 174514, 174913
917992, 917989, 917981, 917975
- 3 RECOMMENDED MOUNTING SCREW; 3mmDIA, 6mmLENGTH MAX.)
PAN HEAD, CLASS 2 TAPPING SCREW SPECIFIED IN JIS
B1115, B1122
(TIGHTENING TORQUE; 0.4N-cm MAX.)
- 4 APPLICABLE PRODUCT SPEC NO. 108-5280, 108-5342
- △ CIRCUIT NUMBER
- POWER CIRCUIT NO. ① ~ ⑩
- SIGNAL CIRCUIT NO. ⑪ ~ ⑯
- △ INDICATED PREFIX AND ID MARK OF PRODUCT P/N BY HOT MARK

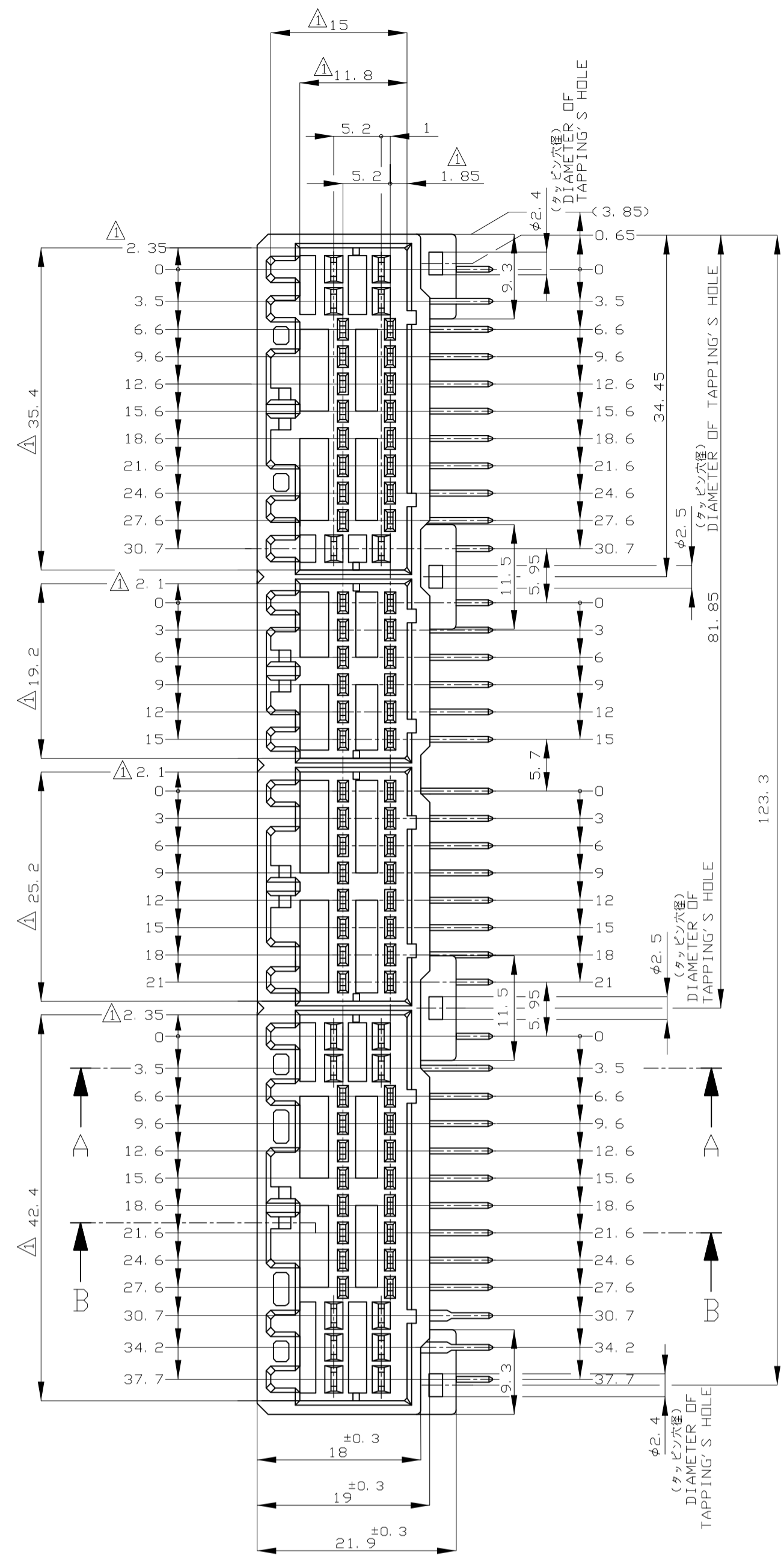
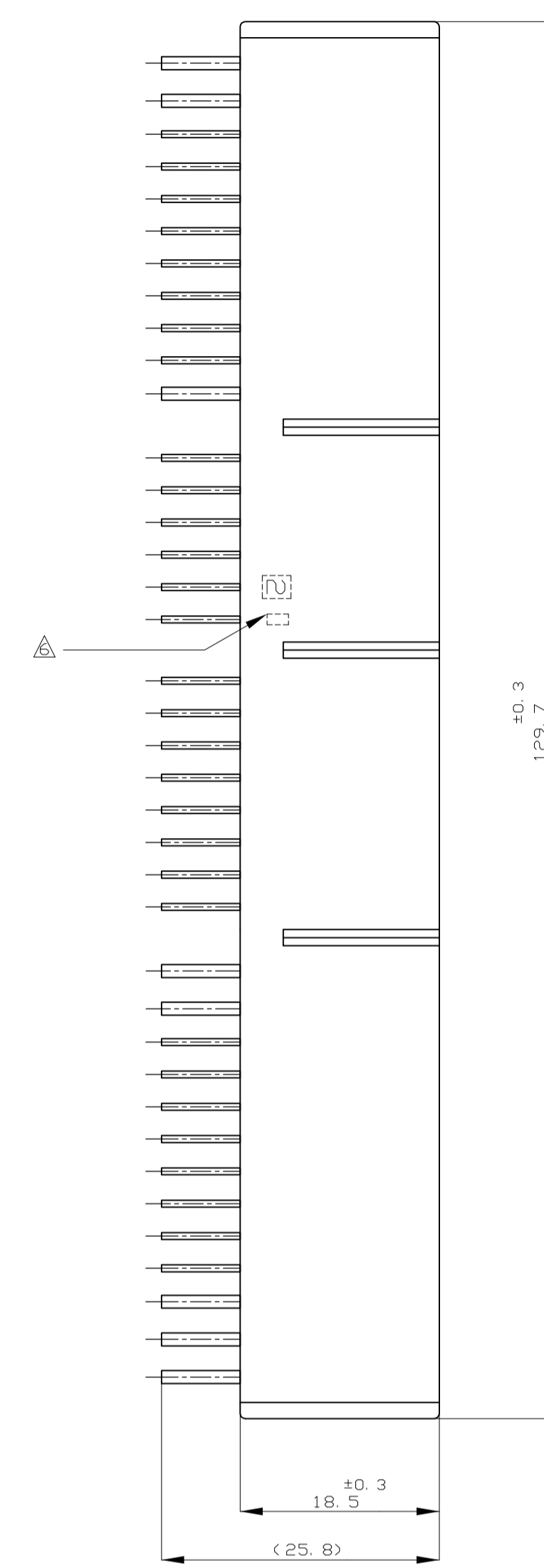
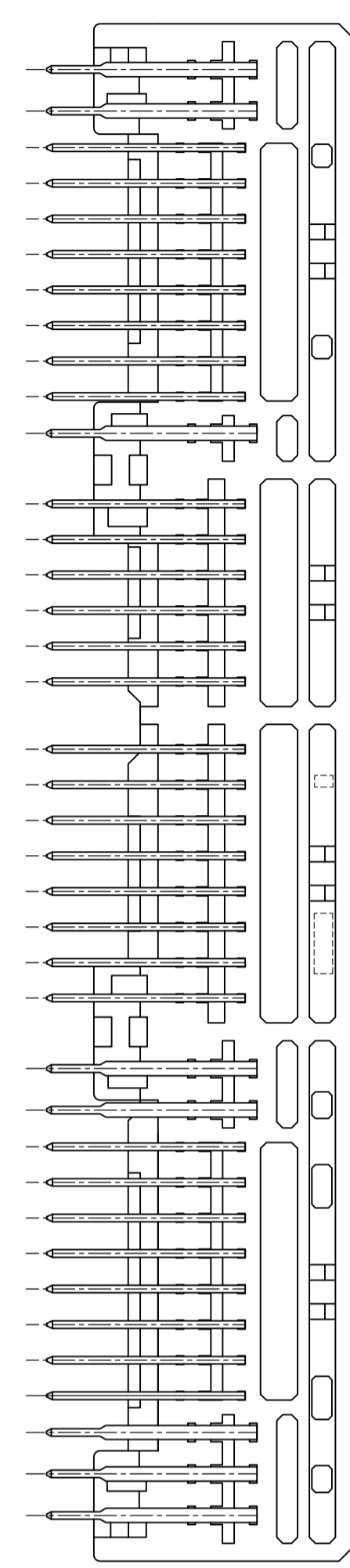
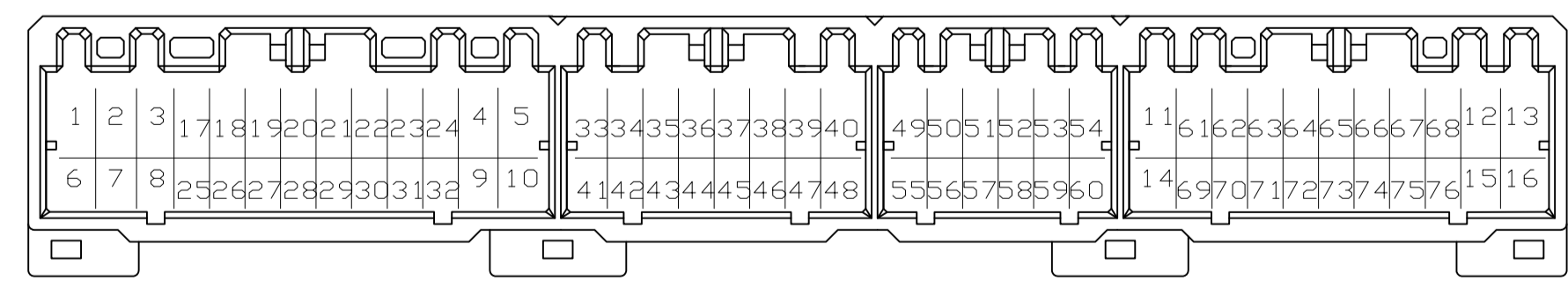
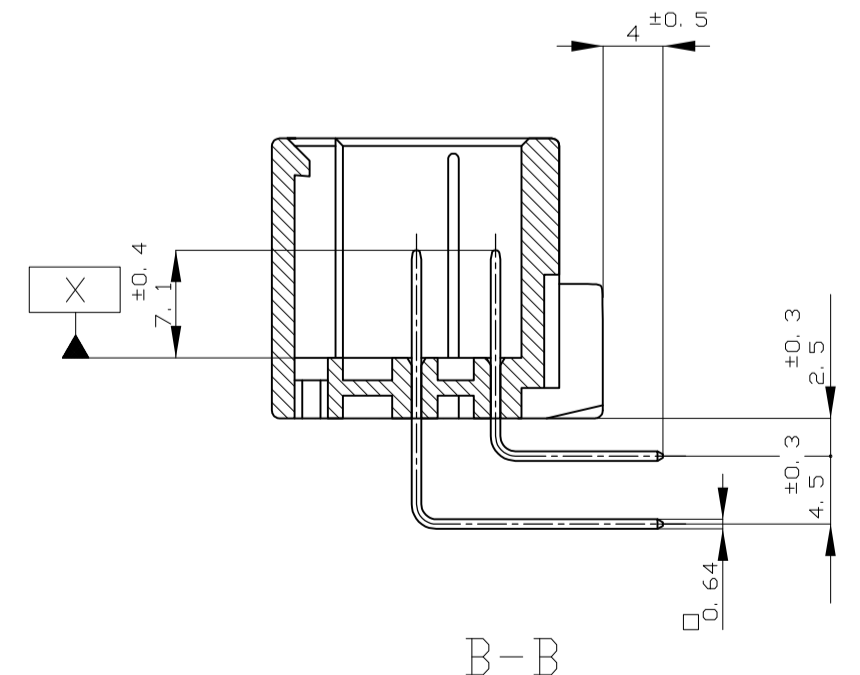
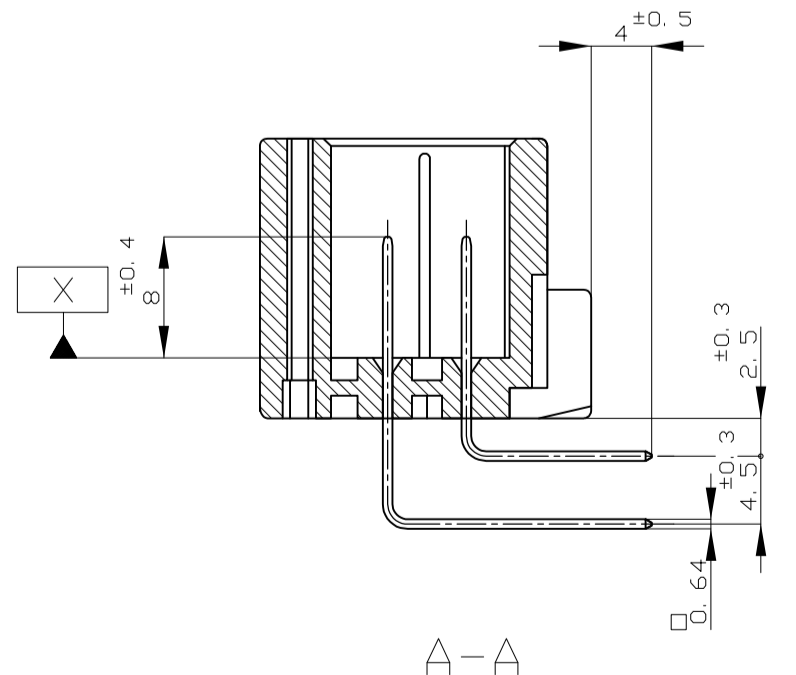

| NO. | FINISH | SELECTIVE GOLD | PRE-TIN | SIZE | COLOR | PART NUMBER |
|-----|-----------------------|-----------------------------|--------------|--|------------|-------------|
| 56 | SELECTIE-TIN (MATTE) | SELECTIVE GOLD x 14 | PRE-TIN x 62 | 24, 31, 39, 40 42~50, 55 | GRAY | 6-5178780-6 |
| 55 | SELECTIE-TIN (MATTE) | SELECTIVE GOLD x 28 | PRE-TIN x 48 | 25~32, 35~40 43~52, 55~58 | BLACK | 5-5178780-2 |
| 55 | SELECTIE-TIN (MATTE) | SELECTIVE GOLD x 28 | PRE-TIN x 48 | 25~32, 35~40 43~52, 55~58 | NATURAL | 5-5178780-1 |
| 54 | SELECTIE-TIN (MATTE) | SELECTIVE GOLD x 28 | PRE-TIN x 48 | 23, 24, 31~51 55~57, 63, 64 | YELLOW | 4-5178780-7 |
| 54 | SELECTIE-TIN (MATTE) | SELECTIVE GOLD x 8 | PRE-TIN x 68 | 49, 50, 52, 53, 68 70, 71, 74 | GRAY | 4-5178780-6 |
| 53 | SELECTIE-TIN (MATTE) | SELECTIVE GOLD x 12 | PRE-TIN x 64 | 26~32, 40, 49~52 | YELLOW | 3-5178780-7 |
| 53 | SELECTIE-TIN (MATTE) | SELECTIVE GOLD x 60 | PRE-TIN x 16 | 17~76 | GRAY | 3-5178780-6 |
| 52 | SELECTIE-TIN (MATTE) | SELECTIVE GOLD x 24 | PRE-TIN x 52 | 23, 24, 31, 33~49 55, 63, 64 | YELLOW | 2-5178780-7 |
| 52 | SELECTIE-TIN (MATTE) | SELECTIVE GOLD x 19 | PRE-TIN x 57 | 22, 24, 31, 34, 39~40 42~48, 49, 50, 55, 56, 63, 64 | GRAY | 2-5178780-6 |
| △ 8 | TIN-LEAD | SELECTIVE GOLD x 7 | PRE-TIN x 69 | 49, 50, 52, 53, 68 70, 74 | GRAY | 8-178780-6 |
| △ 7 | TIN-LEAD | SELECTIVE GOLD x 10 | PRE-TIN x 66 | 24, 31, 39, 44~47 49, 55, 64 | GRAY | 7-178780-6 |
| △ 6 | TIN-LEAD | SELECTIVE GOLD x 14 | PRE-TIN x 62 | 24, 31, 39, 40 42~50, 55 | GRAY | 6-178780-6 |
| △ 5 | TIN-LEAD | SELECTIVE GOLD x 28 | PRE-TIN x 48 | 25~32, 35~40 43~52, 55~58 | YELLOW | 5-178780-7 |
| △ 5 | TIN-LEAD | SELECTIVE GOLD x 28 | PRE-TIN x 48 | 25~32, 35~40 43~52, 55~58 | BLACK | 5-178780-2 |
| △ 5 | TIN-LEAD | SELECTIVE GOLD x 28 | PRE-TIN x 48 | 25~32, 35~40 43~52, 55~58 | NATURAL | 5-178780-1 |
| △ 4 | TIN-LEAD | SELECTIVE GOLD x 28 | PRE-TIN x 48 | 23, 24, 31~51 55~57, 63, 64 | YELLOW | 4-178780-7 |
| △ 4 | TIN-LEAD | SELECTIVE GOLD x 8 | PRE-TIN x 68 | 49, 50, 52, 53, 68 70, 71, 74 | GRAY | 4-178780-6 |
| △ 3 | TIN-LEAD | SELECTIVE GOLD x 60 | PRE-TIN x 16 | 17~76 | GRAY | 3-178780-6 |
| △ 2 | TIN-LEAD | SELECTIVE GOLD x 24 | PRE-TIN x 52 | 23, 24, 31, 33~49 55, 63, 64 | YELLOW | 2-178780-7 |
| △ 0 | TIN-LEAD | SELECTIVE GOLD x 76 | PRE-TIN x 76 | - | LIGHT GRAY | 178780-9 |
| △ 1 | SELECTIVE-TIN (MATTE) | SELECTIVE-TIN (BRIGHT) x 76 | PRE-TIN x 76 | - | NATURAL | 178780-3 |
| △ 0 | SELECTIVE-TIN (MATTE) | SELECTIVE-TIN (BRIGHT) x 76 | PRE-TIN x 76 | - | NATURAL | 178780-1 |

THIS DRAWING IS A CONTROLLED DOCUMENT.

DIMENSIONS: mm

TOLERANCES UNLESS OTHERWISE SPECIFIED

GENERAL TOLERANCE

MATERIAL: HOUSING: PBT CONTACT: BRASS

FINISH: 仕上

SEE TABLE

WEIGHT: 23.8 g

SCALE: 2:1

SHEET: 1 of 1

REV: P8

STE TE Connectivity

76POS CAP HOUSING ASSY
 .040/.070 SERIES HYBRID I/O CONN. (NON FLANGE)

00779 178780

X-ON Electronics

Largest Supplier of Electrical and Electronic Components

Click to view similar products for [Automotive Connectors](#) category:

Click to view products by [TE Connectivity](#) manufacturer:

Other Similar products are found below :

[003-018-000](#) [60403001](#) [60993906-B](#) [M902-2131](#) [M902-2161](#) [M902-2344](#) [72.330.1035.1](#) [73.353.4028.0](#) [F119300-B](#) [F166900](#) [F258300-B](#)
[F358300-B](#) [F407400](#) [F444110](#) [F487000](#) [F509500B-B](#) [827153-1](#) [8N1515-32-24P](#) [9-1326729-8](#) [925474-1](#) [928905-1](#) [964562-4](#) [968782-1](#)
[GT17SA-8DS-HU](#) [98891-1012](#) [98947-1016](#) [12004147](#) [12004475-L](#) [12010290](#) [12015454](#) [12020219-B](#) [12041318-B](#) [12052225-L](#) [12052466](#)
[12064869](#) [12004327-B](#) [12015308](#) [12015384](#) [12015909](#) [1-21030-1](#) [12041254](#) [12041318](#) [12047946-B](#) [12047957](#) [12047957-L](#) [12059473](#)
[12066261](#) [12110546](#) [12110546-B](#) [12131792](#)