

NUMBER C-179464

三角度 (3-ANGLE PROJECTION)

METRIC

PRINT DIM. DIMENSIONS IN MM. DO NOT SCALE PRINT

PRINT DIST.

- 注:
1. 通用製品規格: 108-5410
 2. 通用コンタクト型番
タブ・コンタクト: 177917-□ (#20-#16AWG)
177916-□ (#26-#22AWG)
 3. 嵌合相手側製品型番
プラグ・ハウジング: 177899-□
リセ・コンタクト: 177915-□ (#20-#16AWG)
177914-□ (#26-#22AWG)
 4. 通用プレート型番: 177919-□
 5. 取扱説明書: 411-5638
- 表1参照
8. PART 5-179464-1 COMPLY WITH GLOW WIRE REQUIREMENT FOR PARTS OF NON-METALLIC MATERIAL SUPPORTING A CURRENT-CARRYING CONNECTION DETAILED IN IEC 60335-1, SECTION 30 (GWT)
 9. APPLICATION SPEC: 114-5175



表1 (TABLE 1)

トレードマーク (TRADE MARK)	生産場所 (MANUFACTURING PLACE)
— AMP OR AMP	日本 (JAPAN)
—+ AMP OR AMP	中国 (CHINA(PRO))
· AMP OR AMP	韓国 (KOREA)



断面 "A"- "A" (SECT)

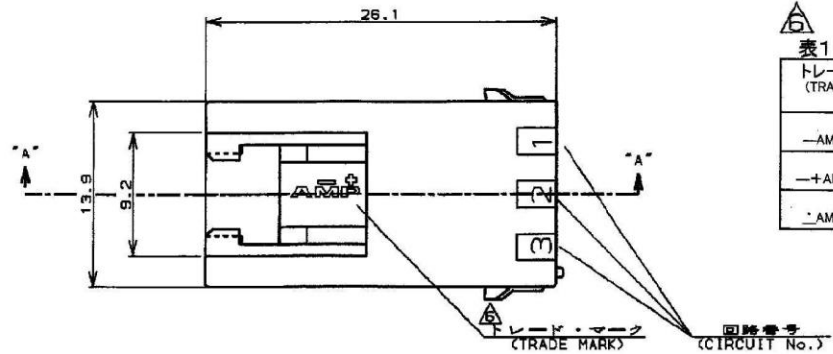
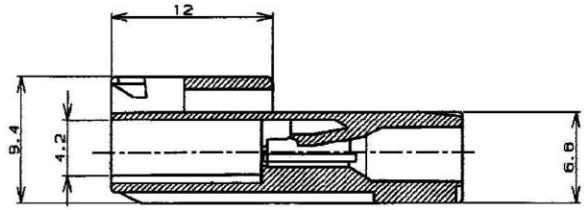
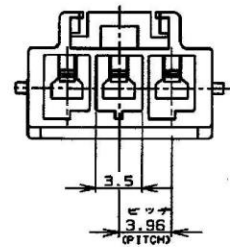
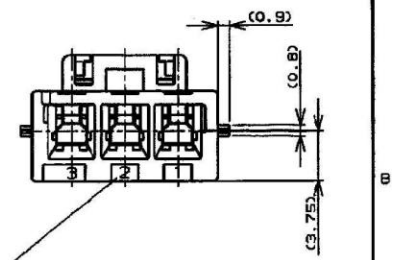

回路番号 (CIRCUIT No.)

- NOTES,
1. PRODUCT SPEC, 108-5410
 2. APPLICABLE CONTACT P/N
TAB CONTACT: 177917-□ (#20-#16AWG)
177916-□ (#26-#22AWG)
 3. MATING CONN. P/N
PLUG H56: 177899-□
REC CONTACT: 177915-□ (#20-#16AWG)
177914-□ (#26-#22AWG)
 4. APPLICABLE PLATE P/N: 177919-□
 5. INSTRUCTION SHEET: 411-5638
 6. SEE TABLE 1
 7. ALL PARTS MEET RTI ELECTRICAL RATING OF 105C ACCORDING TO UL 1977

自然色 (NATURAL)	3	5-179464-1
黒 (BLACK)	↑	↑ -9
青 (BLUE)	↑	↑ -6
黄 (YELLOW)	↑	↑ -4
赤 (RED)	↓	↓ -2
自然色 (NATURAL)	3	179464-1
ハウジング色調 係数 (HOUSING COLOR) [Pos.]		型番 (P/N)

REV.	DESCRIPTION	BY	DATE	CHK.	DATE	DR.	DATE	DE.	DATE	APP.	DATE	SIZE	LOC	REV.	SHEET
C4	REVISED PER ECR-19-017851	SM	DZ	21NOV 2019								A3	J	C4	1 OF 1
C3	REVISED PER ECR-14-001994	A.Z	D.Z	11FEB '14											
C2	REVISED PER ECR-12-013854	A.Z	F.M	02AUG '12											
C1	REVISED PER ECO-11-005140	RK	HMR	01MAR '11											
LTR	変更 (REVISION RECORD)	DR	CHK	DATE											

STE TE Connectivity

CUSTOMER DRAWING

X-ON Electronics

Largest Supplier of Electrical and Electronic Components

Click to view similar products for [Headers & Wire Housings](#) category:

Click to view products by [TE Connectivity](#) manufacturer:

Other Similar products are found below :

[892-18-020-10-001101](#) [58102-G61-06LF](#) [582553-1](#) [0009485154](#) [009176003701906](#) [0050291907](#) [LY20-4P-DT1-P1E-BR](#) [02.125.8002.8](#)
[609-3404](#) [61062-3](#) [61082-181009](#) [622-3653LF](#) [63453-116](#) [636-1030](#) [636-1427](#) [636-3427](#) [636-4007](#) [641938-9](#) [641991-4](#) [644827-2](#) [65817-010LF](#) [65817-015LF](#) [65863-015LF](#) [66207-023LF](#) [67095-007LF](#) [67601157](#) [68645-018](#) [68648-049](#) [70.362.1628.0](#) [70-4210](#) [70-4226B](#) [70-4853B](#) [707-5020](#) [707-5028](#) [71.350.2428.0](#) [71918-208LF](#) [71961-016LF](#) [733-134](#) [733-162](#) [754199-000](#) [760-3052](#) [787-8014-00](#) [79531-3000](#)
[FCN-360C032-B](#) [FCN-367T-T012/H](#) [FCN-723D010/2](#) [80.063.4001.1](#) [800-90-001-10-001000](#) [800-90-010-10-002000](#) [801-43-002-10-013000](#)