

1

2

3

4

SCALA NON IMPERATIVA  
(DO NOT SCALE)  
DIMENSIONI IN  
DIMENSIONS IN mm

METRIC

PROIEZIONE EUROPEA  
EUROPEAN PROJECTION

VISTA da B

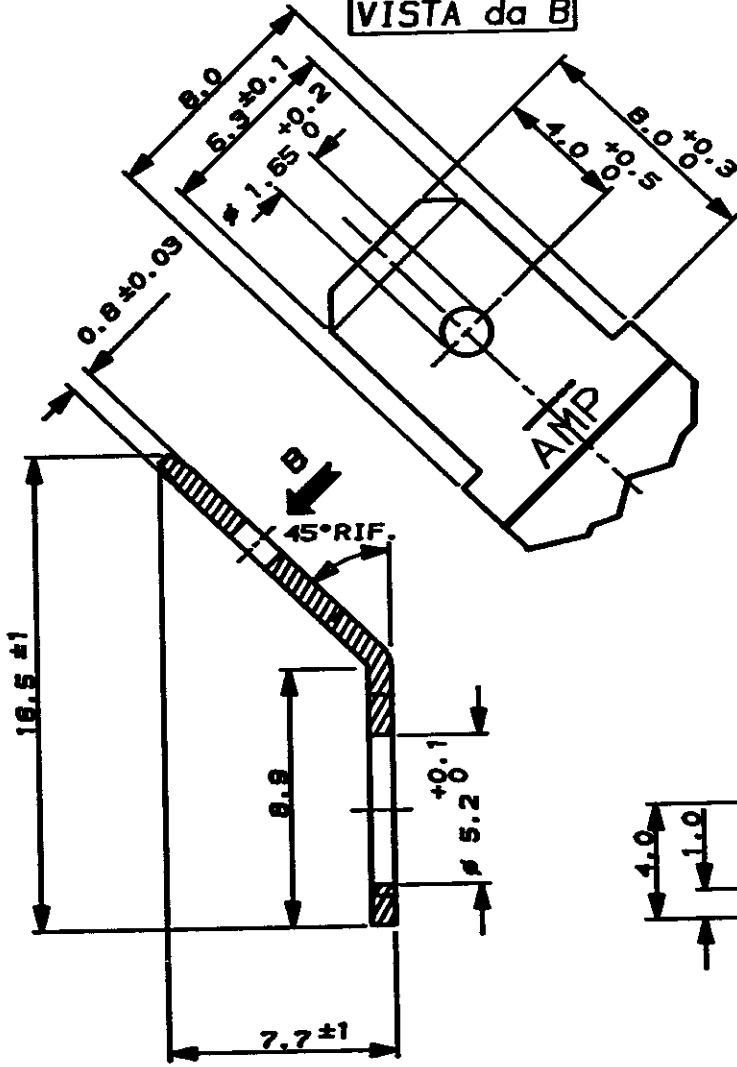

SEZIONE A-A

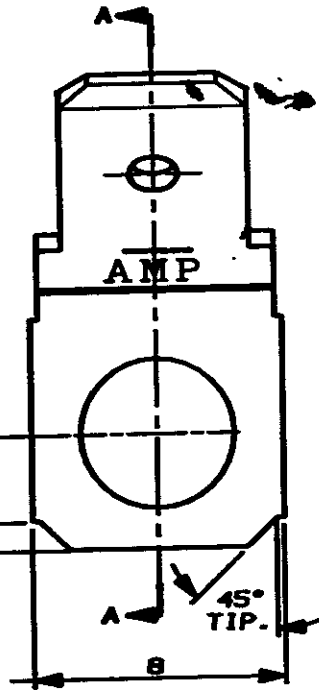

STAGNATO 2µm min. NUDO	OTTONE	181948-2
FINITURA / COLORE (FINISH / COLOUR)	MATERIALE (MATERIAL)	181948-1
		NUMERO (PART NUMBER)

CUSTOMER DWG. FOR REFERENCE ONLY      DISEGNO PER CLIENTE SOLO PER RIFERIMENTO

<del>THIS DRAWING IS UNPUBLISHED</del>		RELEASE FOR PUBLICATION	19
© COPYRIGHT 1990 BY AMP INCORPORATED, HARRISBURG, PA. ALL INTERNATIONAL RIGHTS RESERVED. AMP PRODUCTS MAY BE COVERED BY U.S. AND FOREIGN PATENT AND/OR PATENT PENDING			
TOLLERANZA, SE NON DIVERSAMENTE SPECIFICATO TOLERANCES, UNLESS OTHERWISE SPECIFIED	DIAM. ISOLANTE INS. DIA. RANGED	RANGO FILE GIZRE RANGED	SCALA (SCALE)
± 0.3	-	-	4:1
ANGOLI (ANGLE)	AMP      AMP ITALIA S.p.A. Corso F.lli Garvi, 15 COLLENO (TORINO)		
DIS. Bossano (BY) 22-5-90	DESCRIZIONE (DESCRIPTION) FASTON TAB 6.35mm (.250") Srs. SINGLE BENT 45° VERSION		
CONT. (CNS)	LOC. (LOC)	SIZE (SIZE)	NUMERO (PART NO)
APP. (APP)	IA	C-181948	C
REV. (REV)	REVISIONI (REVISION RECORD)	DIS. DATA (BY DATE)	REV. (REV)
C	RIVISTO E RIDISEGNATO	-	-

PRINT DIST.

1

2

3

4

## X-ON Electronics

Largest Supplier of Electrical and Electronic Components

*Click to view similar products for [Terminals](#) category:*

*Click to view products by [TE Connectivity](#) manufacturer:*

Other Similar products are found below :

[00-054007-01074-6](#) [00-054007-70206-1](#) [00-054007-70210-8](#) [00-054007-70217-7](#) [00-054007-70226-9](#) [00-054007-70228-3](#) [00-054007-70248-1](#) [00-054007-70256-6](#) [00-054007-70301-3](#) [00-054007-70316-7](#) [00-054007-49560-4](#) [00-054007-70209-2](#) [00-054007-70225-2](#) [00-054007-70227-6](#) [00-054007-70231-3](#) [00-054007-70241-2](#) [00-054007-70242-9](#) [00-054007-70244-3](#) [00-054007-70246-7](#) [00-054007-70263-4](#) [00-054007-70288-7](#) [00-054007-70290-0](#) [00-054007-70300-6](#) [00-054007-70304-4](#) [01-2065-1-0216](#) [01-2900-1-04412](#) [00581P0075](#) [600TS-10](#) [60205-1](#) [604200-1](#) [605601-1](#) [60598-1-CUT-TAPE](#) [61314-6-C](#) [61810-3](#) [61-S](#) [61-SN](#) [626-0194](#) [62-NBM-A](#) [62-SN](#) [62-SP](#) [63-S](#) [640179-1](#) [M55155/059I03](#) [M55155/079C01](#) [M55155/099H02](#) [M55155/109H01](#) [M55155/109H02](#) [M55155/12XH05](#) [M55155/16XH02](#) [M55155/29-5S](#)