

THIS DRAWING IS UNPUBLISHED. RELEASED FOR PUBLICATION
 © COPYRIGHT - BY - ALL RIGHTS RESERVED.

LOC	DIST	REVISIONS				
J	-	P	LTR	DATE	DWN	APVD
		DESCRIPTION ECN				
		B1		REVISD PER ECO-11-005030	26APR11	RK HMR

1. 材料:ハウジング:ガラス入り熱可塑性ポリエステル樹脂, 94V-0, 黒
 コンタクト:銅合金

- △2. 仕上げ:コンタクト:全面ニッケル下地めっき1.3μm以上に, 接点部金めっき0.38μm以上
- △3. 仕上げ:コンタクト:全面ニッケル下地めっき1.3μm以上に, 接点部半光沢錫めっき2μm以上

- 2:本図 (P/M)
- 1- -2:本図 (P/M)
- 2:AS SHOWN (P/M)
- 1- -2:AS SHOWN (P/M)

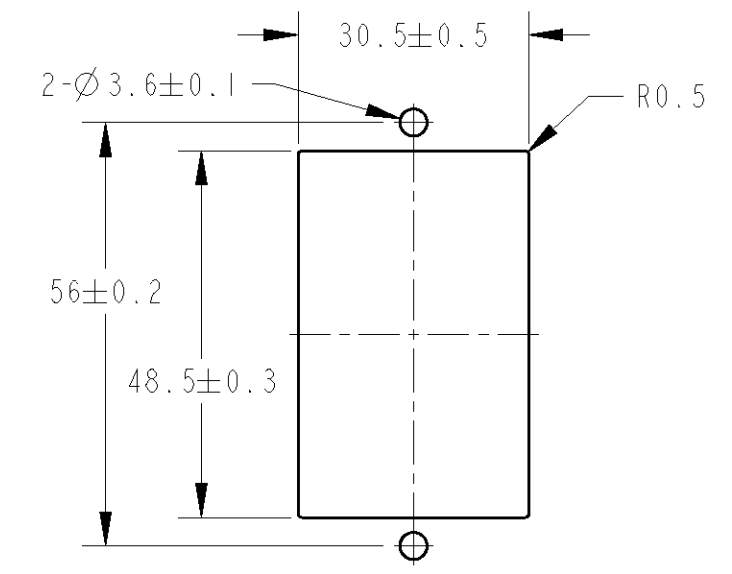
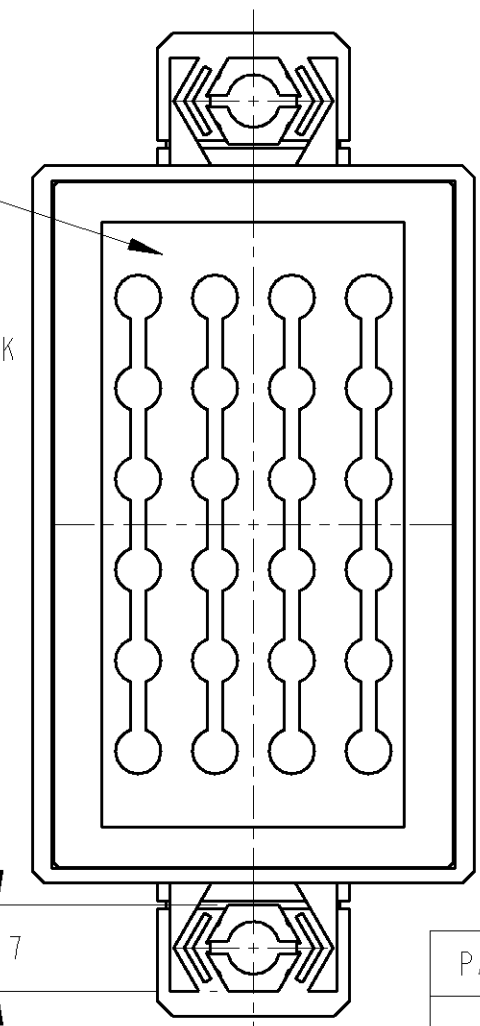
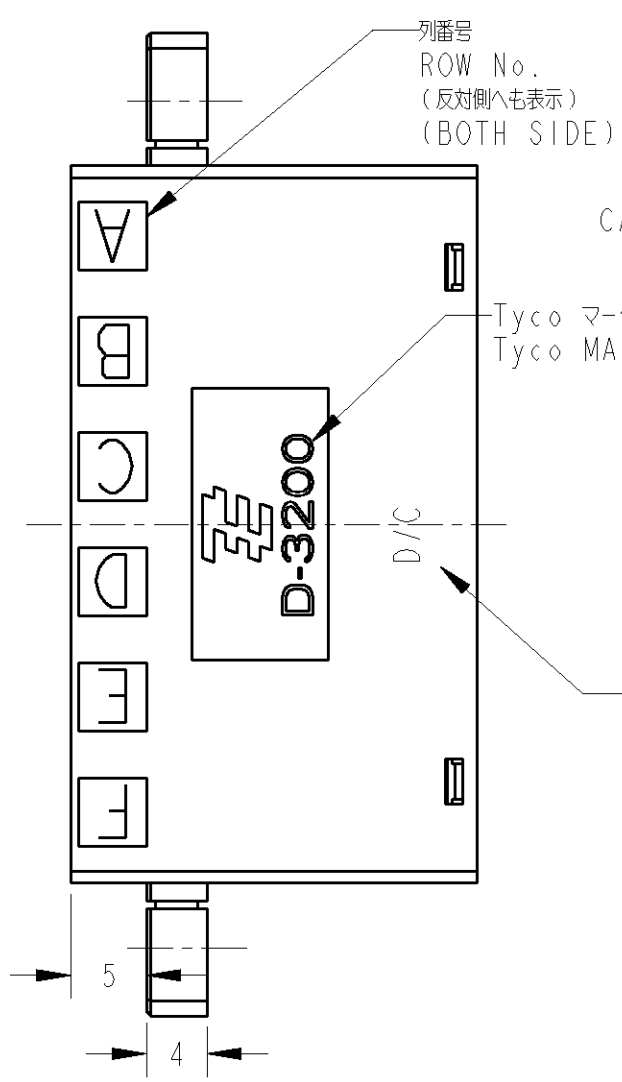
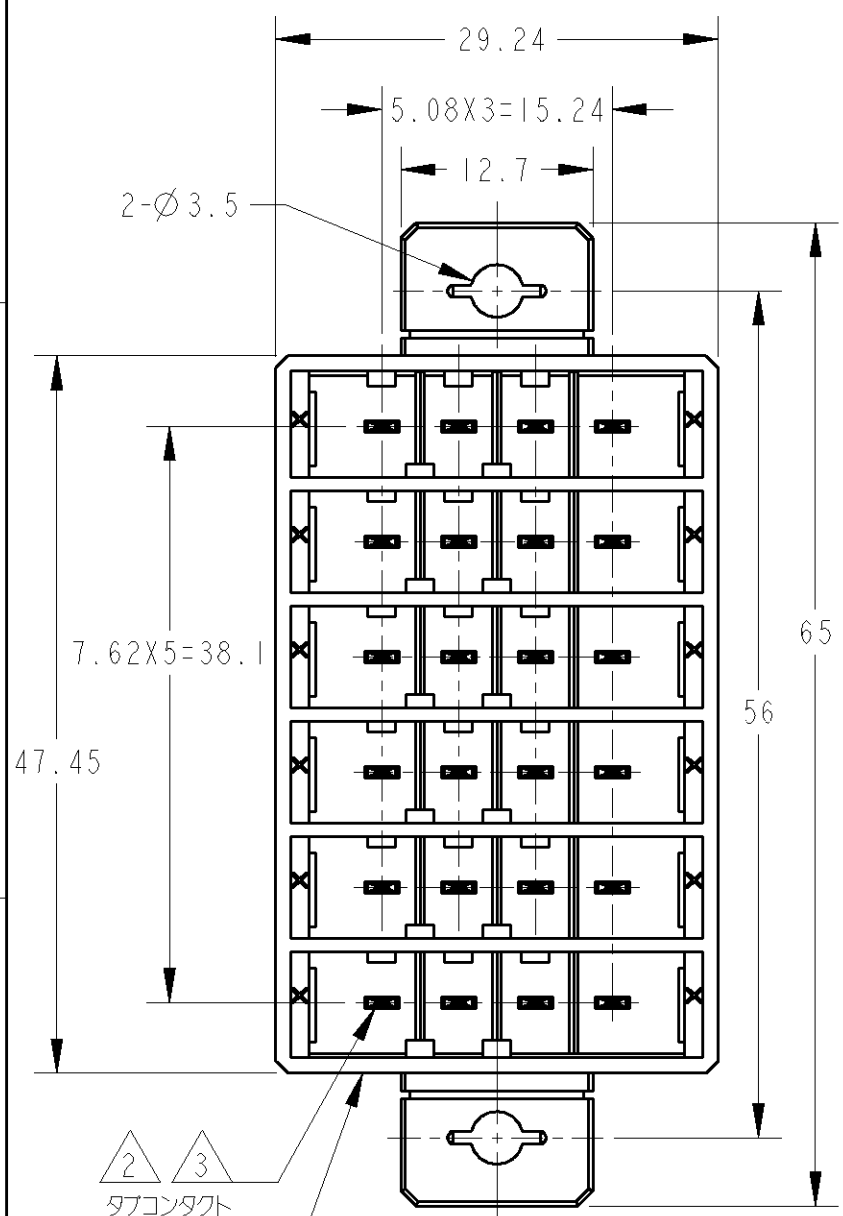

パネル加工推奨寸法図
 RECOMMEND PANEL LAYOUT
 SCALE:1:1

△2 △3
 タブコンタクト
 TAB CONTACT
 タップハウジング
 TAP HOUSING

1. MATERIAL : HOUSING : GLASS FILED THERMOPLASTIC, 94V-0, BLACK
 CONTACT : COPPER ALLOY

△2. FINISH : (ALL OVER) NICKEL PLATING 1.3μmMIN,
 (CONTACT AREA) GOLD PLATING 0.38μmMIN AFTER NICKEL.

△3. FINISH : (ALL OVER) NICKEL PLATING 1.3μmMIN,
 (CONTACT AREA) TIN(MATTE) PLATING 2μmMIN AFTER NICKEL.

PANEL MOUNT BOTTOM	△3	1-1827691-3
PANEL MOUNT	△3	1-1827691-2
FREE HANGING	△3	1-1827691-1
PANEL MOUNT BOTTOM	△2	1827691-3
PANEL MOUNT	△2	1827691-2
FREE HANGING	△2	1827691-1
MOUNT TYPE	FINISH	PART NO

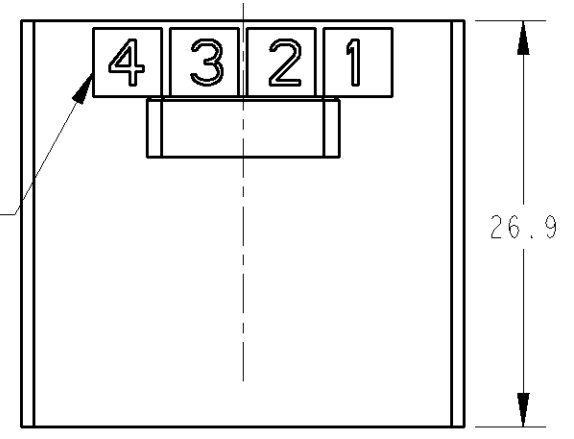

回路番号
 CIRCUIT No.
 (反対側へも表示)
 (BOTH SIDE)

DIMENSIONS: 単位: 概 mm		TOLERANCES UNLESS OTHERWISE SPECIFIED:		DWN S. TAKADA 27JUN2005
		一般公差 ±0.4		CHK D. MITSUGI 29JUN2005
		0-PLC ±		APVD D. MITSUGI 29JUN2005
MATERIAL 材料		1-PLC ±		PRODUCT SPEC 製品規格 108-5754
		2-PLC ±		APPLICATION SPEC 取付適用規格
		3-PLC ±		WEIGHT
		4-PLC ±		
		ANGLES ±3°		CUSTOMER DRAWING
		FINISH 仕上		

TE Connectivity			
NAME 名称 DYNATAP CONN. 24P ASSY -DYNAMIC 3200-			
SIZE A3	CAGE CODE 00779	DRAWING NO 番号 C=1827691	RESTRICTED TO
SCALE 尺度 2:1		SHEET 1 OF 2	REV B1

THIS DRAWING IS UNPUBLISHED. RELEASED FOR PUBLICATION

© COPYRIGHT - BY - ALL RIGHTS RESERVED.

LOC	DIST	REVISIONS					
		P	LTR	DESCRIPTION	DATE	DWN	APVD
J	-			SEE SHEET 1			

- 3:本図 (P/M BOTTOM)
- |- -3:本図 (P/M BOTTOM)
- 3:AS SHOWN (P/M BOTTOM)
- |- -3:AS SHOWN (P/M BOTTOM)

- 1:本図 (F/H)
- |- -1:本図 (F/H)
- 1:AS SHOWN (F/H)
- |- -1:AS SHOWN (F/H)

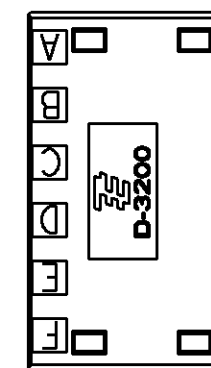
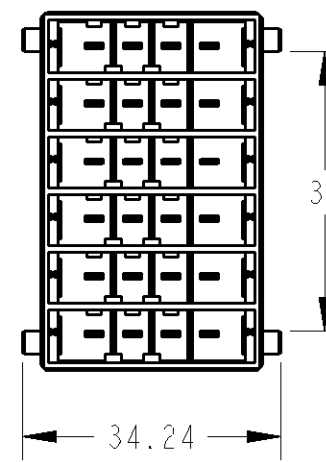
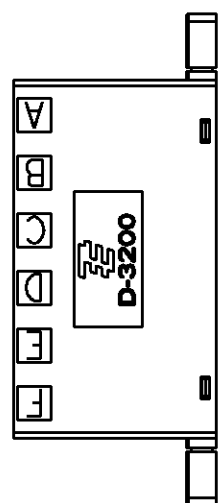
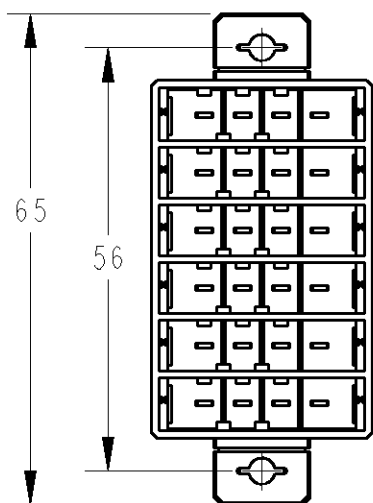
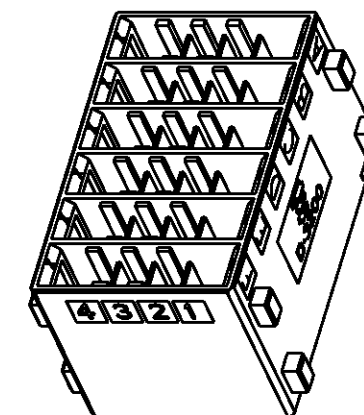
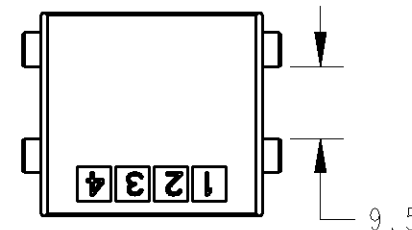
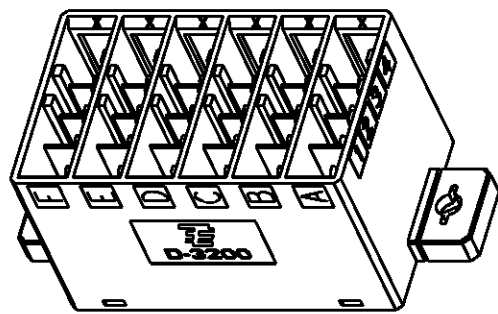
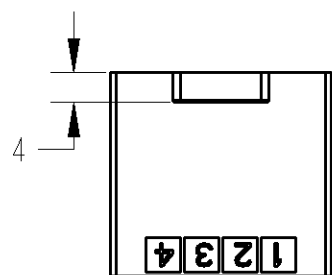

DIMENSIONS: 単位: 概 mm		TOLERANCES UNLESS OTHERWISE SPECIFIED: 概公差 0 PLC ± 1 PLC ± 2 PLC ± 3 PLC ± 4 PLC ± ANGLES ±		DWN S. TAKADA 27JUN2005 CHK D. MITSUGI 29JUN2005 APVD D. MITSUGI 29JUN2005 PRODUCT SPEC 108-5754 APPLICATION SPEC 取付適用規格 WEIGHT -			
MATERIAL 材料 -		FINISH 仕上 -		NAME 名称 DYNATAP CONN. 24P ASSY -DYNAMIC 3200-		SIZE A3 CAGE CODE 00779 DRAWING NO. 1827691 RESTRICTED TO -	
CUSTOMER DRAWING				SCALE 2:1 SHEET 2 OF 2 REV B1			

X-ON Electronics

Largest Supplier of Electrical and Electronic Components

Click to view similar products for [Headers & Wire Housings](#) category:

Click to view products by [TE Connectivity](#) manufacturer:

Other Similar products are found below :

[892-18-020-10-001101](#) [58102-G61-06LF](#) [582553-1](#) [0009485154](#) [009176003701906](#) [0050291907](#) [LY20-4P-DT1-P1E-BR](#) [02.125.8002.8](#)
[609-3404](#) [61062-3](#) [61082-181009](#) [622-3653LF](#) [63453-116](#) [636-1030](#) [636-1427](#) [636-3427](#) [636-4007](#) [641938-9](#) [641991-4](#) [644827-2](#) [65817-](#)
[010LF](#) [65817-015LF](#) [65863-015LF](#) [66207-023LF](#) [67095-007LF](#) [67601157](#) [68645-018](#) [68648-049](#) [70.362.1628.0](#) [70-4210](#) [70-4226B](#) [70-](#)
[4853B](#) [707-5020](#) [707-5028](#) [71.350.2428.0](#) [71918-208LF](#) [71961-016LF](#) [733-134](#) [733-162](#) [754199-000](#) [760-3052](#) [787-8014-00](#) [79531-3000](#)
[FCN-360C032-B](#) [FCN-367T-T012/H](#) [FCN-723D010/2](#) [80.063.4001.1](#) [800-90-001-10-001000](#) [800-90-010-10-002000](#) [801-43-002-10-013000](#)