

4

3

2

1

THIS DRAWING IS UNPUBLISHED. RELEASED FOR PUBLICATION
 © COPYRIGHT - TE Connectivity ALL RIGHTS RESERVED.

P	LTR	DESCRIPTION	DATE	DWN	APVD
	A	RELEASED PER ECR 09-017675	11AUG09	JR	RL
	A1	REVISED PER ECO-17-004099	24AUG2017	BDA	DR

AMP WIRE RANGE	E13288 Listed
3/0 AWG SOLID OR STRANDED	NOT APPLICABLE
LR7189 Certified	MILITARY P/N AND CLASS
NOT APPLICABLE	NOT APPLICABLE

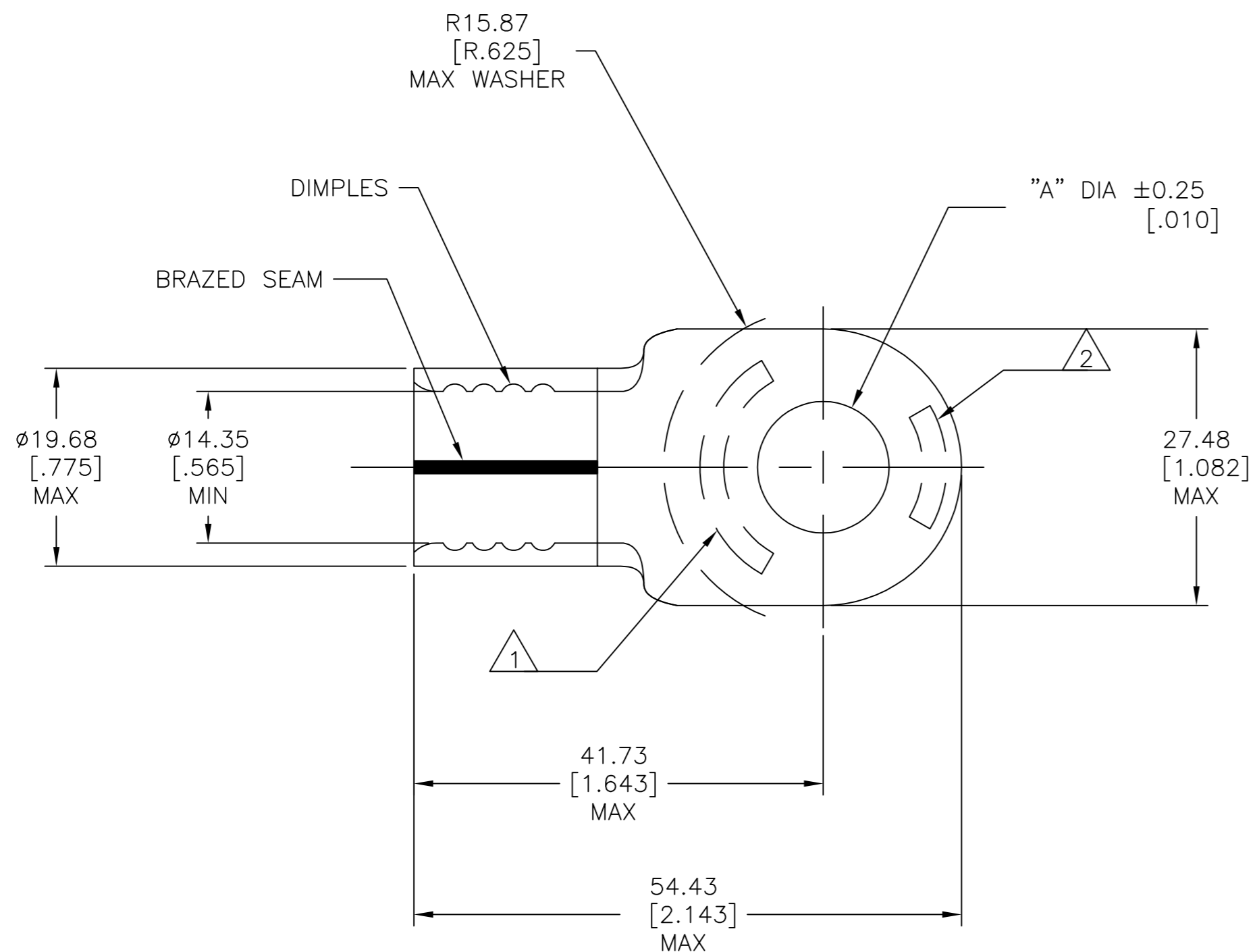

- STAMP AMP 3/0W* APPROX AS SHOWN
- STAMP 150 APPROX AS SHOWN
- TONGUE MATERIAL THK: 2.31±0.08[.091±.003]
- PREPRODUCTION - FASR REQUIRED

CUSTOMER SERVICE SYSTEMS		MAX RECOMMENDED OPERATING TEMPERATURE: 170°[338°F] C MAX
FOR ADDITIONAL PRODUCT INFORMATION OR COPIES OF DRAWINGS AND TECHNICAL DOCUMENTS	PRODUCT INFORMATION CENTER 1-800-522-6752	VOLTAGE RATING: NOT APPLICABLE
FOR APPLICATION TOOLING INFORMATION	TOOLING ASSISTANCE CENTER 1-800-722-1111	CIRCULAR MIL AREA: 76.3-96.3mm²[150,000-190,000] CIR MILS SOLID OR STRANDED
FOR ORDER ENTRY	1-800-526-5142	

50	LOOSE PIECE	10.75 [.423]	1958311-1
QTY.	PACKAGE TYPE	"A"	PART NUMBER
THIS DRAWING IS A CONTROLLED DOCUMENT.		DWN RAGHAVENDRA 02JUL09	
DIMENSIONS: mm [INCHES]		CHK R LONDON 02JUL09	
TOLERANCES UNLESS OTHERWISE SPECIFIED:		APVD R LONDON 02JUL09	
0 PLC ± -		NAME	
1 PLC ± -		TE Connectivity	
2 PLC ± 0.20[.008]		TERMINAL, RING TONGUE, SOLISTRAND™	
3 PLC ± -		-	
4 PLC ± -		APPLICATION SPEC	
ANGLES ± -		SIZE CAGE CODE DRAWING NO RESTRICTED TO	
MATERIAL COPPER ASTM B-152 ANNEALED		WEIGHT A2 00779 C=1958311	
FINISH TIN PLATE 0.00254[.000100] MIN THK PER ASTM-545		SCALE 2:1 SHEET 1 OF 1 REV A1	

D

C

B

A

D

C

B

A

X-ON Electronics

Largest Supplier of Electrical and Electronic Components

Click to view similar products for [Terminals](#) category:

Click to view products by [TE Connectivity](#) manufacturer:

Other Similar products are found below :

[00-054007-01074-6](#) [00-054007-70206-1](#) [00-054007-70210-8](#) [00-054007-70217-7](#) [00-054007-70226-9](#) [00-054007-70228-3](#) [00-054007-70248-1](#) [00-054007-70256-6](#) [00-054007-70301-3](#) [00-054007-70316-7](#) [00-054007-49560-4](#) [00-054007-70209-2](#) [00-054007-70225-2](#) [00-054007-70227-6](#) [00-054007-70231-3](#) [00-054007-70241-2](#) [00-054007-70242-9](#) [00-054007-70244-3](#) [00-054007-70246-7](#) [00-054007-70263-4](#) [00-054007-70288-7](#) [00-054007-70290-0](#) [00-054007-70300-6](#) [00-054007-70304-4](#) [01-2065-1-0216](#) [01-2900-1-04412](#) [00581P0075](#) [600TS-10](#) [60205-1](#) [604200-1](#) [605601-1](#) [60598-1-CUT-TAPE](#) [61314-6-C](#) [61810-3](#) [61-S](#) [61-SN](#) [626-0194](#) [62-NBM-A](#) [62-SN](#) [62-SP](#) [63-S](#) [640179-1](#) [M55155/059I03](#) [M55155/079C01](#) [M55155/099H02](#) [M55155/109H01](#) [M55155/109H02](#) [M55155/12XH05](#) [M55155/16XH02](#) [M55155/29-5S](#)