

STRIP FORM Bandware

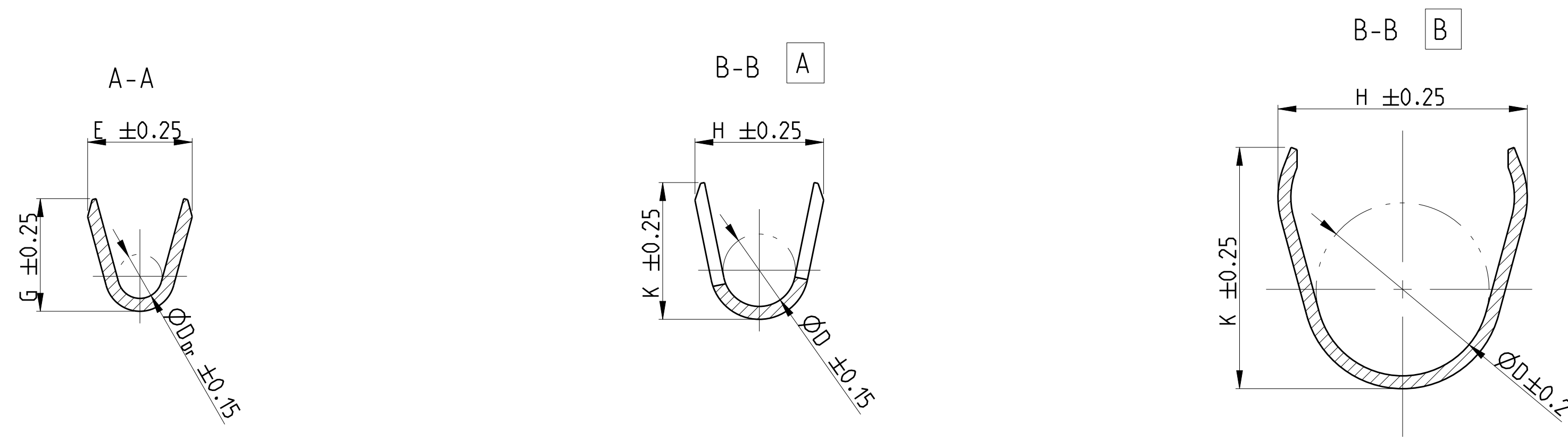

- 1 CONTACT AREA PRE SILVER MIN. 3µm
CANTILEVER SPRING PLAIN
Kontaktzone vorversilbert min. 3µm
Ueberfederer blank
- 2 CONTACT BODY NI-PLATING MIN. 0.5µm; CONTACT AREA PRE-GOLD MIN. 0.6µm
OVER NICKEL; CRIMP AREA PRE-TIN
CANTILEVER SPRING PLAIN
Kontaktkoerper vernickelt min. 0.5µm; Kontaktzone vorvergoldet min. 0.6µm ueber Nickel
Crimpzone vorverzinkt; Ueberfederer blank
- 3 IN THIS AREA CRACK SHAPING AT THE SURFACE PERMISSIBLE
In diesem Bereich Rissbildung in der Oberflaeche zulassig
- 4 PRE-TIN MIN. 1µm; CANTILEVER SPRING PLAIN
vorverzinkt min. 1µm; Ueberfederer blank

- 5 AWG 12 TXL 828905-1 OR / oder 282536-1
AWG 12 GXL 638865-1
- 6 ATTENTION! CONSTRUCTION OF THE CONTACT CAVITY IN THE AREA OF THE SINGLE WIRE SEAL IS Ø6.4^{+0.1}_{-0.05}
Achtung! Die Kammer ist im Bereich der Einzeldichtung auf Ø6.4^{+0.1}_{-0.05} auszuliegen
- 7 PUNCHED WITH VOLATILIZING STAMPING-OIL
Gestanz mit verfluechtigendem Stanzoeel

FLR-/FLK-WIRE FLR-/FLK-Leitung

DESIGN 1 Ausfuehrung 1

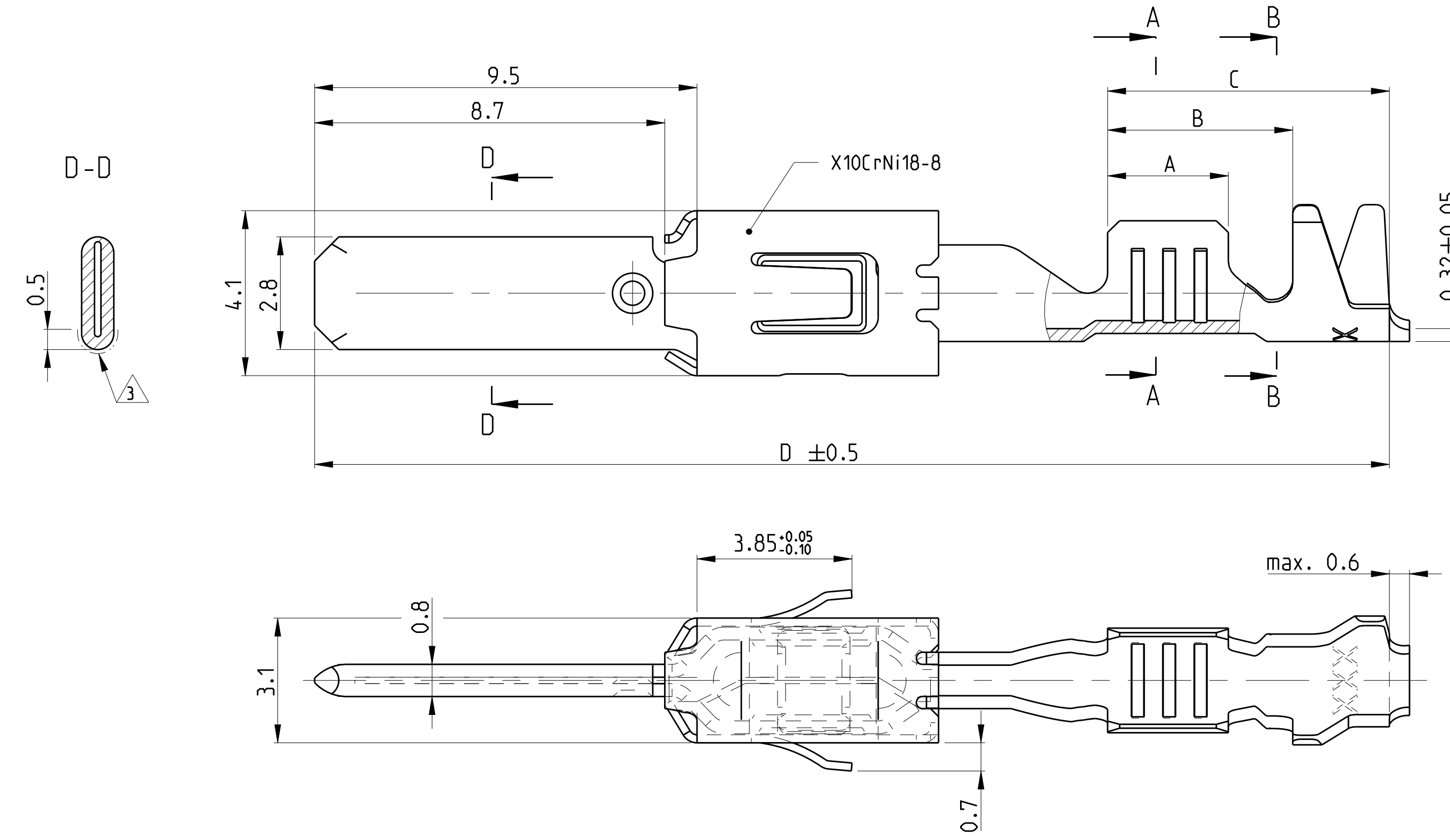

SINGLE WIRE SEAL Einzeldichtungssystem

DESIGN 4 Ausfuehrung 4

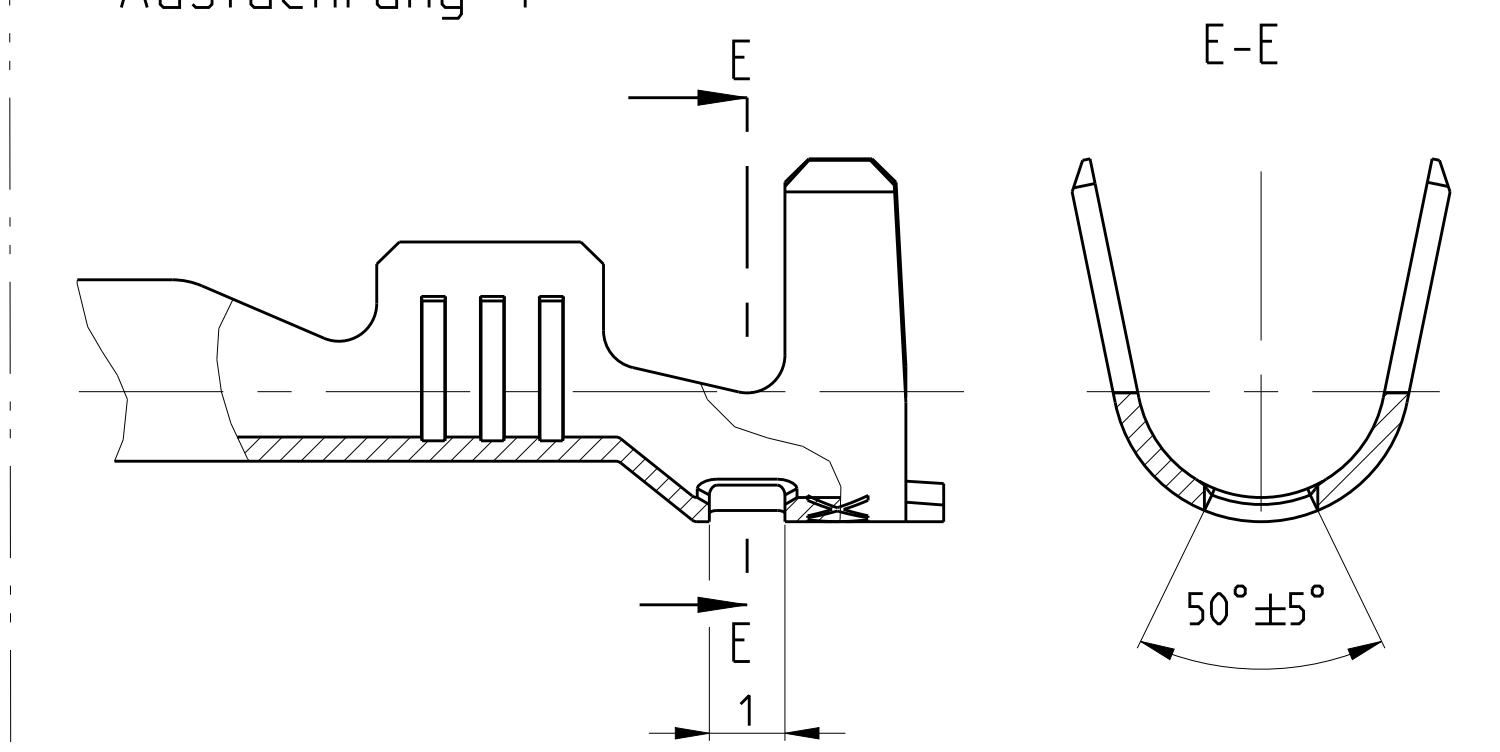

DESIGN 2 Ausfuehrung 2

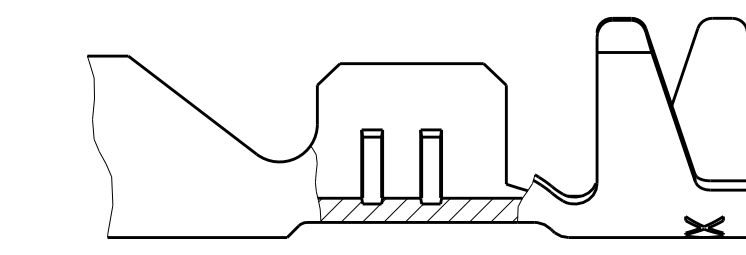

DESIGN 5 Ausfuehrung 5

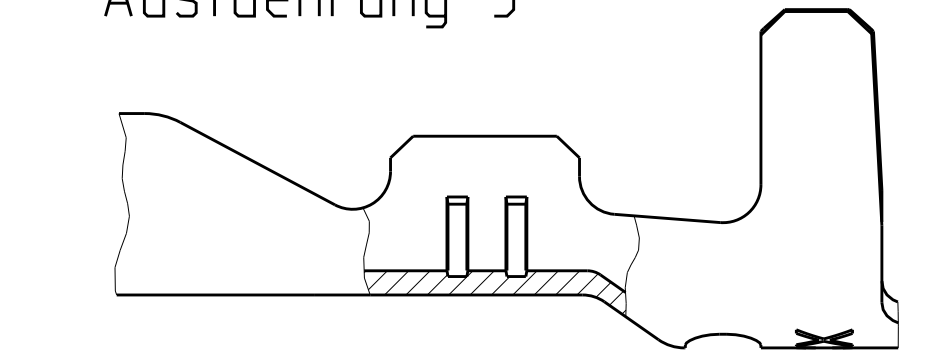

DESIGN 3 Ausfuehrung 3

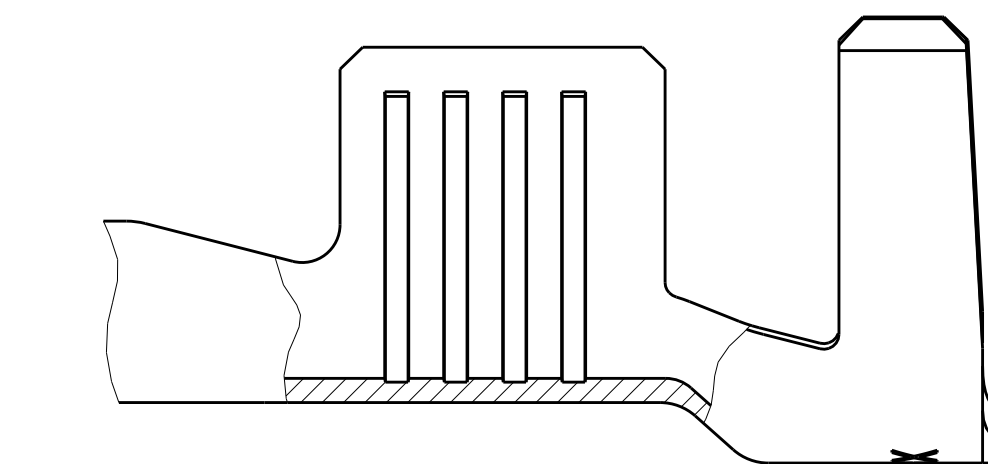

DESIGN 6 Ausfuehrung 6

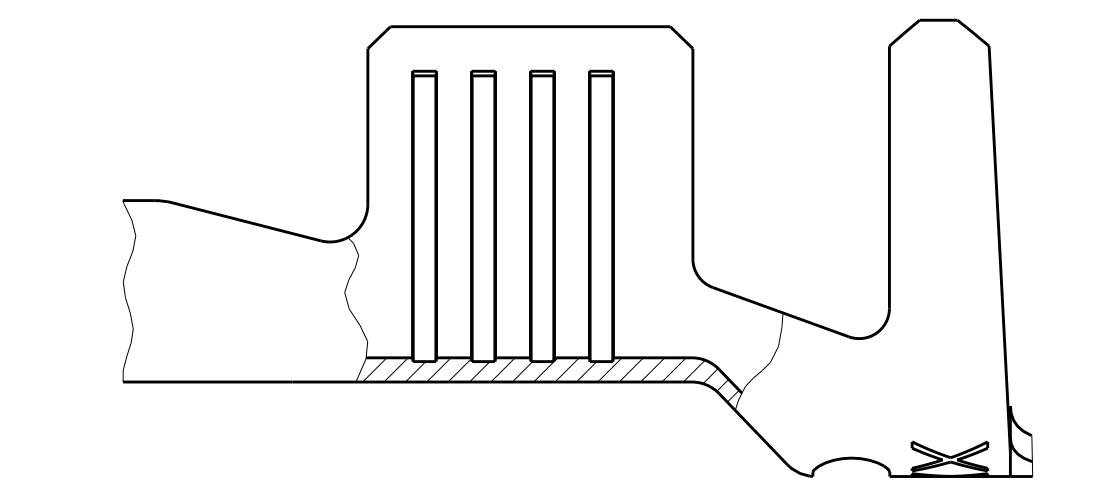

DESIGN 7 Ausfuehrung 7

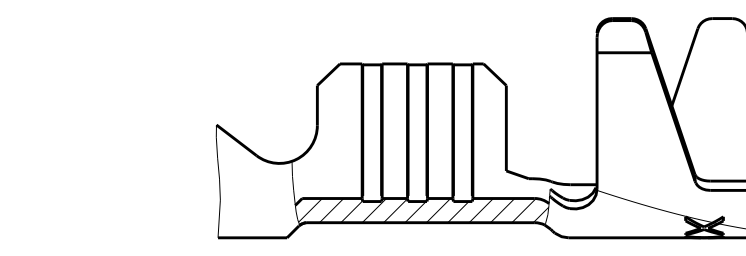

DESIGN 8 Ausfuehrung 8

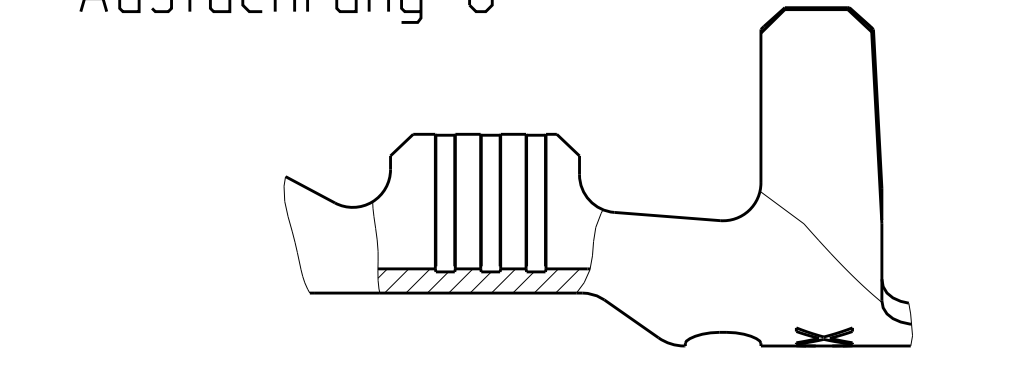

SINGLE WIRE SEAL / Einzeldichtungssystem	REV	DESIGN	MATERIAL	SURFACE	DGB	INSULATION	WIRE CRIMP	INSUL. CRIMP	APPLICATION TOOL	HAND TOOL	TE	TE	SEE / siehe SECTION A-A Schnitt A-A				828922-1		
													E	G	D _{Dr}	H		K	D
SINGLE WIRE SEAL / Einzeldichtungssystem	1-1719504-2	A	4	CuSn4	△	12 AWG	max. 3.0	E = 4.0 G = 4.2 D _{Dr} = 2.0	A	H = 5.3 K = 5.0 D = 3.6	1852291-3	-	3.5	6.0	7.6	26.8	△	828922-1	
	1-1719504-1	A	4	CuSn0.20	△														
	3-968947-1	A	6	CuSn4	△														
	2-968947-2	A	6	CuFe	△														
	2-968947-1	A	6	CuSn4	△														
	1-968947-2	A	6	CuSn4	△														
	1-968947-1	A	6	CuSn4	△														
	2-962916-3	E	4	CuFe	△														
	2-962916-2	E	4	CuFe	△														
	2-962916-1	E	4	CuFe	△														
	1-962916-3	E	4	CuSn4	△														
	1-962916-2	E	4	CuSn4	△														
1-962916-1	E	4	CuSn4	△															
2-962915-3	E	4	CuFe	△															
2-962915-2	E	4	CuFe	△															
2-962915-1	E	4	CuFe	△															
6-962915-6	E	4	CuSn4	△															
1-962915-3	E	4	CuSn4	△															
1-962915-2	E	4	CuSn4	△															
1-962915-1	E	4	CuSn4	△															
5-965982-1	A	8	CuSn4	△															
1-965982-3	A	5	CuSn4	△															
1-965982-1	A	5	CuSn4	△															
3-968946-1	A	3	CuSn0.20	△															
2-968946-2	A	3	CuFe	△															
2-968946-1	A	3	CuSn4	△															
1-968946-2	A	3	CuSn4	△															
1-968946-1	A	3	CuSn4	△															
2-962843-3	C	1	CuFe	△															
2-962843-2	C	1	CuFe	△															
2-962843-1	C	1	CuSn4	△															
1-962843-3	C	1	CuSn4	△															
1-962843-2	C	1	CuSn4	△															
1-962843-1	C	1	CuSn4	△															
2-962842-3	E	1	CuFe	△															
2-962842-2	F	1	CuFe	△															
2-962842-1	E	1	CuSn4	△															
1-962842-3	E	1	CuSn4	△															
1-962842-2	E	1	CuSn4	△															
1-962842-1	E	1	CuSn4	△															
2-962841-3	F	1	CuFe	△															
2-962841-2	F	1	CuFe	△															
2-962841-1	F	1	CuFe	△															
1-962841-3	F	1	CuSn4	△															
1-962841-2	F	1	CuSn4	△															
1-962841-1	F	1	CuSn4	△															
2-963860-3	B	2	CuFe	△															
2-963860-2	B	2	CuFe	△															
2-963860-1	B	2	CuFe	△															
5-963860-2	A	7	CuSn4	△															
5-963860-1	A	7	CuSn4	△															
1-963860-3	B	2	CuSn4	△															
1-963860-2	B	2	CuSn4	△															
1-963860-1	B	2	CuSn4	△															

TE ORDER-NO.	DESIGN REV	MATERIAL	SURFACE	DGB	INSULATION	WIRE CRIMP	INSUL. CRIMP	APPLICATION TOOL	HAND TOOL	TE ORDER-NO.	TE ORDER-NO.
STRIPFORM Bandware	Ausfuehrung	Werkstoff	Oberflaeche	mm ²	mm	mm	mm	Anschtagerwerkzeug	Handzange	SEALING PLUG	Blindstopfen
								EXTRACTION TOOL	Ausdruckwerkzeug		
									No. 968107-1		

THIS DRAWING IS A CONTROLLED DOCUMENT. DATE: 14 JUN 1999. DRAWN BY: K. Gerlach. CHECKED BY: M. Bleicher. APPROVED BY: [Signature].

PRODUCT GROUP DRAWING FOR TAB 2.8x0.8. Produktgruppenzeichnung fuer Flachstecker 2.8x0.8.

SCALE: 10:1. SHEET: 1 OF 1.

X-ON Electronics

Largest Supplier of Electrical and Electronic Components

Click to view similar products for [Automotive Connectors](#) category:

Click to view products by [TE Connectivity](#) manufacturer:

Other Similar products are found below :

[003-018-000](#) [60403001](#) [60993906-B](#) [M902-2131](#) [M902-2161](#) [72.330.1035.1](#) [73.353.4028.0](#) [F119300-B](#) [F166900](#) [F258300-B](#) [F358300-B](#)
[F407400](#) [F444110](#) [F487000](#) [F509500B-B](#) [827153-1](#) [8N1515-32-24P](#) [9-1326729-8](#) [925474-1](#) [928905-1](#) [964562-4](#) [968782-1](#) [GT17SA-8DS-](#)
[HU](#) [98891-1012](#) [98947-1016](#) [12004147](#) [12004475-L](#) [12010290](#) [12010309-B](#) [12015454](#) [12020219-B](#) [12020308](#) [12041318-B](#) [12052225-L](#)
[12052466](#) [12059125](#) [12064869](#) [12004327-B](#) [12010503-B](#) [12015308](#) [12015384](#) [12015909](#) [1-21030-1](#) [12041254](#) [12041318](#) [12047946-B](#)
[12047957](#) [12047957-L](#) [12059473](#) [12066261](#)