

STRIP FORM Bandware

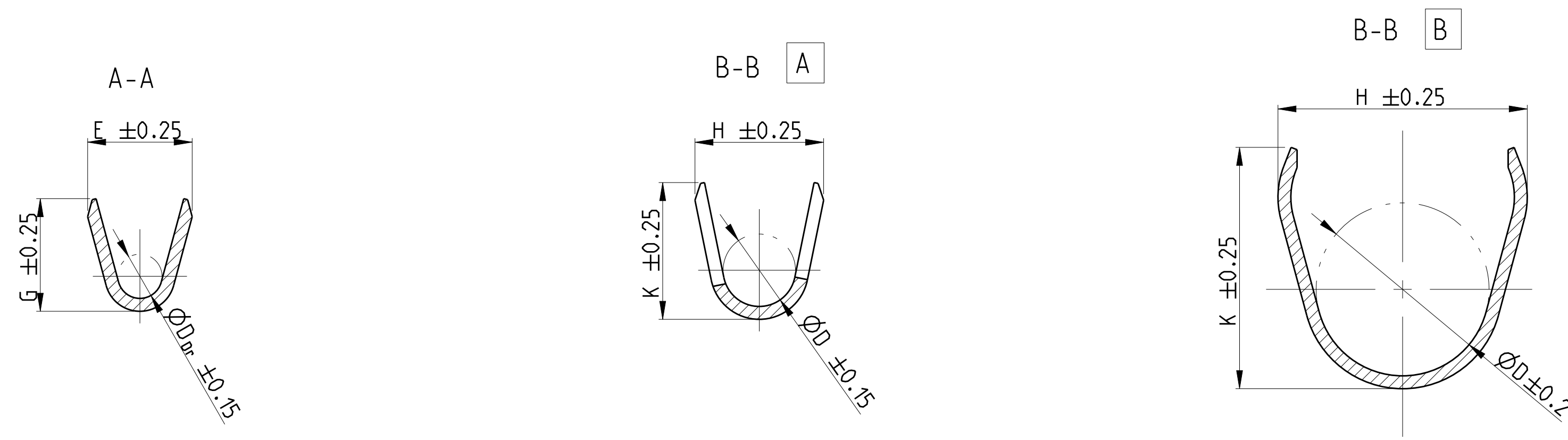

- 1 CONTACT AREA PRE SILVER MIN. 3µm
CANTILEVER SPRING PLAIN
Kontaktzone vorversilbert min. 3µm
Ueberfederer blank
- 2 CONTACT BODY NI-PLATING MIN. 0.5µm; CONTACT AREA PRE-GOLD MIN. 0.6µm
OVER NICKEL; CRIMP AREA PRE-TIN
CANTILEVER SPRING PLAIN
Kontaktkörper vernickelt min. 0.5µm; Kontaktzone vorvergoldet min. 0.6µm ueber Nickel
Crimpszone vorverzinkt; Ueberfederer blank
- 3 IN THIS AREA CRACK SHAPING AT THE SURFACE PERMISSIBLE
In diesem Bereich Rissbildung in der Oberflaeche zulassig
- 4 PRE-TIN MIN. 1µm; CANTILEVER SPRING PLAIN
vorverzinkt min. 1µm; Ueberfederer blank

- 5 AWG 12 TXL 828905-1 OR / oder 282536-1
AWG 12 GXL 638865-1
- 6 ATTENTION! CONSTRUCTION OF THE CONTACT CAVITY IN THE AREA OF THE SINGLE WIRE SEAL IS $\phi 6.4^{+0.1}_{-0.05}$
Achtung! Die Kammer ist im Bereich der Einzeldichtung auf $\phi 6.4^{+0.1}_{-0.05}$ auszuliegen
- 7 PUNCHED WITH VOLATILIZING STAMPING-OIL
Gestanz mit verfluechtigendem Stanzoeel

FLR-/FLK-WIRE
FLR-/FLK-Leitung

DESIGN 1
Ausfuehrung 1

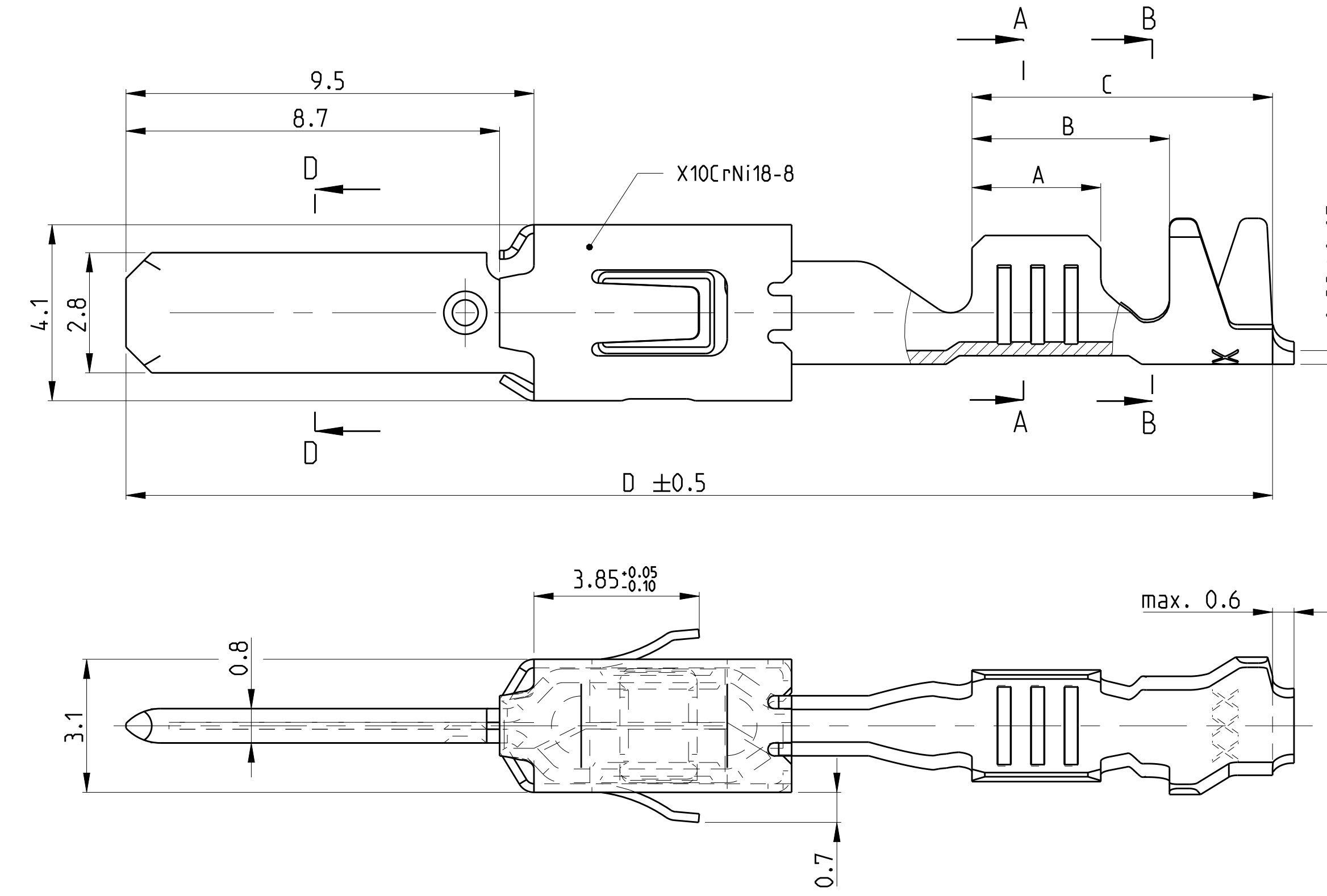

SINGLE WIRE SEAL
Einzeldichtungssystem

DESIGN 4
Ausfuehrung 4

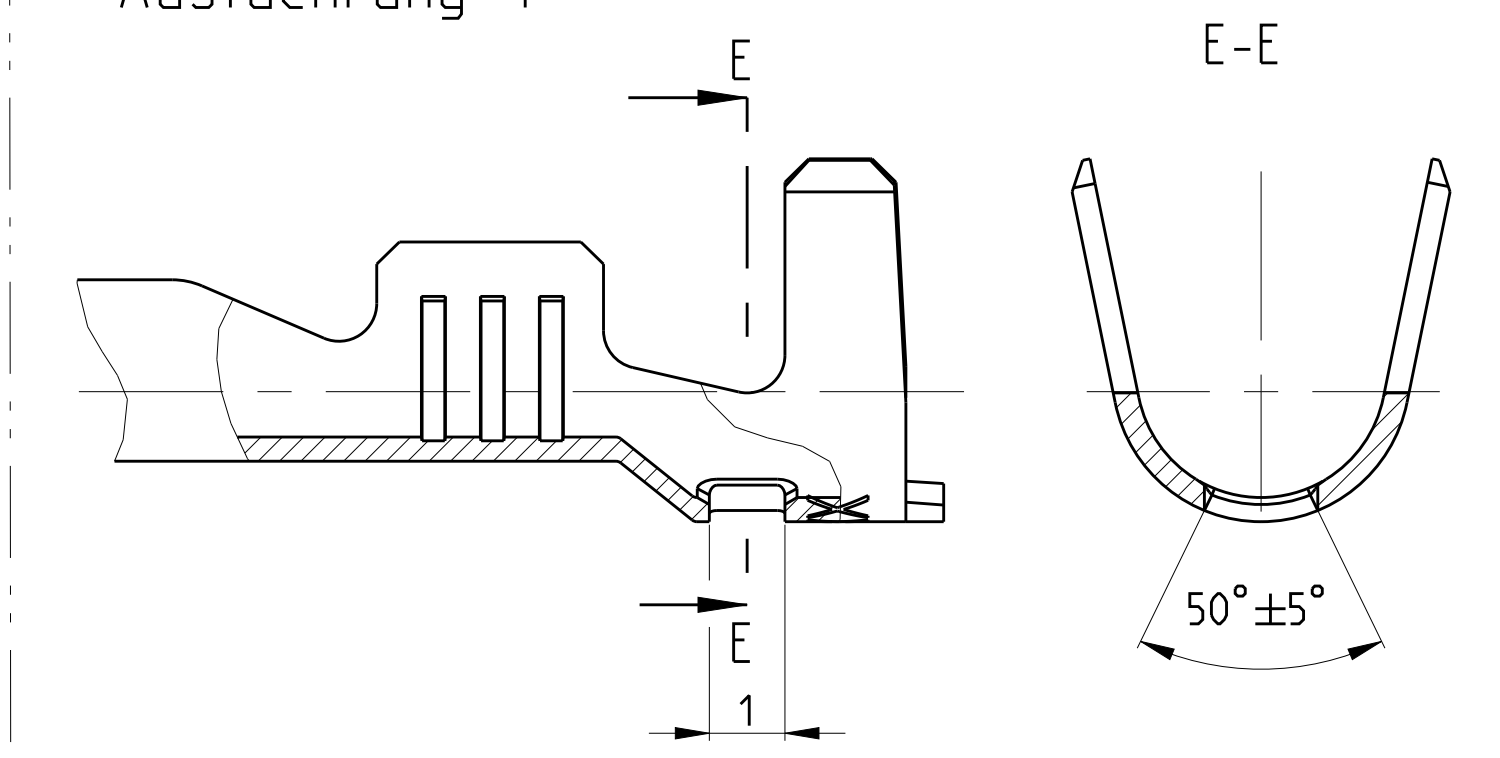

SINGLE WIRE SEAL / Einzeldichtungssystem	REV	DESIGN	MATERIAL	SURFACE	DGB	INSULATION	WIRE CRIMP	INSUL. CRIMP	APPLICATION TOOL	HAND TOOL	TE	TE	SEE / siehe SECTION A-A Schnitt A-A				SEE / siehe SECTION B-B Schnitt B-B			
													E	G	D _{Dr}	H	K	D	H	K
1-1719504-2	A	4	CuSn4	△	12 AWG	max. 3.0	E = 4.0 G = 4.2 D _{Dr} = 2.0	A H = 5.3 K = 5.0 D = 3.6	1852291-3	-	3.5	6.0	7.6	26.8	△	828922-1				
3-968947-1	A	4	CuSn0.20	△	2.5 - 4.0 FLR	max. 3.7	E = 4.5 G = 4.7 D _{Dr} = 2.3	B H = 6.2 K = 6.0 D = 4.3	MQC APPLICATOR	539635-1	4.3	6.9	8.5	28.5	828985	828986-1				
2-968947-2	A	6	CuFe	△					2-541537-2	MATRIZE :					539727-2					
1-968947-2	A	6	CuSn4	△	-1.0 - 2.5 FLR	max. 3.0	E = 3.6 G = 3.8 D _{Dr} = 1.7	A H = 5.3 K = 5.0 D = 3.6	MQC APPLICATOR	734440-1	3.5	6.0	7.6	26.8	828905	828905(Ø5.0)				
2-962916-3	E	4	CuFe	△					2-878560-2											
2-962916-2	E	4	CuSn4	△	0.5 - 1.0 FLR	max. 2.1	E = 2.6 G = 2.9 D _{Dr} = 1.2	A H = 5.0 K = 4.8 D = 3.3	MQC APPLICATOR	734438-1	3.0	5.4	7.0	26.8	828904	828922-1				
2-962915-3	E	4	CuFe	△					2-878559-2											
2-962915-2	E	4	CuSn4	△	0.2 - 0.5 FLR	max. 2.1	E = 2.1 G = 2.1 D _{Dr} = 0.8	A H = 4.7 K = 4.5 D = 3.2	MQC APPLICATOR	539635-1	2.5	4.9	6.5	26.8	828904	828922-1				
6-962915-6	E	4	CuSn4	△					2-878558-2	MATRIZE :					539737-2					
1-965982-3	A	5	CuSn4	△	2.5 - 4.0 FLR	2.7 - 3.7	E = 4.5 G = 4.7 D _{Dr} = 2.3	A H = 5.7 K = 5.9 D = 3.3	MQC APPLICATOR	539635-1	4.3	6.6	8.5	28.5	828985	828986-1				
1-965982-1	A	5	CuFe	△					2-541534-2	MATRIZE :					539723-2					
2-962843-3	C	1	CuFe	△	-1.0 - 2.5 FLK	2.4 - 3.7	E = 3.6 G = 3.8 D _{Dr} = 1.7	A H = 5.5 K = 5.7 D = 3.2	MQC APPLICATOR	734417-3	3.6	5.2	8.9	28.6	828905	828905(Ø5.0)				
2-962843-2	C	1	CuSn4	△					2-878552-2											
2-962843-1	C	1	CuFe	△	-1.0 - 2.5 FLR	2.1 - 2.9	E = 3.6 G = 3.8 D _{Dr} = 1.7	A H = 4.3 K = 4.5 D = 2.6	MQC APPLICATOR	734417-2	3.6	5.2	8.2	27.9	828904	828922-1				
1-962843-3	C	1	CuSn4	△					2-878551-2											
1-962842-3	E	1	CuFe	△	0.5 - 1.0 FLR	1.4 - 2.1	E = 2.6 G = 2.8 D _{Dr} = 1.1	A H = 3.2 K = 3.4 D = 1.8	MQC APPLICATOR	734417-1	3.0	4.6	7.0	26.7	828904	828922-1				
2-962842-2	F	1	CuSn4	△					2-878550-2											
2-962842-1	E	1	CuFe	△	0.2 - 0.5 FLR	1.3 - 1.6	E = 2.1 G = 2.1 D _{Dr} = 0.8	A H = 2.9 K = 2.9 D = 1.4	MQC APPLICATOR	734538-1	2.5	3.7	5.8	25.5	828904	828922-1				
2-963860-3	B	2	CuSn4	△					2-878549-2											

DESIGN 2
Ausfuehrung 2

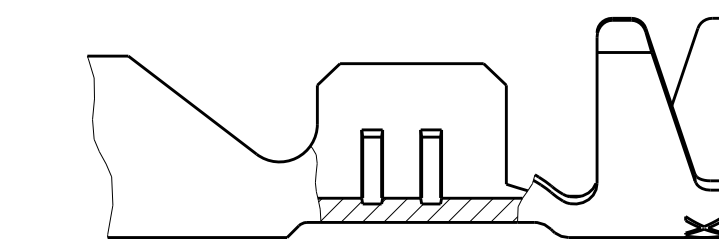

DESIGN 5
Ausfuehrung 5

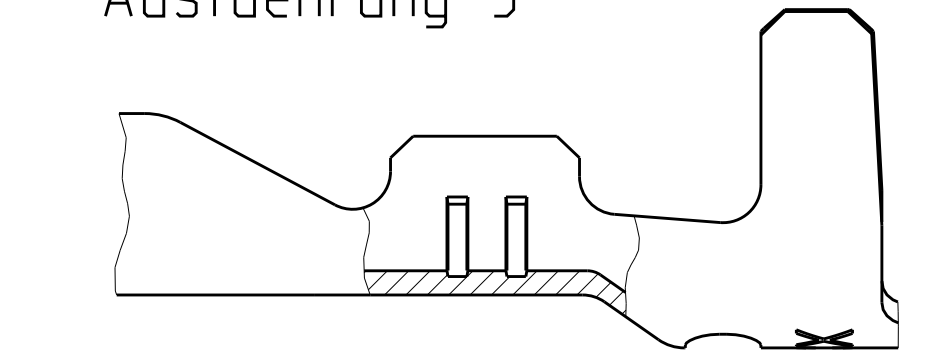

DESIGN 3
Ausfuehrung 3

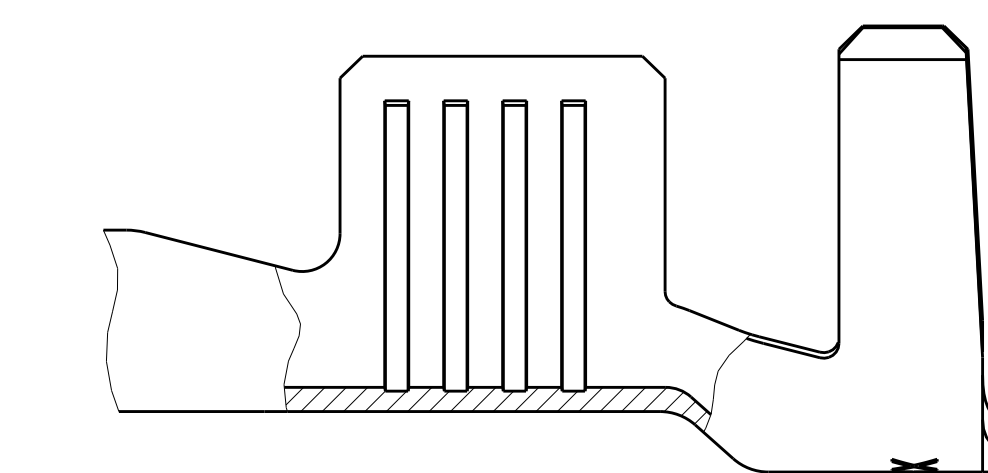

DESIGN 6
Ausfuehrung 6

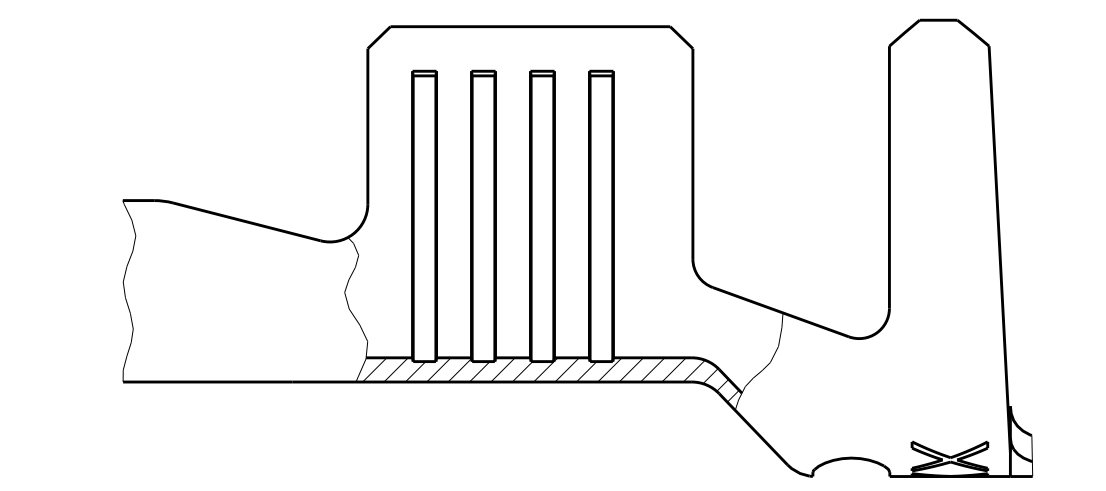

DESIGN 7
Ausfuehrung 7

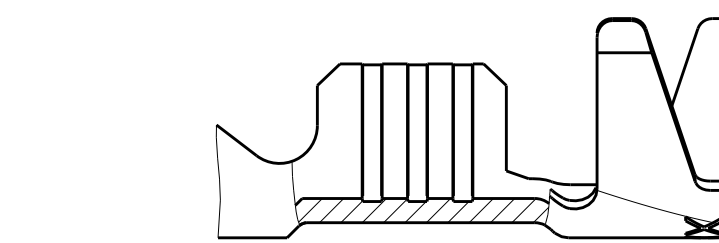

DESIGN 8
Ausfuehrung 8

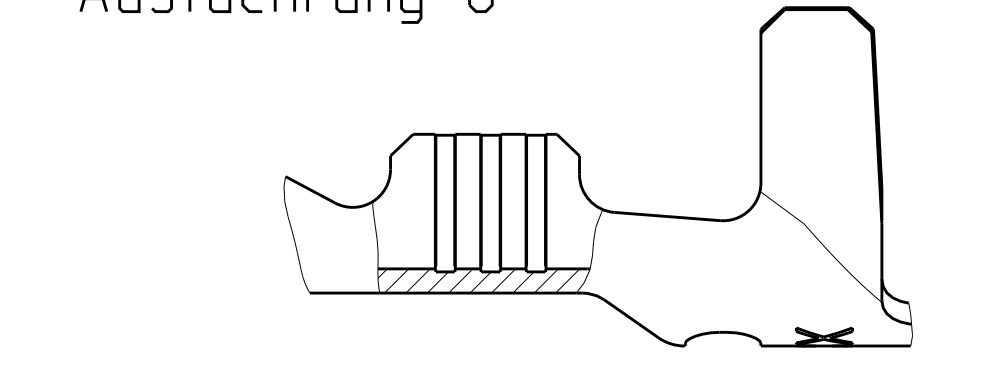

TE	DESIGN	MATERIAL	SURFACE	DGB	INSULATION	WIRE CRIMP	INSUL. CRIMP	APPLICATION TOOL	HAND TOOL	TE	TE
ORDER-NO.	REV	Ausfuehrung	Werkstoff	mm ²	mm	mm	mm	ANSCHLAGWERKZEUG	HANDZANGE	ORDER-NO.	ORDER-NO.
STRIPFORM			Oberflaeche		Isolations	Drathcrimp	Isolationscrimp	EXTRAKTIONSTOOL	Blindstopfen	SINGLE WIRE SEAL	SEALING PLUG
Bandware					Isolations	Bandware	Bandware	Ausdruckwerkzeug		Einzeldichtungssystem	Blindstopfen
					mm	mm	mm	No. 968107-1		(Kammerdurchmesser)	

THIS DRAWING IS A CONTROLLED DOCUMENT. DATE: 14 JUN 1999. DRAWN BY: K. Gerlach. CHECKED BY: M. Bleicher. APPROVED BY: [Signature].

PRODUCT GROUP DRAWING FOR TAB 2.8x0.8
Produktgruppenzeichnung fuer
Flachstecker 2.8x0.8

SCALE: 10:1. SHEET: 1 OF 1. CUSTOMER: Drawing.

X-ON Electronics

Largest Supplier of Electrical and Electronic Components

Click to view similar products for [Automotive Connectors](#) category:

Click to view products by [TE Connectivity](#) manufacturer:

Other Similar products are found below :

[003-018-000](#) [60403001](#) [60993906-B](#) [M902-2131](#) [M902-2161](#) [M902-2344](#) [72.330.1035.1](#) [73.353.4028.0](#) [F119300-B](#) [F166900](#) [F258300-B](#)
[F358300-B](#) [F407400](#) [F444110](#) [F487000](#) [F509500B-B](#) [827153-1](#) [8N1515-32-24P](#) [9-1326729-8](#) [925474-1](#) [928905-1](#) [964562-4](#) [968782-1](#)
[GT17SA-8DS-HU](#) [98891-1012](#) [98947-1016](#) [12004147](#) [12004475-L](#) [12010290](#) [12010309-B](#) [12015454](#) [12020219-B](#) [12041318-B](#) [12052225-](#)
[L](#) [12052466](#) [12064869](#) [12004327-B](#) [12015308](#) [12015384](#) [12015909](#) [1-21030-1](#) [12041254](#) [12041318](#) [12047946-B](#) [12047957](#) [12047957-L](#)
[12059473](#) [12066261](#) [12110546](#) [12110546-B](#)