

THIS DRAWING IS UNPUBLISHED. RELEASED FOR PUBLICATION 2007
 © COPYRIGHT 2007 BY - ALL RIGHTS RESERVED.

REVISIONS					
P	LTR	DESCRIPTION	DATE	DWN	APVD
C		REVISED PER ECO-13-016153	30OCT2013	C JV	DLG
D		REVISED PER ECO-17-003325	07JUN2017	AP	DG

PACKING UNIT:

100 KITS PACKED INTO CARDBOARD BOX

100 PIECES OF EACH COMPONENT OF THE KITS
PACKED INTO FOIL BAG AND PRINTED WITH TE - PN

VERPACKUNGSEINHEIT:

100 KITS IN KARTON VERPACKT

JEDE KOMPONENTE DER KITS ZU JE 100 STÜCK
IN KUNSTSTOFFBEUTEL VERPACKT UND MIT TE - PN BEDRUCKT

NOTE:

△ OBSOLETE PARTS: OBSOLETE CIS STREAMLINING PER D.RENAUD/D.SINISI

								OBSOLETE	OBSOLETE	OBSOLETE	OBSOLETE	OBSOLETE	OBSOLETE	OBSOLETE	OBSOLETE							
1-966 831-8	1-966 831-7	1-966 831-6	1-966 831-5	1-966 831-4	1-966 831-3	1-966 831-2	1-966 831-1	966 831-8	966 831-7	966 831-6	966 831-5	966 831-4	966 831-3	966 831-2	966 831-1							
2	2	2	2	2	2	2	2	-	-	-	-	-	-	-	-	1 987 198-2	JACK SCREW / HEBESCHRAUBE	St	ZINCED / VERZINKT BLACK / SCHWARZ			
-	-	-	-	-	-	-	-	2	2	2	2	2	2	2	2	5 747 942-1	JACK SCREW ASSY / HEBESCHRAUBENKIT	St / PVC	ZINCED / VERZINKT BLACK / SCHWARZ			
1	-	-	-	-	-	-	-	1	-	-	-	-	-	-	-	748 464-2	HSG ASSY. PLUG / STIFTSTECKERGEHÄUSE	26 POS. PA GV / St	BLACK / SCHWARZ TINNED / VERZINNT			
-	1	-	-	-	-	-	-	-	1	-	-	-	-	-	-	748 630-2	HSG ASSY. RCPT / BUCHSENSTECKERGEHÄUSE	26 POS. PA GV / St	BLACK / SCHWARZ TINNED / VERZINNT			
1	1	-	-	-	-	-	-	1	1	-	-	-	-	-	-	747 534-2	INSIDE SHIELD / INNERES SCHIRMBLECH	26 POS. St	TINNED / VERZINNT			
1	1	-	-	-	-	-	-	1	1	-	-	-	-	-	-	747 533-2	OUTSIDE SHIELD / ÄUSSERES SCHIRMBLECH	26 POS. St	TINNED / VERZINNT			
1	1	-	-	-	-	-	-	1	1	-	-	-	-	-	-	747 934-1	SHIELDING ENCLOSURE / ABDECKKAPPE	26 POS. PVC	BLACK / SCHWARZ			
-	-	1	-	-	-	-	-	-	-	1	-	-	-	-	-	748 465-2	HSG ASSY. PLUG / STIFTSTECKERGEHÄUSE	44 POS. PA GV / St	BLACK / SCHWARZ TINNED / VERZINNT			
-	-	-	1	-	-	-	-	-	-	-	1	-	-	-	-	748 631-2	HSG ASSY. RCPT / BUCHSENSTECKERGEHÄUSE	44 POS. PA GV / St	BLACK / SCHWARZ TINNED / VERZINNT			
-	-	1	1	-	-	-	-	-	-	1	1	-	-	-	-	747 550-2	INSIDE SHIELD / INNERES SCHIRMBLECH	44 POS. St	TINNED / VERZINNT			
-	-	1	1	-	-	-	-	-	-	1	1	-	-	-	-	747 549-2	OUTSIDE SHIELD / ÄUSSERES SCHIRMBLECH	44 POS. St	TINNED / VERZINNT			
-	-	1	1	-	-	-	-	-	-	1	1	-	-	-	-	747 936-1	SHIELDING ENCLOSURE / ABDECKKAPPE	44 POS. PVC	BLACK / SCHWARZ			
-	-	-	-	1	-	-	-	-	-	-	-	1	-	-	-	748 463-3	HSG ASSY. PLUG / STIFTSTECKERGEHÄUSE	15 POS. PA GV / St	BLACK / SCHWARZ TINNED / VERZINNT			
-	-	-	-	-	1	-	-	-	-	-	-	-	1	-	-	748 629-2	HSG ASSY. RCPT / BUCHSENSTECKERGEHÄUSE	15 POS. PA GV / St	BLACK / SCHWARZ TINNED / VERZINNT			
-	-	-	-	1	1	-	-	-	-	-	-	1	1	-	-	750 442-2	INSIDE SHIELD / INNERES SCHIRMBLECH	15 POS. SS	UNPLATED			
-	-	-	-	1	1	-	-	-	-	-	-	1	1	-	-	747 517-2	OUTSIDE SHIELD / ÄUSSERES SCHIRMBLECH	15 POS. SS	UNPLATED			
-	-	-	-	1	1	-	-	-	-	-	-	1	1	-	-	747 932-1	SHIELDING ENCLOSURE / ABDECKKAPPE	15 POS. PVC	BLACK / SCHWARZ			
-	-	-	-	-	-	1	-	-	-	-	-	-	-	1	-	748 466-2	HSG ASSY. PLUG / STIFTSTECKERGEHÄUSE	62 POS. PA GV / St	BLACK / SCHWARZ TINNED / VERZINNT			
-	-	-	-	-	-	-	1	-	-	-	-	-	-	-	1	748 632-2	HSG ASSY. RCPT / BUCHSENSTECKERGEHÄUSE	62 POS. PA GV / St	BLACK / SCHWARZ TINNED / VERZINNT			
-	-	-	-	-	-	1	1	-	-	-	-	-	-	1	1	747 566-2	INSIDE SHIELD / INNERES SCHIRMBLECH	62 POS. St	TINNED / VERZINNT			
-	-	-	-	-	-	1	1	-	-	-	-	-	-	1	1	747 565-2	OUTSIDE SHIELD / ÄUSSERES SCHIRMBLECH	62 POS. St	TINNED / VERZINNT			
-	-	-	-	-	-	1	1	-	-	-	-	-	-	1	1	747 938-1	SHIELDING ENCLOSURE / ABDECKKAPPE	62 POS. PVC	BLACK / SCHWARZ			
QUANTITY STÜCKZAHL																PART NO TEILENUMMER	DESCRIPTION OF THE COMPONENTS BENENNUNG DER EINZELTEILE				MATERIAL	SURFACE/COLOUR OBERFLÄCHE/FARBE

TYCO ELECTRONICS
ORDER NUMBER
BESTELLNUMMER

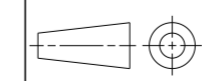

THIS DRAWING IS A CONTROLLED DOCUMENT. DWN M.STEIN 02NOV1995
 CHK M.DAUBER 02NOV1995

DIMENSIONS: mm TOLERANCES UNLESS OTHERWISE SPECIFIED:

0 PLC	±
1 PLC	±
2 PLC	±
3 PLC	±
4 PLC	±
ANGLES	±
FINISH	

MATERIAL: -

APVD: -

PRODUCT SPEC: -

APPLICATION SPEC: -

WEIGHT: -

CUSTOMER DRAWING

STE TE Connectivity

NAME: HD22 RECEPTACLE AND PLUG CONNECTOR KIT
BUCHSEN- UND STIFTSTECKERKIT

SIZE: A2 CAGE CODE: 00779 DRAWING NO: C-966831 RESTRICTED TO: -

SCALE: DRAWING SHEET 1 OF 1 REV D

X-ON Electronics

Largest Supplier of Electrical and Electronic Components

Click to view similar products for [High Speed/Modular Connectors](#) category:

Click to view products by [TE Connectivity](#) manufacturer:

Other Similar products are found below :

[2332816-1](#) [89006-1137LF](#) [650827-1](#) [65762-001LF](#) [73474-201LF](#) [74040-1346](#) [74075-0267](#) [88911-201LF](#) [9514M0C20D](#) [1410191-1](#)
[1410337-1](#) [1410368-3](#) [1410964-2](#) [1410326-3](#) [1410367-3](#) [1410971-4](#) [1467833-1](#) [2000877-1](#) [2000878-1](#) [2041314-1](#) [2065387-1](#) [2187307-1](#)
[2187462-1](#) [2226278-6](#) [KA81-07](#) [91290-101LF](#) [1934290-1](#) [2000875-1](#) [2065917-1](#) [2102736-2](#) [FSR-40](#) [2169868-2](#) [2226279-2](#) [22354-8](#) [437-](#)
[5040-000](#) [5-1393565-0](#) [532449-3](#) [532803-2](#) [34745-0001](#) [0740618502](#) [0760151403](#) [0760551105](#) [0760551608](#) [0761451128](#) [0761651124](#)
[0761655108](#) [0761659807](#) [0769853208](#) [0736440217](#) [0758324203](#)