

STANDARD CRIMP

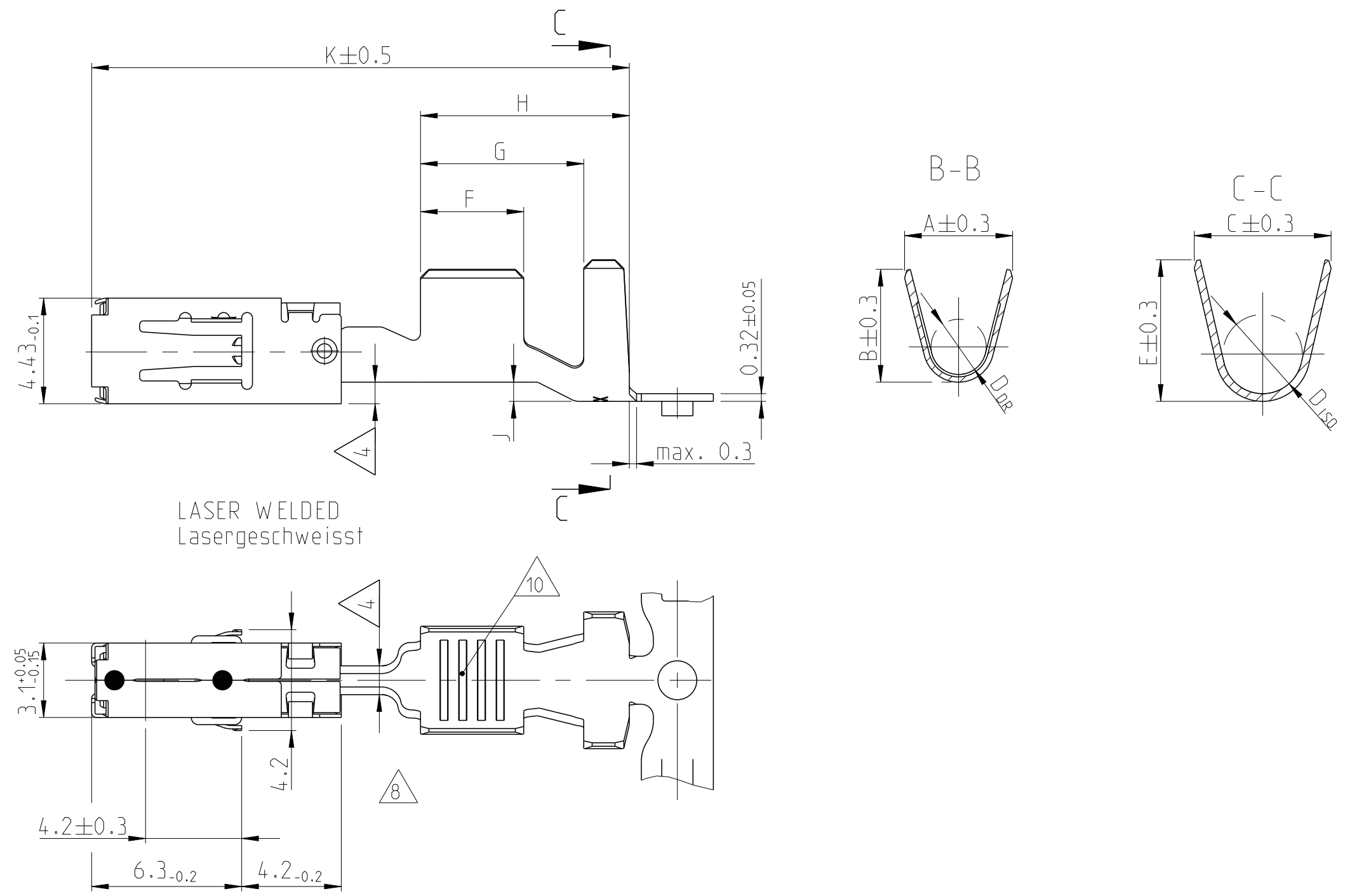

LASER WELDED
Lasergeschweisst

SERRATION DESIGN Serration Ausfuehrung F14

DESIGN / Ausfuehrung
0,5 - 1,0mm²

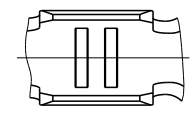

DESIGN / Ausfuehrung
0,2 - 0,5mm²
1,5 - 2,5mm²
12 AWG

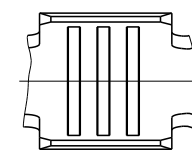

DESIGN / Ausfuehrung
4,0mm²

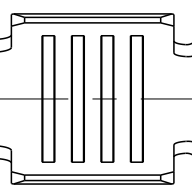

SINGLE WIRE SEAL Einzeldichtungssystem

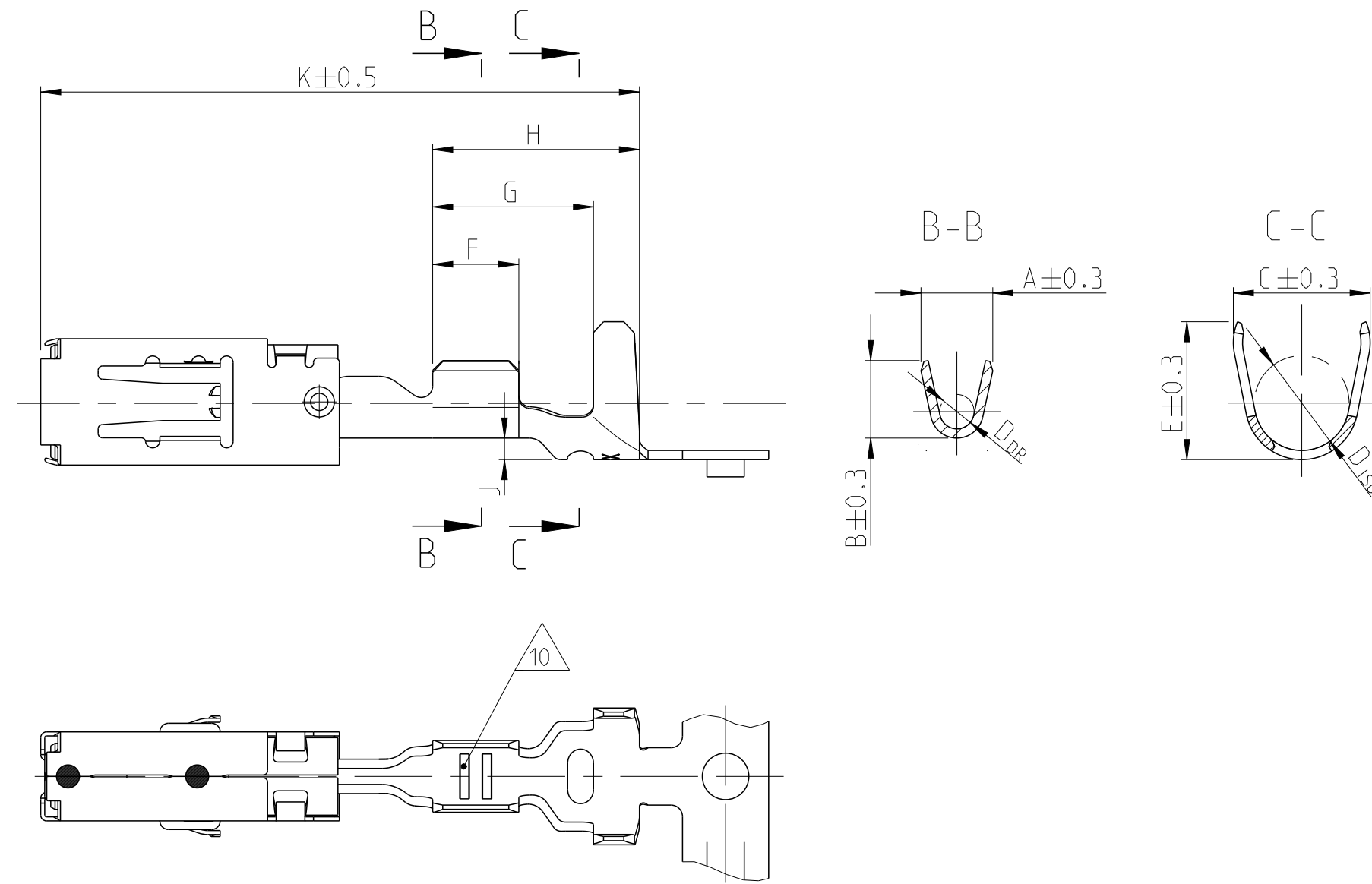

REVISIONS				
P.	LTN.	DESCRIPTION	DATE	APPV.
J11		NOTE B ADDED. TABLE UPDATE WITH PNs 1-...-4	17MAY2017	MAH. SBEC
J12		PNs 1-968855-4, 1-968857-4, 1-968859-4 OBSOLETE ON DRW.	05MAR2018	MAH. SBEC
J13		Added PN 2-968851-3, 2-968853-3, 2-968857-3 and 2-968859-3	07MAY2018	FRAN. BECK
J14		Obsolete PN 1-968882-1/-2/-3; PN 1-968880-1/-3	11NOV2020	FRAN. BECK

NOTES:
Bemerkungen:

1 MATING PART SEE INTERFACE DRAWING
TE-NO.: 114-18230-002
Gegensiecker nach Ausfuehrungsvorschrift
TE-Nr.: 114-18230-002

2 SURFACE:
- PRE TIN PLATED 1 TO 3 µm
- GOLD PLATED MIN. 2 µm (ONLY CONTACT AREA)
- SILVER PLATED 3 TO 5 µm (ONLY CONTACT AREA)
Oberflaeche:
- verzinkt 1 bis 3 µm
- vergoldet min. 2 µm (nur Kontaktzone)
- versilbert 3 bis 5 µm (nur Kontaktzone)

3 DOUBLE CRIMPS ARE ONLY POSSIBLE WITH
APPLICATORS AUTHORIZED BY TE (NO HAND TOOL)
SUITABLE TOOLS ON REQUEST
Doppelanschlaege sind nur mit von TE zugelassenen
Anschlagwerkzeugen moeglich (keine Handzangen)
passende Werkzeuge auf Anfrage

4 GAUGE INSPECTION
Lehrenpruefung

5 DETAILS OF DESIGN ARE LEFT TO MANUFACTURER
Einzelheiten der Ausfuehrung bleiben dem Hersteller ueberlassen

6 ONLY GERMAN LANGUAGE VERSION SHALL BE BINDING
Massgebend ist der deutsche Text

7 PUNCHING OIL RAZIOL CLF 11 SG
Stanzoeel:

8 "Ag+" MARKING ON SILVER PLATED VERSIONS FOR INCREASED LIMIT TEMPERATURE
"Ag+" Markierung auf versilberten Versionen fuer erhöhte Grenztemperatur

9 968880 nicht fuer Neuanwendungen, wird ersetzt durch 2141857
968882 nicht fuer Neuanwendungen, wird ersetzt durch 2141859
10 968880 SUPERSEDED BY PN 2141857
968882 SUPERSEDED BY PN 2141859

10 Unterschiedliche Ausfuehrung und Anzahl der Rillen moeglich
DIFFERENT FORM AND NUMBER OF THE SERRATIONS POSSIBLE

VERSION Ausfuehrung	ORDER-NO. STRIP-FORM Bestell-Nr. Bandware	REV	BODY Werkstoff	SURFACE Oberflaeche	WIRE SIZE RANGE Leiter- quer- schnitt mm ²	INSULATION DIAMETER Isolations- durchmesser mm	CRIMP DIMENSIONS / Crimpabmessungen mm											WEIGHT Gewicht g	SINGLE WIRE SEAL Einzeldichtung	TE CONNECTIVITY NO. DEAD END PLUG Blindstopfen	TE CONNECTIVITY NO.	APPLICATION TOOLS Verarbeitungswerkzeuge
							A	B	D _{DR}	C	E	D _{ISO}	F	G	H	J	K					
SINGLE WIRE SEAL / Einzeldichtung	1-1719506-3	A	CUNISI X10CPN18-8	SILVER PLATED versilbert	12 AWG	3.0	4.0	4.2	2.0	5.0	5.0	3.5	3.5	5.9	7.5	0.8	21.0	0.59	828905-1	828922-1		
	1-1719506-1	A		PRE TIN PLATED verzinkt	-	3.8	-	-	-	-	-	-	-	-	-	-	-	-	-	-	-	-
	2-968859-3	D		SILVER PLATED versilbert	4	3.4	4.5	4.7	2.3	6.0	6.0	4.3	4.3	7.0	8.5	1.25	22.6	0.65	828985-1	828986-1		
	1-968859-3	E		SILVER PLATED versilbert	-	3.7	-	-	-	-	-	-	-	-	-	-	-	-	-	-	-	-
	1-968859-1	E		PRE TIN PLATED verzinkt	-	3.7	-	-	-	-	-	-	-	-	-	-	-	-	-	-	-	-
	2-968857-3	B		SILVER PLATED versilbert	1.5	2.2	3.6	3.8	1.7	5.0	5.0	3.5	3.5	6.0	7.6	0.8	21.0	0.58	828905-1	828922-1		
	1-968857-3	E		SILVER PLATED versilbert	-	2.2	-	-	-	-	-	-	-	-	-	-	-	-	-	-	-	-
	1-968857-2	D		GOLD PLATED vergoldet	2.5	3.0	-	-	-	-	-	-	-	-	-	-	-	-	-	-	-	-
	1-968857-1	E		PRE TIN PLATED verzinkt	-	3.0	-	-	-	-	-	-	-	-	-	-	-	-	-	-	-	-
	1-968855-3	E		SILVER PLATED versilbert	0.5	1.4	2.5	2.7	1.2	4.8	4.8	3.3	3.0	5.6	7.2	0.75	21.0	0.54	828904-1	828922-1		
	1-968855-2	E		GOLD PLATED vergoldet	-	1.4	-	-	-	-	-	-	-	-	-	-	-	-	-	-	-	-
	1-968855-1	E		PRE TIN PLATED verzinkt	1.0	2.1	-	-	-	-	-	-	-	-	-	-	-	-	-	-	-	-
	1-2141859-3	A		SILVER PLATED versilbert	0.2	1.2	2.4	2.3	1.0	4.5	4.5	3.2	2.5	5.1	6.7	0.75	21.0	0.52	828904-1	828922-1		
	1-2141859-2	A		GOLD PLATED vergoldet	-	1.2	-	-	-	-	-	-	-	-	-	-	-	-	-	-	-	-
	1-2141859-1	A		PRE TIN PLATED verzinkt	0.5	1.4	-	-	-	-	-	-	-	-	-	-	-	-	-	-	-	-
	1-968882-3	E		SILVER PLATED versilbert	0.2	1.2	2.1	2.1	0.8	4.5	4.5	3.2	2.5	5.1	6.7	0.75	21.0	0.52	828904-1	828922-1		
	1-968882-2	E		GOLD PLATED vergoldet	-	1.2	-	-	-	-	-	-	-	-	-	-	-	-	-	-	-	-
	1-968882-1	E		PRE TIN PLATED verzinkt	0.5	1.4	-	-	-	-	-	-	-	-	-	-	-	-	-	-	-	-
STANDARD CRIMP	2-968853-3	D	SILVER PLATED versilbert	4	2.7	4.5	4.7	2.3	5.7	5.9	3.3	4.3	6.8	8.7	0.8	22.6	0.65	-	-			
	1-968853-3	E	SILVER PLATED versilbert	-	2.7	-	-	-	-	-	-	-	-	-	-	-	-	-	-	-		
	1-968853-1	E	PRE TIN PLATED verzinkt	-	3.7	-	-	-	-	-	-	-	-	-	-	-	-	-	-	-		
	2-968851-3	D	SILVER PLATED versilbert	1.5	2.2	3.6	3.8	1.7	4.6	5.0	2.6	3.5	5.1	6.7	0.3	20.2	0.56	-	-			
	1-968851-3	E	SILVER PLATED versilbert	-	2.2	-	-	-	-	-	-	-	-	-	-	-	-	-	-	-		
	1-968851-2	E	GOLD PLATED vergoldet	2.5	3.0	-	-	-	-	-	-	-	-	-	-	-	-	-	-	-		
	1-968851-1	E	PRE TIN PLATED verzinkt	-	3.0	-	-	-	-	-	-	-	-	-	-	-	-	-	-	-		
	1-968849-3	E	SILVER PLATED versilbert	0.5	1.4	2.5	2.7	1.2	3.3	3.5	1.8	3.0	4.6	6.2	0.2	20.2	0.51	-	-			
	1-968849-2	E	GOLD PLATED vergoldet	-	1.4	-	-	-	-	-	-	-	-	-	-	-	-	-	-	-		
	1-968849-1	E	PRE TIN PLATED verzinkt	1.0	2.1	-	-	-	-	-	-	-	-	-	-	-	-	-	-	-		
	1-2141857-3	A	SILVER PLATED versilbert	0.2	1.2	2.4	2.3	1.0	2.9	2.9	1.4	2.5	3.8	5.7	0.2	20.2	0.48	-	-			
	1-2141857-1	A	PRE TIN PLATED verzinkt	0.5	1.4	-	-	-	-	-	-	-	-	-	-	-	-	-	-	-		
1-968880-3	E	SILVER PLATED versilbert	0.2	1.2	2.1	2.1	0.8	2.9	2.9	1.4	2.5	3.8	5.7	0.2	20.2	0.48	-	-				
1-968880-1	E	PRE TIN PLATED verzinkt	0.5	1.4	-	-	-	-	-	-	-	-	-	-	-	-	-	-	-			

SEE APPLICATION SPECIFICATION 114-18148
siehe Verarbeitungsspezifikation 114-18148

THIS DRAWING IS A CONTROLLED DOCUMENT.		OWN S. Blidar	22SEP97	STE TE Connectivity
DIMENSIONS: mm		CHK G. Hotea	22SEP97	
TOLERANCES UNLESS OTHERWISE SPECIFIED: mm		APPV J. Woller	22SEP97	NAME PRODUCT GROUP DRAWING FOR Tabellenzeichnung fuer AMP MCP 2.8
MATERIAL		FINISH	APPL. SPEC 108-18513	
CUSTOMER DRAWING		SIZE A1	CAGE CODE 00779	DRAWING NO. 114-18148
SCALE 5:1		SHEET 1	OF 1	REV J14

X-ON Electronics

Largest Supplier of Electrical and Electronic Components

Click to view similar products for [Automotive Connectors](#) category:

Click to view products by [TE Connectivity](#) manufacturer:

Other Similar products are found below :

[003-018-000](#) [60403001](#) [60993906-B](#) [M902-2131](#) [M902-2161](#) [72.330.1035.1](#) [73.353.4028.0](#) [F119300-B](#) [F166900](#) [F258300-B](#) [F358300-B](#)
[F407400](#) [F444110](#) [F487000](#) [F509500B-B](#) [827153-1](#) [8N1515-32-24P](#) [9-1326729-8](#) [925474-1](#) [928905-1](#) [964562-4](#) [968782-1](#) [GT17SA-8DS-](#)
[HU](#) [98891-1012](#) [98947-1016](#) [12004147](#) [12004475-L](#) [12010290](#) [12010309-B](#) [12015454](#) [12020219-B](#) [12020308](#) [12041318-B](#) [12052225-L](#)
[12052466](#) [12059125](#) [12064869](#) [12004327-B](#) [12010503-B](#) [12015308](#) [12015384](#) [12015909](#) [1-21030-1](#) [12041254](#) [12041318](#) [12047946-B](#)
[12047957](#) [12047957-L](#) [12059473](#) [12066261](#)