

STANDARD CRIMP

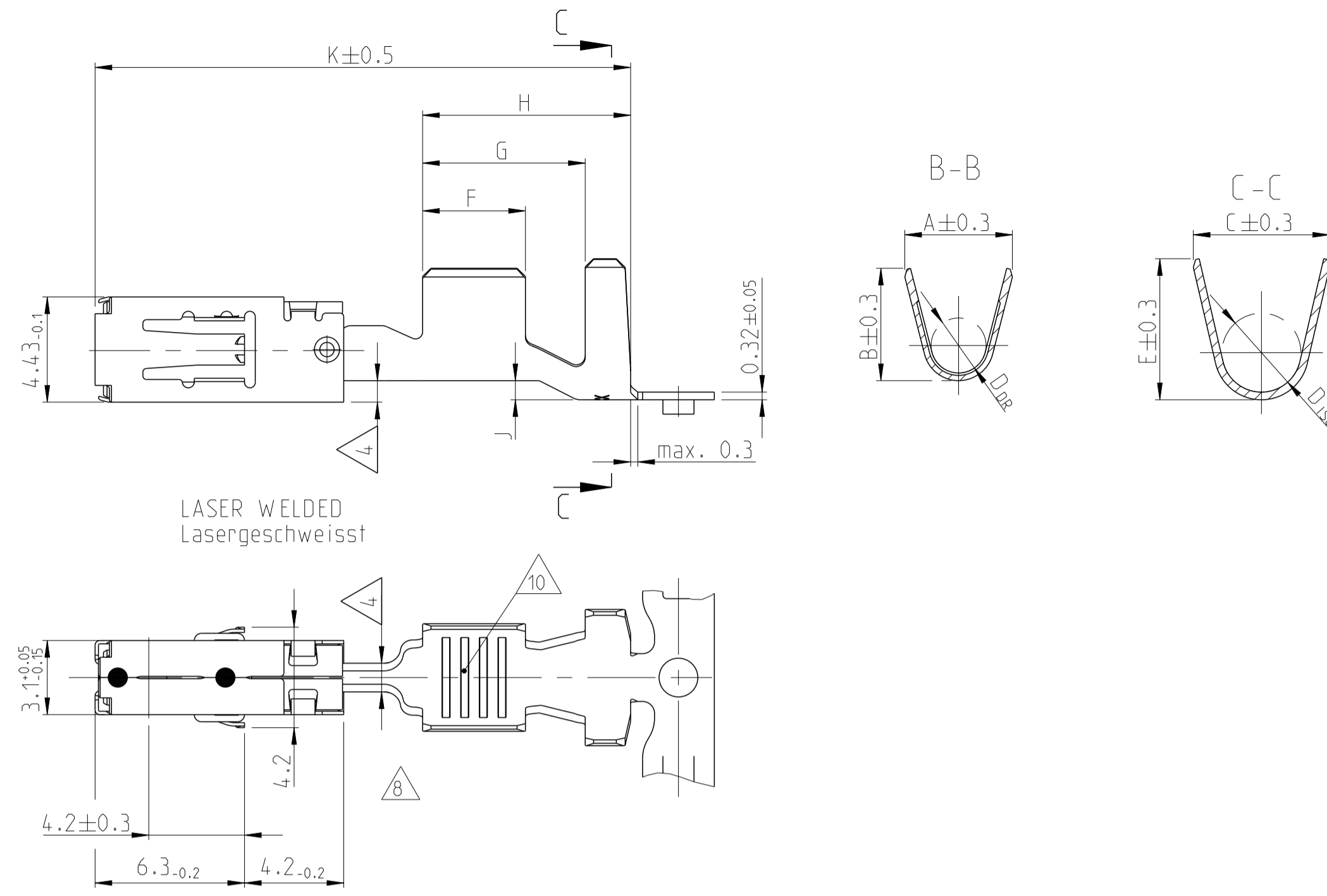

SERRATION DESIGN

Serration Ausfuehrung F14

DESIGN / Ausfuehrung
0,5 - 1,0mm²

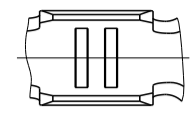

DESIGN / Ausfuehrung
0,2 - 0,5mm²
1,5 - 2,5mm²
12 AWG

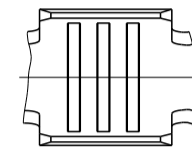

DESIGN / Ausfuehrung
4,0mm²

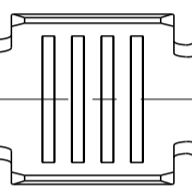

SINGLE WIRE SEAL

Einzelichtungssystem

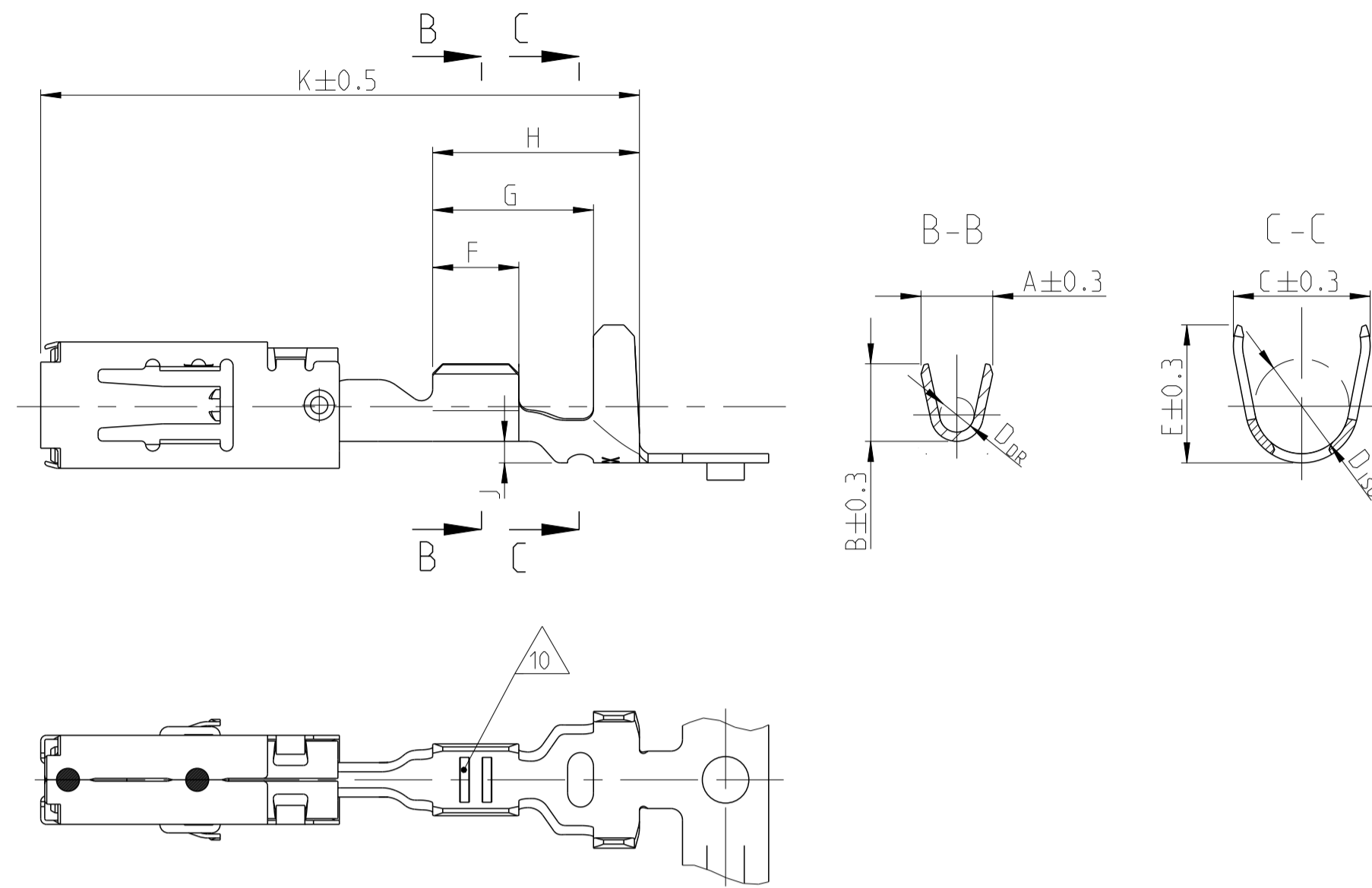

REVISIONS				
P.	LTN	DESCRIPTION	DATE	APVD
J11		NOTE B ADDED. TABLE UPDATE WITH PNs 1-...-4	17MAY2017	MAH. SBEC
J12		PNs 1-968855-4, 1-968857-4, 1-968859-4 OBSOLETE ON DRW.	05MAR2018	MAH. SBEC
J13		Added PN 2-968851-3, 2-968853-3, 2-968857-3 and 2-968859-3	07MAY2018	FRAN. BECK
J14		Obsolete PN 1-968882-1/-2/-3; PN 1-968880-1/-3	11NOV2020	FRAN. BECK

NOTES:
Bemerkungen:

1 MATING PART SEE INTERFACE DRAWING
TE-NO.: 114-18230-002
Gegensecker nach Ausfuehrungsvorschrift
TE-Nr.: 114-18230-002

2 SURFACE:
- PRE TIN PLATED 1 TO 3 μm
- GOLD PLATED MIN. 2 μm (ONLY CONTACT AREA)
- SILVER PLATED 3 TO 5 μm (ONLY CONTACT AREA)
Oberflaeche:
- verzinkt 1 bis 3 μm
- vergoldet min. 2 μm (nur Kontaktzone)
- versilbert 3 bis 5 μm (nur Kontaktzone)

3 DOUBLE CRIMPS ARE ONLY POSSIBLE WITH
APPLICATORS AUTHORIZED BY TE (NO HAND TOOL)
SUITABLE TOOLS ON REQUEST
Doppelanschlaege sind nur mit von TE zugelassenen
Anschlagwerkzeugen moeglich (keine Handzangen)
passende Werkzeuge auf Anfrage

4 GAUGE INSPECTION
Lehrenpruefung

5 DETAILS OF DESIGN ARE LEFT TO MANUFACTURER
Einzelheiten der Ausfuehrung bleiben dem Hersteller ueberlassen

6 ONLY GERMAN LANGUAGE VERSION SHALL BE BINDING
Massgebend ist der deutsche Text

7 PUNCHING OIL RAZIOL CLF 11 SG
Stanzoeel:

8 "Ag+" MARKING ON SILVER PLATED VERSIONS FOR INCREASED LIMIT TEMPERATURE
"Ag+" Markierung auf versilberten Versionen fuer erhoehte Grenztemperatur

9 968880 nicht fuer Neuanwendungen, wird ersetzt durch 2141857
968882 nicht fuer Neuanwendungen, wird ersetzt durch 2141859
10 968880 SUPERSEDED BY PN 2141857
968882 SUPERSEDED BY PN 2141859

10 Unterschiedliche Ausfuehrung und Anzahl der Rillen moeglich
DIFFERENT FORM AND NUMBER OF THE SERRATIONS POSSIBLE

VERSION Ausfuehrung	ORDER-NO. STRIP-FORM Bestell-Nr. Bandware	REV	BODY Werkstoff	SURFACE Oberflaeche	WIRE SIZE RANGE Leiter- quer- schnitt mm ²	INSULATION DIAMETER Isolations- durchmesser mm	CRIMP DIMENSIONS / Crimpabmessungen mm											WEIGHT Gewicht g	SINGLE WIRE SEAL Einzelichtung	TE CONNECTIVITY NO. DEAD END PLUG Blindstopfen	TE CONNECTIVITY NO.	APPLICATION TOOLS Verarbeitungswerkzeuge
							A	B	D _{DR}	C	E	D _{ISO}	F	G	H	J	K					
1-1719506-3	A			SILVER PLATED versilbert	12 AWG	3.0	4.0	4.2	2.0	5.0	5.0	3.5	3.5	5.9	7.5	0.8	21.0	0.59	828905-1	828922-1		
1-1719506-1	A			PRE TIN PLATED verzinkt		3.8																
2-968859-3	D			SILVER PLATED versilbert	4	3.4	4.5	4.7	2.3	6.0	6.0	4.3	4.3	7.0	8.5	1.25	22.6	0.65	828985-1	828986-1		
1-968859-3	E			SILVER PLATED versilbert		-																
1-968859-1	E			PRE TIN PLATED verzinkt		3.7																
2-968857-3	B			SILVER PLATED versilbert	1.5	2.2	3.6	3.8	1.7	5.0	5.0	3.5	3.5	6.0	7.6	0.8	21.0	0.58	828905-1	828922-1		
1-968857-3	E			SILVER PLATED versilbert		-																
1-968857-2	D			GOLD PLATED vergoldet	2.5	3.0																
1-968857-1	E			PRE TIN PLATED verzinkt		-																
1-968855-3	E			SILVER PLATED versilbert	0.5	1.4	2.5	2.7	1.2	4.8	4.8	3.3	3.0	5.6	7.2	0.75	21.0	0.54	828904-1	828922-1		
1-968855-2	E			GOLD PLATED vergoldet		-																
1-968855-1	E			PRE TIN PLATED verzinkt	1.0	2.1																
1-2141859-3	A			SILVER PLATED versilbert	0.2	1.2	2.4	2.3	1.0	4.5	4.5	3.2	2.5	5.1	6.7	0.75	21.0	0.52	828904-1	828922-1		
1-2141859-2	A			GOLD PLATED vergoldet		-																
1-2141859-1	A			PRE TIN PLATED verzinkt	0.5	1.4																
1-968882-3	E			SILVER PLATED versilbert	0.2	1.2	2.1	2.1	0.8	4.5	4.5	3.2	2.5	5.1	6.7	0.75	21.0	0.52	828904-1	828922-1		
1-968882-2	E			GOLD PLATED vergoldet		-																
1-968882-1	E			PRE TIN PLATED verzinkt	0.5	1.4																
2-968853-3	D			SILVER PLATED versilbert	4	2.7	4.5	4.7	2.3	5.7	5.9	3.3	4.3	6.8	8.7	0.8	22.6	0.65	-	-		
1-968853-3	E			SILVER PLATED versilbert		-																
1-968853-1	E			PRE TIN PLATED verzinkt		3.7																
2-968851-3	D			SILVER PLATED versilbert	1.5	2.2	3.6	3.8	1.7	4.6	5.0	2.6	3.5	5.1	6.7	0.3	20.2	0.56	-	-		
1-968851-3	E			SILVER PLATED versilbert		-																
1-968851-2	E			GOLD PLATED vergoldet	2.5	3.0																
1-968851-1	E			PRE TIN PLATED verzinkt		-																
1-968849-3	E			SILVER PLATED versilbert	0.5	1.4	2.5	2.7	1.2	3.3	3.5	1.8	3.0	4.6	6.2	0.2	20.2	0.51	-	-		
1-968849-2	E			GOLD PLATED vergoldet		-																
1-968849-1	E			PRE TIN PLATED verzinkt	1.0	2.1																
1-2141857-3	A			SILVER PLATED versilbert	0.2	1.2	2.4	2.3	1.0	2.9	2.9	1.4	2.5	3.8	5.7	0.2	20.2	0.48	-	-		
1-2141857-1	A			PRE TIN PLATED verzinkt	0.5	1.4																
1-968880-3	E			SILVER PLATED versilbert	0.2	1.2	2.1	2.1	0.8	2.9	2.9	1.4	2.5	3.8	5.7	0.2	20.2	0.48	-	-		
1-968880-1	E			PRE TIN PLATED verzinkt	0.5	1.4																

SEE APPLICATION SPECIFICATION 114-18148
siehe Verarbeitungsspezifikation 114-18148

THIS DRAWING IS A CONTROLLED DOCUMENT.		OWN S. Blidar	22SEP97	 TE Connectivity
DIMENSIONS: mm		CHK G. Hotea	22SEP97	
TOLERANCES UNLESS OTHERWISE SPECIFIED: ±0.2		APVD J. Woller	22SEP97	NAME PRODUCT SPEC
MATERIAL		APPLICATION SPEC		PRODUCT GROUP DRAWING FOR Tabellenzeichnung fuer AMP MCP 2.8
FINISH		WEIGHT		SIZE A1
CUSTOMER DRAWING		SCALE 5:1		CAGE CODE 00779
		DRAWING NO. 114-18148		DRAWING NO. 1355036
		SHEET 1 OF 1		REVISIONS REV 1

X-ON Electronics

Largest Supplier of Electrical and Electronic Components

Click to view similar products for [Automotive Connectors](#) category:

Click to view products by [TE Connectivity](#) manufacturer:

Other Similar products are found below :

[003-018-000](#) [60403001](#) [60993906-B](#) [M902-2131](#) [M902-2161](#) [M902-2344](#) [72.330.1035.1](#) [73.353.4028.0](#) [F119300-B](#) [F166900](#) [F258300-B](#)
[F358300-B](#) [F407400](#) [F444110](#) [F487000](#) [F509500B-B](#) [827153-1](#) [8N1515-32-24P](#) [9-1326729-8](#) [925474-1](#) [928905-1](#) [964562-4](#) [968782-1](#)
[GT17SA-8DS-HU](#) [98891-1012](#) [98947-1016](#) [12004147](#) [12004475-L](#) [12010290](#) [12010309-B](#) [12015454](#) [12020219-B](#) [12041318-B](#) [12052225-](#)
[L](#) [12052466](#) [12064869](#) [12004327-B](#) [12015308](#) [12015384](#) [12015909](#) [1-21030-1](#) [12041254](#) [12041318](#) [12047946-B](#) [12047957](#) [12047957-L](#)
[12059473](#) [12066261](#) [12110546](#) [12110546-B](#)