

THIS DRAWING IS UNPUBLISHED. RELEASED FOR PUBLICATION 20
 © COPYRIGHT 20 BY - ALL RIGHTS RESERVED.

| LOC | | DIST | | REVISIONS | | | |
|-----|-----|-------------|---------------------------|-----------|------|----|--|
| P | LTR | DESCRIPTION | DATE | DWN | APVD | | |
| AF | - | A3 | REVISED PER ECR-15-006926 | 05MAY15 | JR | KR | |

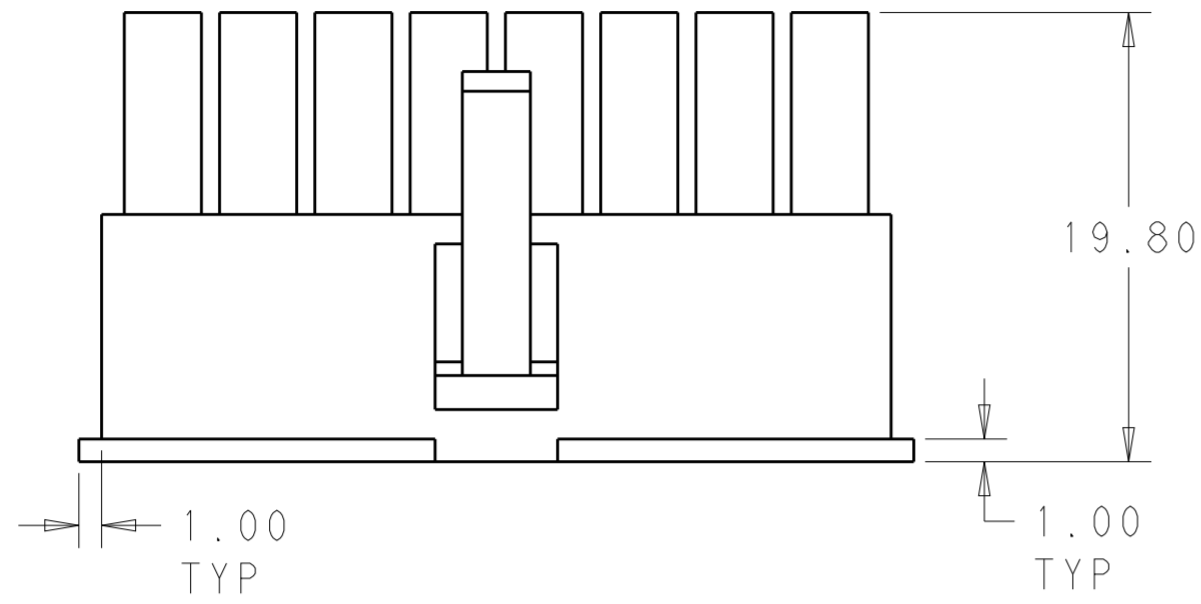

- 1 POLYAMIDE, UL94V-2, COLOR- WHITE
- 2 FLAMMABILITY V2 FOR THICKNESS 0.38mm, 1.5mm NAD 3.0mm PER IEC 60695-11-10.
- 3 GLOW-WIRE FLAMMABILITY (GWFI) 800°C FOR THICKNESS 0.38mm AND 0.75mm PER IEC 60695-2-12.
- 4 GLOW-WIRE FLAMMABILITY (GWFI) 960°C FOR THICKNESS 1.5mm AND 3.0mm PER IEC 60695-2-12.
- 5 GLOW-WIRE IGNITION (GWIT) 825°C FOR THICKNESS 0.38mm, 0.75mm, 1.5mm AND 3.0mm PER IEC 60695-2-13.
- 6 COMPLY WITH GLOW WIRE REQUIREMENTS FOR PARTS OF NON-METALLIC MATERIAL SUPPORTING A CURRENT-CARRYING CONNECTION DETAILED IN IEC 60335-1, SECTION 30(GWT).

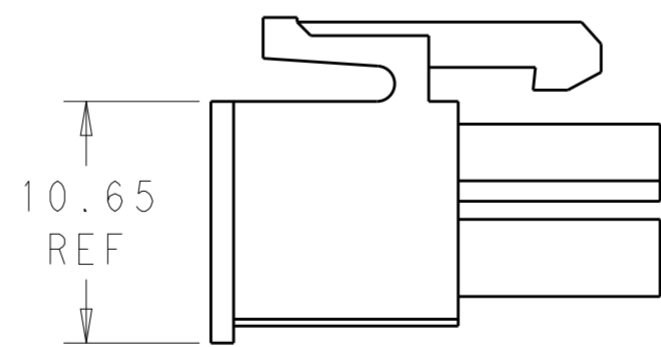
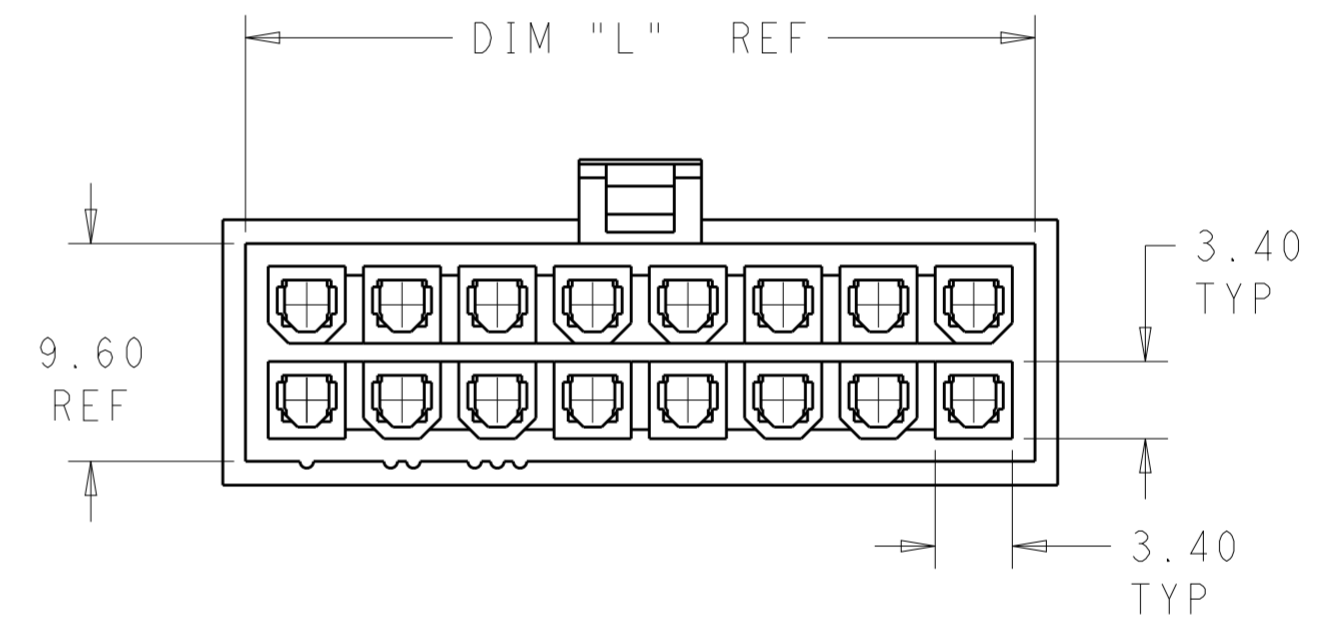
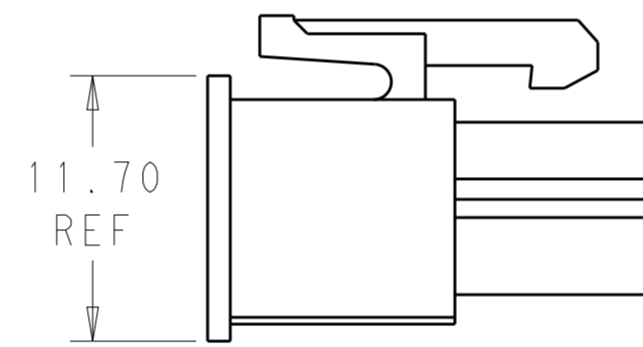
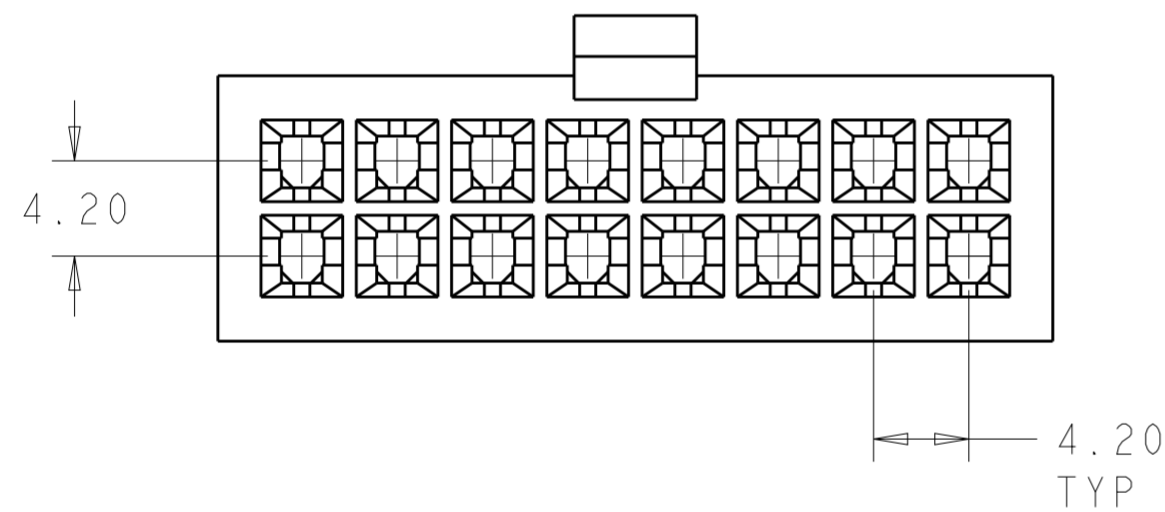

SCALE 3:1
FOR -2 PART ONLY

| | | |
|-------|------------|-------------|
| 51.60 | 24 | 2-1969603-4 |
| 47.40 | 22 | 2-1969603-2 |
| 43.20 | 20 | 2-1969603-0 |
| 39.00 | 18 | 1-1969603-8 |
| 34.80 | 16 | 1-1969603-6 |
| 30.60 | 14 | 1-1969603-4 |
| 26.40 | 12 | 1-1969603-2 |
| 22.20 | 10 | 1-1969603-0 |
| 18.00 | 8 | 1969603-8 |
| 13.80 | 6 | 1969603-6 |
| 9.60 | 4 | 1969603-4 |
| 5.40 | 2 | 1969603-2 |
| DIM L | NO. OF POS | PART NO. |

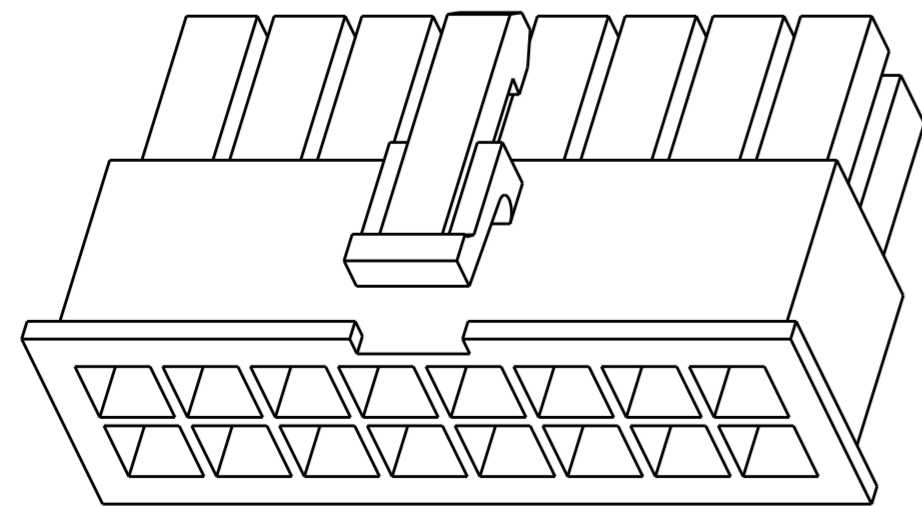

| | | | | | | |
|--|--|------------------|---------------|----------|----------------------------|--|
| THIS DRAWING IS A CONTROLLED DOCUMENT. | | DWN | JR RUTH | 26SEPT13 | STE TE Connectivity | |
| DIMENSIONS: | | CHK | KURT RANDOLPH | 26SEPT13 | | |
| TOLERANCES UNLESS OTHERWISE SPECIFIED: | | APVD | KURT RANDOLPH | 26SEPT13 | | |
| mm | | PRODUCT SPEC | | | | |
| 0 PLC ± | | APPLICATION SPEC | | | NAME | RECEPTACLE HOUSING, VAL-U-LOK, GLOW WIRE |
| 1 PLC ± | | WEIGHT | | | SIZE | A200779 |
| 2 PLC ±0.25 | | Customer Drawing | | | CAGE CODE | C-1969603 |
| 3 PLC ± | | SCALE | 3:1 | | DRAWING NO | 1969603 |
| 4 PLC ± | | SHEET | 1 OF 1 | | RESTRICTED TO | - |
| ANGLES ± | | REV | A3 | | | |
| FINISH | | | | | | |

X-ON Electronics

Largest Supplier of Electrical and Electronic Components

Click to view similar products for [Power to the Board](#) category:

Click to view products by [TE Connectivity](#) manufacturer:

Other Similar products are found below :

[6450171-4](#) [6450552-7](#) [6600323-8](#) [6643429-1](#) [6646040-2](#) [6651939-1](#) [6766604-1](#) [120959-1](#) [1393557-2](#) [1393532-2](#) [1393532-3](#) [1393532-4](#)
[1393557-1](#) [1600812-5](#) [1-6450861-2](#) [1744132-7](#) [1761122-1](#) [1766250-1](#) [1892109-1](#) [2-6450860-5](#) [2-6450870-0](#) [1-6450161-4](#) [1-6450850-6](#) [1-](#)
[6450869-6](#) [1645526-2](#) [1-6600130-0](#) [2005243-2](#) [377-0020-11130](#) [TE34-12-16P-F0](#) [51700-10201602AALF](#) [5-6450830-6](#) [5646956-4](#) [377-](#)
[0080-11131A](#) [4-6450830-9](#) [4-6600333-3](#) [10125416-4050LF](#) [10130248-005LF](#) [6600320-3](#) [3-6450860-5](#) [1888123-2](#) [6450166-1](#) [6643978-1](#)
[6766605-1](#) [701-15-02109](#) [N11444](#) [6651938-1](#) [6450810-7](#) [46437-1112](#) [1-1589677-8](#) [5646956-5](#)