

LOC	DIST	REV	DATE	BY	CHK	APPV
D		REV PER ECO 12-014265	8-7-12	CT	DH	
F		ECO-13-004755	26MAR2013	KG	DH	
G		ECO-14-017030	25NOV2014	MGM	CT	

- 1 MATERIAL:  
CONTACT - COPPER ALLOY  
HOUSING - LCP, COLOR - BLACK
- 2 FINISH:  
MATING AREA: 1.27µm MIN GOLD OVER  
1.25µm MIN NICKEL
- 3 DATUMS AND BASIC DIMENSIONS ESTABLISHED BY CUSTOMER.
- 4 REFERENCE APPLICATION SPEC 114-13267 FOR RECOMMENDED  
PLATING THRU HOLE DIAMETER AND PLATING THICKNESSES.
- 5 FINISH:  
COMPLIANT PIN AREA: 0.38µm MIN BRIGHT TIN LEAD OVER  
1.27µm MIN NICKEL
- 6 FINISH:  
COMPLIANT PIN AREA: 0.38µm MIN MATTE TIN OVER  
1.27µm MIN NICKEL

4  
 $\oplus \text{ } \varnothing 0.05 \text{ } \ominus \text{ } X \text{ } Y$   
 FINISHED HOLE SIZE  
 AND PLATED THRU HOLES

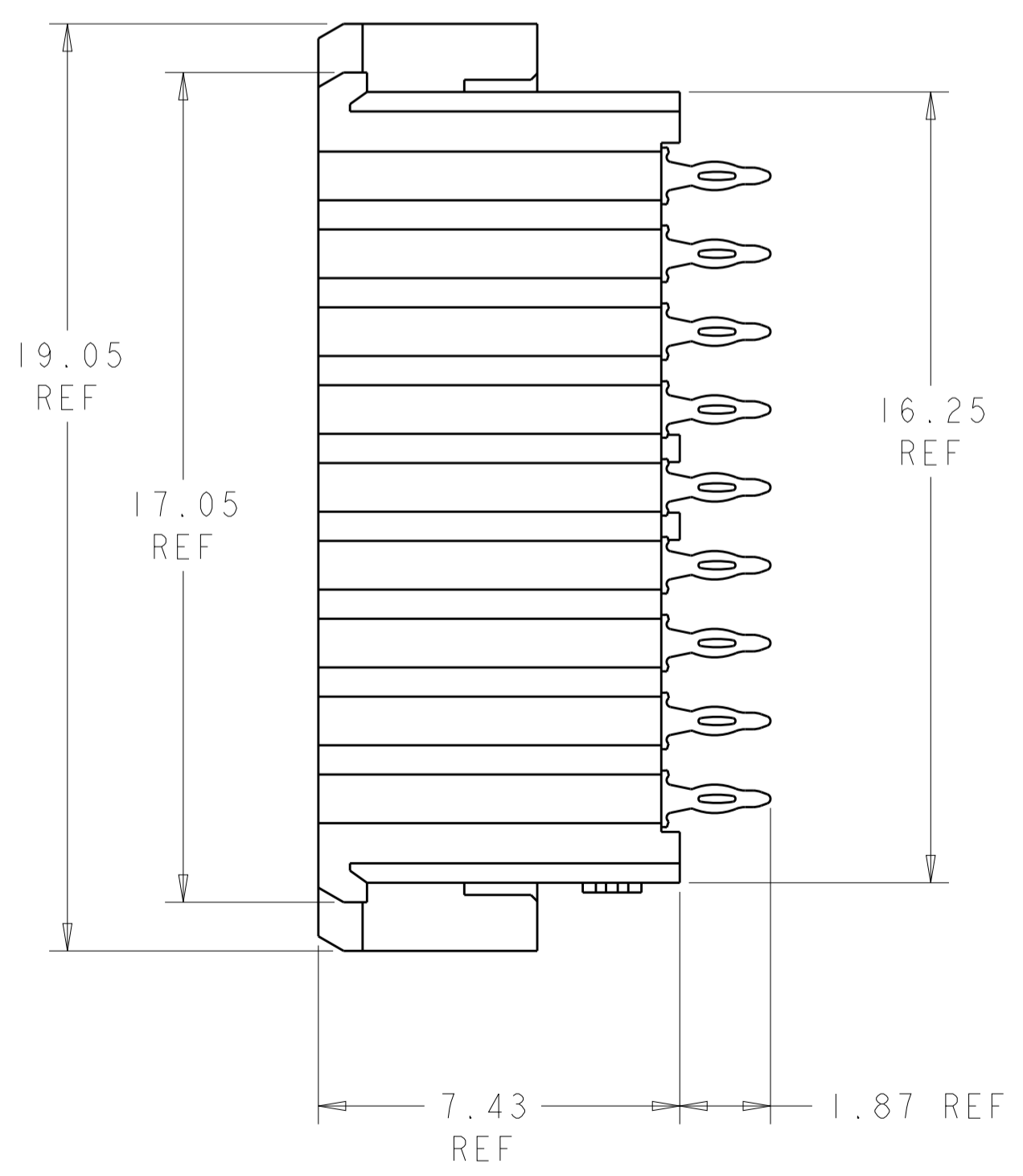
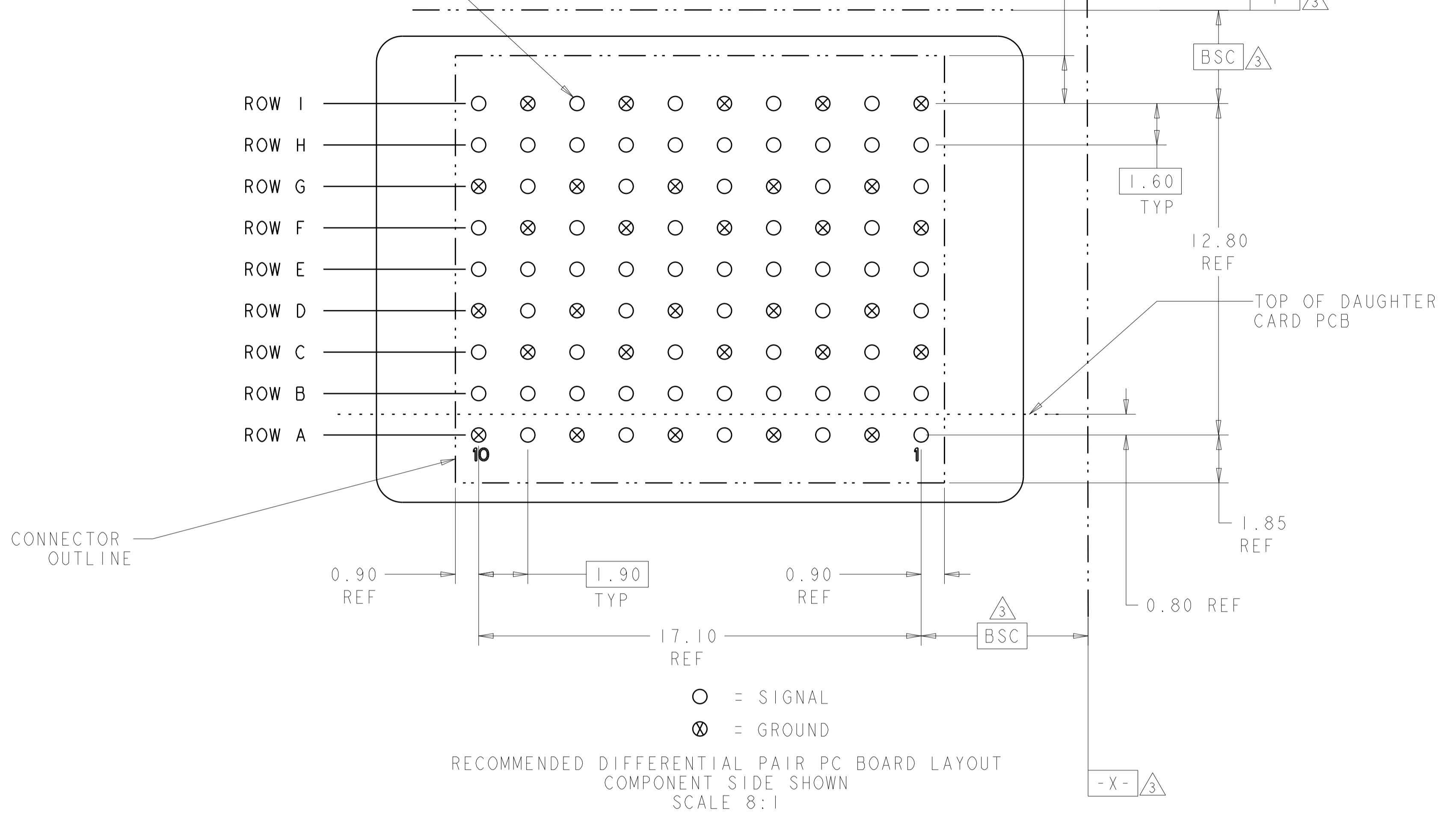
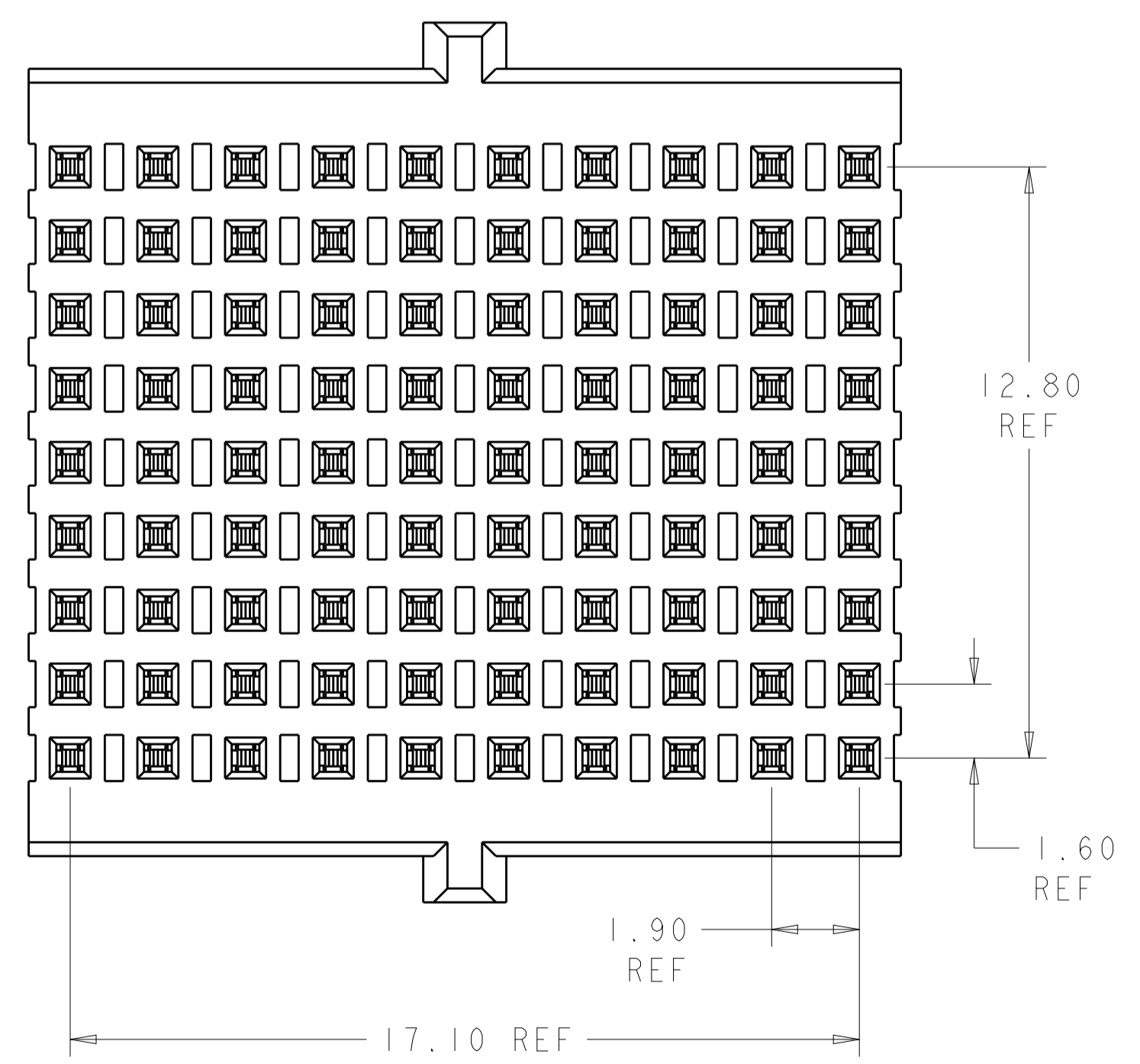
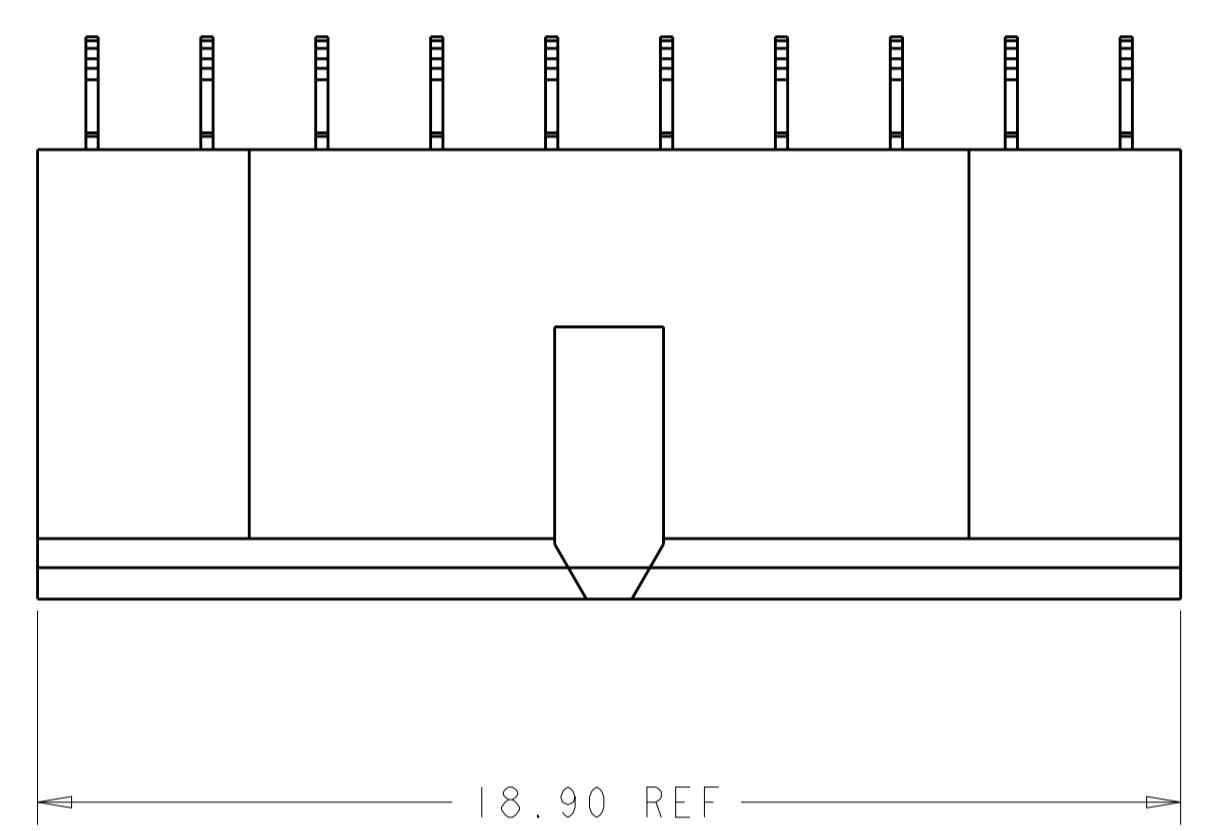

2/6	2000896-2
2/5	2000896-1
FINISH	PART NUMBER

THIS DRAWING IS A CONTROLLED DOCUMENT. DIMENSIONING AND TOLERANCING PER GPS (ISO STANDARDS). DIMENSIONS: mm. TOLERANCES UNLESS OTHERWISE SPECIFIED: 0 PLC ±0.13, 1 PLC ±0.13, 2 PLC ±0.05, 3 PLC ±, 4 PLC ±, ANGLES ±.

DWN: D. BELACK 24JUN2009	CHK: A. TSANG 2-24-2009	APPV: M. McALONIS 2-24-2009	NAME: Fortis Zd. 10-COLUMN, 3-PAIR, VERTICAL CENTER MODULE ASSEMBLY
PRODUCT SPEC: 108-2409			SIZE: A1
APPLICATION SPEC: 114-13267			CAGE CODE: 2000896
WEIGHT: 3.38 g -2x			SCALE: 8:1
CUSTOMER DRAWING			SHEET 1 OF 1 REV G

TE Connectivity

## X-ON Electronics

Largest Supplier of Electrical and Electronic Components

*Click to view similar products for [High Speed/Modular Connectors](#) category:*

*Click to view products by [TE Connectivity](#) manufacturer:*

Other Similar products are found below :

[650827-1](#) [74040-1346](#) [1410191-1](#) [1410368-3](#) [1410964-2](#) [1410326-3](#) [1410367-3](#) [1410971-4](#) [1467833-1](#) [2000877-1](#) [2000878-1](#) [2041314-1](#)  
[2065387-1](#) [2187307-1](#) [163P](#) [1934290-1](#) [2000875-1](#) [2065917-1](#) [2102736-2](#) [FSR-40](#) [2169868-2](#) [22354-8](#) [437-5040-000](#) [5-1393565-0](#) [039-](#)  
[0246-000](#) [0761601016](#) [0784461022](#) [10123159-12ELF](#) [030-2415-003/100 PK](#) [030-7380-004](#) [030-2494-001](#) [532939-1](#) [5532901-3](#) [3-1469268-](#)  
[7](#) [74748-102LF](#) [10041743-101LF](#) [10066670-100002LF](#) [1-533915-1](#) [249-4515-000](#) [7-1469373-3](#) [DL2-2J/S](#) [2000713-8](#) [2000713-7](#)  
[10124313-101LF](#) [3011-21](#) [757105208](#) [EBTF-4-10-2.0-S-RA-1](#) [430305-001](#) [4395800100](#) [8140115](#)