

THIS DRAWING IS UNPUBLISHED. RELEASED FOR PUBLICATION  
 © COPYRIGHT - By - ALL RIGHTS RESERVED.

LOC		DIST		REVISIONS			
P	LTR	DESCRIPTION		DATE	DWN	APVD	
CM	00	B		REVISED PER ECO-12-014543	07NOV12	KH SM	

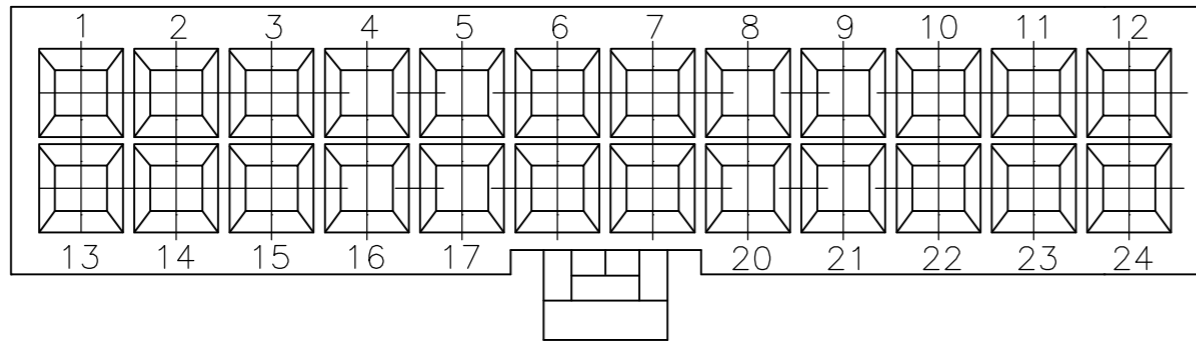

1 MATERIAL: NYLON, UL94V-2, BLUE.

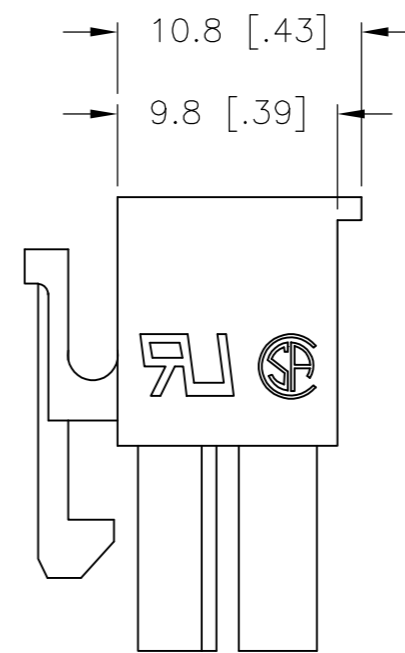
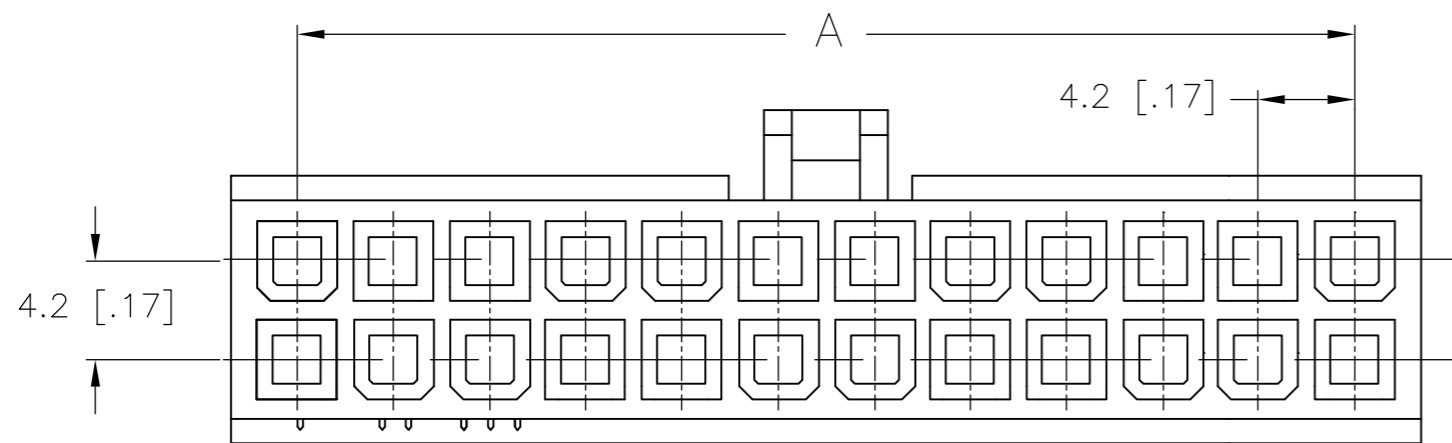
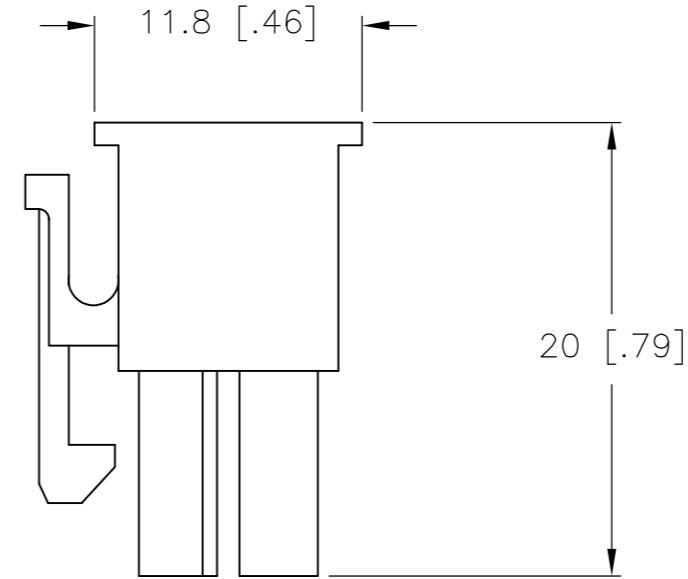
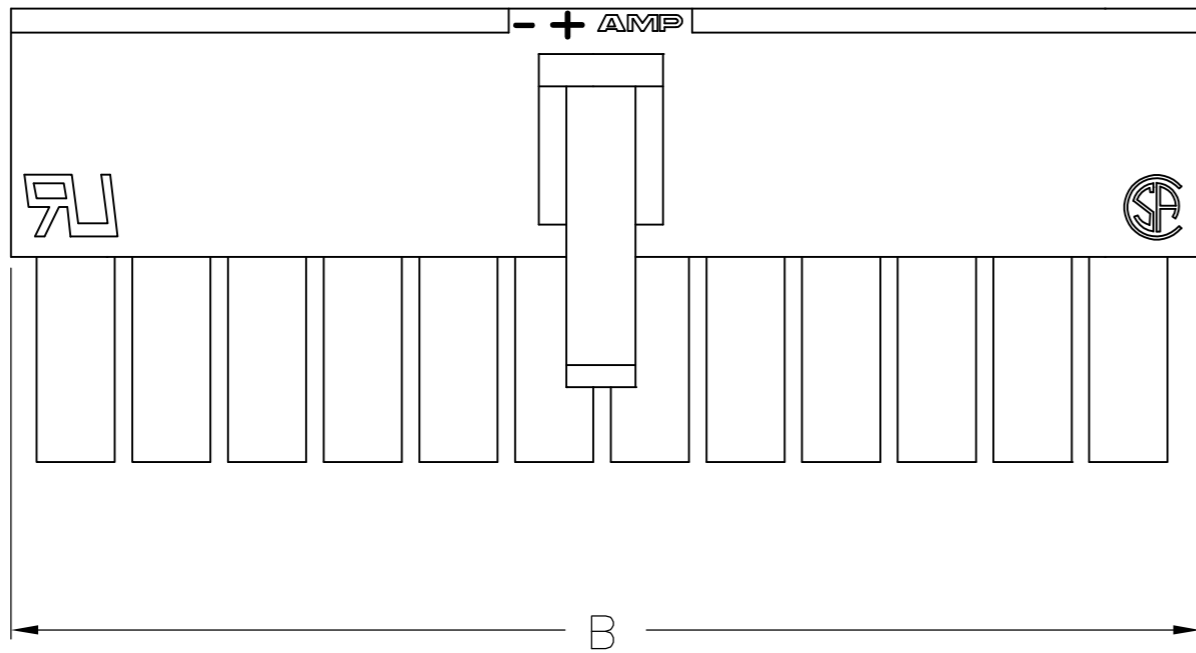

ONLY FOR 2029097-2

51.6	46.2	24	2-2029097-4
47.4	42.0	22	2-2029097-2
43.2	37.8	20	2-2029097-0
39.0	33.6	18	1-2029097-8
34.8	29.4	16	1-2029097-6
30.6	25.2	14	1-2029097-4
26.4	21.0	12	1-2029097-2
22.2	16.8	10	1-2029097-0
18.0	12.6	8	2029097-8
13.8	8.4	6	2029097-6
9.6	4.2	4	2029097-4
5.4	-	2	2029097-2
DIM B	DIM A	POS.	PART NUMBER

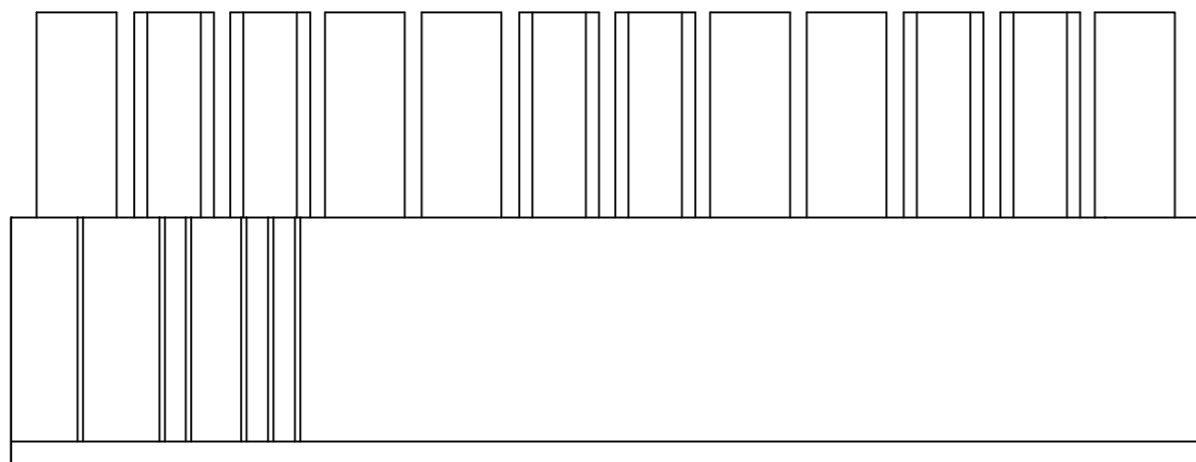

THIS DRAWING IS A CONTROLLED DOCUMENT.		DWN K. WHITAKER 08APR2008	TE Connectivity			
DIMENSIONS: mm [INCHES]		CHK C. CASH 08APR2008				
TOLERANCES UNLESS OTHERWISE SPECIFIED:		APVD C. CASH 08APR2008	NAME RECEPTACLE HOUSING, BLUE, VAL-U-LOK(TM)			
0 PLC ± 1 PLC ± 0.4 [.02] 2 PLC ± 0.25 [.010] 3 PLC ± 0.150 [.0059] 4 PLC ± ANGLES ±		PRODUCT SPEC	SIZE A2	CAGE CODE 00779	DRAWING NO C=2029097	RESTRICTED TO -
MATERIAL 1		FINISH	WEIGHT	SCALE 3:1	SHEET 1 of 1	REV B
CUSTOMER DRAWING						

## X-ON Electronics

Largest Supplier of Electrical and Electronic Components

*Click to view similar products for [Headers & Wire Housings](#) category:*

*Click to view products by [TE Connectivity](#) manufacturer:*

Other Similar products are found below :

[95000-104TRLF](#) [10135584-644402LF](#) [DF62W-EP2022PCA](#) [95000-106TRLF](#) [DF62W-2022SCA](#) [DF62W-EP2022PC](#) [2203348](#) [DF62W-2022SC](#) [1084018](#) [1029039](#) [1084017](#) [802-10-012-10-002000](#) [1112640](#) [1112639](#) [891-007-9SS-BST1T](#) [000-34000](#) [0008550134](#) [0009482033](#) [0009507031](#) [57102-F02-18ULF](#) [57102-S06-03LF](#) [57202-S52-04LF](#) [PCN6-15S-2.5E](#) [0039019024](#) [58102-G61-06LF](#) [582553-1](#) [0009485154](#) [0009508121](#) [0022285053](#) [0050291907](#) [018731A](#) [LY20-4P-DT1-P1E-BR](#) [02.125.8002.8](#) [60101931](#) [60598-1 \(Cut Strip\)](#) [M1625-3R/100](#) [61062-3](#) [61082-181009](#) [CSU011177004](#) [636-1427](#) [638009-1](#) [641938-9](#) [641991-4](#) [644168-1](#) [644827-2](#) [647662-1](#) [65039-019ELF](#) [65692-001LF](#) [65781-018](#) [65781-047](#)