

THIS DRAWING IS UNPUBLISHED.

RELEASED FOR PUBLICATION

ALL RIGHTS RESERVED.

© COPYRIGHT - By -

REVISIONS

P	LTR	DESCRIPTION	DATE	DWN	APVD
D		ECO-18-018694	22NOV2018	LL	SH

NOTE:

- MATERIAL:
 - HOUSING: PA9T WITH 30% GF, UL94 V-0, COLOR: BLACK.
 - INSERT HOUSING: PA9T WITH 30% GF, UL94 V-0, COLOR: BLACK.
 - CONTACTS: PHOSPHOR BRONZE.
 - SHELL: BRASS.
 - MYLAR: PI, THICKNESS=0.07mm, COLOR: YELLOW
- FINISH:
 - CONTACTS: (SEE TABLE) GOLD PLATED ON CONTACT AREA. GOLD FLASH ON SOLDER TAIL. 1.27um [50u"] MIN. NICKEL UNDERPLATED OVERALL.
 - SHELL: 0.508um [20u"] MIN. NICKEL PLATED OVERALL.
- REFLOW SOLDER COPABLE TO 260+/-5°C PEAK TEMPERATURE PER TE SPEC TEC-109-201, TEST METHOD A, CONDITION B.

TE LOGO & DATE CODE

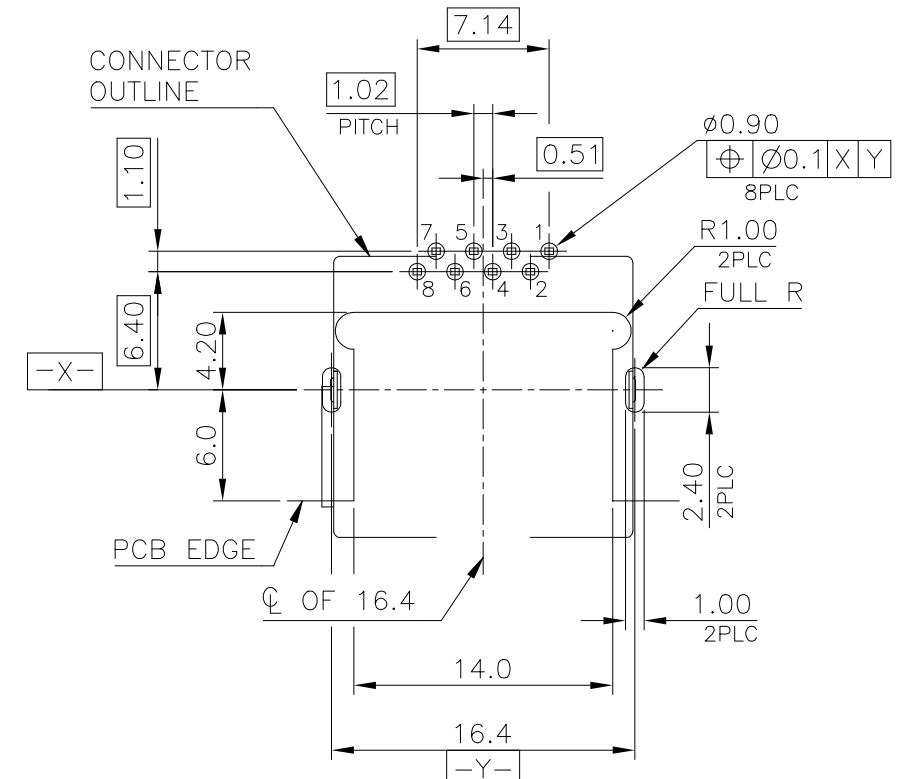
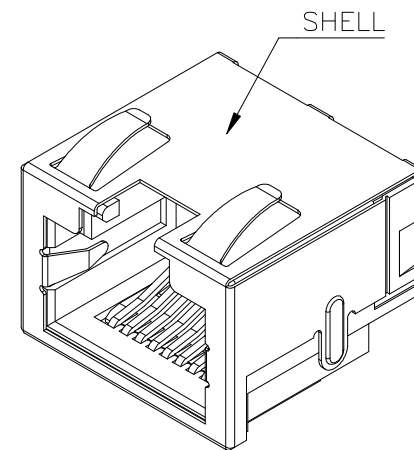
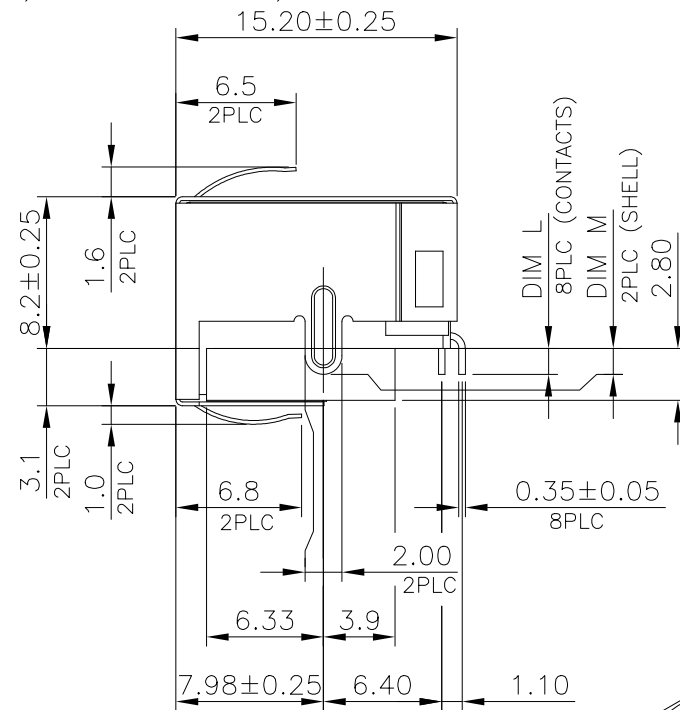
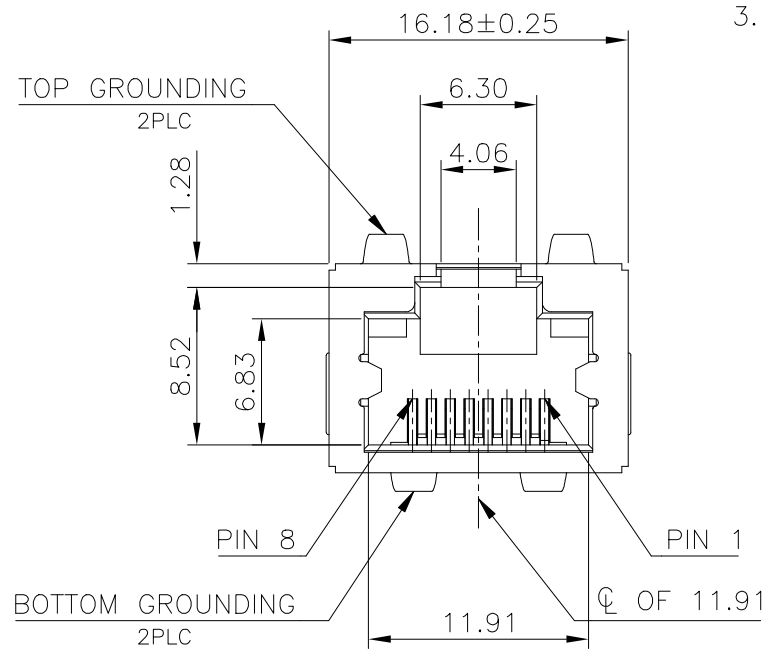
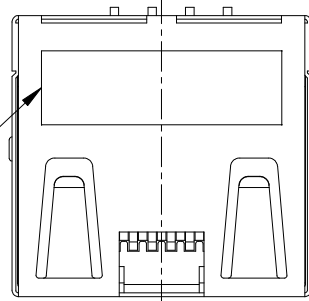

RECOMMENDED PCB LAYOUT (COMPONENT SIDE)
 TOLERANCE: ±0.05
 PCB THICKNESS: 1.2mm

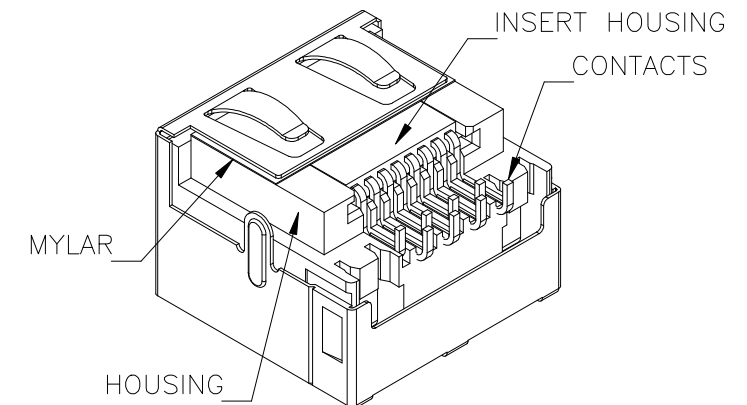

0.762um [30u"]	1.8	1.8	2041307-2
0.152um [6u"]	1.4	1.4	2041307-1
MIN. GOLD THICKNESS	DIM M	DIM L	PART NUMBER

MYLAR ATTACHED (UNDER SHELL)

MYLAR NOT ALLOWED TO PROTRUDE FROM SHELL

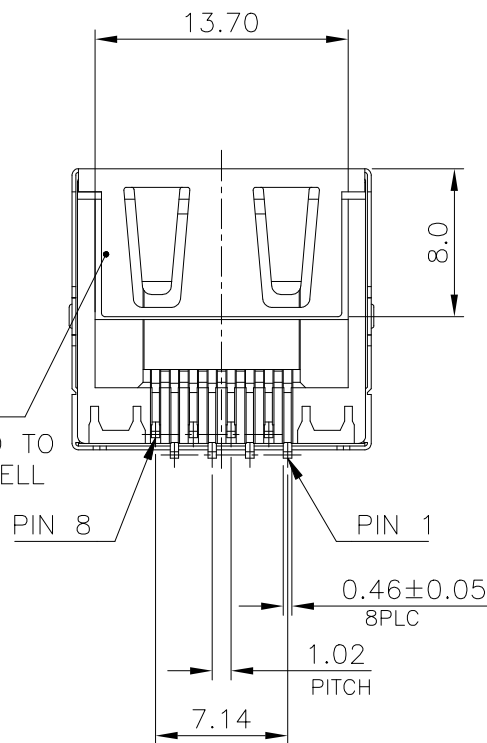

THIS DRAWING IS A CONTROLLED DOCUMENT.

DIMENSIONS:	TOLERANCES UNLESS OTHERWISE SPECIFIED:
mm	
0 PLC	± -
1 PLC	± 0.3
2 PLC	± 0.2
3 PLC	± 0.15
4 PLC	± -
ANGLES	± -
MATERIAL	FINISH
SEE NOTE	SEE NOTE

DWN	E. LIU	10JAN2011
CHK	S. CHIEN	10JAN2011
APVD	W. KODAMA	10JAN2011
PRODUCT SPEC	108-57847	
APPLICATION SPEC	-	
WEIGHT	2.91 GRAMS	
CUSTOMER DRAWING		



NAME			
MODULAR JACK CONN			
RJ45 W/O LED, TAB UP, SIDE ENTRY			
OFFSET, DIP TYPE, H=8.2MM			
SIZE	CAGE CODE	DRAWING NO	RESTRICTED TO
A3	00779	C=2041307	-
SCALE		SHEET	REV
1:1		1 of 3	D

THIS DRAWING IS UNPUBLISHED.

RELEASED FOR PUBLICATION

ALL RIGHTS RESERVED.

© COPYRIGHT - By -

REVISIONS

P	LTR	DESCRIPTION	DATE	DWN	APVD
-	-	SEE SHEET 1	-	-	-

- NOTES:
- MATERIAL:
TRAY: PET
TOP TRAY: PET
BOX: CORRUGATED FIBER.
 - EACH BAG SHALL BE INCLUDED:
*DESICCANT
 - DIMENSION: SEE DRAWING
 - QUANTITY: SEE TABLE
 - WEIGHT: SEE TABLE

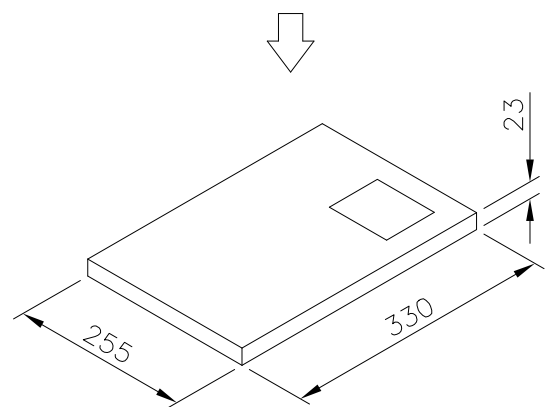
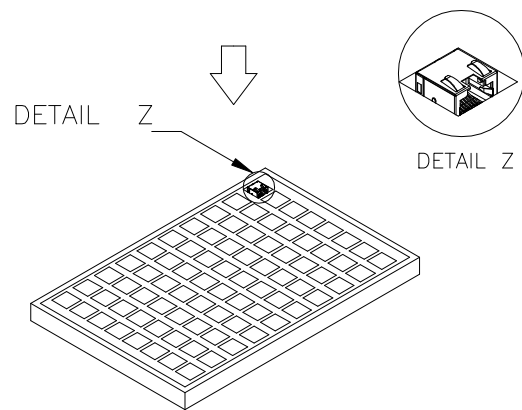
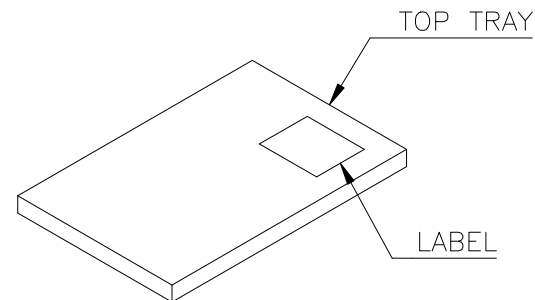
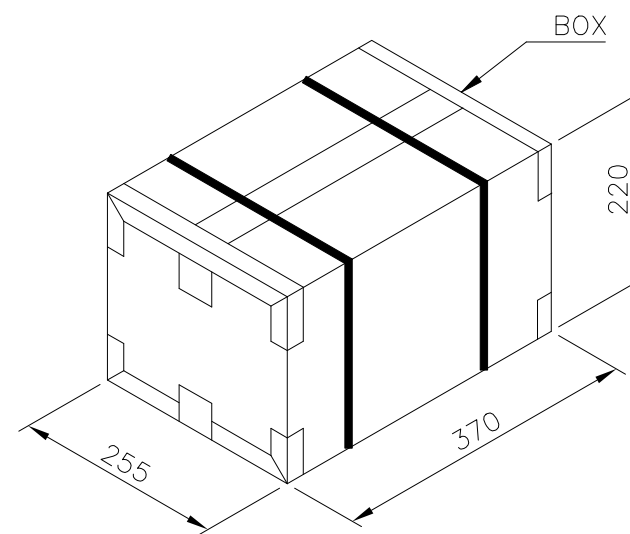
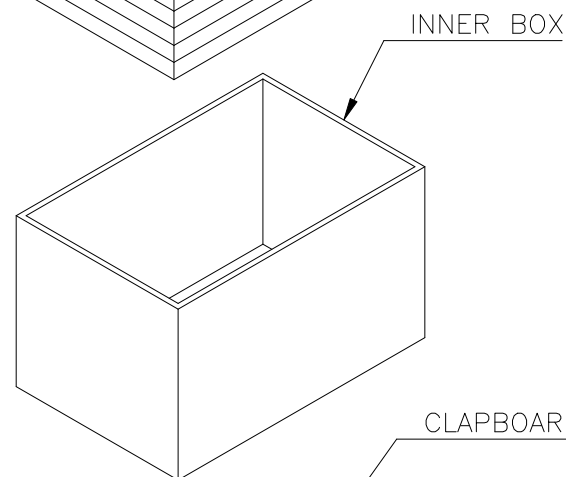
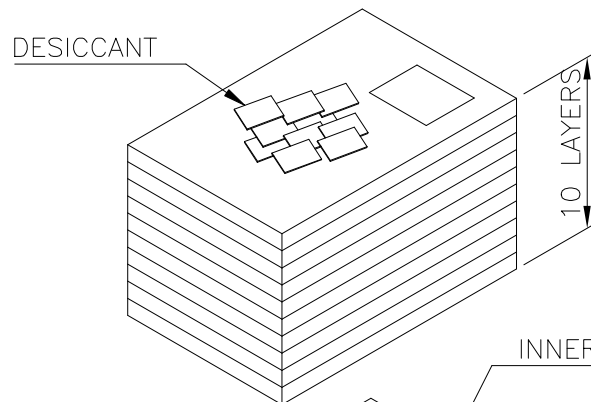

4.97 Kg	2.33 Kg	80	10	800	2041307-1
GROSS WEIGHT	NET WEIGHT	PCS/ TRAY	TRAY/ BOX	PCS/ BOX	PART NUMBER

THIS DRAWING IS A CONTROLLED DOCUMENT.		DWN	E. LIU	10JAN2011												
DIMENSIONS: mm		CHK	S. CHIEN	10JAN2011												
TOLERANCES UNLESS OTHERWISE SPECIFIED:		APVD	W. KODAMA	10JAN2011												
<table border="0"> <tr><td>0 PLC</td><td>± -</td></tr> <tr><td>1 PLC</td><td>± 0.3</td></tr> <tr><td>2 PLC</td><td>± 0.2</td></tr> <tr><td>3 PLC</td><td>± 0.15</td></tr> <tr><td>4 PLC</td><td>± -</td></tr> <tr><td>ANGLES</td><td>± -</td></tr> </table>		0 PLC	± -	1 PLC	± 0.3	2 PLC	± 0.2	3 PLC	± 0.15	4 PLC	± -	ANGLES	± -	NAME		
0 PLC	± -															
1 PLC	± 0.3															
2 PLC	± 0.2															
3 PLC	± 0.15															
4 PLC	± -															
ANGLES	± -															
MATERIAL		PRODUCT SPEC														
SEE NOTE		108-57847														
FINISH		APPLICATION SPEC														
SEE NOTE		-														
		WEIGHT														
		-														
		CUSTOMER DRAWING														

STE TE Connectivity			
MODULAR JACK CONN RJ45 W/O LED, TAB UP, SIDE ENTRY OFFSET, DIP TYPE, H=8.2MM			
SIZE	CAGE CODE	DRAWING NO	RESTRICTED TO
A3	00779	©=2041307	-
SCALE		SHEET	REV
1:1		2 of 3	D

THIS DRAWING IS UNPUBLISHED. RELEASED FOR PUBLICATION
 © COPYRIGHT - By - ALL RIGHTS RESERVED.

REVISIONS					
P	LTR	DESCRIPTION	DATE	DWN	APVD
-	-	SEE SHEET 1	-	-	-

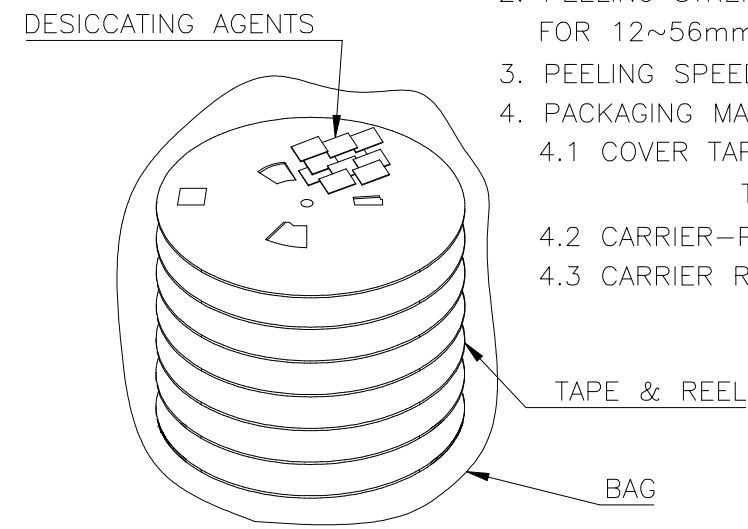
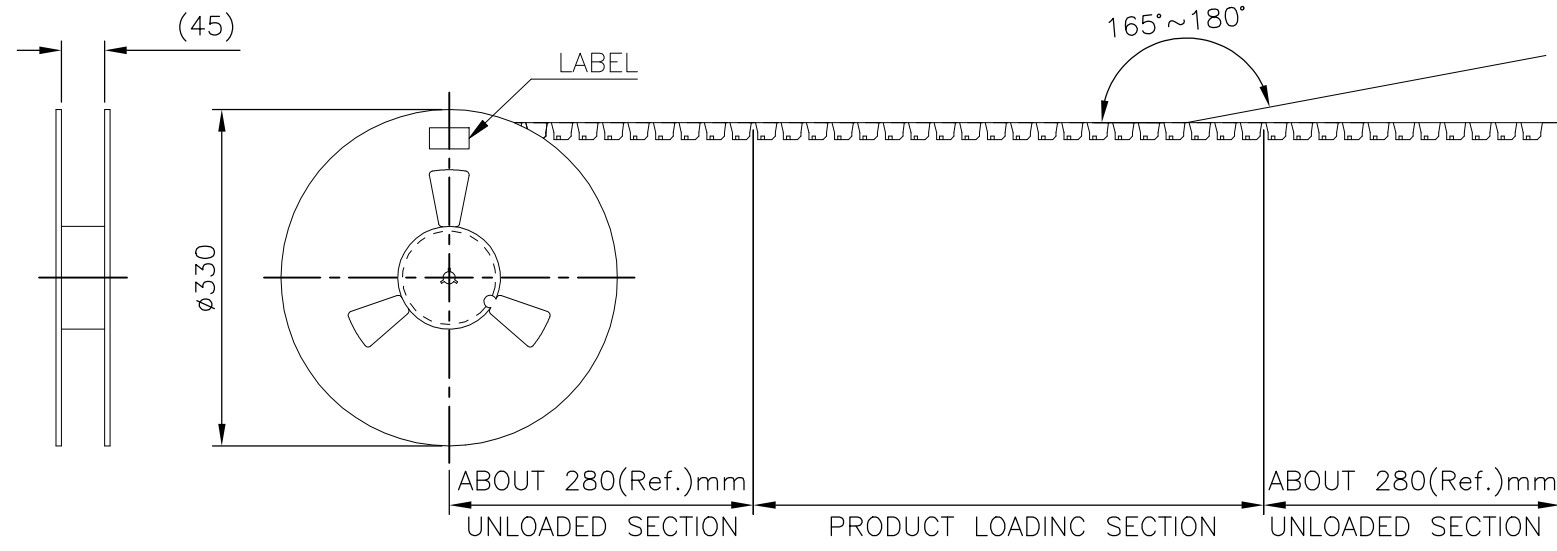

- NOTE:
- EACH BAG SHALL BE INCLUDED:
*DESICCANT
 - PEELING STRENGTH: 0.1~1.3N(1~130 GRAMS)
FOR 12~56mm WIDE CARRIER TAPES
 - PEELING SPEED: 300mm/MINUTES.
 - PACKAGING MATERIAL:
 - COVER TAPE-COMPOSITE OF POLYETHYLENE TEREPHTHALATE (PET)
 - CARRIER-POLYSTYRENE (PS)
 - CARRIER REEL-POLYSTYRENE

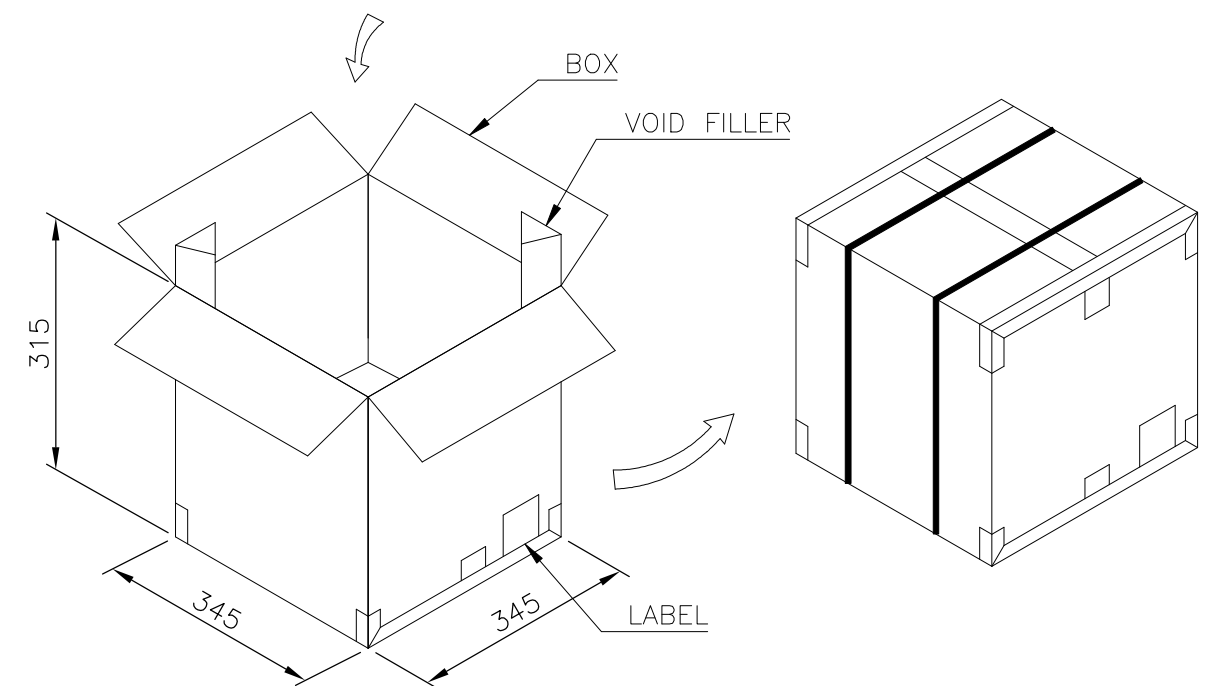
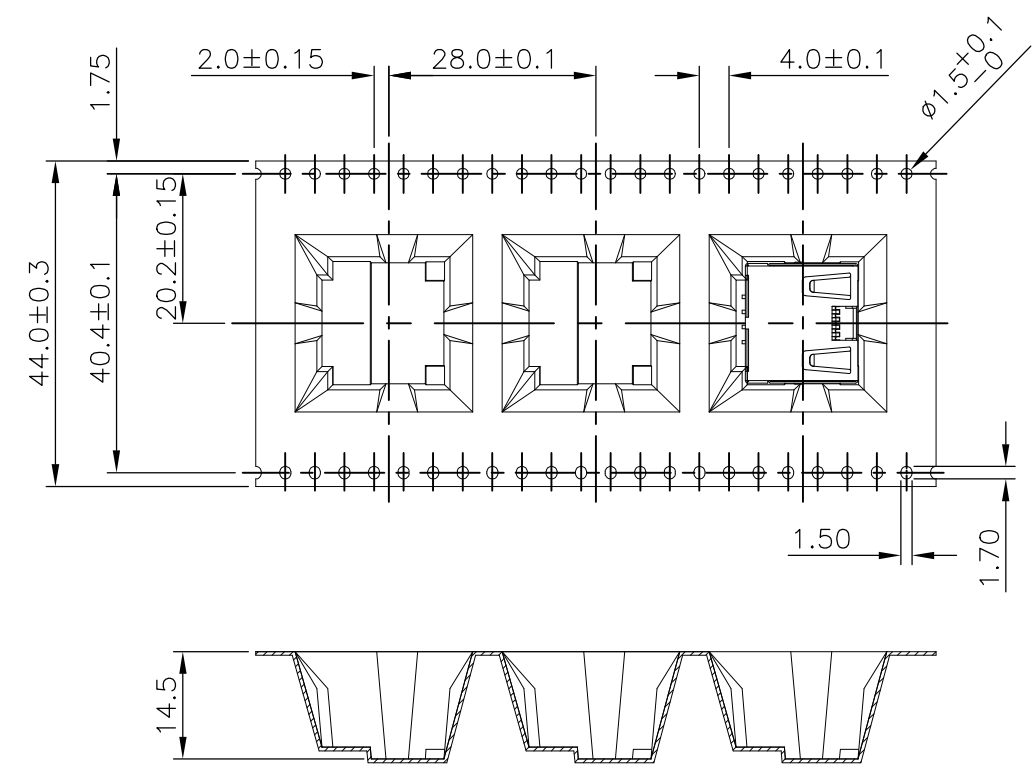

5.8 Kg	2.62Kg	150	6	900	2041307-2
GROSS WEIGHT	NET WEIGHT	PCS/ REEL	REEL/ BOX	PCS/ BOX	PART NUMBER

THIS DRAWING IS A CONTROLLED DOCUMENT.		DWN E. LIU 10JAN2011	TE Connectivity		
DIMENSIONS: mm		CHK S. CHIEN 10JAN2011			
TOLERANCES UNLESS OTHERWISE SPECIFIED:		APVD W. KODAMA 10JAN2011	NAME		
0 PLC ± - 1 PLC ± 0.3 2 PLC ± 0.2 3 PLC ± 0.15 4 PLC ± - ANGLES ± -		PRODUCT SPEC 108-57847	MODULAR JACK CONN RJ45 W/O LED, TAB UP, SIDE ENTRY OFFSET, DIP TYPE, H=8.2MM		
MATERIAL SEE NOTE		FINISH SEE NOTE	APPLICATION SPEC -	SIZE A3	CAGE CODE 00779
		WEIGHT -	DRAWING NO C-2041307	RESTRICTED TO -	
CUSTOMER DRAWING			SCALE 1:1	SHEET 3 of 3	REV D

X-ON Electronics

Largest Supplier of Electrical and Electronic Components

Click to view similar products for [Modular Connectors / Ethernet Connectors](#) category:

Click to view products by [TE Connectivity](#) manufacturer:

Other Similar products are found below :

[8949-H88/06BLKA/SN](#) [74441-0010/BKN](#) [MP1010RX-1000](#) [MP44RX-1000](#) [PHJ-4P4C-1-V-4](#) [PHP-6P6C-5](#) [GAX-3-66](#) [GAX-8-62](#) [GDCX-PA-66-50](#) [GDCX-PN-64](#) [GDCX-PN-66](#) [GDCX-PN-66-50](#) [GDLX-A-66](#) [GDLX-N-66](#) [GDLX-S-66](#) [GDLX-S-88K](#) [GDLX-SMT-S-88](#) [GDTX-S-88-50](#) [GDX-PA-1010](#) [GLX-N-1010M-BLK](#) [GLX-S-88M-BLK](#) [GMX-N-1010](#) [GMX-S-1010](#) [GMX-S-66](#) [GMX-SMT4-N-88](#) [GPX-2-64](#) [GSGX-N-2-88](#) [GSGX-N-4-88](#) [GSX-NS2-88-3.05](#) [GSX-NS2-88-3.05-50](#) [GSX-NS-88-3.05-50](#) [PT-108A-8C-UL](#) [PT-J951-8C](#) [PTS-J531-8CS-50UL](#) [1-1775629-2](#) [A-2014-0-4](#) [GWLX-S-88-GR](#) [GWLX-S9-88-YG](#) [DC-1021-8-WH-6](#) [1300530003](#) [1324640-4](#) [RJ11FTVC2G](#) [RJ11FTVC2N](#) [RJFTVX2SA1G](#) [132764-001](#) [1413235](#) [MP88X-1000](#) [MPS88RX-5000](#) [E5288-S000K3-L](#) [E5908-15A242-L](#)