

REVISIONS

| P | LTR | DESCRIPTION | DATE | DWN | APVD |
|----|-----|---------------------------|-----------|-----|------|
| B | | REVISED PER ECR-10-003329 | 16FEB2010 | HMR | DD |
| B1 | | REVISED PER ECR-19-015136 | 27SEP2019 | SB | DD |
| B2 | | REVISED PER ECR-20-007067 | 24JUN2020 | SB | DD |

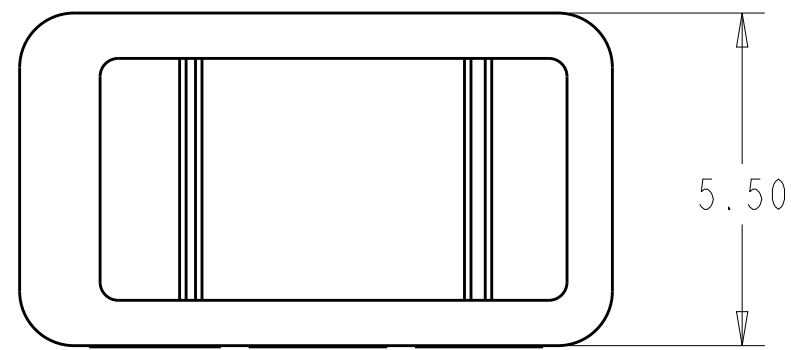

- 1 MATERIAL : PBT
- 2. PRODUCT TO COMPLY WITH DIRECTIVE 2002/95/EC(ROHS)
- 3 PRELIMINARY
- 4. FOR USE WITH TE P/N 1954289-X AND 2058703-X

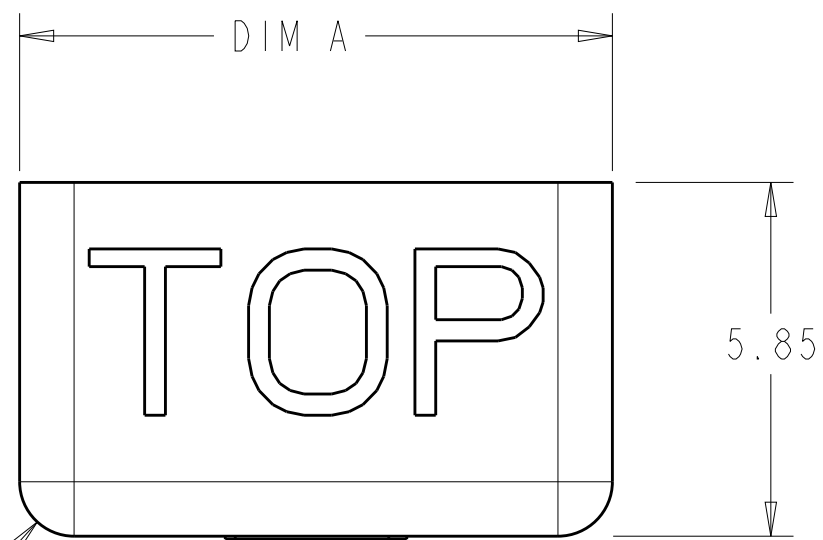

R0.90
TYP

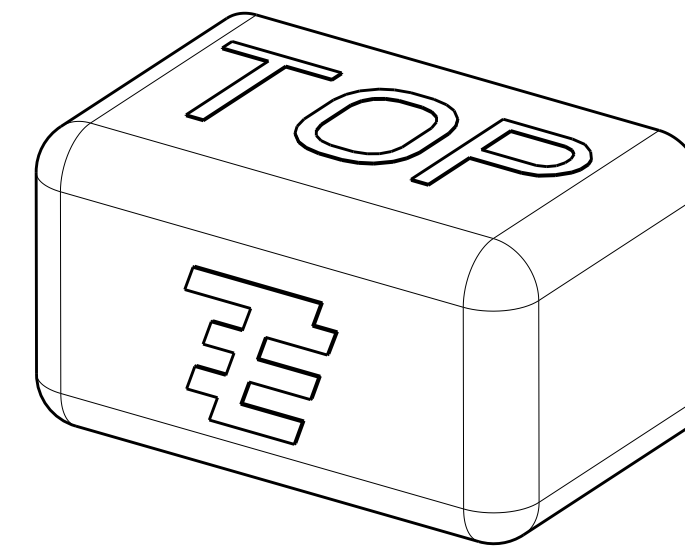

2058128-1
SHOWN

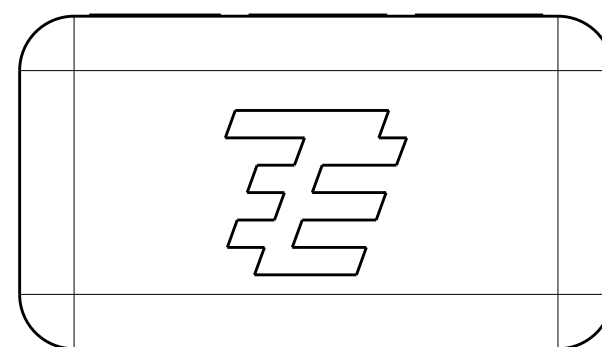

| | | | | |
|---|---------|-------|------|-------------|
| 3 | BLACK | 25.80 | 6 | 1-2058128-3 |
| 3 | BLACK | 17.80 | 4 | 1-2058128-2 |
| 3 | BLACK | 9.80 | 2 | 1-2058128-1 |
| | NATURAL | 25.80 | 6 | 2058128-3 |
| | NATURAL | 17.80 | 4 | 2058128-2 |
| | NATURAL | 9.80 | 2 | 2058128-1 |
| | COLOR | DIM A | POSN | PART NO. |

| | | | | |
|--|--|-------------------------------|---|-------------------------|
| THIS DRAWING IS A CONTROLLED DOCUMENT. | | DWN R BROWN 26NOV2008 | TE Connectivity | |
| | | CHK R NARANG 26NOV2008 | | |
| DIMENSIONS: | TOLERANCES UNLESS OTHERWISE SPECIFIED: | APVD - | NAME DUSTCAP BLADE AND RECEPTACLE | |
| mm | 0 PLC ± 1 PLC ±0.2 2 PLC ±0.13 3 PLC ± 4 PLC ± | PRODUCT SPEC - | SIZE A2 | |
| | ANGLES ±2° FINISH - | APPLICATION SPEC 114-13225 | CAGE CODE 00779 | DRAWING NO C-2058128 |
| MATERIAL | | WEIGHT - | RESTRICTED TO | |
| | | CUSTOMER DRAWING | SCALE 8:1 | SHEET 1 OF 1 |
| | | | REV B2 | |

X-ON Electronics

Largest Supplier of Electrical and Electronic Components

Click to view similar products for [Lighting Connectors](#) category:

Click to view products by [TE Connectivity](#) manufacturer:

Other Similar products are found below :

[293300-7](#) [293660-5](#) [CNX_H03_NTP](#) [30-9767-BU](#) [3605](#) [3-21030-1](#) [ZCH-110-RGB-I](#) [503471-0290](#) [ZCH-110-RGB-J](#) [217-0716-200](#)
[1954563-1](#) [1-293657-2](#) [2834036-1](#) [2834037-1](#) [1-2213222-4](#) [2-2213222-4](#) [2213222-4](#) [2834122-3](#) [2834122-5](#) [2834135-2](#) [FLA-R4142-30](#)
[FLA-R4162-30](#) [FLA-R2142-30](#) [FLA-R2141-30](#) [FLA-R2162-30](#) [FLA-R2161-30](#) [FLA-R0161-30](#) [FLA-R0141-30](#) [FLA-R0142-30](#) [FLA-](#)
[R0162-30](#) [FLA-C00-00](#) [DGA00010553](#) [CNXV04NTP](#) [104128-0610](#) [503485-0000 \(Cut Strip\)](#) [503485-0000 \(Loose Piece\)](#) [503485-0000](#)
[\(MINI Reel\)](#) [1-2834074-2](#) [1-2834074-3](#) [1357-AC PLUG W2C \(CHINA\)](#) [1357-AC PLUG W2 \(USA\)](#) [104266-0110](#) [CNXV02NTP](#) [2106212-1](#)
[2-2834074-2](#) [104266-0210](#) [293470-1](#) [293651-2](#) [293651-4](#) [1-2834006-2](#)