

- △1 HOUSING MATERIAL: PA66, BLACK, UL 94 V-0 RATED.
- △2 BRASS PER ASTM B36.
- △3 3.81um [.00150] MIN TIN-LEAD OVER 2.54 [.00100] MIN COPPER OR 1.27um [.00050] MIN NICKEL.
- △4 0.76um [.00030] MIN GOLD FOR A LENGTH OF 5.08 [.200] MIN FROM MATING END, 3.81um [.00150] MIN TIN-LEAD FOR A LENGTH OF 5.36 [.211] MIN FROM OPPOSITE END, BOTH OVER
- △5 1.27um [.00050] MIN NICKEL.
- △6 3.81um [.00150] MIN TIN OVER 2.54 [.00100] MIN COPPER OR 0.76um [.00030] MIN GOLD FOR A LENGTH OF 5.08 [.200] MIN FROM MATING END, 3.81um [.00150] MIN TIN FOR A LENGTH OF 5.36 [.211] MIN FROM OPPOSITE END, BOTH OVER 1.27um [.00050] MIN NICKEL.

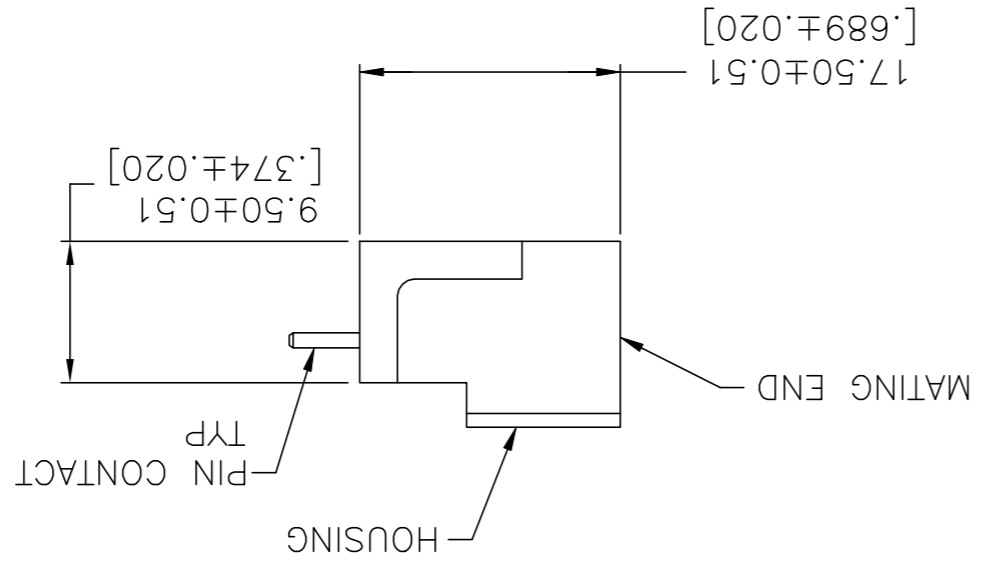

RECOMMENDED PC BOARD LAYOUT

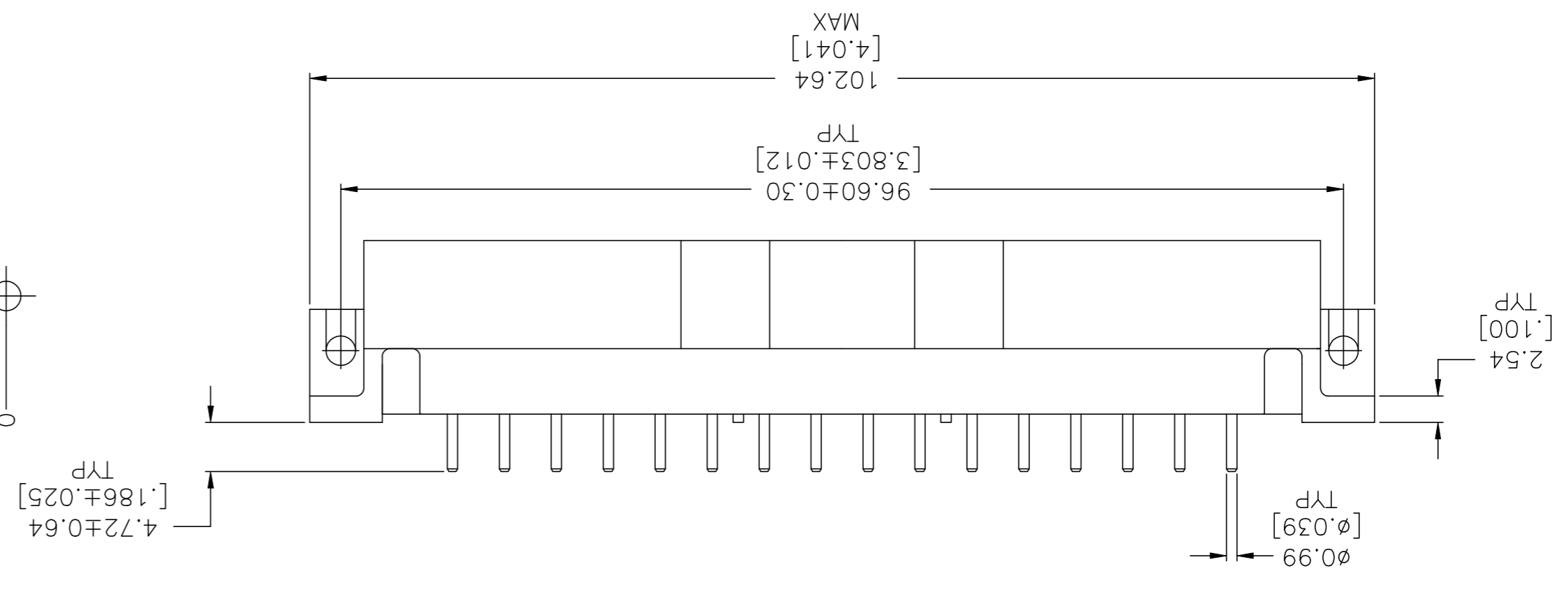
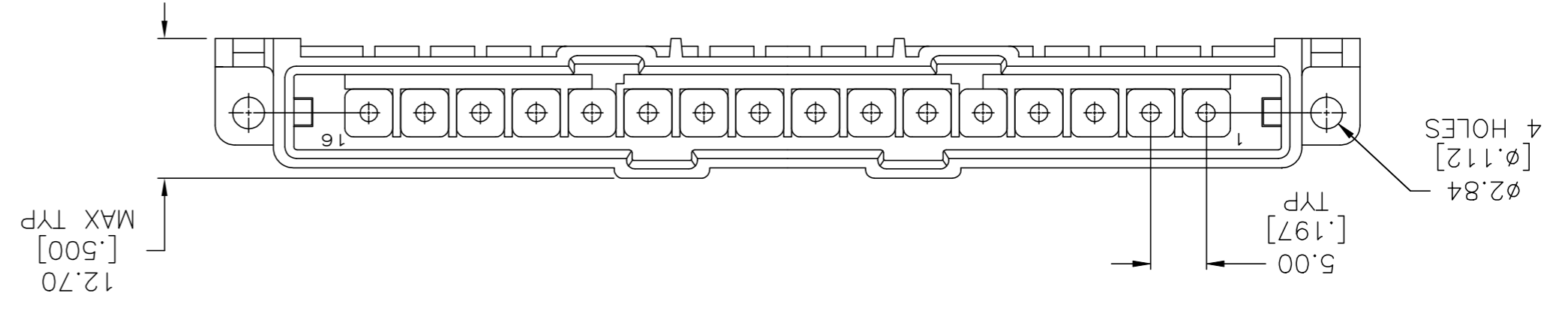
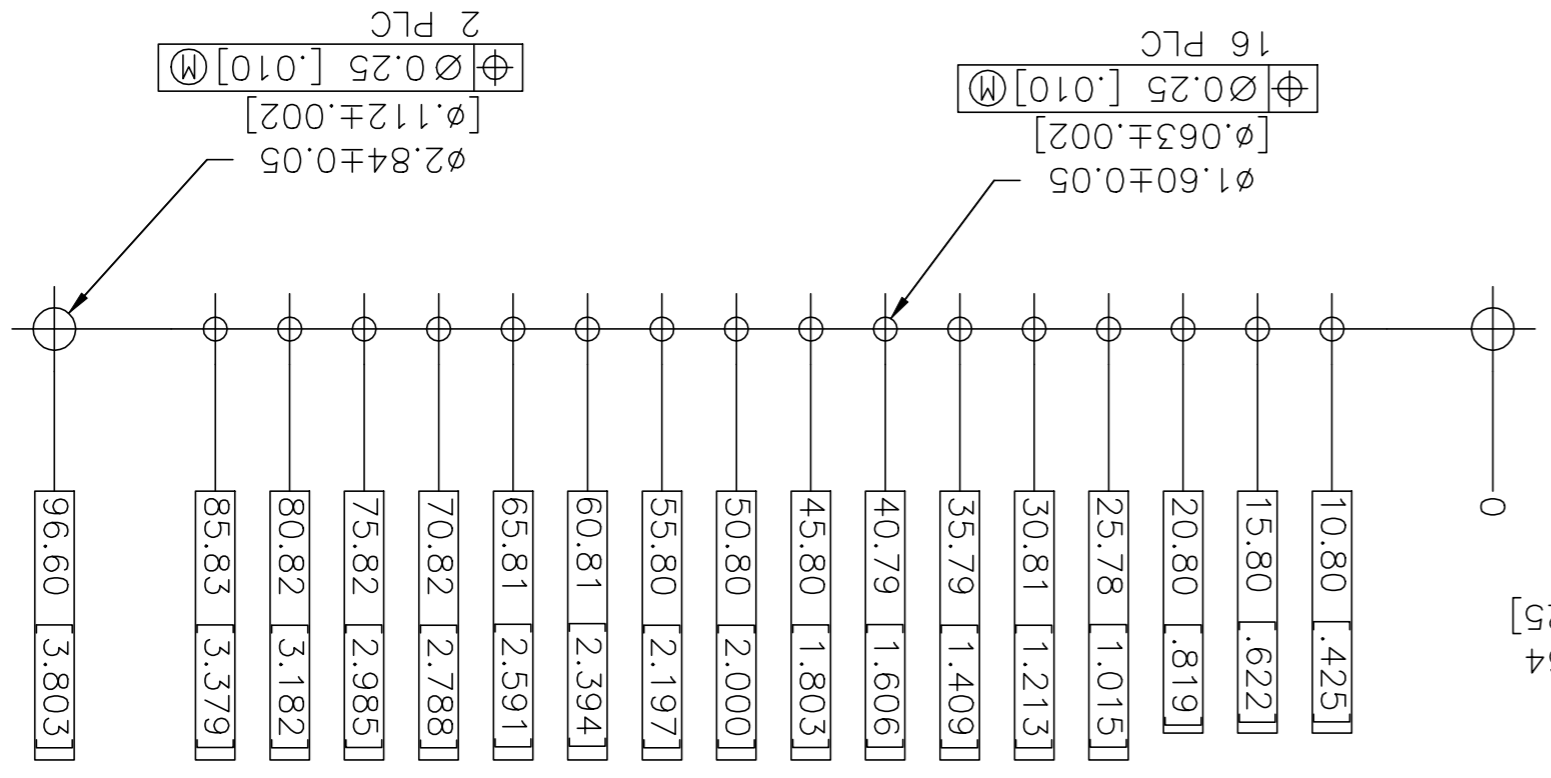

THIS DRAWING IS A CONTROLLED DOCUMENT.		TOLERANCES UNLESS OTHERWISE SPECIFIED:	
DIMENSIONS:	mm [INCHES]	0 PLC	± .0005
		1 PLC	± .0010
		2 PLC	± 0.25 [.010]
		3 PLC	± .0010
		4 PLC	± .0010
FINISH		CONTACTS: SEE TABLE	
MATERIAL		HOUSING: 1	

FINISH	207599-7
3	207599-6
4	207599-3
5	207599-1
6	

NAME	STE
APVD	R. STONE
CHK	7-24-92
DWN	07/21/92
L. SIFE	
TE Connectivity Ltd.	
PIN HEADER ASSEMBLY, 16 POSN, IN-LINE, SMALL METRIC CONNECTOR, METRIMATE	
CAGE CODE	207599
DRAWING NO	207599
SCALE	2:1
SHEET	1 of 1
REV	

207599

P	LTR	DESCRIPTION	DATE	DWN	APVD
L		REVISED PER ECO-20-001562	04FEB2020	SG	MZ
K		REVISED PER ECO-18-000443	19JAN2018	RS	MZ
REVISIONS					

X-ON Electronics

Largest Supplier of Electrical and Electronic Components

Click to view similar products for te connectivity manufacturer:

Other Similar products are found below :

[570416-000](#) [CLTEQ-M81CE-SSRELAY-4-20V](#) [D38999/24FJ4AN](#) [358838-000](#) [4-1195131-0](#) [650069-000](#) [SMD100-2](#) [CB-1022B-78](#)
[RM707012](#) [RP410012](#) [MMS42](#) [1-640426-8](#) [2EDL4CM](#) [DTS20W19-11PD-3028-LC](#) [RM202615](#) [NC6-P104-06](#) [MSPS103B](#) [DTS26F21-41AE](#) [DTS26F21-41PE-LC](#) [DTS26F21-11SE-3028-LC](#) [1932144-1](#) [293545-4](#) [LVR125S](#) [MS27466T25F4PB](#) [CKB-38-78010](#)
[1206SFF150F/63-2](#) [D38999/20JB35HA](#) [D38999/24WJ20PA](#) [1754138-1](#) [TE1500A2R2J](#) [DTS24F25-29PC-3028-LC](#) [D38999/24WG11HA](#)
[D38999/24WG11HN](#) [MS27467T21F11H](#) [DJT16E21-11HA](#) [1206SFH150F/24-2](#) [DTS24F19-11SC-3028-LC](#) [DTS24F21-41HN-LC](#)
[DTS24F21-41AN](#) [DTS24F21-41PN-LC](#) [MS27467T21F35J](#) [MS27467T21F11J](#) [MS27467T21F16H-LC](#) [MS27467T21F35H](#)
[MS27467T21F41H-LC](#) [DJT16E21-11PA-LC](#) [DJT16E21-11HA-LC](#) [DJT16E21-11AA](#) [MS27467T21B11JA](#) [DJT16E21-11JA](#)