

4

3

2

1

THIS DRAWING IS UNPUBLISHED. RELEASED FOR PUBLICATION 12, 2002.  
 © COPYRIGHT 2002 BY TYCO ELECTRONICS CORPORATION. ALL RIGHTS RESERVED.

LOC	DIST	REVISIONS			
P	LTR	DESCRIPTION	DATE	DWN	APVD
A	40	E	ECN 0150-0589-02	4-02	WH RS

1. TORQUE 8.0 IN-LBS  $\begin{matrix} +1.5 \\ -0.5 \end{matrix}$  IN-LBS BIDIRECTIONAL
2. 5/16" WRENCH HEAD 1055265-1
3. PREVIOUS PART NUMBER 2098-0275-50

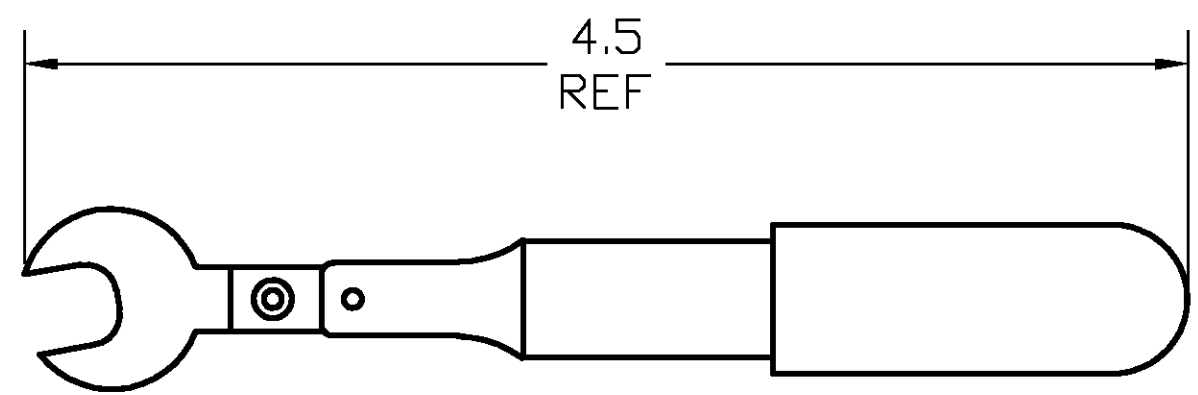

THIS DRAWING IS A CONTROLLED DOCUMENT.		DWN	DAVID STULL	12/12/02	<b>tyco</b> <b>Electronics</b>	Tyco Electronics Corporation Harrisburg, PA 17112		
DIMENSIONS: INCHES		CHK	DAVID STULL	12/12/02		NAME TORQUE WRENCH FOR SMA (OSM) RF CONNECTORS		
TOLERANCES UNLESS OTHERWISE SPECIFIED:		APVD	R.SCHAEFFER	12/12/02	PRODUCT SPEC 408-8640			
0 PLC ± -		APPLICATION SPEC		SIZE		CAGE CODE	DRAWING NO	RESTRICTED TO
1 PLC ± -		-		A3		00779	1055258	-
2 PLC ± -		MATERIAL		WEIGHT		SCALE		SHEET
3 PLC ± -		-		.30 LBS.		1:1		1 OF 1
4 PLC ± -		FINISH		CUSTOMER DRAWING		REV		E
ANGLES ± -		NICKEL PLATING		-		-		-

## X-ON Electronics

Largest Supplier of Electrical and Electronic Components

*Click to view similar products for [Spanners](#) category:*

*Click to view products by [TE Connectivity](#) manufacturer:*

Other Similar products are found below :

[74005](#) [74008](#) [1406504-3](#) [1406504-4](#) [1406504-5](#) [1406504-7](#) [1725859-2](#) [9965](#) [999-16625-001](#) [G70515-18](#) [1055265-1](#) [1055267-1](#) [1-1406504-0](#) [1055787-1](#) [DCH.91.251.PA](#) [TG70-18](#) [TG70](#) [G62748-11](#) [DPH.99.005.2K](#) [DCP.91.045.TN](#) [1055512-1](#) [1055276-1](#) [R282303020](#) [TA-0456](#) [DCA.91.149.0TN](#) [TA-0436](#) [TA-0398](#) [TOL-222901](#) [74\\_Z-0-0-193](#) [294GB-5069-17-N](#) [74\\_Z-0-0-2](#) [523200-4](#) [294GB-5070-25-A](#) [74\\_Z-0-0-79](#) [294GB-5070-17-A](#) [74\\_Z-0-0-321](#) [TOL-171801](#) [PR23350](#) [1490262-2](#) [9968](#) [AC24VS](#) [80117](#) [DCN.91.149.0TK](#) [BT-A-6010CAGE](#) [R282340000](#) [BT-BS-609WT](#) [BT-A-6000B](#) [R282303000](#) [BT-BS-610R](#) [BT-BS-610RT](#)