

4 3 2 1

THIS DRAWING IS UNPUBLISHED. RELEASED FOR PUBLICATION 20
 © COPYRIGHT 20 BY TYCO ELECTRONICS CORPORATION. ALL RIGHTS RESERVED.

LOC	DIST	REVISIONS				
DS	-	P	LTR	DESCRIPTION	DATE	DWN
				SEE SHEET 2		

INSPECTION ITEM NO.
 SHEET 1 : ① ~ ③
 ◀:6sigma CONTROLLED DIMENSION
 ■:QIP INSPECTION ITEM

GENERAL TOLERANCE : ±0.2

Technical drawings of a dual band WiFi antenna. The drawings include a front view, a side view, and a detail view of the antenna's profile. Dimensions are provided in millimeters. Key dimensions include: 15.25, 8.25, 2.80, 3-2.00, 3-4.80±0.1, 2.20±0.1, 22.75±0.1, 1.70, 3-φ0.90, 16.25, 9.25, 3.80, and 3-1.05. Inspection markers ①, ②, ③, ④, ⑤, ⑥, and ⑦ are placed on the drawings to indicate specific inspection points. A stamping specification symbol (triangle with 'L') is also present.

ISO VIEW

NOTE

- Material : SUS 304 1/2H
- Thickness : 0.3 t
- Ni-Plating 1.0~5.0 micro meter
Overplated with Sn-plating 1.0~5.0 micro meter
- Cutting Burr : 0.1mm MAX
- Coplanarity : 0.1mm MAX

⑥ SMD Area
 ⑦ Stamping Specification : Intaglio "L"

<small>THIS DRAWING IS A CONTROLLED DOCUMENT FOR TYCO ELECTRONICS CORPORATION IT IS SUBJECT TO CHANGE AND THE CONTROLLING ENGINEERING ORGANIZATION SHOULD BE CONTACTED FOR THE LATEST REVISION.</small>		DWN JH.LIM 26-SEP-12 CHK JH.LIM 26-SEP-12 APVD JH.LIM 26-SEP-12		TE Connectivity	
DIMENSIONS: mm		TOLERANCES UNLESS OTHERWISE SPECIFIED: GENERAL TOLERANCE IS ±0.1		NAME DUAL BAND WiFi ANTENNA, STAMPED METAL, SMD TYPE	
		0-PLC ± 1-PLC ± 2-PLC ± 3-PLC ± 4-PLC ± ANGLES ±		PRODUCT SPEC - APPLICATION SPEC -	
MATERIAL -		FINISH -		SIZE CAGE CODE DRAWING NO RESTRICTED TO A300779 C- 2108517-2 -	
CUSTOMER DRAWING				WEIGHT - SCALE 3:1 SHEET 1 OF 2 REV A5	

AMP 1470-19 REV 31MAR2000

4

3

2

1

THIS DRAWING IS UNPUBLISHED. RELEASED FOR PUBLICATION 20
 © COPYRIGHT 20 BY TYCO ELECTRONICS CORPORATION. ALL RIGHTS RESERVED.

LOC	DIST	REVISIONS				
DS	-	P	LTR	DESCRIPTION	DATE	DWN
		A5		Updated description of Part name	2019.03.07	DW

GENERAL TOLERANCE : ±0.2

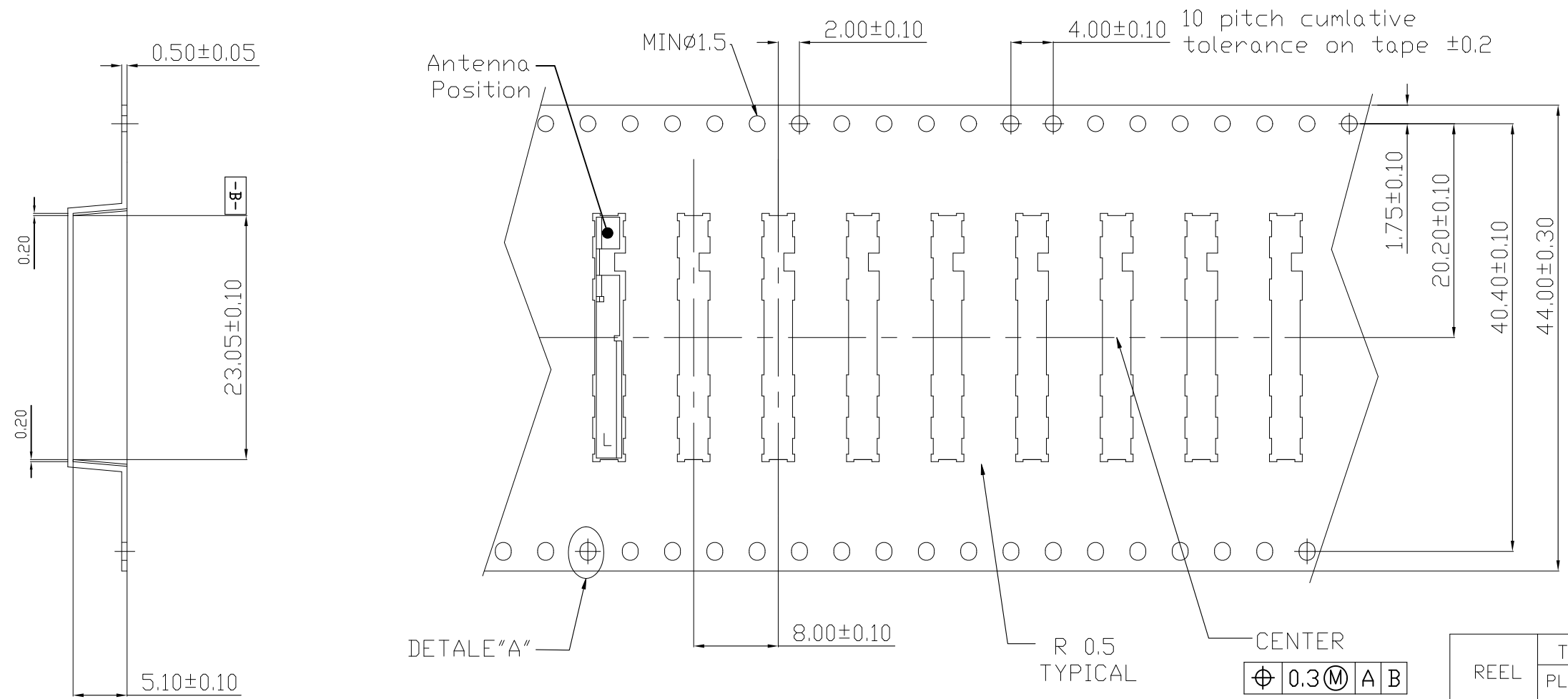

REEL	TYPE	COLOR	HUB	SIZE
	PLASTIC	BLACK	80	330
SHEET	CL 44mmX0.5t	POCKET COUNTER	1,500 POCKET	

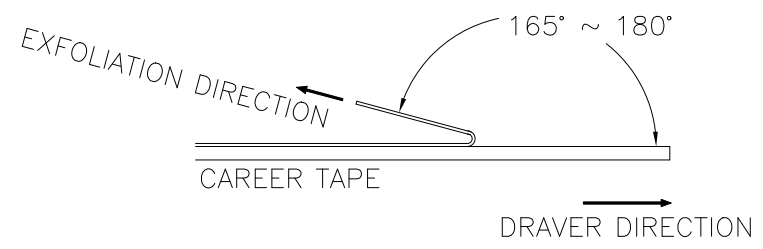
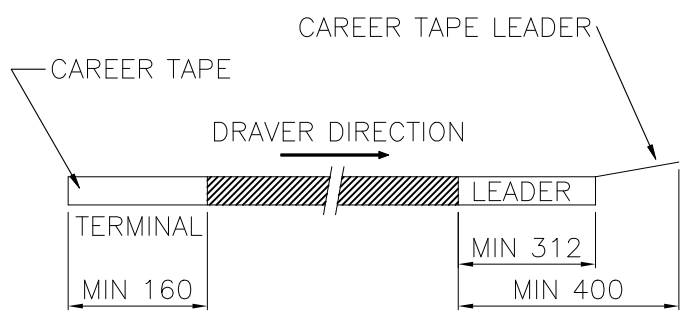
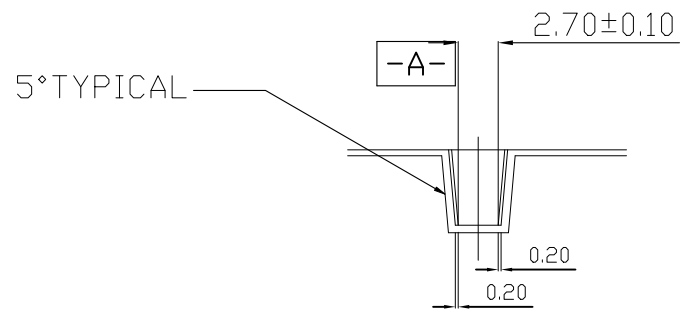
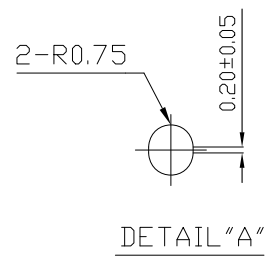

1. APPLICABLE HDR P/N: TBD
2. PACKING Q'TY : 1500EA/ REEL
3. EXFOLIATION STRENGTH OF COVER TAPE : 0.1 ~ 1.27N (10~130gf)
4. MATERIAL : CAREER TAPE : PS 0.4T
COVER TAPE : PET 0.08T
PLASTIC REEL : PS (CONDUCTIVE)

THIS DRAWING IS A CONTROLLED DOCUMENT FOR TYCO ELECTRONICS CORPORATION IT IS SUBJECT TO CHANGE AND THE CONTROLLING ENGINEERING ORGANIZATION SHOULD BE CONTACTED FOR THE LATEST REVISION.

DIMENSIONS: mm	TOLERANCES UNLESS OTHERWISE SPECIFIED: GENERAL TOLERANCE IS ±0.1	DWN JH.LIM 26-SEP-12	TE Connectivity	
	0-PLC ± 1-PLC ± 2-PLC ± 3-PLC ± 4-PLC ± ANGLES ± FINISH -	CHK JH.LIM 26-SEP-12		NAME DUAL BAND WiFi ANTENNA, STAMPED METAL, SMD TYPE
	MATERIAL -	APVD JH.LIM 26-SEP-12		
CUSTOMER DRAWING		WEIGHT -	SCALE 2:1 SHEET 2 OF 2 REV A5	

X-ON Electronics

Largest Supplier of Electrical and Electronic Components

Click to view similar products for [Antennas](#) category:

Click to view products by [TE Connectivity](#) manufacturer:

Other Similar products are found below :

[GAN30084EU](#) [930-033-R](#) [GW17.07.0250E](#) [1513563-1](#) [EXE902SM](#) [APAMPG-117](#) [MAF94383](#) [W3908B0100](#) [W6102B0100](#) [YE572113-30RSMM](#) [108-00014-50](#) [66089-2406](#) [SPDA17RP918](#) [A09-F8NF-M](#) [A09-F5NF-M](#) [RGFRA1903041A1T](#) [W3525BW100](#) [W3593B0100](#) [W3921B0100](#) [SIMNA-868](#) [SIMNA-915](#) [SIMNA-433](#) [W1044](#) [W1049B090](#) [A75-001](#) [WTL2449CQ1-FRSMM](#) [CPL9C](#) [EXB148BN](#) [0600-00060](#) [TRA9020S3PBN-001](#) [Y4503](#) [GD5W-28P-NF](#) [MA9-7N](#) [GD53-25](#) [GD5W-21P-NF](#) [C37](#) [MAF94051](#) [MA9-5N](#) [EXD420PL](#) [B1322NR](#) [QWFTB120](#) [MAF94271](#) [MAF94300](#) [GPSMB301](#) [FG4403](#) [AO-AGSM-OM54](#) [5200232](#) [MIKROE-2349](#) [WCM.01.0111](#) [MIKROE-2393](#)