

THIS DRAWING IS UNPUBLISHED. RELEASED FOR PUBLICATION 20  
 © COPYRIGHT 20 BY - ALL RIGHTS RESERVED.

LOC	DIST	REVISIONS					
GE	45	P	LTR	DESCRIPTION	DATE	DWN	APVD
			A	INITIAL RELEASE	10MAY2013	DD	TB

1. ALL RADII 0.40[.016] UNLESS OTHERWISE SPECIFIED.
2. DIMENSIONS IN BRACKETS ARE IN INCHES.

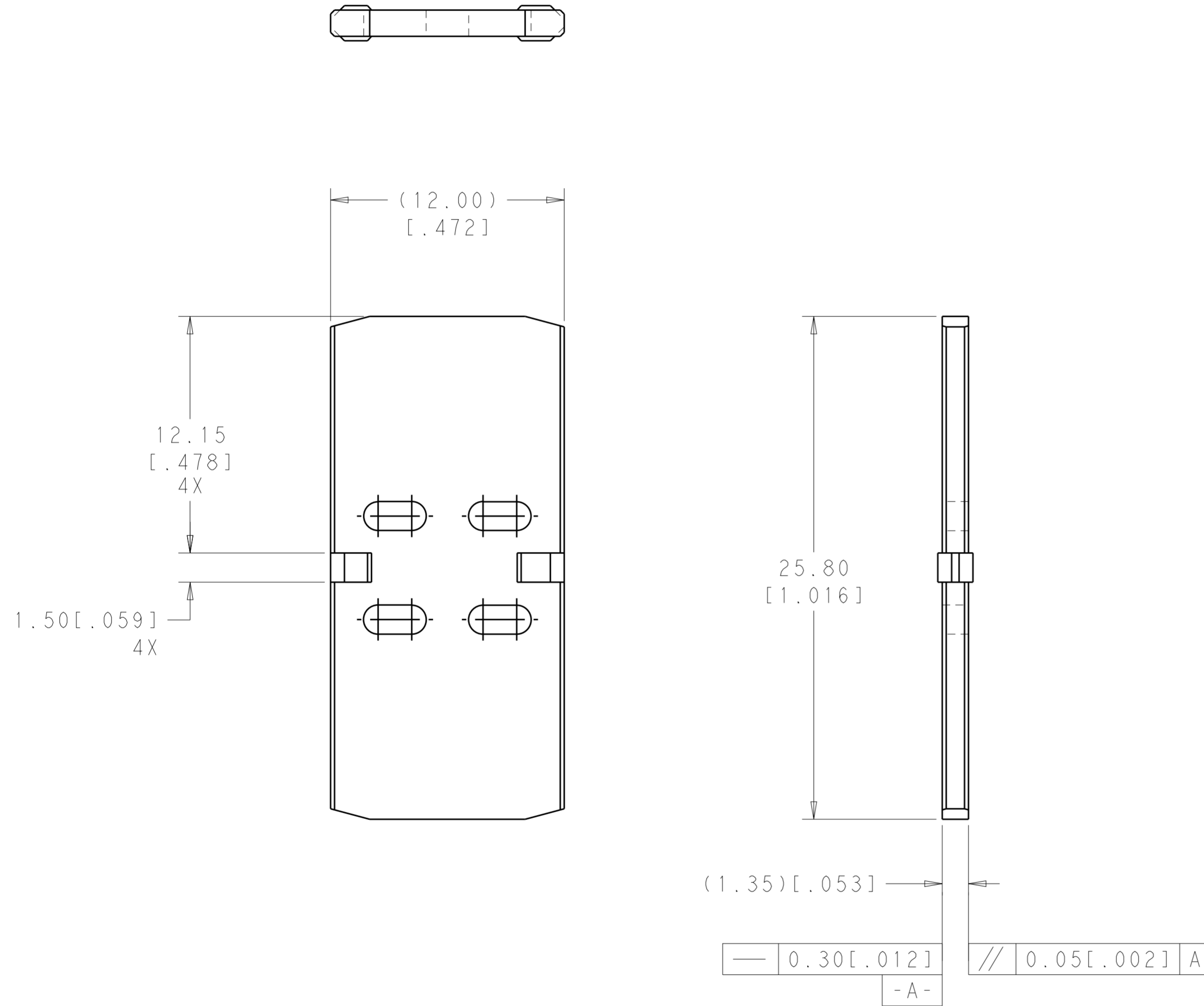

AS SHOWN	212866-1
DESCRIPTION	TE PART NUMBER

THIS DRAWING IS A CONTROLLED DOCUMENT.		DWN D. DRUMMOND 10MAY2013	TE Connectivity	
DIMENSIONS: mm [INCHES]		CHK T. BANAS 10MAY2013		
TOLERANCES UNLESS OTHERWISE SPECIFIED:		APVD T. BANAS 10MAY2013	NAME SPACER, 10 POSITION, FREE HANGING	
0 PLC ±-	1 PLC ±-	PRODUCT SPEC	SIZE CAGE CODE DRAWING NO RESTRICTED TO	
2 PLC ±0.10[.004]	3 PLC ±-	APPLICATION SPEC	A200779 C-212866	
4 PLC ±-	ANGLES ±-	WEIGHT	SCALE 5:1 SHEET 1 OF 1 REV A	
MATERIAL	FINISH	Customer Drawing		

## X-ON Electronics

Largest Supplier of Electrical and Electronic Components

*Click to view similar products for [Automotive Connectors](#) category:*

*Click to view products by [TE Connectivity](#) manufacturer:*

Other Similar products are found below :

[003-018-000](#) [600858](#) [60403001](#) [60993906-B](#) [60993913-B](#) [629515004020001](#) [M902-2131](#) [M902-2161](#) [M902-2344](#) [72.330.1035.1](#)  
[73.353.4028.0](#) [F118010](#) [F119300-B](#) [F132210](#) [F132210-B](#) [F166900](#) [F180100](#) [F258300](#) [F258300-B](#) [F294300-B](#) [F339100](#) [F339700](#) [F358300-](#)  
[B](#) [F374110](#) [F407400](#) [F412210](#) [F427600](#) [F444110](#) [F487000](#) [F495100-B](#) [F500900-B](#) [F509500B-B](#) [770444-1](#) [776880-1](#) [827153-1](#) [881735-1](#)  
[8N1515-32-24P](#) [9-1326727-8](#) [9-1326729-8](#) [925467-1](#) [925474-1](#) [928905-1](#) [936398-2](#) [964562-1](#) [964562-4](#) [964731-2](#) [965051-1](#) [968782-1](#)  
[GT17SA-8DS-HU](#) [GT17VS-10DP-5.2CF](#)