

LOC		DIST		REVISIONS			
P	LTR	DESCRIPTION	DATE	DNW	APVD		
E1		REVISED PER ECO-07-012824	6/4/07	SS	GS		

- NOTES:**
- THIS PLUG HOUSING MATES WITH RECEPTACLE HOUSING PART NUMBER 213427-1.
 - FOR MOUNTING SCREW INFORMATION SEE DRAWING 208211.
 - THIS HOUSING ACCEPTS (3) POWER SIZE 8 COAXIAL SIZE 8 SOCKET CONTACTS AND (12) TYPE II SIZE 16, TYPE III+ SIZE 16, TYPE VI SIZE 16, TYPE X SIZE 16, SUBMINATURE COAXIAL OR OPTIMATE FIBER OPTIC SOCKET CONTACTS.

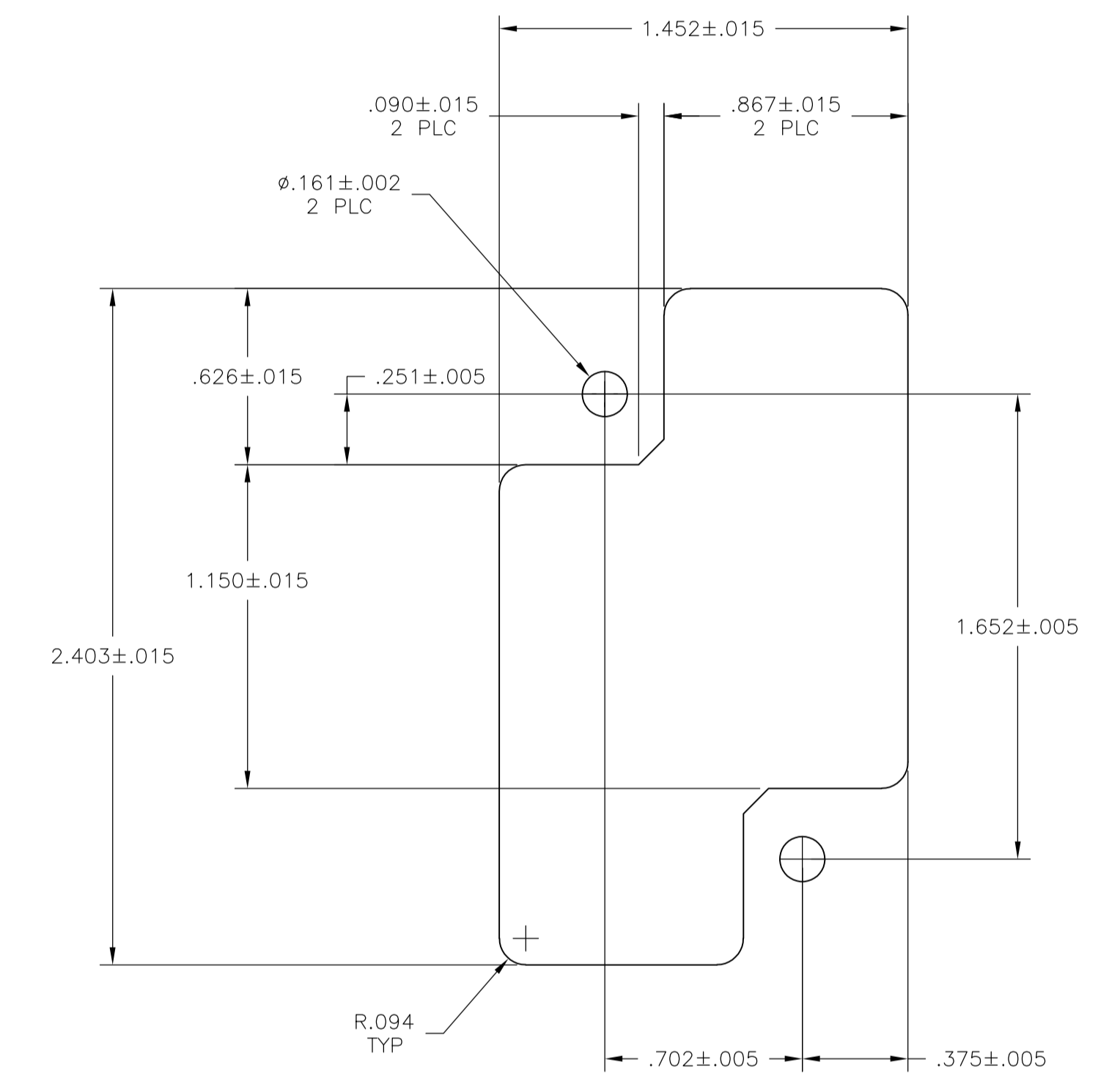
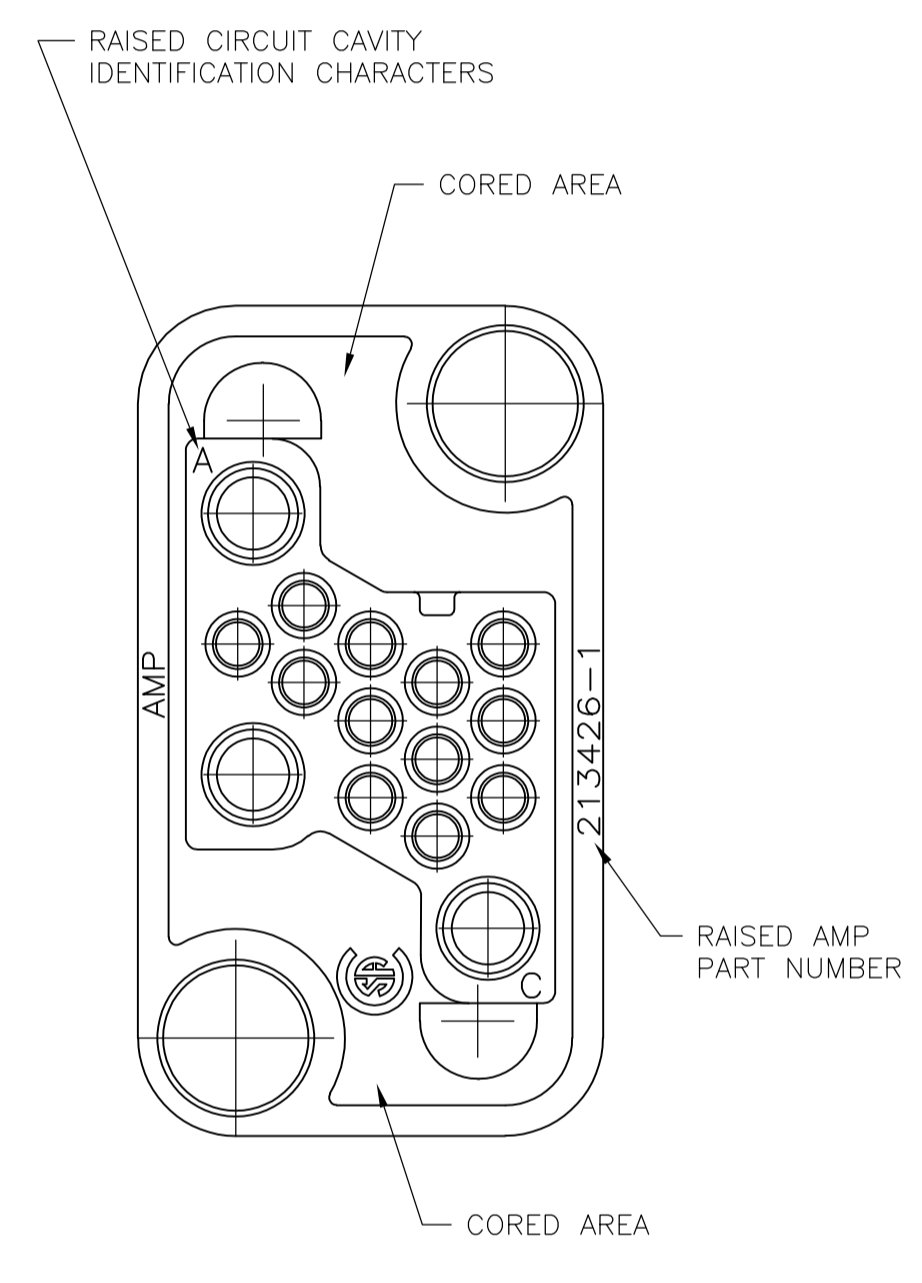
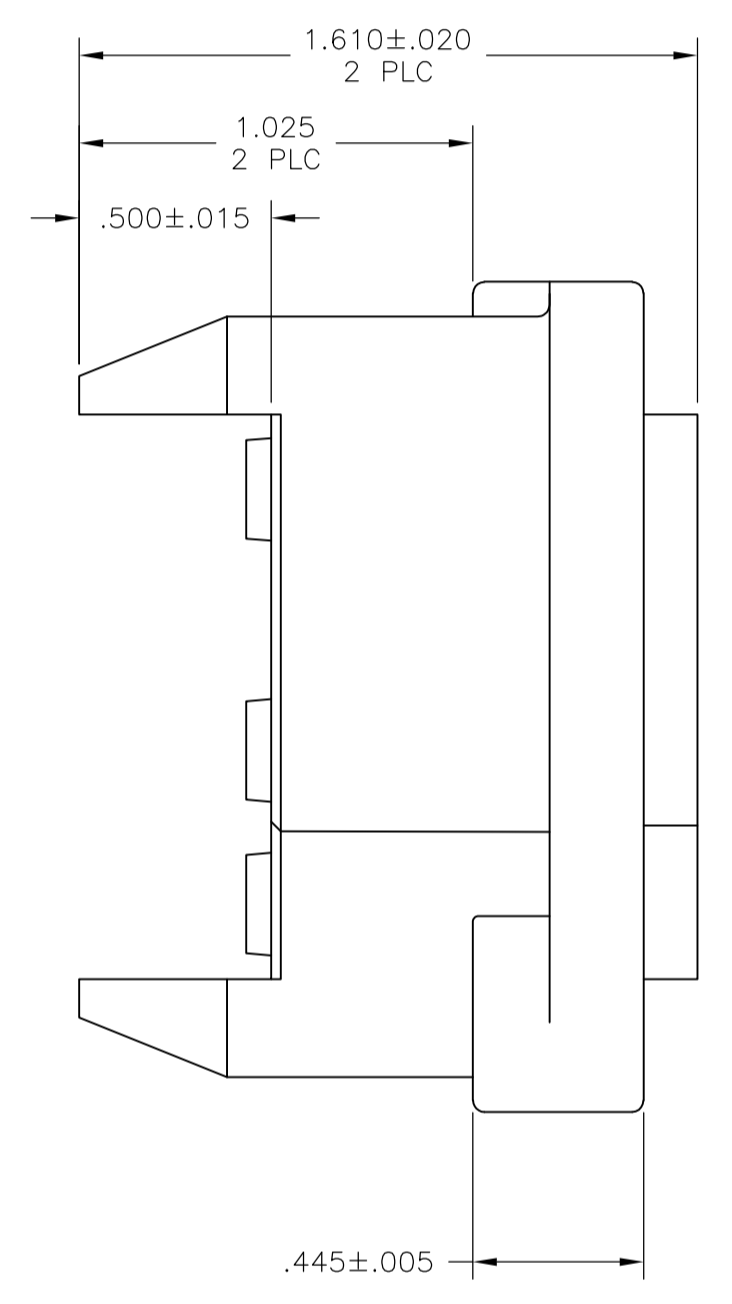
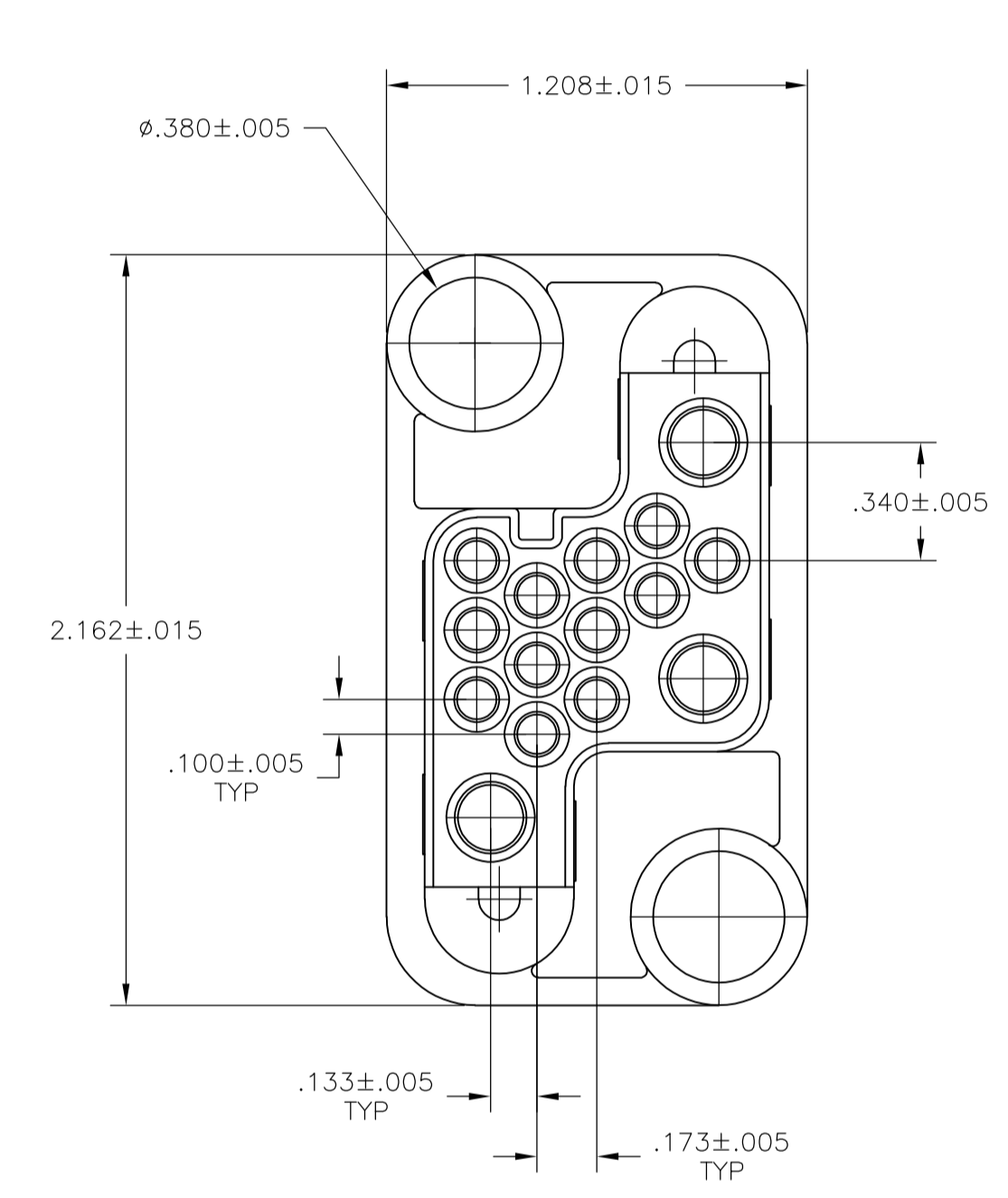

RECOMMENDED PANEL CUTOUT

THIS DRAWING IS A CONTROLLED DOCUMENT.		DIN S SCHLEGEL 2/6/03	Tyco Electronics Corporation Harrisburg, PA 17105-3608	
DIMENSIONS: INCHES		CHK G STEINHAUER 2/6/03	APVD G STEINHAUER 2/6/03	
TOLERANCES UNLESS OTHERWISE SPECIFIED:		NAME HOUSING, PLUG, DRAWER CONNECTOR, 15 POSITION METRIMATE		
0 PLC ± -	1 PLC ± -	PRODUCT SPEC		
2 PLC ± .010	3 PLC ± -	APPLICATION SPEC		
4 PLC ± -	ANGLES ± 0°30'	SIZE A1	CAGE CODE 00779	DRAWING NO C=213426
MATERIAL POLYESTER, BLACK	FINISH -	WEIGHT -	RESTRICTED TO -	CUSTOMER DRAWING
		SCALE 2:1	SHEET 1 OF 1	REV E1

X-ON Electronics

Largest Supplier of Electrical and Electronic Components

Click to view similar products for [Headers & Wire Housings](#) category:

Click to view products by [TE Connectivity](#) manufacturer:

Other Similar products are found below :

[892-18-020-10-001101](#) [58102-G61-06LF](#) [582553-1](#) [0009485154](#) [009176003701906](#) [0050291907](#) [LY20-4P-DT1-P1E-BR](#) [02.125.8002.8](#)
[609-3404](#) [61062-3](#) [61082-181009](#) [622-3653LF](#) [63453-116](#) [636-1030](#) [636-1427](#) [636-3427](#) [636-4007](#) [641938-9](#) [641991-4](#) [644827-2](#) [65817-010LF](#) [65817-015LF](#) [65863-015LF](#) [66207-023LF](#) [67095-007LF](#) [67601157](#) [68645-018](#) [68648-049](#) [70.362.1628.0](#) [70-4210](#) [70-4226B](#) [70-4853B](#) [707-5020](#) [707-5028](#) [71.350.2428.0](#) [71918-208LF](#) [71961-016LF](#) [733-134](#) [733-162](#) [754199-000](#) [760-3052](#) [787-8014-00](#) [79531-3000](#)
[FCN-360C032-B](#) [FCN-367T-T012/H](#) [FCN-723D010/2](#) [80.063.4001.1](#) [800-90-001-10-001000](#) [800-90-010-10-002000](#) [801-43-002-10-013000](#)