

THIS DRAWING IS UNPUBLISHED. RELEASED FOR PUBLICATION
 © COPYRIGHT - By - ALL RIGHTS RESERVED.

| REVISIONS | | | | |
|-----------|-----|---------------------------|-----------|-------|
| P | LTR | DESCRIPTION | DATE | APVD |
| | A3 | REVISED PER ECO-15-013981 | 29DEC2015 | NK MZ |

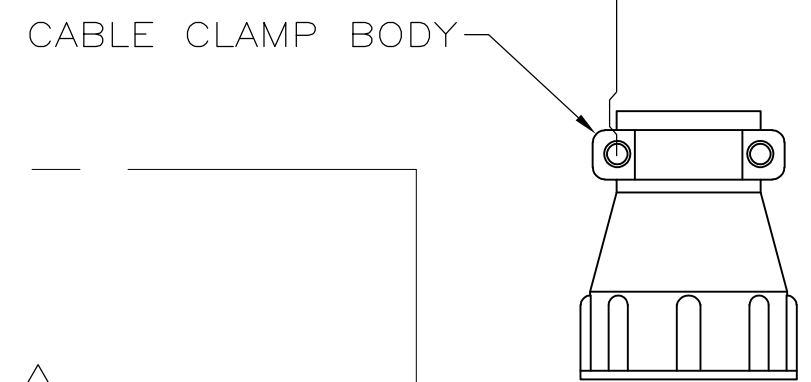

- 1 CABLE CLAMP BODY AND INSERTS: NYLON, BLACK. SCREWS: CARBON STEEL.
- 2 CABLE CLAMPING AREA ADJUSTABLE FROM 0.25 [.010] TO 4.09 [.161] SQ AREA BY REVERSING OR CHANGING CLAMPING INSERTS.
- 3 11.51 [.453] MAXIMUM CABLE OUTSIDE DIAMETER.
- 4 SCREWS: ZINC PLATE, NON-HEXAVALENT COATING.
- 5 OBSOLETE PARTS: OBSOLETE CIS STREAMLINING PER D.RENAUD/D.SINISI

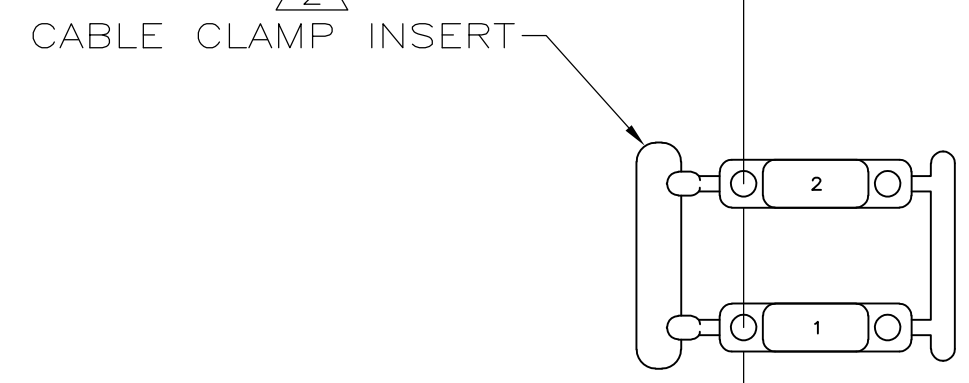
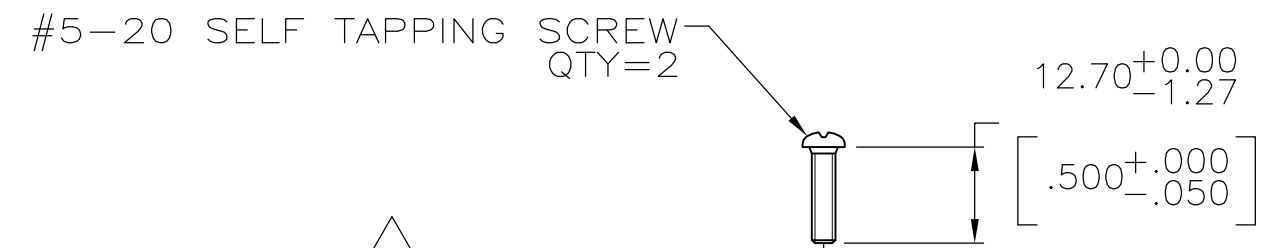
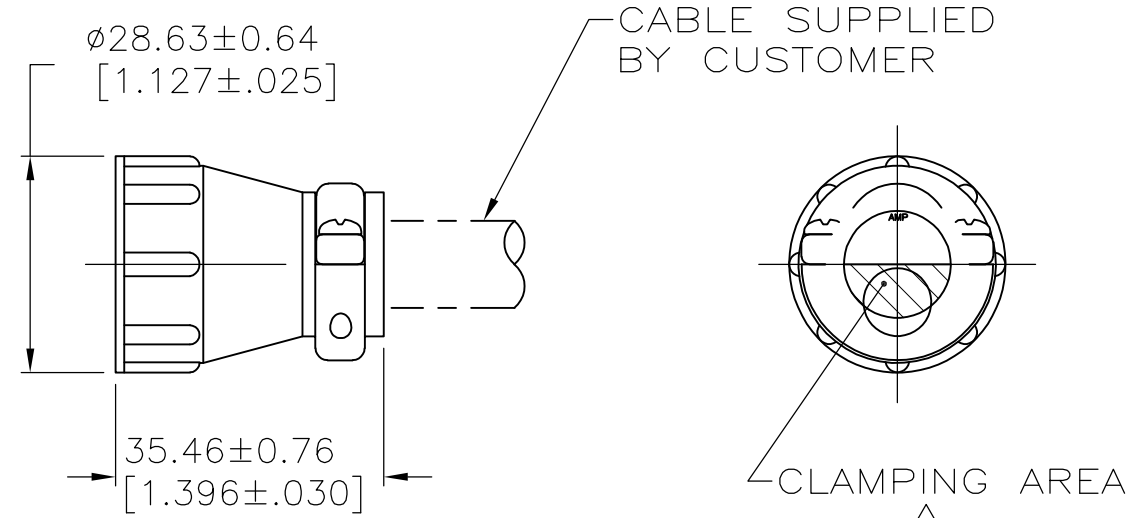

| SCREW FINISH | PACKAGING | PART NUMBER |
|--------------|------------|-------------|
| 4 | BULK | 213904-4 |
| 4 | INDIVIDUAL | 213904-3 |
| 4 | BULK | -213904-2 |
| 4 | INDIVIDUAL | -213904-1 |

THIS DRAWING IS A CONTROLLED DOCUMENT.

| | | | | | | | |
|------------------|-----------|----------|---|-------|-----------|------------|---------------|
| DWN | D.HARDY | 07/12/95 | TE Connectivity CABLE CLAMP KIT, STANDARD, UNASSEMBLED, SIZE 17, CPC | | | | |
| CHK | R.STONE | 07/13/95 | | | | | |
| APVD | A.FRANTUM | 07/14/95 | | | | | |
| PRODUCT SPEC | 108-1579 | | | | | | |
| APPLICATION SPEC | - | | NAME | | | | |
| MATERIAL | 1 | FINISH | - | SIZE | CAGE CODE | DRAWING NO | RESTRICTED TO |
| CUSTOMER DRAWING | | | | A3 | 00779 | C-213904 | - |
| | | | | SCALE | 1:1 | SHEET | 1 OF 1 |
| | | | | | | REV | A3 |

X-ON Electronics

Largest Supplier of Electrical and Electronic Components

Click to view similar products for [Standard Circular Connector](#) category:

Click to view products by [TE Connectivity](#) manufacturer:

Other Similar products are found below :

[5M2530B10P](#) [600259N006](#) [600273N007](#) [6134-336-13149](#) [6134-337-11149](#) [6134-337-2390](#) [6134-341-17149](#) [6280-4SG-516](#) [6280-7SG-3DC](#)
[6290](#) [6291A](#) [66200A-10](#) [680-SMG](#) [681-PMG](#) [CXS3102A14S2P](#) [CXS3102A181S](#) [7271-6SG-300](#) [7282-3PG-300-CH3](#) [75-474618-01S](#) [75-](#)
[474618-04P](#) [75-474618-04S](#) [799539-000](#) [MI8-SE](#) [805-005-07NF11-19PC](#) [805-005-07NF15-7PA](#) [8280-4PG-516](#) [8280-7PG-519](#) [8282-5PG-](#)
[519](#) [836783-1](#) [MP-4102-25P-C](#) [862256-1](#) [864019-2](#) [866857-1](#) [867865-1](#) [PT01SP-14-18P](#) [PT08P-14-5S](#) [120-1833-000](#)
[QCM019PC2DC012B](#) [1-2069279-1](#) [121583-0217](#) [121667-0020](#) [129591AU](#) [1000B BULK](#) [RD10A16-19-P6CS051/1](#) [RD10A20-31-](#)
[P8CS051/1](#) [RD16A14-12-S6CS051/2](#) [1301240290](#) [1301240347](#) [1301860202](#) [1301240268](#) [1301240275](#)