

NOTES

1. All dimensions are in [inches] [millimeters] : [lbs] [gms]

2. Dimensions appearing in table are as follows:

a - As Supplied

b - After Unrestricted Recovery

3. Coating is optional. As supplied dimensions appearing in table are for uncoated parts. When coating is added, entry diameters will be reduced by .05 max.

4. Molding ports are optional. When specified molding ports will be located as shown.

5. Weight shown in table of dimensions is based on polyolefin part.

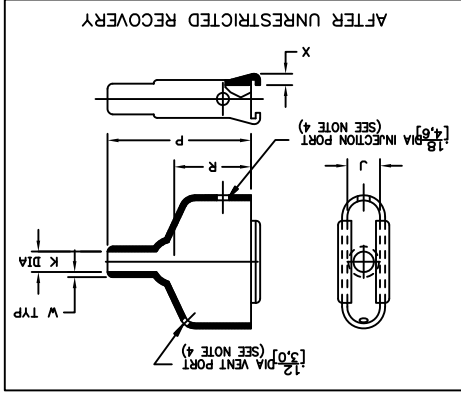
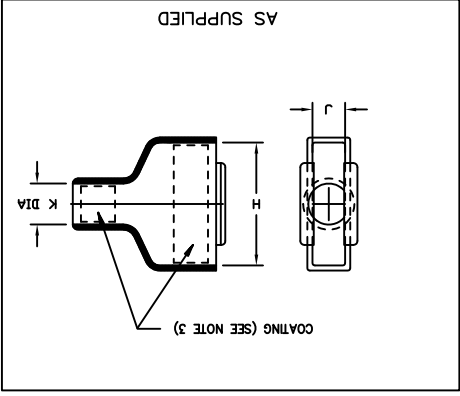

ORDERING INFORMATION

214A0XX -XXX -XX /XXX -0

Base part number

Material dash number (See Compatibility Chart)

Modification number

Adhesive slash number (if necessary, see Compatibility Chart)

Color Designator

COMPATABILITY CHART			
MATERIAL DASH NO.	MATERIAL DESCRIPTION	RT SPEC	COATING SLASH NO.
-3	Polyolefin, Semi-Rigid	RT-301	/42./86
-4	Polyolefin, Flexible	RT-1304	/42./86
-5	Elastomer, Flexible	RT-501	/42
-6	Silicone	RT-602	N/A
-8	Space Polyolefin	N/A	
-12	*WTN, Flexible	RT-1308	N/A
-25	Elastomer, Fluid Resistant	RT-1325	/42.86
-100	Polyolefin, Semi-flexible	RT-1323	/180

\*WTN is a Registered Trademark of Dupont ZEPHOL

PART NUMBER		H	J	K	P	R	W	X	Weight	This Boot Fits	Amphenol Series 17
214A011	Min	.85	.20	.33	.10	.12	.04	.04	.0044	DE-9	XX09X
214A021	Min	.47	.42	.40	.21	.15	.07	.12	.0057	DA-15	XX15X
214A032	Min	.47	.42	.40	.21	.15	.07	.12	.0057	DB-25	XX25X
214A042	Min	.47	.42	.40	.21	.15	.07	.12	.0057	DC-37	XX37X
214A052	Min	.47	.42	.40	.21	.15	.07	.12	.0057	DD-50	XX50X

TABLE OF DIMENSIONS

Raychem Molded Parts

CUSTOMER DRAWING

THIS DRAWING AND THE INFORMATION SET FORTH HEREON ARE THE PROPERTY OF TYCO ELECTRONICS CORPORATION, AND ARE TO BE HELD IN TRUST AND CONFIDENCE. PUBLICATION, DUPLICATION, DISCLOSURE OR USE FOR ANY PURPOSE NOT EXPRESSLY AUTHORIZED IN WRITING BY TYCO ELECTRONICS CORPORATION IS PROHIBITED.

DRAWN		APPROVED		M. Mazariegos D. Hurrell		5/30/12		TE Connectivity	
UNLESS OTHERWISE SPECIFIED DIMENSIONS ARE METRIC, AND INCHES ARE IN BRACKETS.		DECIMAL TOLERANCES		X ± 0.13 (0.005)		X ± 0.50 (0.01)		X ± 1 DEG.	
ANGLE TOLERANCE		X ± 1 DEG.		X ± 0.50 (0.01)		X ± 0.25 (0.01)		X ± 0.13 (0.005)	
THIRD ANGLE PROJECTION		CAD FILE:		214A011THR052_CD		RPN		TITLE	
TYCO ELECTRONICS RESERVES THE RIGHT TO SHOULD EVALUATE THE SUBMITTER OF THE PRODUCT FOR APPLICATION.		SIZE		B		06090		DO NOT SCALE THIS DRAWING	
© 2011-2012 Tyco Electronics Corporation. All rights reserved.		SHEET 1 OF 1		214A011thr052		DWG. NO.		SUBMINIATURE, STRAIGHT	

DIMENSIONING AND TOLERANCING PER ASME Y14.5M (ISO STANDARDS)

REVISIONS

DESCRIPTION

DATE

RELEASE PER ECO-12-010855

06/11/2012

## X-ON Electronics

Largest Supplier of Electrical and Electronic Components

*Click to view similar products for [Cable Boots](#) category:*

*Click to view products by [TE Connectivity](#) manufacturer:*

Other Similar products are found below :

[618235-000](#) [622A014-3-0](#) [CX4132-000](#) [879103-4](#) [879515-000](#) [889092](#) [982033-2](#) [R280576000](#) [1300830729](#) [MTPSRBCL-C](#) [1811481-1](#)  
[200W531-3-0](#) [202A121-386-0](#) [202A142-4-00/42-0](#) [202A163-4-0-CS5067](#) [202B221-13-0](#) [202B231-13-0](#) [202B563-25-07-0](#)  
[202C621710CS5361](#) [202D132-4-07/42-0](#) [202D221-4-0-CS5349](#) [202D221-4-26-0](#) [202D263-25-08-0](#) [202D263-4-22/42-0](#) [202D263-4-88-0](#)  
[202D921-2542-0](#) [202E336-71-0](#) [202F211-50-22-0-CS8474](#) [202F242-50-05-0](#) [202F242-51-04/164-0](#) [202K121-25-CS-1858-0](#) [202K121-25-](#)  
[CS-2062-0](#) [202K132-25-01/225-0CS8387](#) [202K153-3-0186-0](#) [202S132-25-UP-0](#) [203W301-3/42-0](#) [207W613-100/184-0-CS5657](#) [207W623-](#)  
[100-01/184-0](#) [207W634-100/184-0-CS5657](#) [207W656-100-01/184-0](#) [207W667-100-01/184-0](#) [207W667-100/184-0](#) [208A011-3-0](#) [208A021-3-](#)  
[0](#) [221A011-51164-0-CS7133](#) [222A121-2586](#) [222A152-342-0](#) [222A213-25-0-CS5613](#) [222D221-25-13/86-0](#) [222D232-4-61-0-CS5078](#)