

DO NOT SCALE

DIMENSIONS IN mm

METRIC

THIRD ANGLE

PROJECTION



P.C.B. HOLE DIM. ACTION PIN

DRILLED HOLE	:1,60 ±0,025 mm
FIN. HOLE	:1,39 to 1,54 mm
AFTER REFLOW	:1,37 to 1,54 mm
Cu-thks	:0,025 to 0,075 mm
SnPb-thks	:0,004 to 0,010 mm

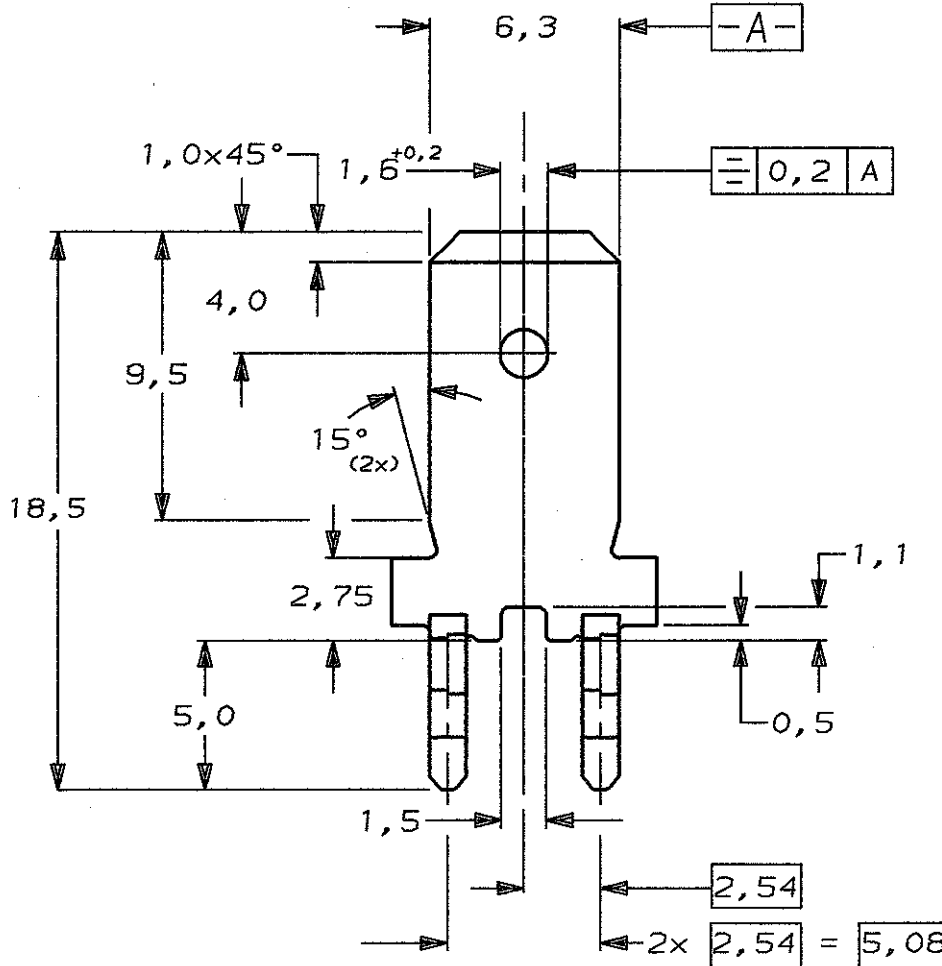
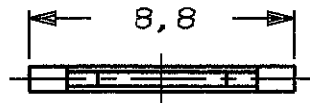

2,54µM MIN. SNPB (93/7) ALL OVER.

PHOSPHORBRONZE

216926-1

FINISH

MATERIAL

PARTNUMBER

CUSTOMER DRAWING



AMP-HOLLAND B.V.

's-Hertogenbosch, The Netherlands.

FOR REFERENCE ONLY WILL NOT BE UPDATED

THIS DRAWING IS UNPUBLISHED RELEASED FOR PUBLICATION FROM 19-

© COPYRIGHT 19- BY AMP-HOLLAND B.V. ALL INTERNATIONAL RIGHTS RESERVED. AMP PRODUCTS MAY BE COVERED BY U.S. AND FOREIGN PATENTS AND/OR PATENTS PENDING.

DR. S.MEEUWSEN DATE 01-03-90

WIRE RANGE NAME

.250'' SERIES TAB WITH ACTION PIN, FOR POSITIVE LOCK RECEPTACLE. (1,6-3,2 P.C.BOARD THK'S). LOOSE PIECE VERSION.

REV. DATE D M Y

CHK. R.V.LOKVEN DATE 03-04-90

INSUL. RANGE

19 02 91

APP. L.V.SOEST. DATE 03-04-90

SIZE A4 SHEET 1 OF 1

DWG. No. C-216926

REV. LTR. B

X-ON Electronics

Largest Supplier of Electrical and Electronic Components

Click to view similar products for [Terminals](#) category:

Click to view products by [TE Connectivity](#) manufacturer:

Other Similar products are found below :

[HT-13-10](#) [71M-250-32-NB](#) [01-2065-1-0216](#) [00581P0075](#) [M10-10RX](#) [M10BCK](#) [60205-1](#) [604200-1](#) [60598-1-CUT-TAPE](#) [60617-1-C](#) [60873-1](#) [M14-516R/SK](#) [M14-6RSX](#) [M18-8FBX](#) [M18-8R/LX](#) [M18BCK](#) [61314-6-C](#) [61-S](#) [61-SN-A](#) [62-NBM-A](#) [63-S](#) [640179-1](#) [640917-2-CUT-TAPE](#) [6501550002](#) [66107-2-C](#) [696683-1](#) [696834-1](#) [696861-1](#) [696931-1](#) [696999-1](#) [M8-516RK](#) [M86700006](#) [MA250DMFMX-A](#) [701-2007](#) [701-2307](#) [701-7761-03](#) [70F-110-32-PB](#) [718-N-A](#) [71M-187-20-NBL](#) [71M-250-32-NBL](#) [72F-187-20-NBL](#) [72M-250-32-NBL](#) [7310](#) [73F-250-32](#) [73F-250-32-NL](#) [F14-10C](#) [F-1M](#) [751-250](#) [76650-5002](#) [76828-149](#)