

LOC		DIST		REVISIONS			
P	LTN	DESCRIPTION	DATE	DWN	APVD		
A		RELEASE TO ACTIVE	1NOV2016	RG	SH		

- 1 SURFACE TRACES PERMITTED WITHIN THIS AREA EXCEPT WHERE CAGE STANDOFFS, SHOWN IN DETAIL S, CONTACT PC BOARD.
- 2 PITCH BETWEEN PORTS OF ONE 1X4 CAGE.
- 3 SPACING BETWEEN CAGES ON THE SAME PC BOARD. TO BE SPECIFIED BY CUSTOMER, MUST COMPLY WITH MINIMUM DIMENSIONS SHOWN.
- 4 REFERENCE APPLICATION SPEC 114-13217 FOR RECOMMENDED DRILL HOLE DIAMETER AND PLATING THICKNESS.
- 5 UNPLATED THRU HOLE.
- 6 DATUM AND BASIC DIMENSION ESTABLISHED BY CUSTOMER.
- 7 DATUM -A- IS TOP SURFACE OF THE HOST BOARD.
- 8 DIMENSION C IS THE NOMINAL THICKNESS OF CUSTOMER SUPPLIED PC BOARD. MINIMUM PC BOARD THICKNESS:  
 SINGLE SIDED: 1.45mm  
 DOUBLE SIDED: 5.0mm PER CUSTOM
- 9. MATES WITH QSFP MSA COMPATIBLE TRANSCEIVER.
- 10 BASELINE FOR THE DIMENSION IS CENTER OF COMPLIANT PIN HOLE.
- 11 LED ON HOST BOARD. QUANTITY, POSITION, AND GEOMETRY DEPENDS ON CHOICE OF LIGHT PIPES.
- 12 DATE CODE (YYWW) MARKED APPROXIMATELY AS SHOWN.
- 13 REFERENCE APP SPEC 114-13217 FOR GASKET THICKNESS CALCULATION.
- 14 MATERIAL:  
 CAGE ASSEMBLY: NICKEL SILVER, 0.25 THICK  
 EMI SPRINGS: COPPER ALLOY  
 GASKET PLATE: STAINLESS STEEL
- 15 FINISH:  
 EMI SPRINGS: TIN PLATING OVER NICKEL

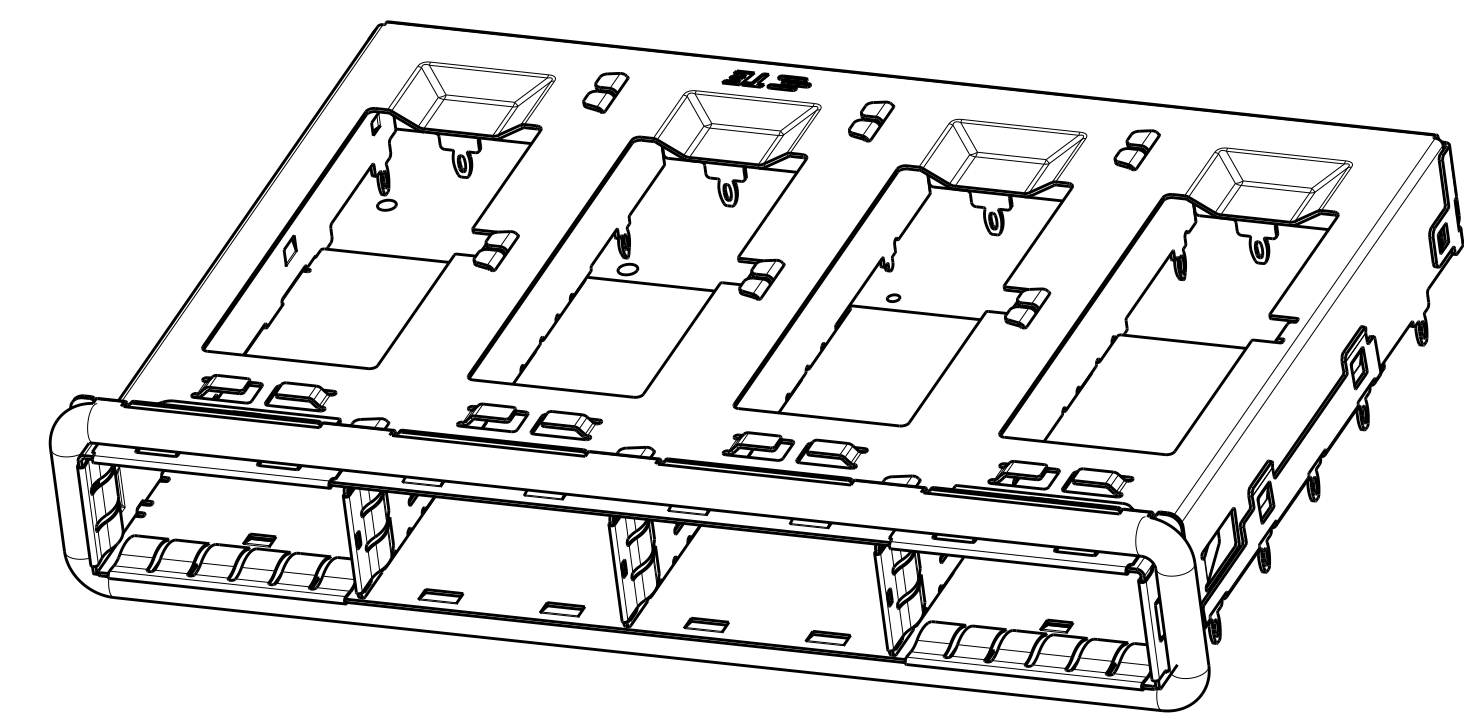

ELASTOMERIC GASKET

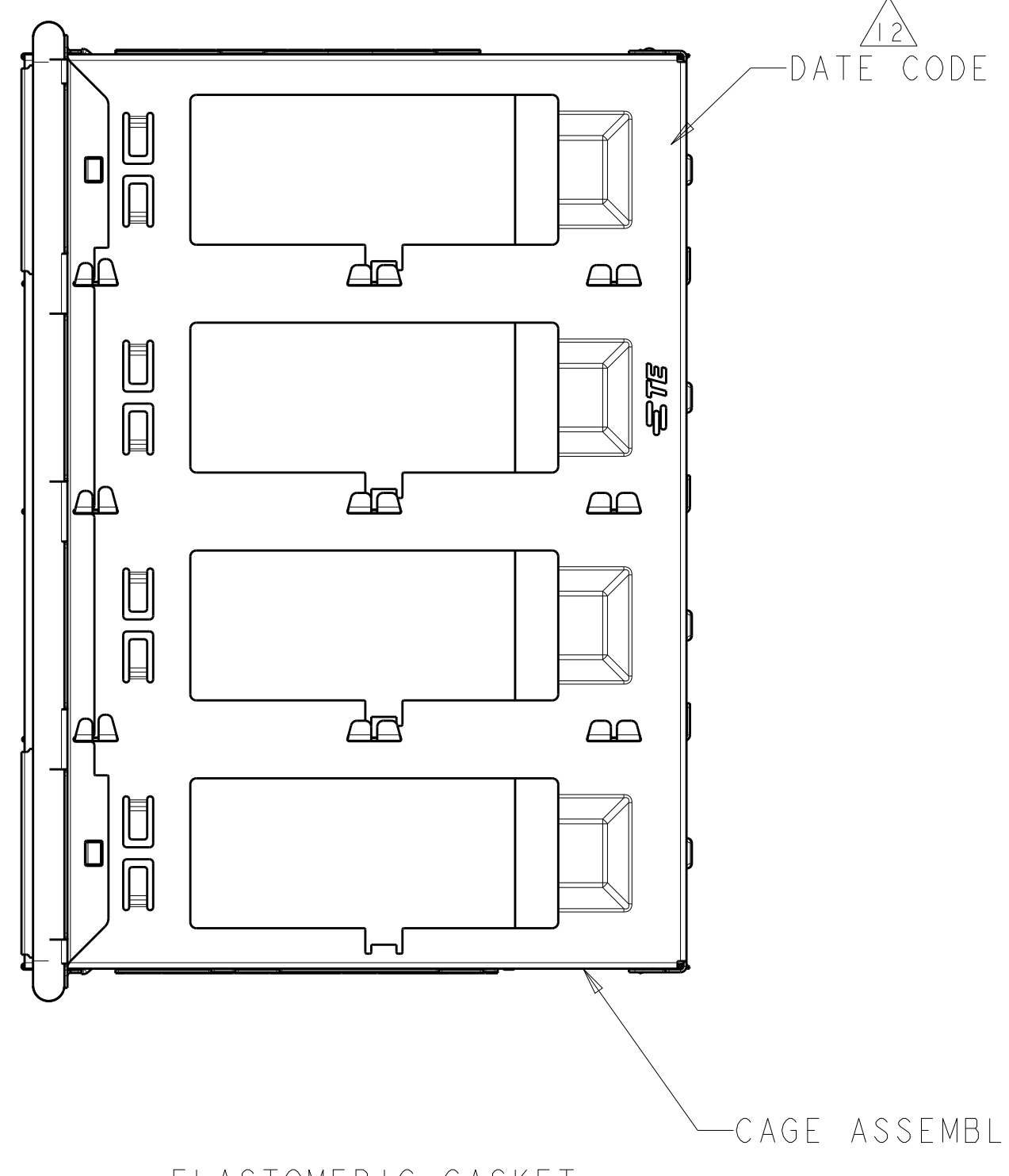
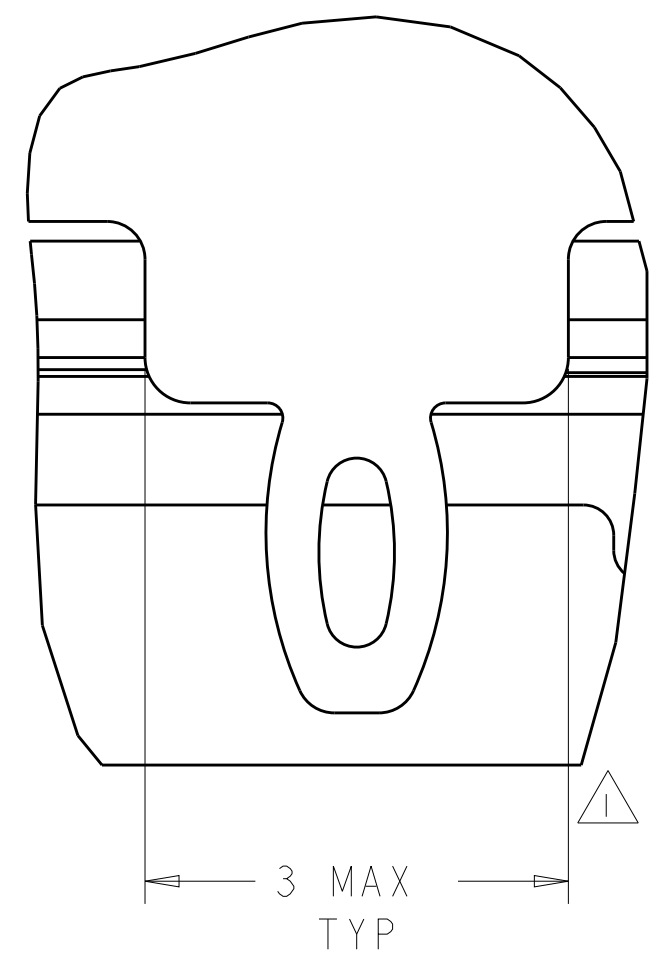
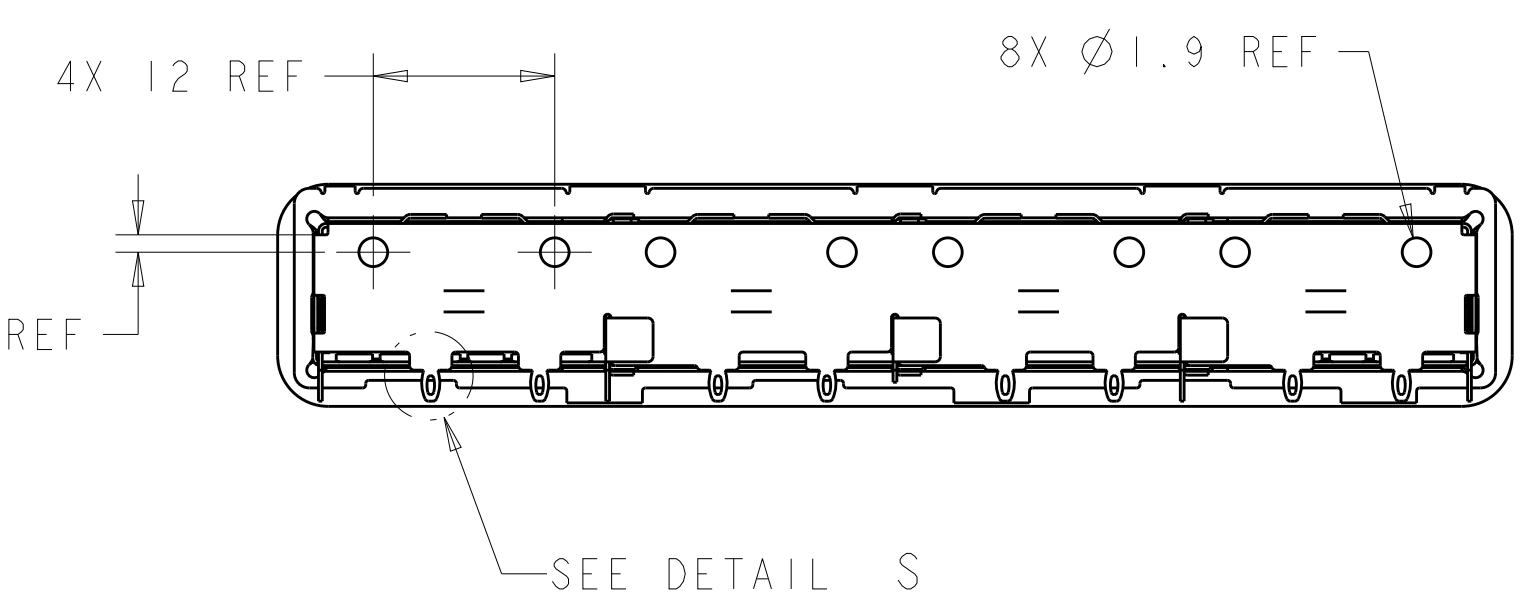
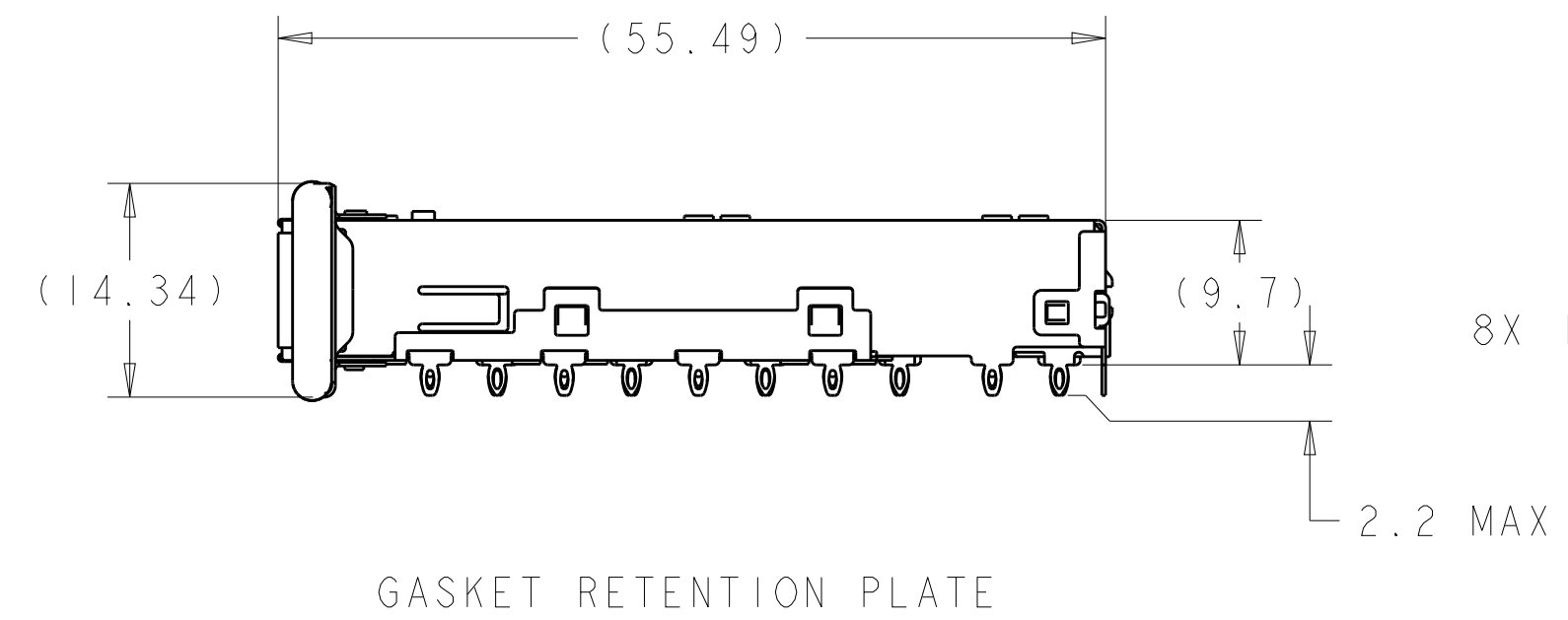
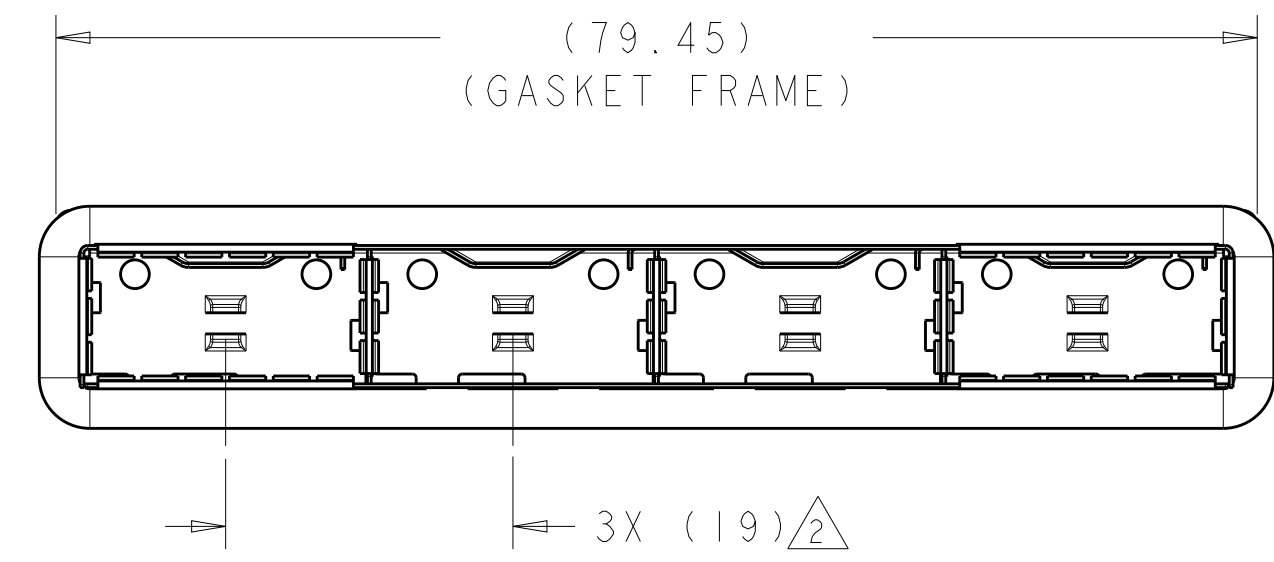

DETAIL S  
SCALE 20:1

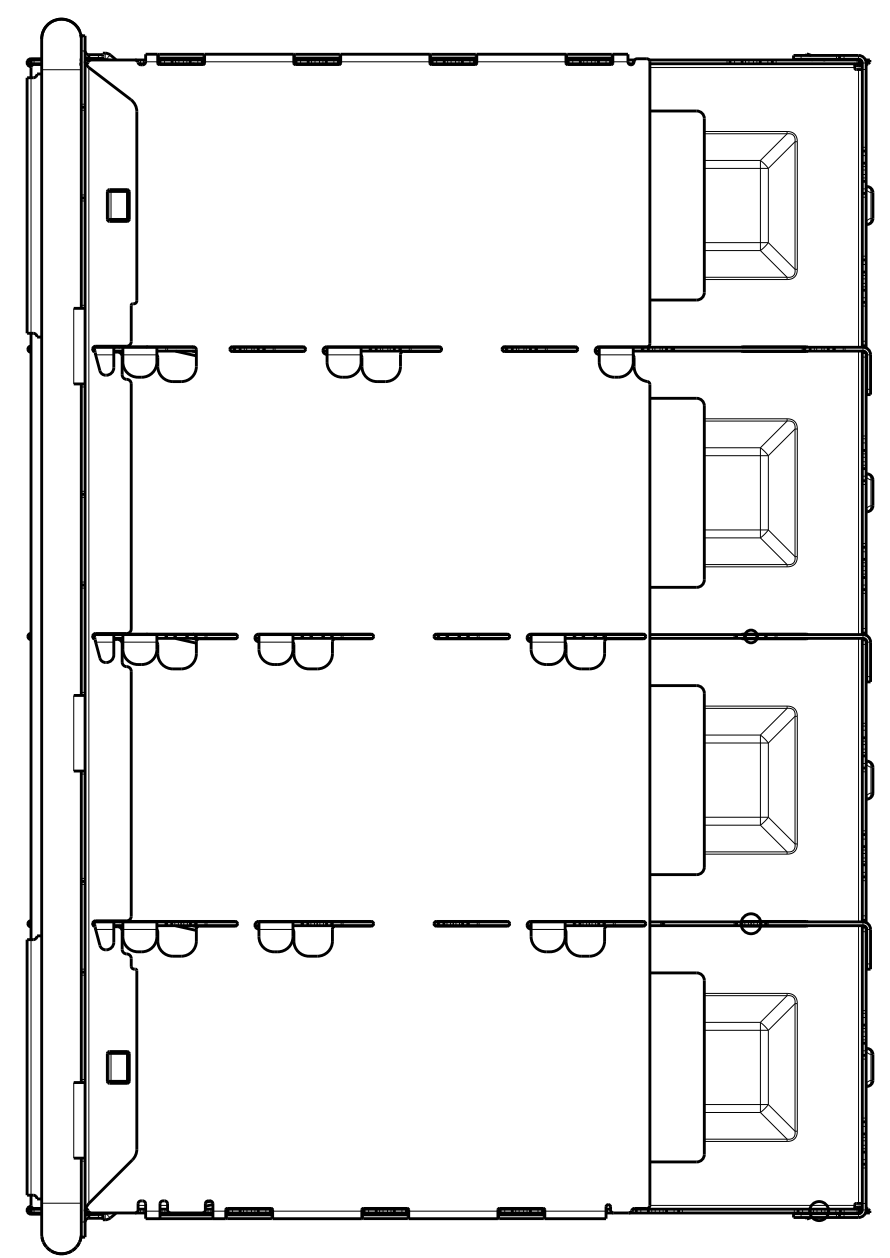

2170288-1  
PART NUMBER

THIS DRAWING IS A CONTROLLED DOCUMENT.		DWN: KINSEN SUN 05MAR2012	TE Connectivity	
DIMENSIONS: mm		CHK: DENNY ZHU 05MAR2012		
TOLERANCES UNLESS OTHERWISE SPECIFIED:		APVD: AILEY CAI 05MAR2012	NAME: 1X4 CAGE ASSEMBLY, THRU BEZEL, W/ ELASTOMERIC GASKET, QSFP	
0 PLC	±	PRODUCT SPEC	SIZE: CAGE CODE DRAWING NO	
1 PLC	±0.25	108-2286	RESTRICTED TO	
2 PLC	±0.15	APPLICATION SPEC	A100779C=2170288	
3 PLC	±	114-13217	SCALE 2:1 SHEET 1 OF 4 REV A	
4 PLC	±	WEIGHT		
ANGLES	±	CUSTOMER DRAWING		
MATERIAL	FINISH			

LOC		DIST		REVISIONS			
GP	00	P	LTN	DESCRIPTION	DATE	DMN	APVD
-	-	-	-	SEE SHEET 1	-	-	-

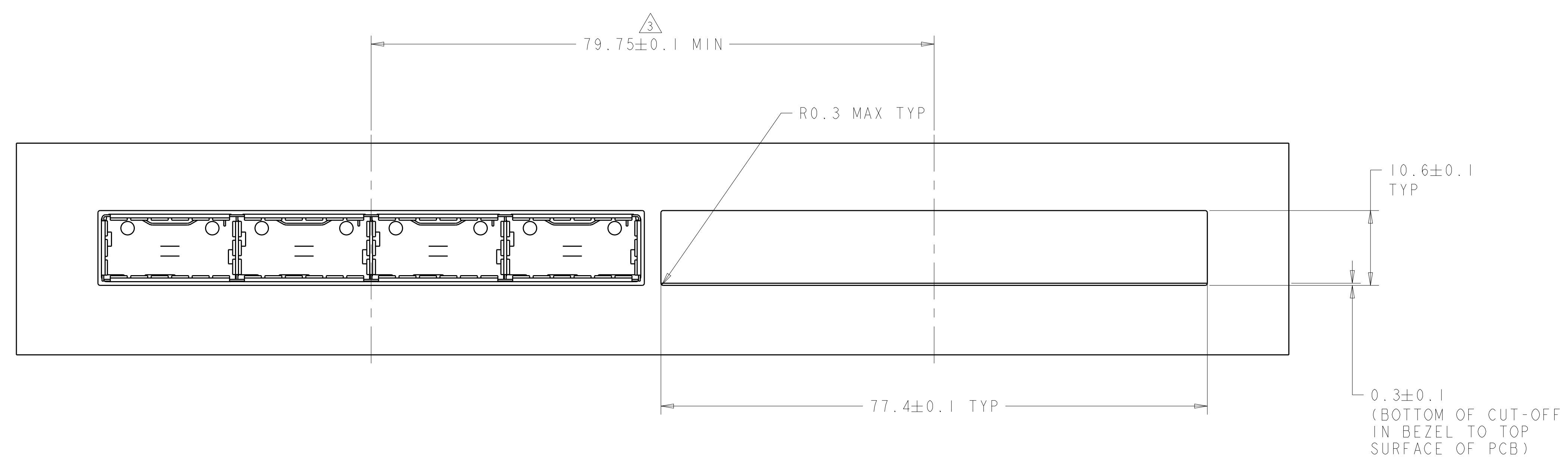

ONE SIDED CONFIGURATION  
 SCALE 5:2

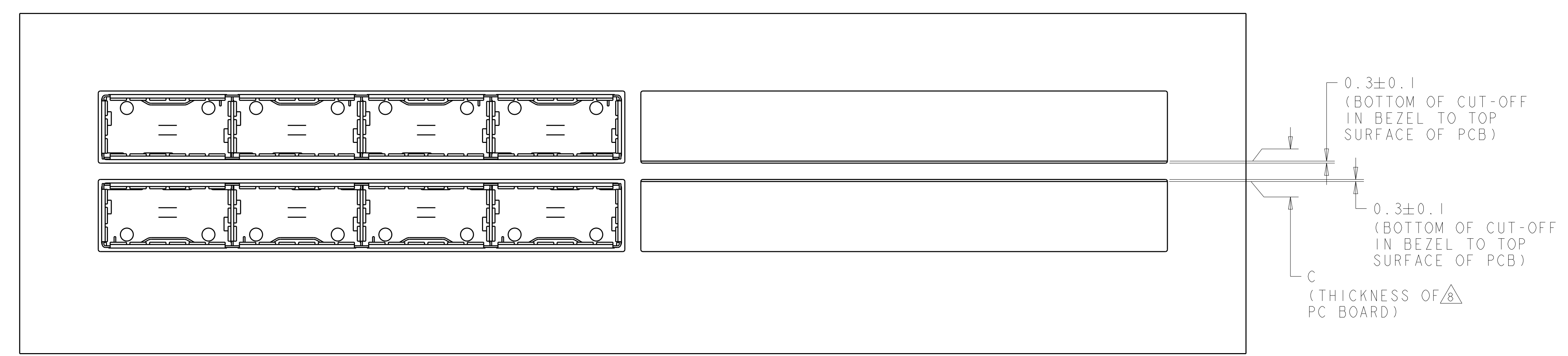
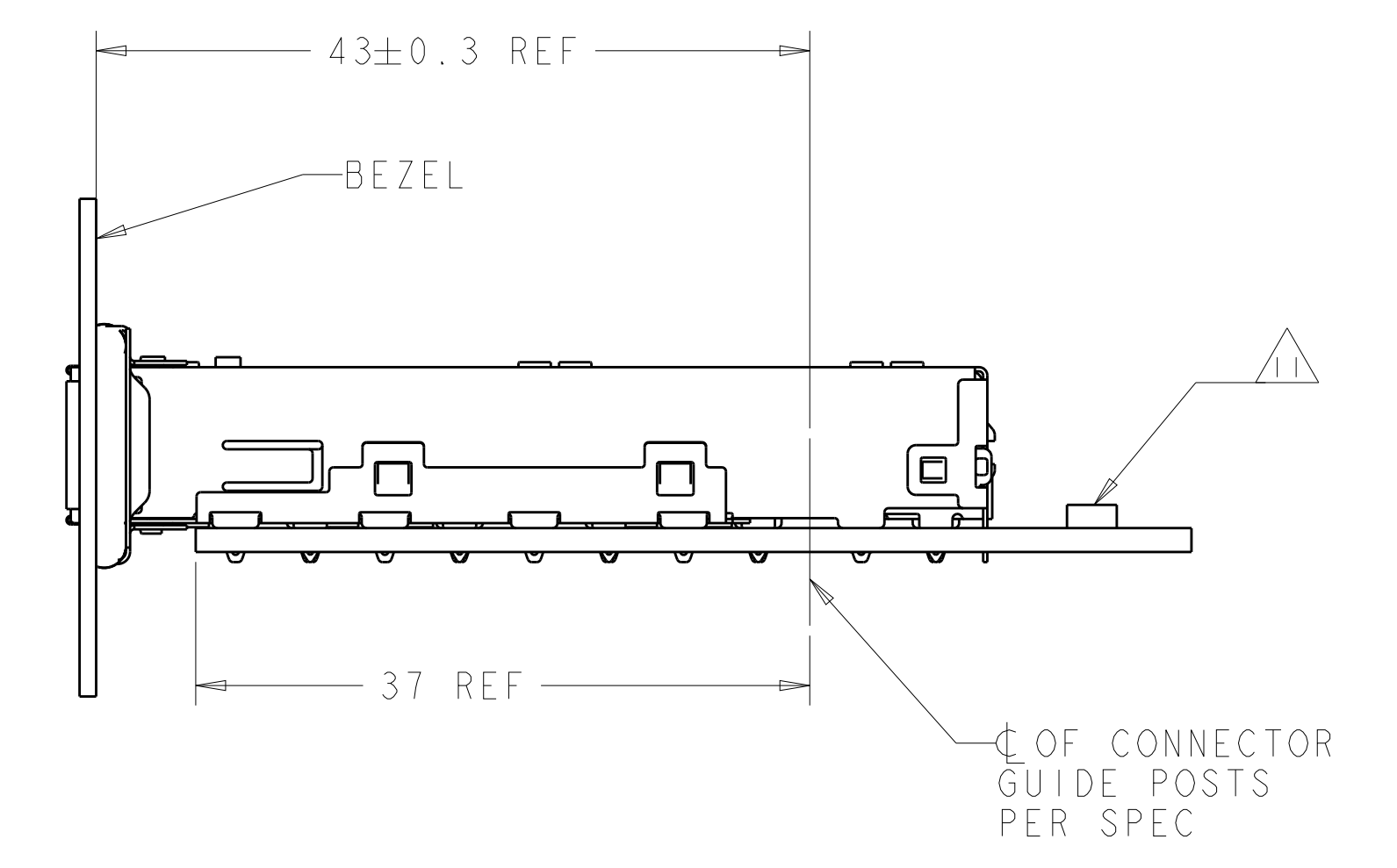

BELLY TO BELLY CONFIGURATION SIMILAR  
 TO ONE SIDED EXCEPT WHERE NOTED  
 SCALE 5:2

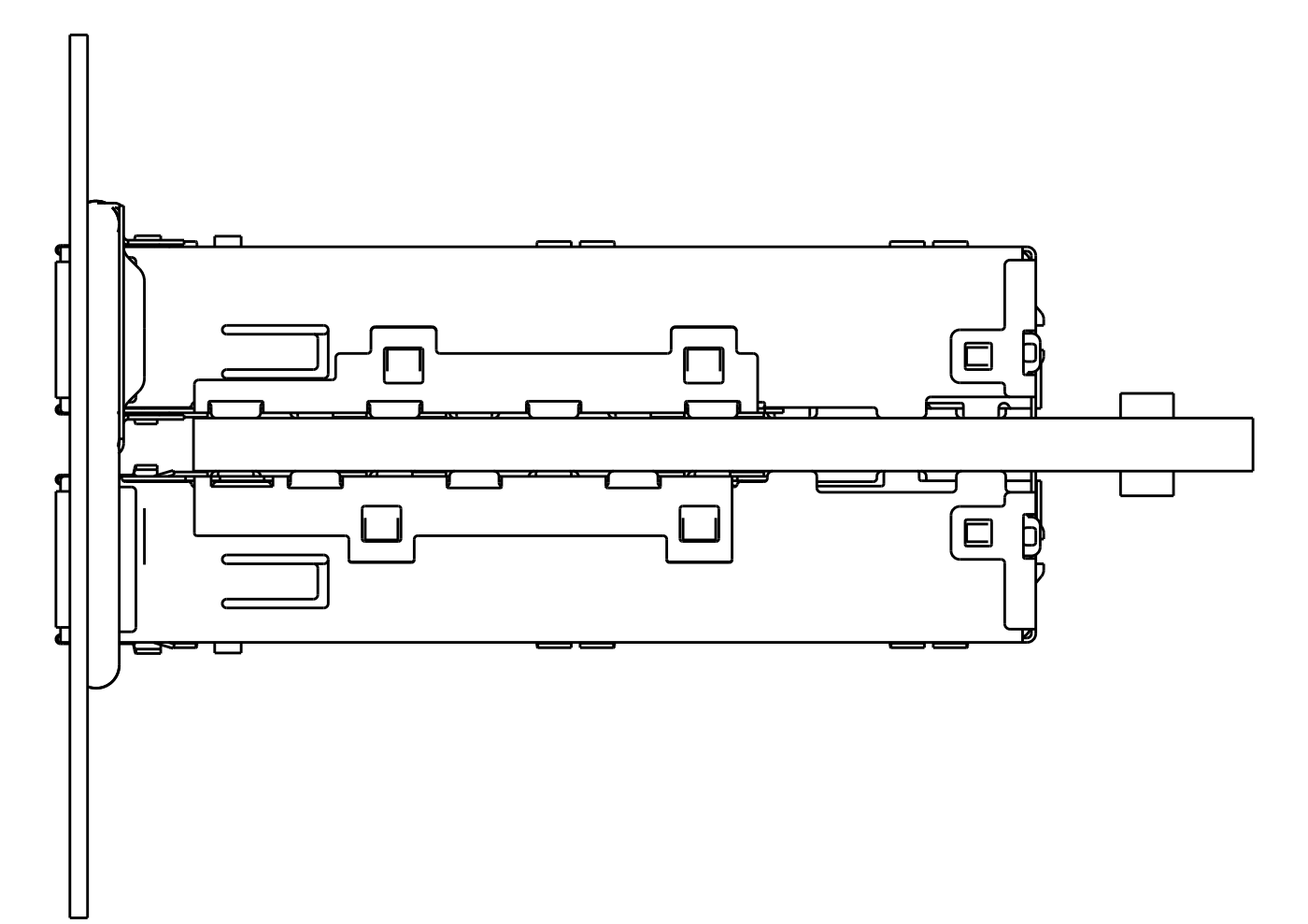

THIS DRAWING IS A CONTROLLED DOCUMENT.		DMN KINSEN SUN 05MAR2012	TE Connectivity
DIMENSIONS:		CHK DENNY ZHU 05MAR2012	
mm	TOLERANCES UNLESS OTHERWISE SPECIFIED:	APVD ALEX CAI 05MAR2012	NAME 1X4 CAGE ASSEMBLY, THRU BEZEL, W/ ELASTOMERIC GASKET, QSFP
0 PLC	±	PRODUCT SPEC	SIZE 108-2286
1 PLC	±0.25	APPLICATION SPEC	RESTRICTED TO
2 PLC	±0.15	114-13217	A100779C=2170288
3 PLC	±	WEIGHT	SCALE 2:1 SHEET 2 OF 4 REV A
4 PLC	±	CUSTOMER DRAWING	
ANGLES	±		
FINISH			

LOC	DIST	REVISIONS				
GP	00	P. LTH	DESCRIPTION	DATE	DWN	APVD
-	-	-	SEE SHEET 1	-	-	-

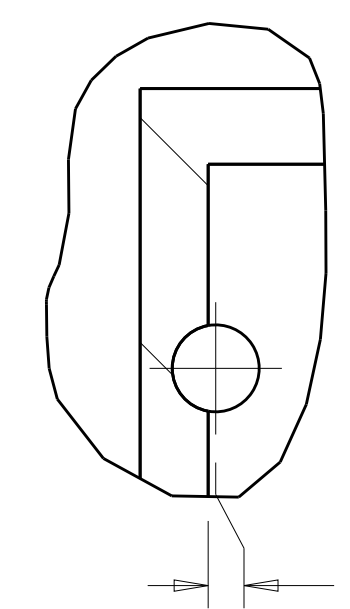

DETAIL M  
SCALE 10:1

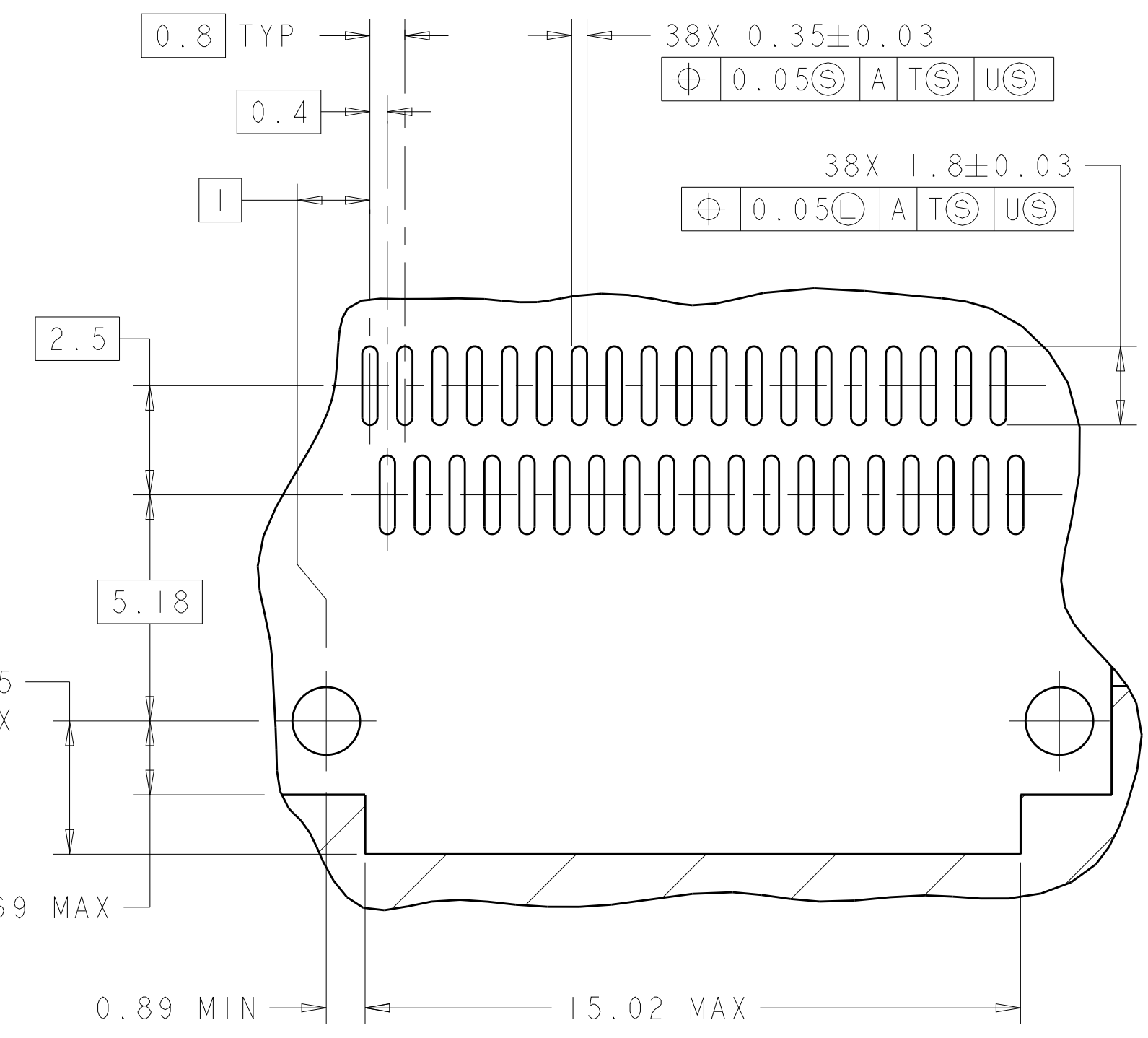
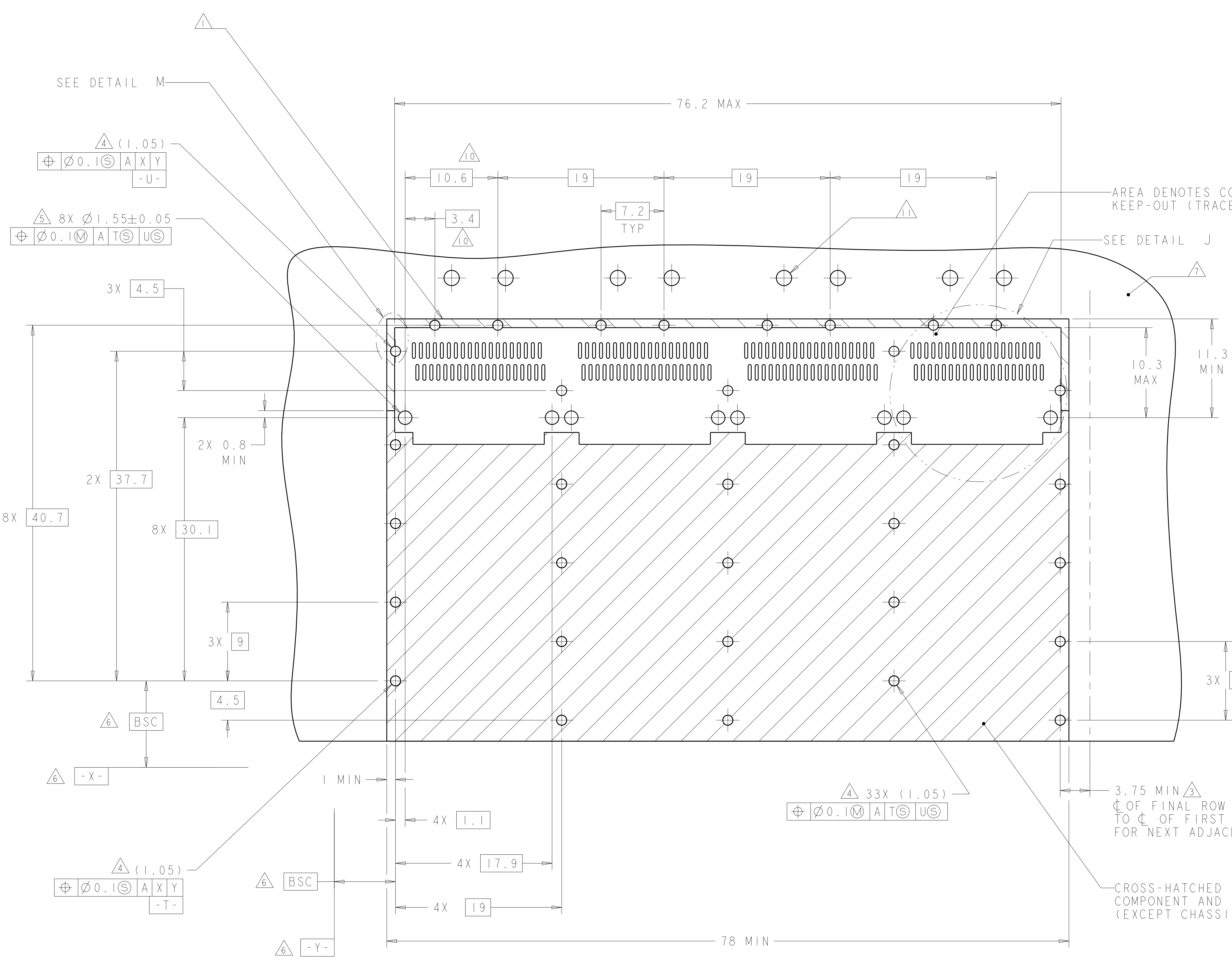

RECOMMENDED PC BOARD LAYOUT  
 SINGLE SIDE MOUNT CONFIGURATION  
 SCALE 4:1

THIS DRAWING IS A CONTROLLED DOCUMENT.		DWN: RINSEN SUN 05MAR2012	TE Connectivity
DIMENSIONS: mm		CHK: DENNY ZHU 05MAR2012	
TOLERANCES UNLESS OTHERWISE SPECIFIED:		APVD: AILEY CAI 05MAR2012	NAME: 1X4 CAGE ASSEMBLY, THRU BEZEL, W/ ELASTOMERIC GASKET, QSFP
0 PLC	±	PRODUCT SPEC	SIZE: CAGE CODE DRAWING NO
1 PLC	±0.10	108-2286	RESTRICTED TO
2 PLC	±0.05	APPLICATION SPEC	A100779C=2170288
3 PLC	±	114-13217	SCALE 2:1 SHEET 3 OF 4 REV A
4 PLC	±	WEIGHT	
ANGLES	±	CUSTOMER DRAWING	
MATERIAL	FINISH		

LOC	DIST	REVISIONS					
GP	00	P.	LTN	DESCRIPTION	DATE	DWN	APVD
		-		SEE SHEET 1			

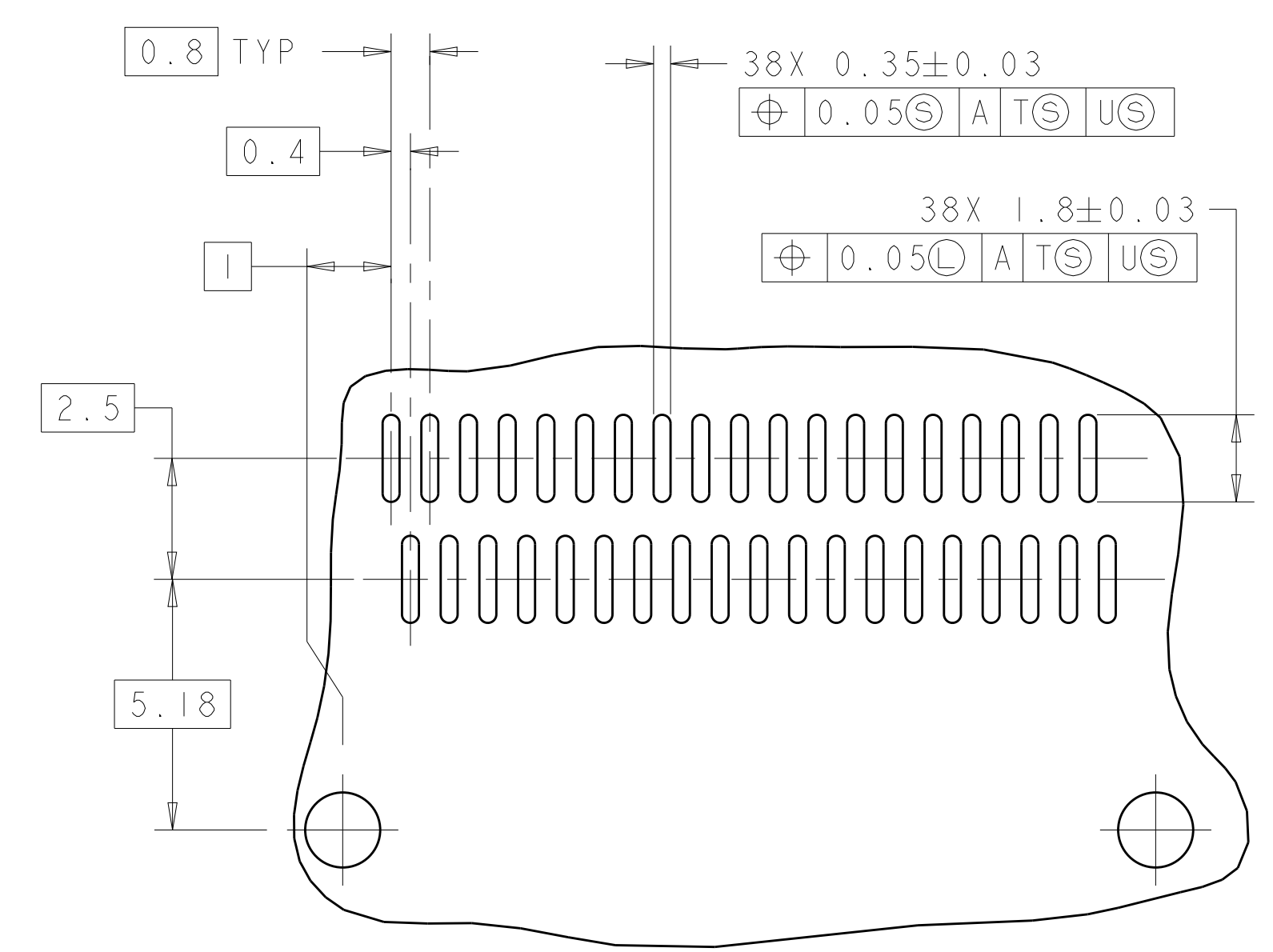
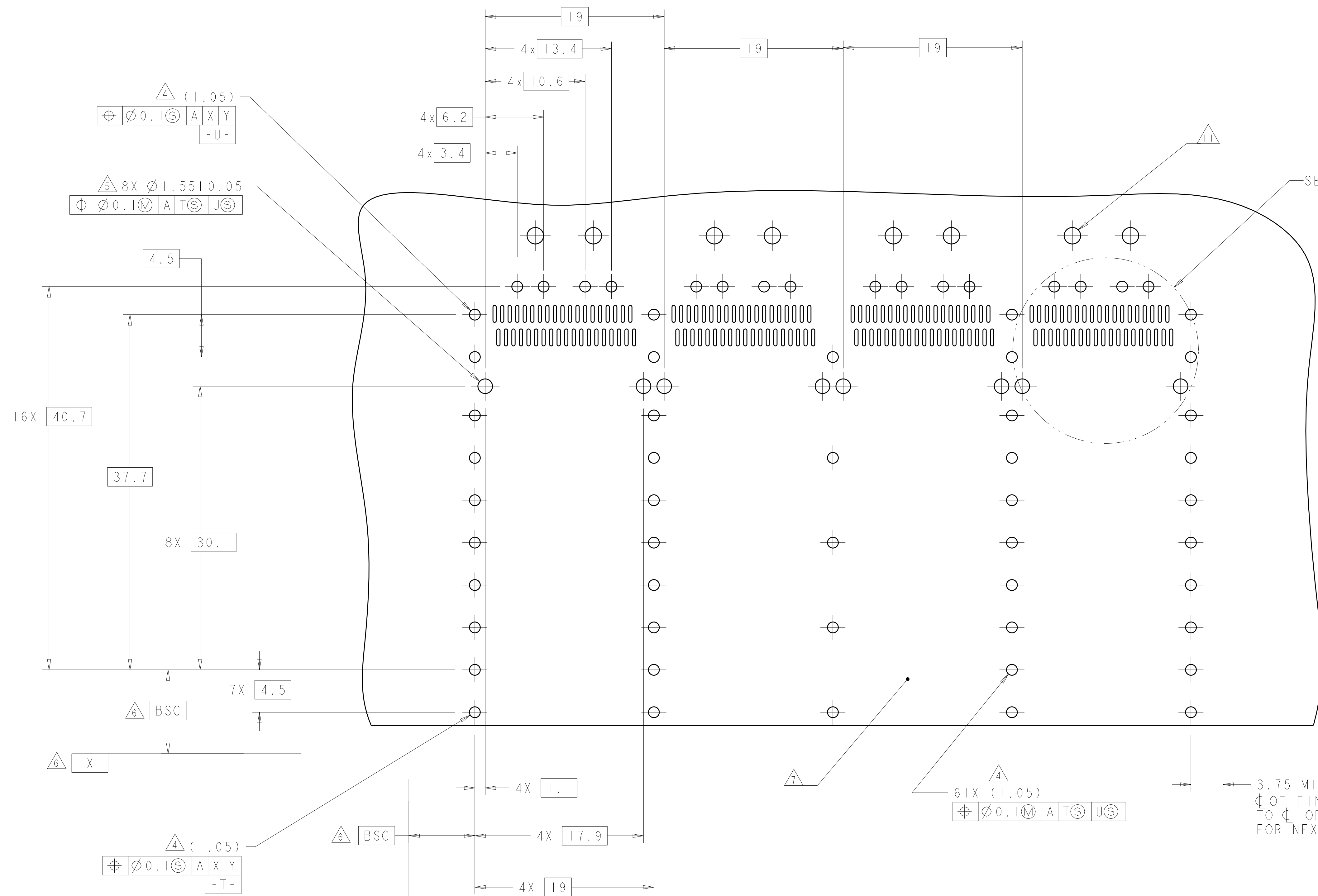

DETAIL K  
SCALE 8:1

RECOMMENDED PC BOARD LAYOUT  
 BELLY TO BELLY CONFIGURATION  
 SEE SHEET 3 FOR COMPONENT AND TRACE KEEP-OUTS  
 SCALE 4:1

THIS DRAWING IS A CONTROLLED DOCUMENT.		DWN: KINSEN SUN 05MAR2012	TE Connectivity
DIMENSIONS: mm		CHK: DENNY ZHU 05MAR2012	
TOLERANCES UNLESS OTHERWISE SPECIFIED:		APVD: AILEY CAI 05MAR2012	NAME: 1X4 CAGE ASSEMBLY, THRU BEZEL, W/ ELASTOMERIC GASKET, QSFP
0 PLC	±0.10	PRODUCT SPEC	108-2286
2 PLC	±0.05	APPLICATION SPEC	114-13217
3 PLC	±	WEIGHT	
4 PLC	±	CUSTOMER DRAWING	SCALE 2:1 SHEET 4 OF 4 REV A
ANGLES	±		
FINISH			

## X-ON Electronics

Largest Supplier of Electrical and Electronic Components

*Click to view similar products for [I/O Connectors](#) category:*

*Click to view products by [TE Connectivity](#) manufacturer:*

Other Similar products are found below :

[571763P](#) [72.250.1628.2](#) [72.250.2428.2](#) [74720-0505](#) [76.350.0729.0](#) [76871-1403](#) [FCN-244F080-G/1](#) [FCN-260A9920](#) [MP-5T180MUNNA-005](#)  
[PCR-E36PM](#) [PCS-XE26MA+](#) [G38A71314B](#) [1571250010](#) [157-22500-3](#) [MS3471L14-19P L/C](#) [91-569786-35H](#) [172501-4002](#) [172501-6002](#)  
[FCN-260C008-A/L0](#) [FCN-260C024-AL0](#) [FCN-261Z008](#) [2000314-1](#) [200331-1](#) [PCR-E36FC+](#) [PCS-E28FS+](#) [PCS-XE26SLFD+](#) [PCS-](#)  
[XE26SLFDT+](#) [G730VID08BDC24](#) [HDMR-29-01-S-SM-TR](#) [U90B2054081210](#) [UE86K842720321](#) [38113800006](#) [DP3AR020WQ1R200](#)  
[Z4.102.0680.0](#) [500-1040](#) [500-1052](#) [500-1054](#) [ZP-4008-66L](#) [0709821002](#) [10-565995-597N](#) [DX40-20P\(55\)](#) [5554841-1](#) [U90B3054061110](#)  
[U65-E04-4020](#) [ZPF00000000097891](#) [557-262M2-06C](#) [747360449](#) [10099439-003C-TRLF](#) [10137239-0021LF](#) [E9320-001-01](#)