

THIS DRAWING IS UNPUBLISHED.

RELEASED FOR PUBLICATION

12JUN2012

© COPYRIGHT 2012 BY Tyco Electronics Japan G.K. ALL RIGHTS RESERVED.

LOC J DIST -

REVISIONS

P	LTR	DESCRIPTION	DATE	DWN	APVD
A		RELEASED	06DEC2013	T.S	N.Y
B		ADD ITEM	18NOV2014	T.S	N.Y
BI		NEW PN 9--2 ADDED	09NOV2020	SS	JDB

- 1. -1 : TYPE I , INSULATION DIAMETER 1.05-1.15mm
- 1- -1 : TYPE II, INSULATION DIAMETER 1.05-1.15mm
- 2 : TYPE I , INSULATION DIAMETER 0.93-1.05mm
- 1- -2 : TYPE II, INSULATION DIAMETER 0.93-1.05mm
- 3 : TYPE I , INSULATION DIAMETER 0.93-1.05mm IPC, 1.05-1.15mm IPC
- 4 : TYPE I , INSULATION DIAMETER 1.1-1.2mm

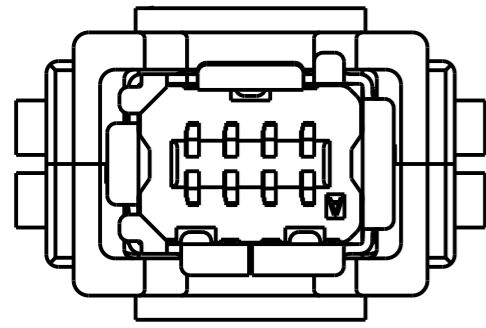
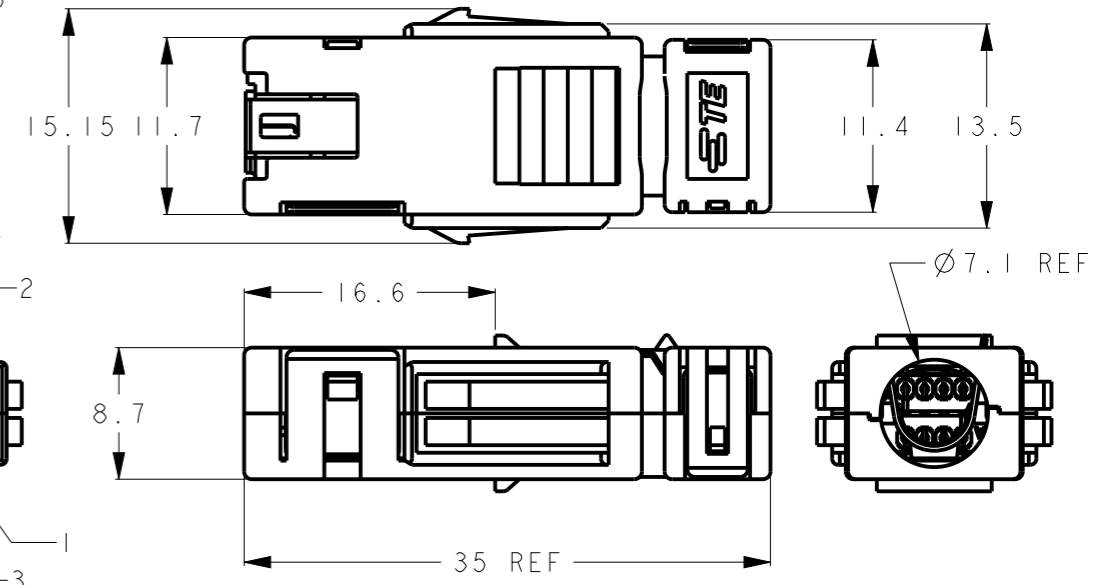
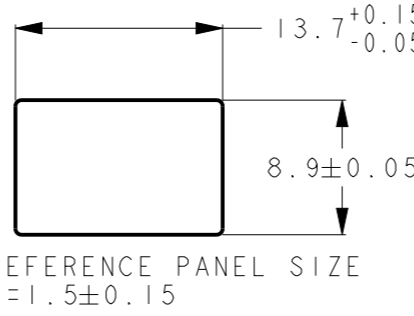

MATING SHAPE : TYPE I  
2201864-1/-2-3  
SCALE 4:1

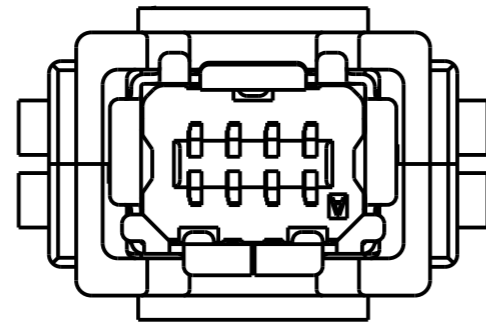

MATING SHAPE : TYPE II  
1-2201864-1/-2  
SCALE 4:1

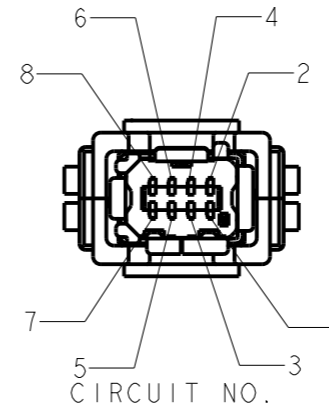

CIRCUIT NO.

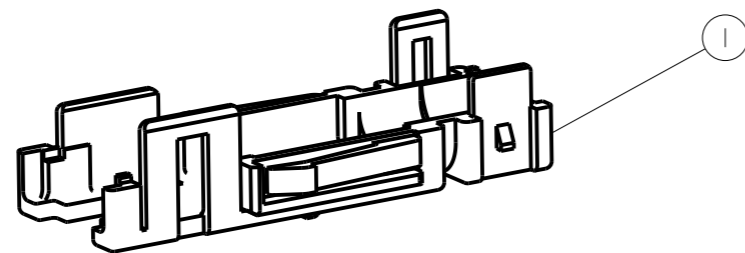
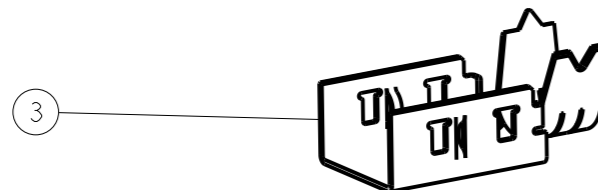
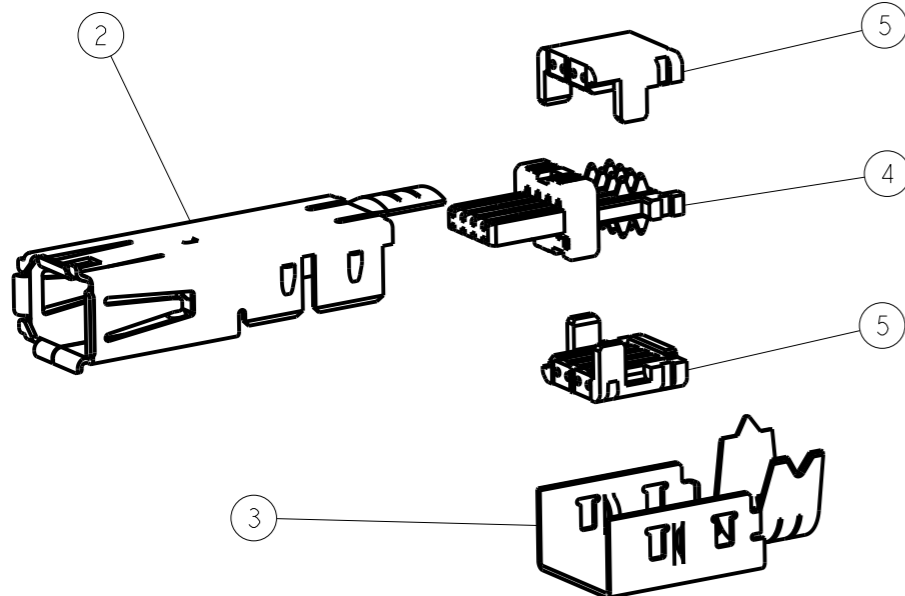
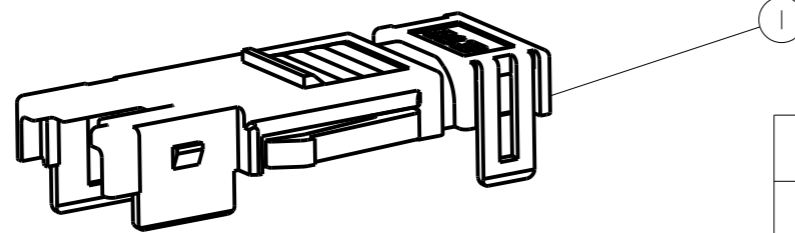

	2	-	-	-	-	-			
	2	-	1	2	2	-	THERMO PLASTIC	CABLE HSG Ø1.1-1.2 COLOR : GREEN	5
	-	-	1	-	-	2		CABLE HSG Ø0.93-1.05 COLOR : RED	
	-	-	-	-	-	2		CABLE HSG Ø1.05-1.15 COLOR : BLUE	
	1	1	1	1	1	1	HSG MATERIAL:THERMO PLASTIC	REC SUB ASSY	4
	1	1	1	1	1	1	CONTACT MATERIAL:COPPER ALLOY FINISH:Ni PLATING ALL OVER CONTACT AREA Au PLATING TERMINATION AREA Au PLATING	BOTTOM SHELL	3
	-	-	-	1	-	1	MATERIAL:COPPER ALLOY FINISH:NICKEL PLATING	REC TOP SHELL TYPE II	2
	1	1	1	-	1	-	MATERIAL:COPPER ALLOY FINISH:NICKEL PLATING	REC TOP SHELL TYPE I	
	2	2	2	2	2	2	THERMO PLASTIC	REC COVER HSG	1
	9--2	-4	-3	1--2	-2	1--1	MATERIAL/FINISH	PART NAME	ITEM

THIS DRAWING IS A CONTROLLED DOCUMENT.

DIMENSIONS: mm	TOLERANCES UNLESS OTHERWISE SPECIFIED: ± 0.5
Ø PLC	±
1 PLC	±0.5
2 PLC	±0.13
3 PLC	±0.013
4 PLC	±0.0001
ANGLES	±
MATERIAL	FINISH

DWN	06DEC2013
T. SHIMOYASU	
CHK	06DEC2013
M. HARASAWA	
APVD	06DEC2013
N. YAMASAKI	
PRODUCT SPEC	108-78955
APPLICATION SPEC	114-5506
WEIGHT	-
CUSTOMER DRAWING	

**STE** TE Connectivity

INDUSTRIAL MINI I/O PIERCING  
REC CONNECTOR KIT

SIZE	CAGE CODE	DRAWING NO	RESTRICTED TO
A3	00779	C-2201864	
SCALE	SHEET	OF	REV
2.1	1	1	BI

## X-ON Electronics

Largest Supplier of Electrical and Electronic Components

*Click to view similar products for [Modular Connectors / Ethernet Connectors](#) category:*

*Click to view products by [TE Connectivity](#) manufacturer:*

Other Similar products are found below :

[8949-H88/06BLKA/SN](#) [74441-0010/BKN](#) [MP1010RX-1000](#) [MP44RX-1000](#) [PHJ-4P4C-1-V-4](#) [PHP-6P6C-5](#) [GAX-3-66](#) [GAX-8-62](#) [GDCX-PA-66-50](#) [GDCX-PN-64](#) [GDCX-PN-66](#) [GDCX-PN-66-50](#) [GDLX-A-66](#) [GDLX-N-66](#) [GDLX-S-66](#) [GDLX-S-88K](#) [GDTX-S-88-50](#) [GDX-PA-1010](#) [GLX-N-1010M-BLK](#) [GLX-S-88M-BLK](#) [GMX-N-1010](#) [GMX-S-1010](#) [GMX-S-66](#) [GMX-SMT4-N-88](#) [GPX-2-64](#) [GSGX-N-2-88](#) [GSGX-N-4-88](#) [GSX-NS2-88-3.05](#) [GSX-NS2-88-3.05-50](#) [GSX-NS-88-3.05-50](#) [PT-108A-8C-UL](#) [PT-J951-8C](#) [PTS-J531-8CS-50UL](#) [1-1775629-2](#) [A-2014-0-4](#) [GWLX-S-88-GR](#) [GWLX-S9-88-YG](#) [DC-1021-8-WH-6](#) [1300530003](#) [1324640-4](#) [RJ11FTVC2G](#) [RJ11FTVC2N](#) [RJFTVX2SA1G](#) [132764-001](#) [1413235](#) [MP88X-1000](#) [MPS88RX-5000](#) [E5288-S000K3-L](#) [E5908-15A242-L](#) [155302-001](#)