

THIS DRAWING IS UNPUBLISHED.
 VERTRAULICHE UNVERÖFFENTLICHTE ZEICHNUNG
 © COPYRIGHT 2013 Tyco Electronics Corporation
 RELEASED FOR PUBLICATION
 FREI FÜR VERÖFFENTLICHUNG
 2013
 ALL RIGHTS RESERVED.
 ALLE RECHTE VORBEHALTEN.

PROJECT NO.:
 PRJ-11-3789

| REVISIONS ÄNDERUNGEN | | | | | |
|-------------------------|-----|-----------------------------|-----------|-----|------|
| P | LTR | DESCRIPTION BESCHREIBUNG | DATE | DWN | APVD |
| | A1 | NEW DRAWING | 14MAR2014 | RS | GKT |
| | | | | | |
| | | | | | |

2208714-1

2208714-2

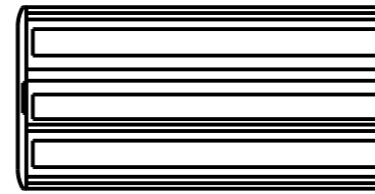
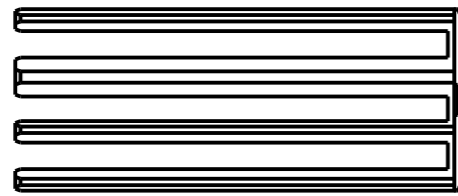

59.2±0.3

48.5±0.3

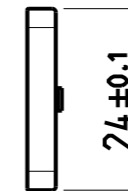
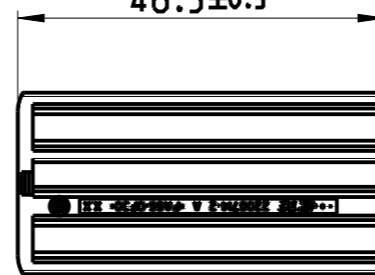
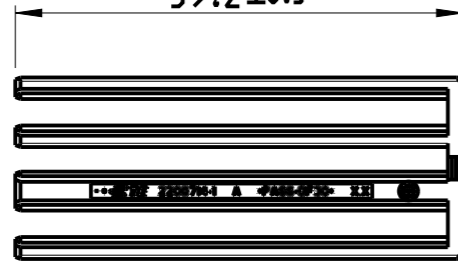
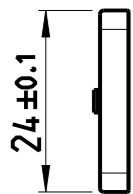

NOTES:

1. DELIVERY CONDITION - LOOSE PIECE

Bemerkungen:

1. Anlieferungszustand Teile - lose beigelegt

PRODUCT CHARACTERISTICS ACC. QMP EMEA_12
 BESONDERE MERKMALE NACH QMP EMEA_12

TOLERANCES UNLESS OTHERWISE SPECIFIED ACC. TO DIN 16901-140 @ CENTRIC TO NOMINAL DIMENSION. EDITION 1982-11 SHALL APPLY.
 Freimess toleranzen nach DIN 16901-140 @. Es gilt die Ausgabe 1982-11.

THIS DRAWING IS A CONTROLLED DOCUMENT.
 DIMENSIONING AND TOLERANCING PER GPS (ISO STANDARDS)

| | |
|-------------------------------------|-------------------------------------------------------------------|
| DIMENSIONS: MASSEINHEITEN: MM | TOLERANCES UNLESS OTHERWISE SPECIFIED: ALLOUEREINTOLERANZEN |
| | 0 PLC 1 PLC 2 PLC 3 PLC 4 PLC |
| | ANGLES/WINKEL ±1° |
| | FINISH/OBERFLÄCHE/FARBE |

| | | |
|--------------------|-----------|-----------|
| DWN | RAMESH S | 12SEP2013 |
| CHK | GOPI KT | 10OCT2013 |
| APVD | ZAYC M | - |
| PRODUCT SPEC | | |
| VERARBEITUNGSSPEZ. | | |
| WEIGHT | SEE TABLE | |
| GEWICHT | | |



NAME
 SECONDARY LOCK, 91 POS AND 105 POS
 1.2 CB CONTACT SYSTEM

| USED ON | PART NO. | MATERIAL | DESCRIPTION | WEIGHT (g) | COLOUR | ITEM NO. |
|-------------|-------------|-----------|---------------------------------|------------|--------|----------|
| X-2208709-X | 0-2208714-2 | PA66-GF30 | SECONDARY LOCK 91 POS. CON. | 1.40 | VOILET | 2 |
| X-2208720-X | 0-2208714-1 | PA66-GF30 | SECONDARY LOCK 105 POS. CON. | 1.70 | VOILET | 1 |

| | | | | | | | |
|------------------|------------------|-------------------|-------|------------------------------|---------------|--------------------------|----|
| SIZE | A3 | CAGE CODE | 00779 | DRAWING NO. ZEICHNUNG-NR. | C-2208714 | RESTRICTED TO NUR FÜR | - |
| CUSTOMER DRAWING | /KUNDENZEICHNUNG | SCALE MASSSTAB | 1:1 | SHEET BLATT | 1 OF VON 1 | REV | A1 |

X-ON Electronics

Largest Supplier of Electrical and Electronic Components

Click to view similar products for [RF Connector Accessories](#) category:

Click to view products by [TE Connectivity](#) manufacturer:

Other Similar products are found below :

[89674-0712](#) [FERRULE-174](#) [R125802000](#) [R141802000](#) [R141842000](#) [R141862000W](#) [R280752000](#) [R280907000](#) [RFI75-3](#) [RFI77-14](#)
[AX102907](#) [HP-500](#) [2098-3251-94](#) [KA-81-05](#) [89674-0805](#) [FERRULE-223](#) [202102-11](#) [213337-1](#) [R280468000](#) [R280510000](#) [RFI25-12-D3](#)
[RFI25-5](#) [RFI75-2-D2](#) [RFI77-6](#) [RFI97-14](#) [3550 04 K00](#) [360HS001M2508M6](#) [4-1532137-4](#) [HRM-514S\(40\)](#) [XC0600B-03P](#) [5-21085-0](#)
[111062-0490](#) [112122-SOD-LUG](#) [IPP-2014](#) [RFI95-14-D2](#) [LPTW2TP-124](#) [MX-913/U\(45\)](#) [1736-1511-075](#) [32Z112-000F](#) [000-78400](#) [78_Z-7-](#)
[3-4](#) [56Z112-000N](#) [RFI75-2-D3](#) [32Z111-000L5](#) [RG6WRO](#) [47140003A](#) [RFI75-2-D4](#) [RFI25-3-D3](#) [53919000B](#) [R280469010](#)