

THIS DRAWING IS UNPUBLISHED. RELEASED FOR PUBLICATION 20
 © COPYRIGHT 20 TYCO ELECTRONICS CORPORATION ALL RIGHTS RESERVED.

LOC	DIST	REVISIONS			
P	LTR	DESCRIPTION	DATE	DWN	APVD
1	-	A	AS PER ECR-14-002109	20FEB2014	RS DD

NOTES:

1 MATERIAL AND FINISH:

- HOUSING: THERMOPLASTIC
- PIN CONTACT: BRASS
- SOCKET CONTACT: COPPER ALLOY
- FINISH: TIN OVER NICKEL.
- WIRE: COPPER/TEFLON

2. TO ENSURE THE FUNCTION OF THE MINIATURE HERMAPHRODITIC W-B CONNECTORS, THE MINIATURE HERMAPHRODITIC W-B CONNECTOR SHOULD BE FIXED ON THE HEAT SINK OR SOME OTHER RIGID SUBSTRATE. CUSTOMER CAN USE TAPE, OR SOME OTHER METHOD TO FIX THE HEAT SINK.

3 STRIP AND RETAIN

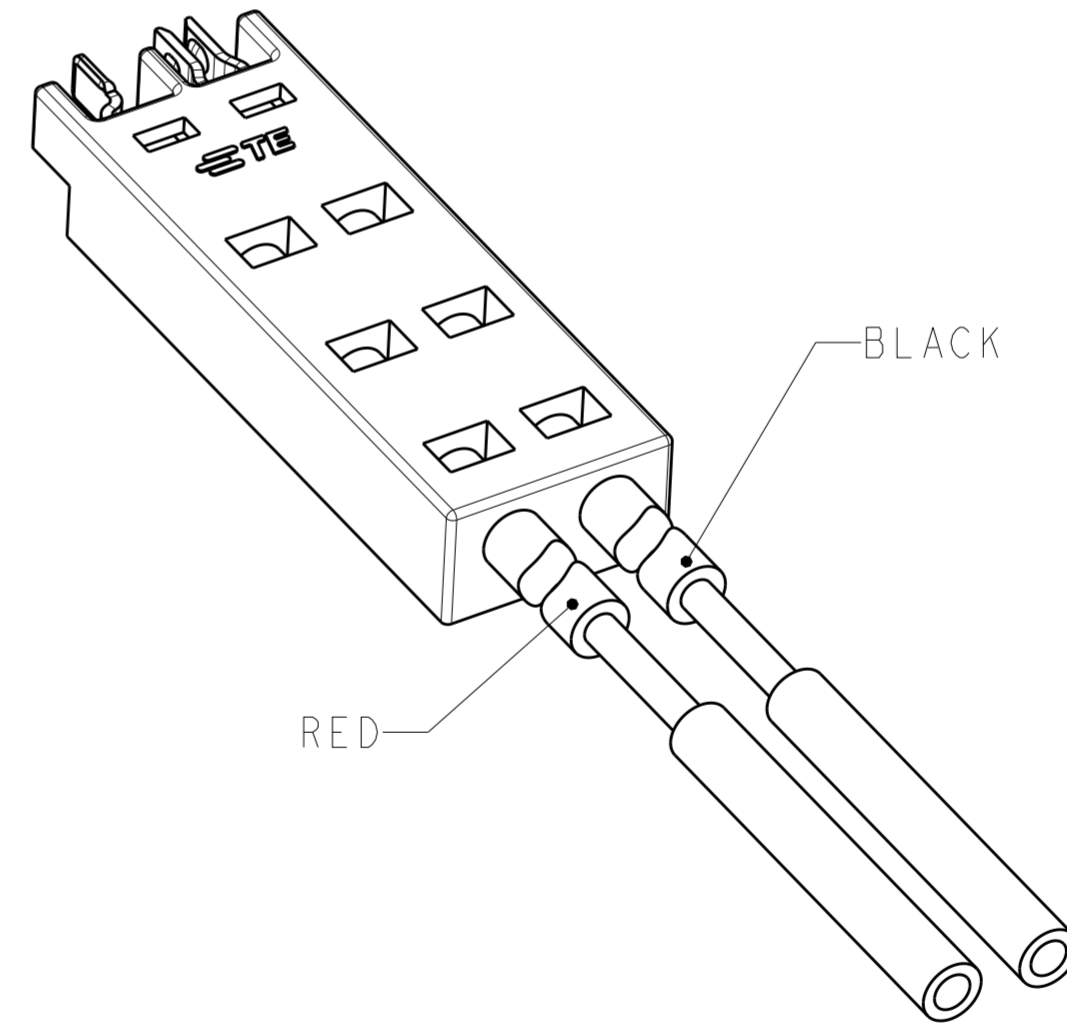
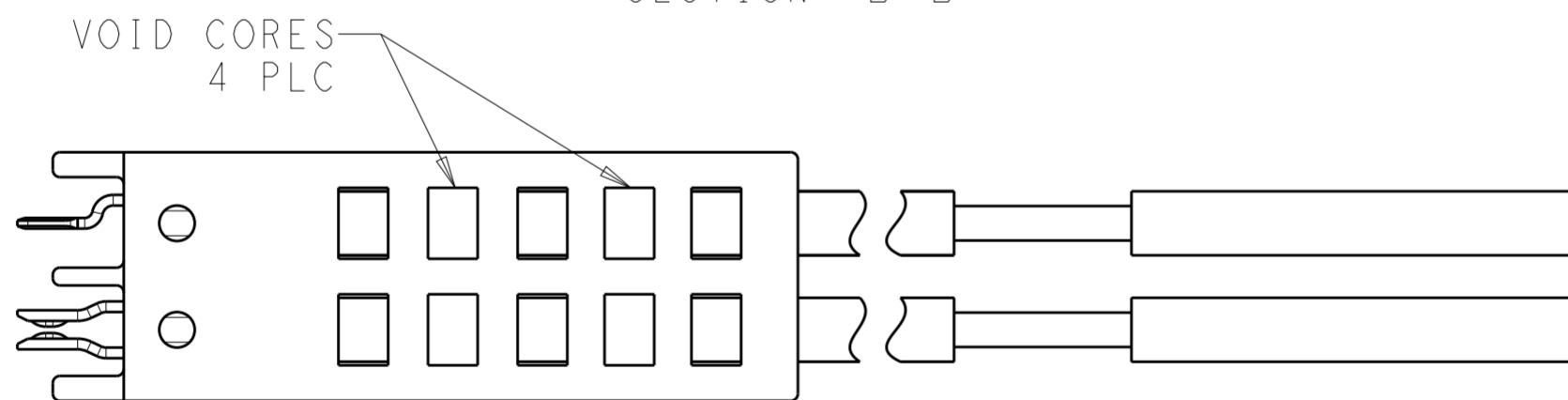
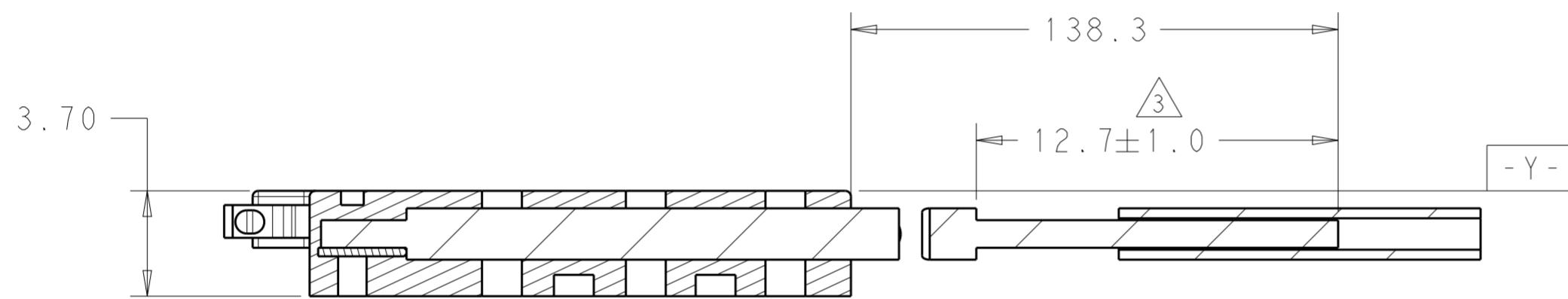
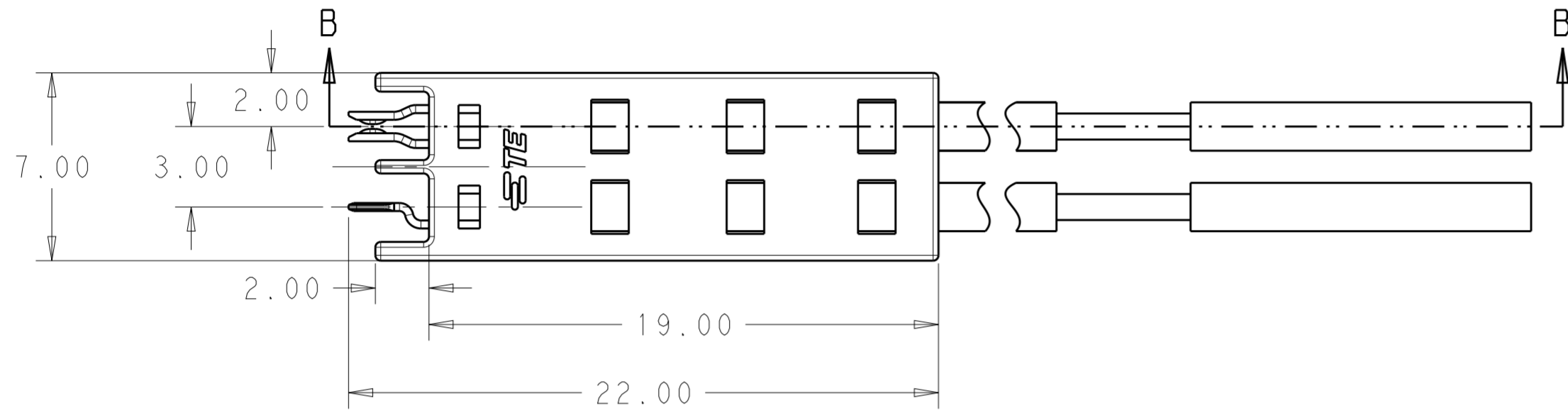

2213203-1
PART NO.

THIS DRAWING IS A CONTROLLED DOCUMENT.		DWN J. SHAFFER 09 JAN 2013	TE Connectivity	
DIMENSIONS: mm		CHK D. DECKER 09 JAN 2013		
TOLERANCES UNLESS OTHERWISE SPECIFIED:		APVD D. DECKER 09 JAN 2013	NAME INSERT MOLDING ASSEMBLY DRAWING OF MINIATURE HERMAPHRODITIC, 2 POSITION	
0 PLC ±- 1 PLC ±0.2 2 PLC ±0.13 3 PLC ±0.013 4 PLC ±0.0001 ANGLES ±- FINISH		PRODUCT SPEC -	SIZE A2	CAGE CODE 00779
MATERIAL		APPLICATION SPEC -	DRAWING NO. C-2213203	RESTRICTED TO -
1		WEIGHT -	SCALE 5 SHEET 1 OF 1 REV A	
		Customer Drawing		

X-ON Electronics

Largest Supplier of Electrical and Electronic Components

Click to view similar products for [Lighting Connectors](#) category:

Click to view products by [TE Connectivity](#) manufacturer:

Other Similar products are found below :

[293300-7](#) [293660-5](#) [CNX_H03_NTP](#) [30-9767-BU](#) [3605](#) [3-21030-1](#) [ZCH-110-RGB-I](#) [503471-0290](#) [ZCH-110-RGB-J](#) [217-0716-200](#)
[1954563-1](#) [1-293657-2](#) [2834036-1](#) [2834037-1](#) [1-2213222-4](#) [2-2213222-4](#) [2213222-4](#) [2834122-3](#) [2834122-5](#) [2834135-2](#) [FLA-R4142-30](#)
[FLA-R4162-30](#) [FLA-R2142-30](#) [FLA-R2141-30](#) [FLA-R2162-30](#) [FLA-R2161-30](#) [FLA-R0161-30](#) [FLA-R0141-30](#) [FLA-R0142-30](#) [FLA-](#)
[R0162-30](#) [FLA-C00-00](#) [DGA00010553](#) [CNXV04NTP](#) [104128-0610](#) [503485-0000 \(Cut Strip\)](#) [503485-0000 \(Loose Piece\)](#) [503485-0000](#)
[\(MINI Reel\)](#) [1-2834074-2](#) [1-2834074-3](#) [1357-AC PLUG W2C \(CHINA\)](#) [1357-AC PLUG W2 \(USA\)](#) [104266-0110](#) [2106212-1](#) [2-2834074-2](#)
[104266-0210](#) [293470-1](#) [293651-2](#) [293651-4](#) [1-2834006-2](#) [293651-1](#)