

NOTES:

1. MATERIALS AND FINISH
- HOUSING: LCP
- CONTACTS: COPPER ALLOY,
FINISH: TIN AND SELECT GOLD

2. PRODUCT TO COMPLY WITH
DIRECTIVE 2002/95/EC (ROHS)

3. PACKAGED IN TAPE AND REEL

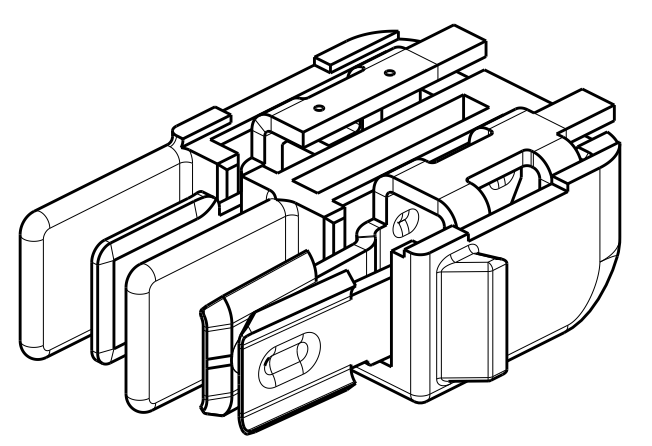
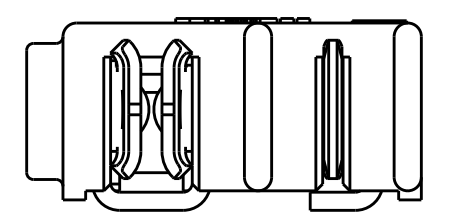
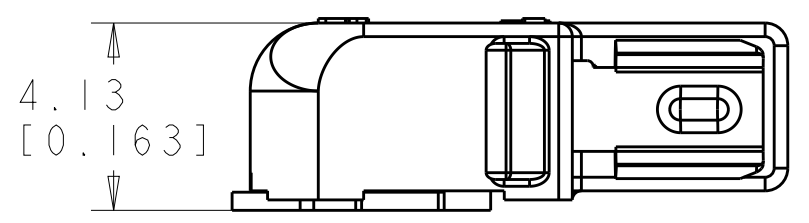
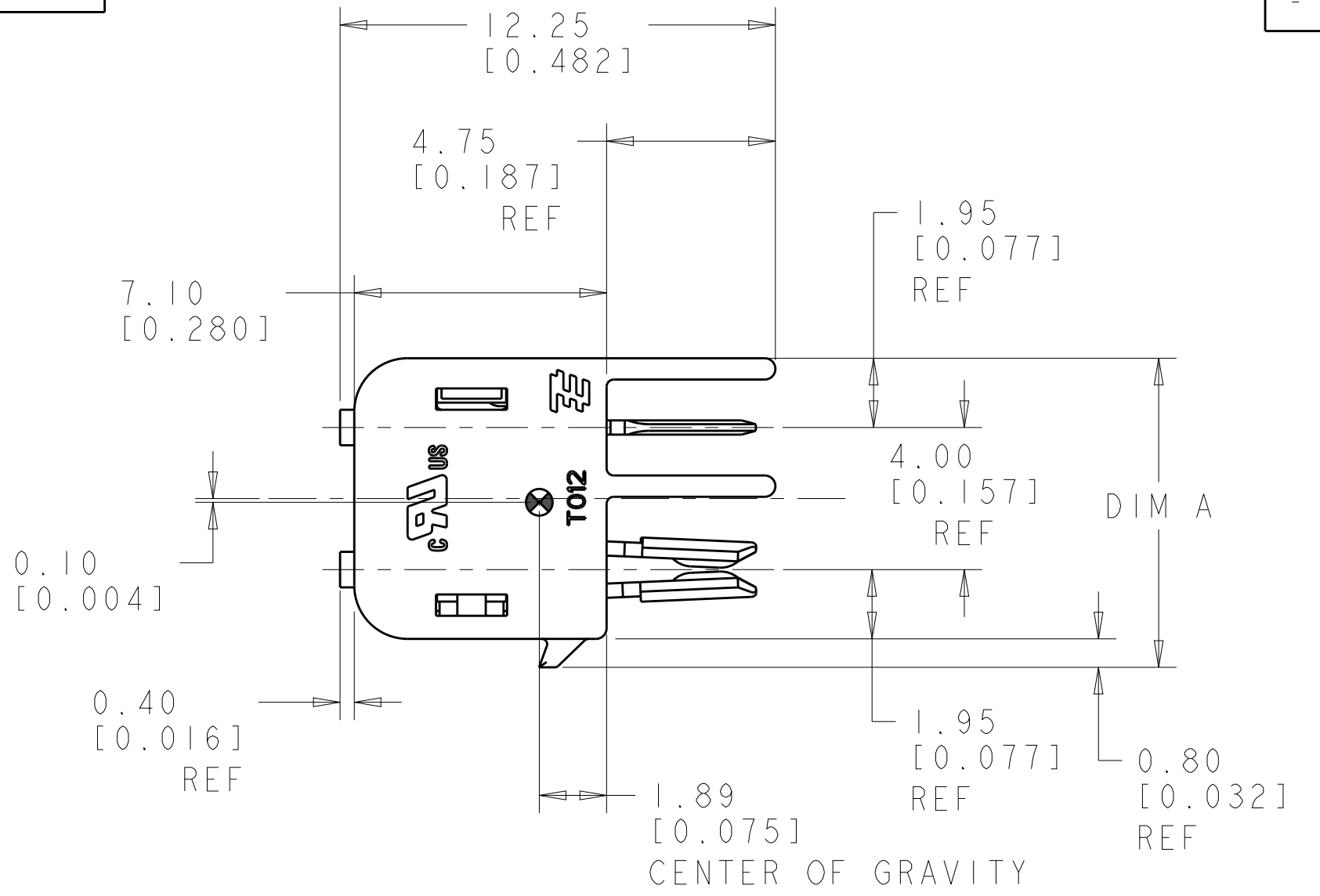

2213614-1/
1-2213614-1
SHOWN

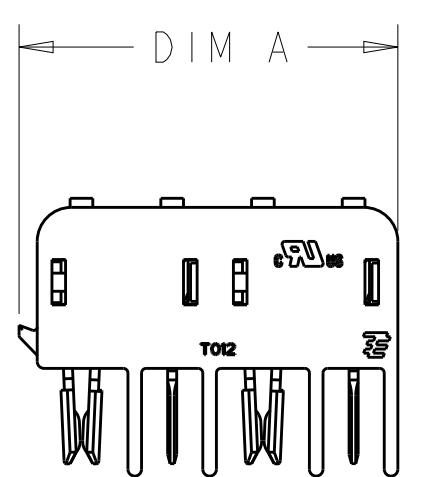
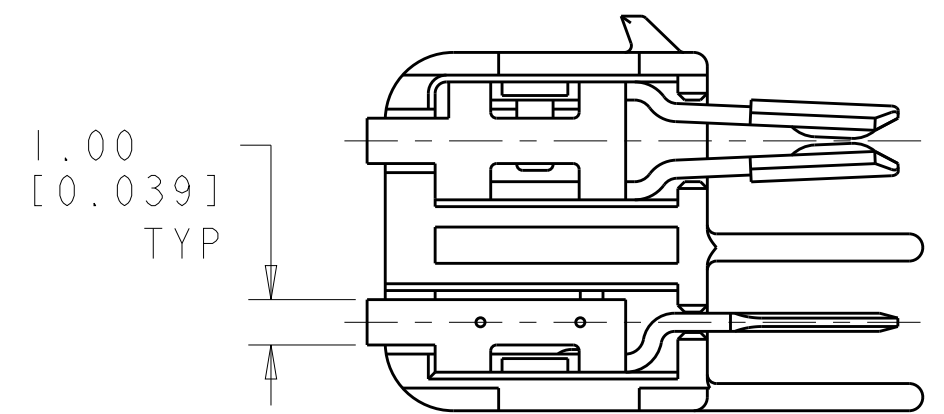

2213614-2/
1-2213614-2
SCALE 3:1

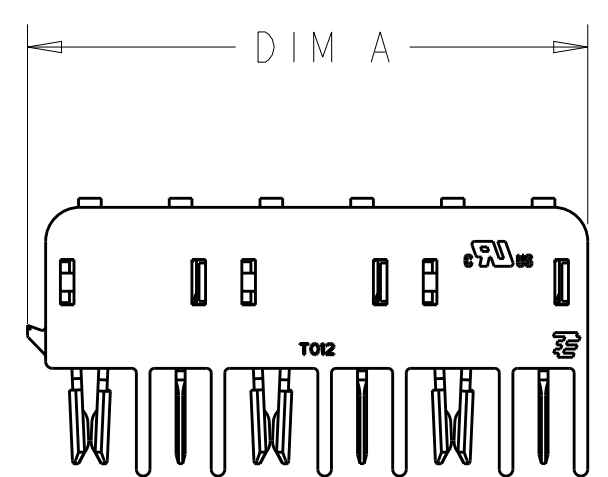

2213614-3/
1-2213614-3
SCALE 3:1

6	BLACK	24.70	1-2213614-3
4	BLACK	16.70	1-2213614-2
2	BLACK	8.70	1-2213614-1
6	NATURAL	24.70	2213614-3
4	NATURAL	16.70	2213614-2
2	NATURAL	8.70	2213614-1
POSITION		COLOR	DIM A
		DIM A	PART NO.

THIS DRAWING IS A CONTROLLED DOCUMENT.

DIMENSIONS:

mm

TOLERANCES UNLESS OTHERWISE SPECIFIED:

0 PLC ±

1 PLC ±0.13

2 PLC ±0.013

3 PLC ±

4 PLC ±1°

ANGLES

FINISH

MATERIAL

DWN RAVI.S 17JAN2015

CHK D.DECKER 17JAN2015

APVD D.DECKER 17JAN2015

PRODUCT SPEC 108-2342

APPLICATION SPEC 114-13225

WEIGHT -

CUSTOMER DRAWING

TE Connectivity

CONNECTOR ASSEMBLY, HERMAPHRODITIC BLADE AND RECEPTACLE, WITH LATCH

SIZE A200779

CAGE CODE C-2213614

DRAWING NO -

RESTRICTED TO -

SCALE 6:1

SHEET 1 OF 2

REV A1

LOC	DIST	REVISIONS					
		P	LTR	DESCRIPTION	DATE	DWN	APVD
			-	SEE SHEET 1	-	-	-

D

D

C

C

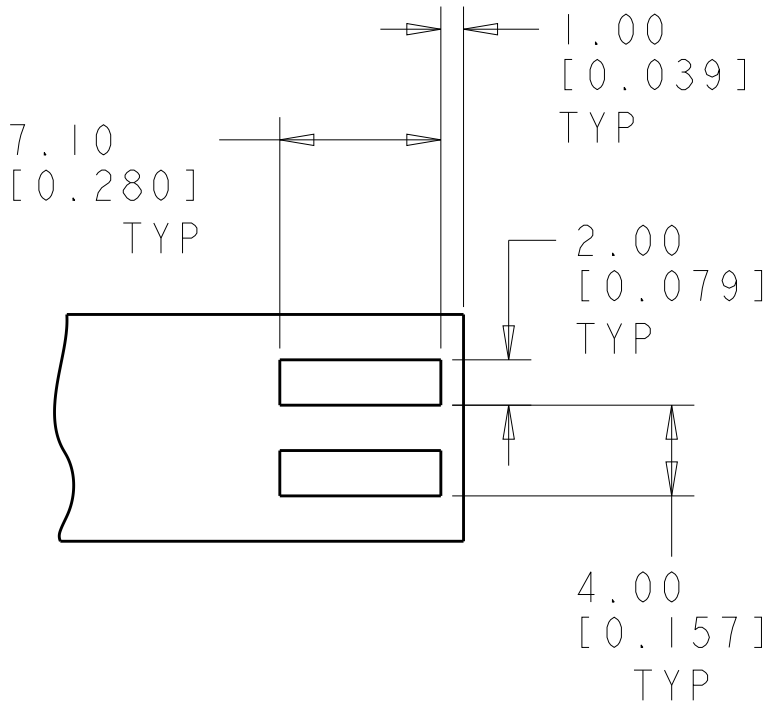

RECOMMENDED PCB LAYOUT
FOR 2213614-1 & 1-2213614-1

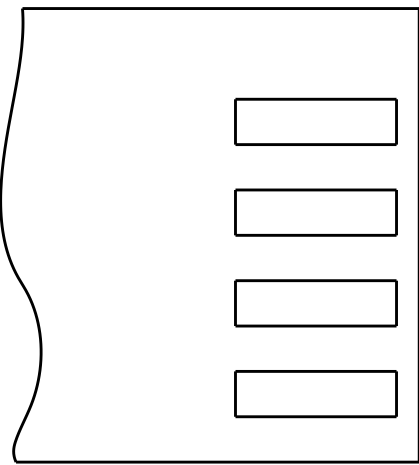

RECOMMENDED PCB LAYOUT
FOR 2213614-2 & 1-2213614-2

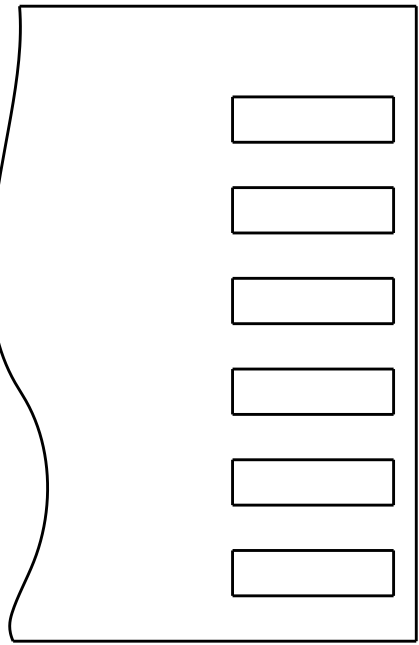

RECOMMENDED PCB LAYOUT
FOR 2213614-3 & 1-2213614-3

B

B

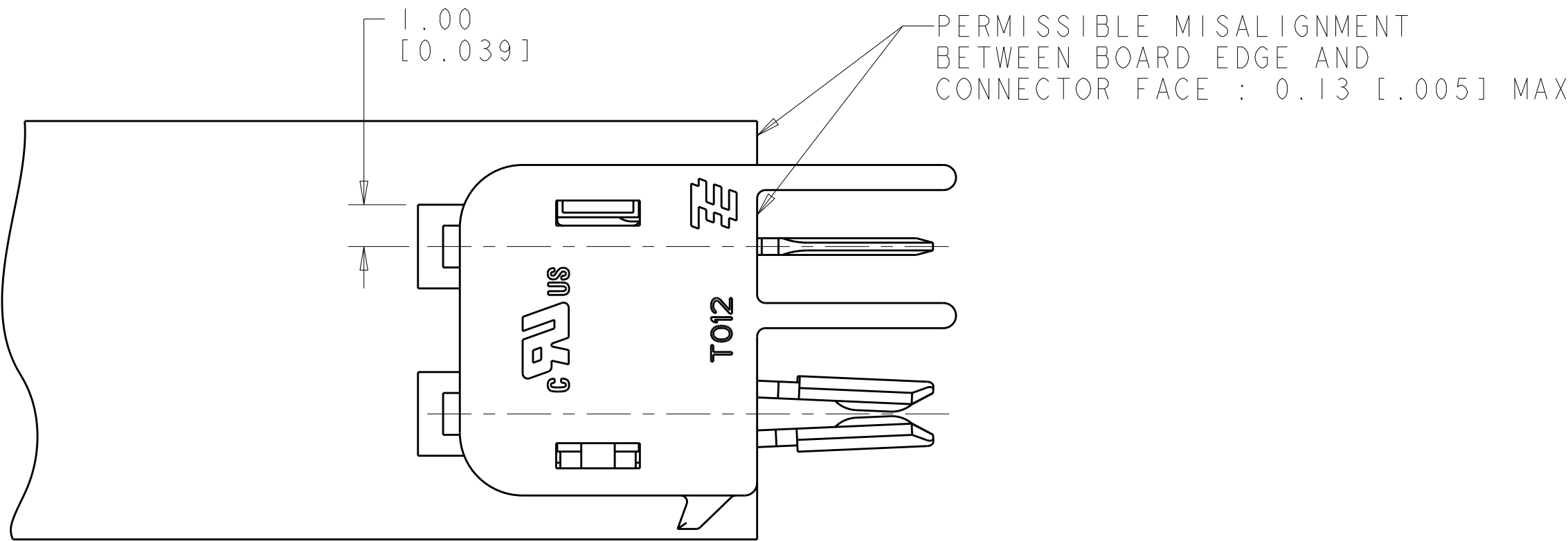

SCALE 8:1

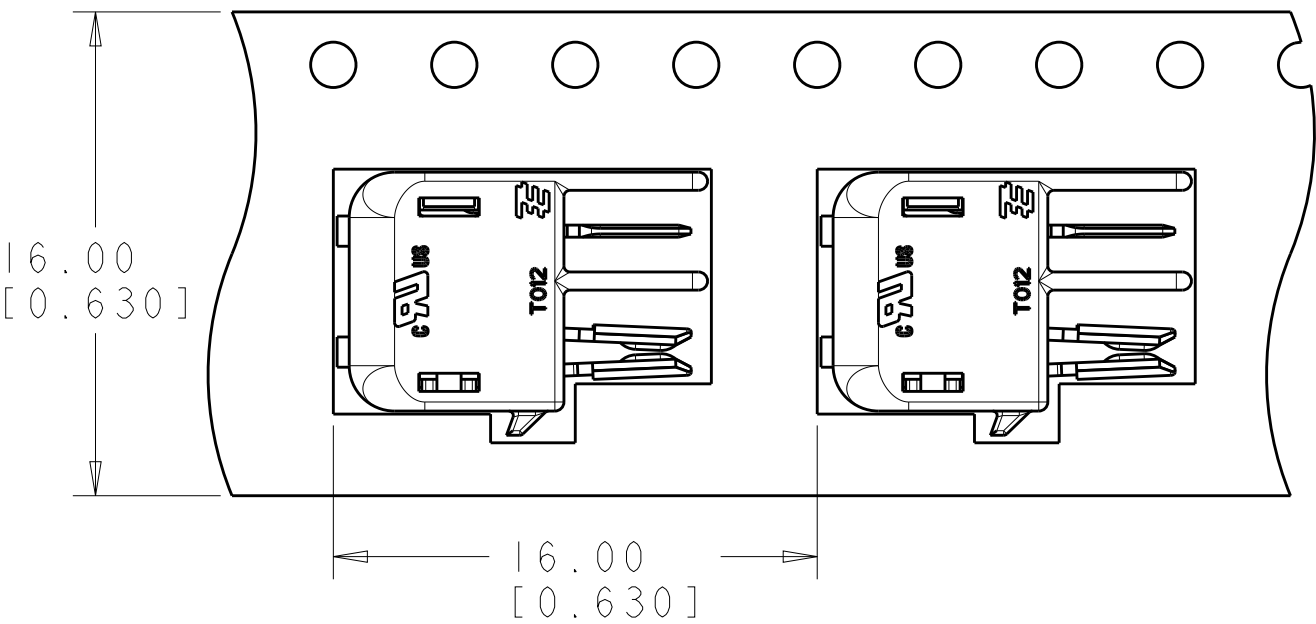

TO BE PACKAGED AS SHOWN
SCALE 4:1

A

A

THIS DRAWING IS A CONTROLLED DOCUMENT.		DWN RAVLS 17JAN2015	TE Connectivity			
		CHK D. DECKER 17JAN2015				
		APVD D. DECKER 17JAN2015	NAME CONNECTOR ASSEMBLY, HERMAPHRODITIC BLADE AND RECEPTACLE, WITH LATCH			
DIMENSIONS: mm		PRODUCT SPEC 108-2342	SIZE A200779	CAGE CODE C-2213614	DRAWING NO.	RESTRICTED TO
TOLERANCES UNLESS OTHERWISE SPECIFIED: 0 PLC ± 1 PLC ±0.13 2 PLC ±0.013 3 PLC ± 4 PLC ±1° ANGLES FINISH		APPLICATION SPEC 114-13225	WEIGHT -	SCALE 3:1	SHEET 2 OF 2	REV A1
MATERIAL		CUSTOMER DRAWING				

X-ON Electronics

Largest Supplier of Electrical and Electronic Components

Click to view similar products for [Lighting Connectors](#) category:

Click to view products by [TE Connectivity](#) manufacturer:

Other Similar products are found below :

[293300-7](#) [293660-5](#) [CNX_H03_NTP](#) [30-9767-BU](#) [3605](#) [3-21030-1](#) [ZCH-110-RGB-I](#) [503471-0290](#) [ZCH-110-RGB-J](#) [217-0716-200](#)
[1954563-1](#) [1-293657-2](#) [2834036-1](#) [2834037-1](#) [1-2213222-4](#) [2-2213222-4](#) [2213222-4](#) [2834122-3](#) [2834122-5](#) [2834135-2](#) [FLA-R4142-30](#)
[FLA-R4162-30](#) [FLA-R2142-30](#) [FLA-R2141-30](#) [FLA-R2162-30](#) [FLA-R2161-30](#) [FLA-R0161-30](#) [FLA-R0141-30](#) [FLA-R0142-30](#) [FLA-](#)
[R0162-30](#) [FLA-C00-00](#) [DGA00010553](#) [CNXV04NTP](#) [104128-0610](#) [503485-0000 \(Cut Strip\)](#) [503485-0000 \(Loose Piece\)](#) [503485-0000](#)
[\(MINI Reel\)](#) [1-2834074-2](#) [1-2834074-3](#) [1357-AC PLUG W2C \(CHINA\)](#) [1357-AC PLUG W2 \(USA\)](#) [104266-0110](#) [CNXV02NTP](#) [2106212-1](#)
[2-2834074-2](#) [104266-0210](#) [293470-1](#) [293651-2](#) [293651-4](#) [1-2834006-2](#)