

THIS DRAWING IS UNPUBLISHED. RELEASED FOR PUBLICATION, 19 .
 © COPYRIGHT 19 BY AMP INCORPORATED. ALL INTERNATIONAL RIGHTS RESERVED.

LOC	DIST	REVISIONS						
AJ	16	P	F	ZONE	LTR	DESCRIPTION	DATE	APPD
					F	OBSOLETE -9 PER OU20-0072-01	12APR01	MO

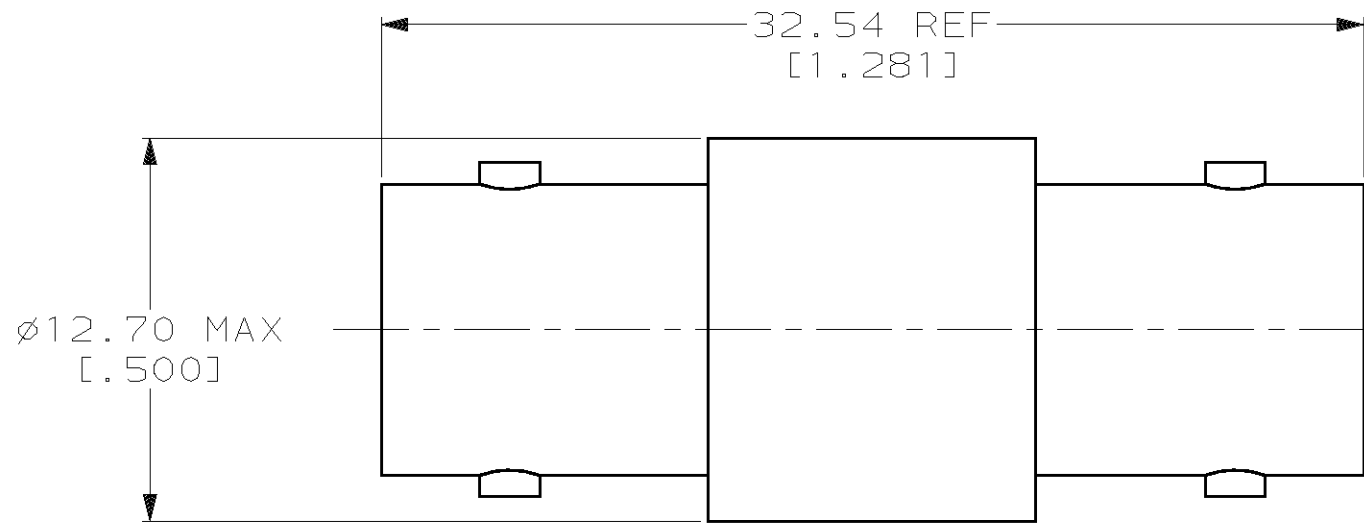

1. PART MAY BE INTER-MATED WITH PRODUCT PER MIL-C-39012
- 2 GOLD PLATING PER MIL-G-45204
- 3 NICKEL PLATING PER QQ-N-290
- 4 SILVER PLATING PER QQ-S-365
- 5 SEE SEPARATE RESTRICTED CUSTOMER DRAWING 221551-9

	OBSOLETE	2	3	1-221551-0
	OBSOLETE	5	-	221551-9
SUPERSEDED BY	221551-3	2	4	221551-4
		2	3	221551-3
SUPERSEDED BY	221551-1	4	4	221551-2
		4	3	221551-1
		CONTACT	SHELL	PART NUMBER
		FINISH		

DO NOT SCALE PRINT. UNLESS SPECIFIED DIMENSIONS IN mm [INCHES] TOLERANCES ON: 2 PLC DEC ± - 3 PLC DEC ± - ANGLES ± -		DR 5-10-91 M.E. COWHER	PART NO	
MATERIAL -	CHK 5-117-91 J.T. LIPPERT	APPD 5-24-91 M. PHILLIPS	AMP Incorporated Harrisburg, PA 17105-3608	
FINISH 2 3 4	APPD 6-5-91 M.E. COWHER	PRODUCT SPEC -	NAME ADAPTER, FEED THRU, JACK, SERIES BNC	
	APPLICATION SPEC -	WEIGHT -	SIZE B	CAGE CODE 00779
			DRAWING NO 221551	
			SCALE 4:1	SHEET 1 OF 1

X-ON Electronics

Largest Supplier of Electrical and Electronic Components

Click to view similar products for [RF Adapters - In Series](#) category:

Click to view products by [TE Connectivity](#) manufacturer:

Other Similar products are found below :

[5916-1103-603](#) [5918-1103-000](#) [5919-1503-000](#) [651A505](#) [82-5552](#) [9030-9523-502](#) [PN2C](#) [A0407000](#) [R114703000W](#) [R125704000](#)
[R125771001](#) [R141710000W](#) [R141723161](#) [R141730000](#) [R143730700](#) [R143770000](#) [R161703000W](#) [R161753000W](#) [R161791530W](#)
[R201705000](#) [R222705200](#) [R222M40010W](#) [R316754000](#) [R405006000](#) [R443162000](#) [AD78TL](#) [HRM-513S](#) [1996352-2](#) [2157155-1](#) [252169-75](#)
[AD158](#) [2101130-1](#) [252186](#) [R114704000W](#) [R114720000W](#) [R125705001](#) [R125705701](#) [R125771000](#) [R125771001W](#) [R125791501W](#)
[R127704001](#) [R127.870.001](#) [R127872001](#) [R141717000](#) [R142710000](#) [R142723000](#) [R143703000](#) [R143704000](#) [R143705700](#) [R161715000W](#)