

4

3

2

1

NOTES:

1. ALL DIMENSIONS ARE IN INCHES / LBS [MILLIMETERS] [GRAMS]

2. DIMENSIONS APPEARING IN TABLE ARE AS FOLLOWS: a AS SUPPLIED b AFTER UNRESTRICTED RECOVERY

COATING (ADHESIVE) IS OPTIONAL. AS SUPPLIED DIMENSIONS APPEARING IN TABLE ARE FOR UNCOATED PARTS. WHEN COATING IS ADDED, ENTRY DIAMETERS WILL BE REDUCED BY .06 MAX.

MOLDING PORTS ARE OPTIONAL. WHEN -00 MODIFICATION NUMBER IS SPECIFIED MOLDING PORTS WILL BE LOCATED AS SHOWN.

ON SIZES 222A111 AND 222A121 THE 0.18 INCH DIAMETER MOLDING PORT AT "T" WILL BE ELIMINATED. THE 0.12" DIA MOLDING PORT WILL BE ENLARGED TO 0.18 INCHES

5. WEIGHT SHOWN IN TABLE OF DIMENSIONS IS BASED ON POLYOLEFIN PART

6. ORDERING INFORMATION 222A1XX -XX -XX /XXX /0

BASE PART NUMBER MATERIAL DASH NUMBER -3 POLYOLEFIN, SEMI RIGID (RT-301) -4 POLYOLEFIN, FLEXIBLE (RT-1304) -5 ELASTOMER, FLEXIBLE (RT-501) -6 SILICONE (RT-602) -12 FLUORO ELASTOMER, FLEXIBLE (RT-1312) -25 ELASTOMER, FLUID RESISTANT (RW-2070) -100 POLYOLEFIN, SEMI-FLEXIBLE ZEROHAL (RT-1323) MODIFICATION NUMBER ADHESIVE SLASH NUMBER SEE COMPATIBILITY CHART BELOW COLOR DESIGNATOR

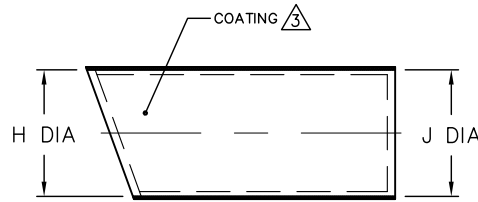

AS SUPPLIED

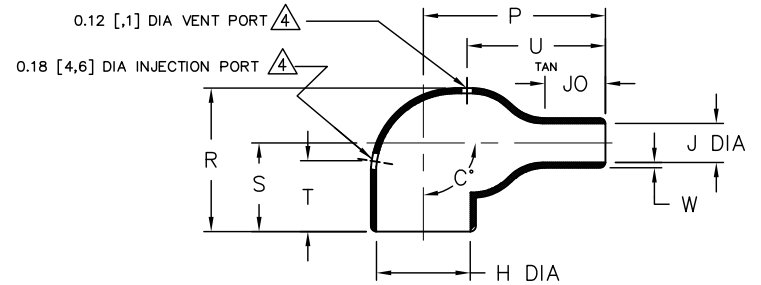

AFTER UNRESTRICTED RECOVERY

Table with 3 columns: LTR, DESCRIPTION, DATE. Row 1: V, REVISED PER ECO-15-010088, 07/01/15

TABLE OF DIMENSIONS

Table with columns: PART DESCRIPTION, H (MIN, MAX), J (MIN, MAX), P (±10%), R (±10%), S (±10%), T (±10%), U (±10%), JO (±10%), W (±20%), C* (±10%, ±5%), WEIGHT REF (b). Rows include parts 222A111, 222A121, 222A132, 222A142, 222A152, 222A163, 222A174, 222A185, 222A196.

IF THIS DOCUMENT IS PRINTED IT BECOMES UNCONTROLLED. CHECK FOR THE LATEST REVISION.

COMPATIBILITY CHART

Table with 3 columns: MATERIAL DASH NO., ADHESIVE (COATING) SLASH NO., ADHESIVE (COATING) S NO. Rows include dash numbers -3, -4, -5, -6, -12, -25, -100.

UNLESS OTHERWISE SPECIFIED DIMENSIONS ARE INCHES. METRIC DIMENSIONS ARE IN BRACKETS. DECIMAL TOLERANCES: .XXX ± 0.005 [0.13 mm], .XX ± 0.01 [0.25 mm], .X ± 0.1 [0.50 mm]. ANGLE TOLERANCE: .X ± 1 DEG.

DRAWN: YUNGUYEN, APPROVED: DHURRELL, THIRD ANGLE PROJECTION symbol.

CUSTOMER DRAWING header, TE Connectivity logo, Raychem Molded Parts address, TITLE: BOOT, 90 DEGREE, THIN WALL, SIZE B, CODE IDENT. NO. 06090, DWG. NO. 222A111thru196, DO NOT SCALE THIS DRAWING, SHEET 1 OF 1.

4

3

2

1

X-ON Electronics

Largest Supplier of Electrical and Electronic Components

Click to view similar products for [Heat Shrink Cable Boots & End Caps](#) category:

Click to view products by [TE Connectivity](#) manufacturer:

Other Similar products are found below :

[577159N001](#) [645494-000](#) [CX4132-000](#) [687025-000](#) [705331-000](#) [718446-000](#) [725666N001](#) [729257-000](#) [F27131-000](#) [F85868-000](#) [770-003S106W2](#) [770-013210W1](#) [770-013311](#) [770-013312](#) [806542N001](#) [807507-000](#) [808362-000](#) [808618-000](#) [809125-000](#) [809130-000](#) [809218-000](#) [812014-000](#) [812047-000](#) [813166-000](#) [813767N002](#) [814741-000](#) [819117N001](#) [823026-000](#) [823070-000](#) [825002-000](#) [841189N001](#) [861471-000](#) [866647-000](#) [879515-000](#) [937577-000](#) [957073-000](#) [982033-2](#) [A77813-000](#) [R280576000](#) [D96192-000](#) [163549-000](#) [EN3BOOTLKIT](#) [MTPSRBCL-C](#) [1954015-1](#) [200W531-3-0](#) [202A163-4-0-CS5067](#) [202A343-3-00-0](#) [202B221-13-0](#) [202B231-13-0](#) [202B563-25-07-0](#)