

4

3

2

1

NOTES:

1. ALL DIMENSIONS ARE IN INCHES / LBS [MILLIMETERS] [GRAMS]

2. DIMENSIONS APPEARING IN TABLE ARE AS FOLLOWS: a AS SUPPLIED b AFTER UNRESTRICTED RECOVERY

COATING (ADHESIVE) IS OPTIONAL. AS SUPPLIED DIMENSIONS APPEARING IN TABLE ARE FOR UNCOATED PARTS. WHEN COATING IS ADDED, ENTRY DIAMETERS WILL BE REDUCED BY .06 MAX.

MOLDING PORTS ARE OPTIONAL. WHEN -00 MODIFICATION NUMBER IS SPECIFIED MOLDING PORTS WILL BE LOCATED AS SHOWN.

ON SIZES 222A111 AND 222A121 THE 0.18 INCH DIAMETER MOLDING PORT AT "T" WILL BE ELIMINATED. THE 0.12" DIA MOLDING PORT WILL BE ENLARGED TO 0.18 INCHES

5. WEIGHT SHOWN IN TABLE OF DIMENSIONS IS BASED ON POLYOLEFIN PART

6. ORDERING INFORMATION 222A1XX -XX -XX /XXX /0

- BASE PART NUMBER
MATERIAL DASH NUMBER
-3 POLYOLEFIN, SEMI RIGID (RT-301)
-4 POLYOLEFIN, FLEXIBLE (RT-1304)
-5 ELASTOMER, FLEXIBLE (RT-501)
-6 SILICONE (RT-602)
-12 FLUORO ELASTOMER, FLEXIBLE (RT-1312)
-25 ELASTOMER, FLUID RESISTANT (RW-2070)
-100 POLYOLEFIN, SEMI-FLEXIBLE ZEROHAL (RT-1323)

MODIFICATION NUMBER
ADHESIVE SLASH NUMBER
SEE COMPATIBILITY CHART BELOW
COLOR DESIGNATOR

IF THIS DOCUMENT IS PRINTED IT BECOMES UNCONTROLLED. CHECK FOR THE LATEST REVISION.

COMPATIBILITY CHART

Table with 3 columns: MATERIAL DASH NO., ADHESIVE (COATING) SLASH NO., ADHESIVE (COATING) S NO.

REVISIONS table with columns: LTR, DESCRIPTION, DATE

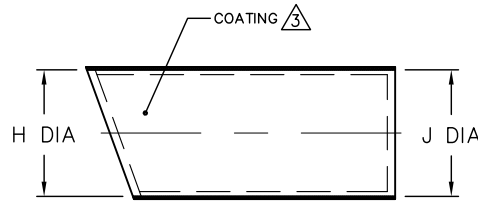

AS SUPPLIED

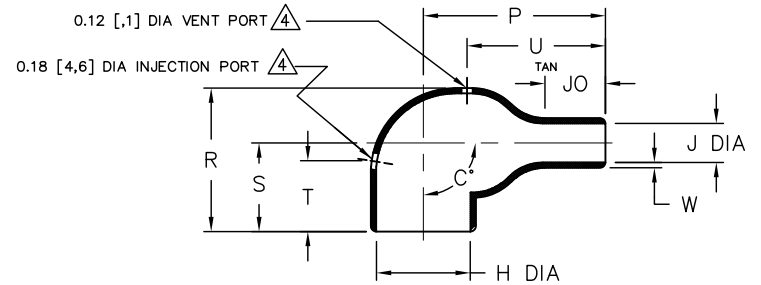

AFTER UNRESTRICTED RECOVERY

TABLE OF DIMENSIONS

Table with columns: PART DESCRIPTION, H (MIN, MAX), J (MIN, MAX), P, R, S, T, U, JO, W, C*, WEIGHT REF

CUSTOMER DRAWING

UNLESS OTHERWISE SPECIFIED DIMENSIONS ARE INCHES. METRIC DIMENSIONS ARE IN BRACKETS. DECIMAL TOLERANCES: .XXX ± 0.005, .XX ± 0.01, .X ± 0.1

DRAWN YUNGUYEN
APPROVED DHURRELL
THIRD ANGLE PROJECTION

TE Connectivity logo, Raychem Molded Parts address, TITLE: BOOT, 90 DEGREE, THIN WALL, SIZE B, CODE IDENT. NO. 06090, DWG. NO. 222A111thru196

D

C

B

A

D

C

B

A

X-ON Electronics

Largest Supplier of Electrical and Electronic Components

Click to view similar products for [Heat Shrink Cable Boots & End Caps](#) category:

Click to view products by [TE Connectivity](#) manufacturer:

Other Similar products are found below :

[577159N001](#) [645494-000](#) [CX4132-000](#) [687025-000](#) [705331-000](#) [718446-000](#) [725666N001](#) [729257-000](#) [F27131-000](#) [F85868-000](#) [770-003S106W2](#) [770-013210W1](#) [770-013311](#) [770-013312](#) [806542N001](#) [807507-000](#) [808362-000](#) [808618-000](#) [809125-000](#) [809130-000](#) [809218-000](#) [812014-000](#) [812047-000](#) [813166-000](#) [813767N002](#) [814741-000](#) [819117N001](#) [823026-000](#) [823070-000](#) [825002-000](#) [841189N001](#) [861471-000](#) [866647-000](#) [879515-000](#) [937577-000](#) [957073-000](#) [982033-2](#) [A77813-000](#) [R280576000](#) [D96192-000](#) [163549-000](#) [EN3BOOTLKIT](#) [MTPSRBCL-C](#) [1954015-1](#) [200W531-3-0](#) [202A163-4-0-CS5067](#) [202A343-3-00-0](#) [202B221-13-0](#) [202B231-13-0](#) [202B563-25-07-0](#)