

THIS DRAWING IS UNPUBLISHED.

RELEASED FOR PUBLICATION

REVISIONS

© COPYRIGHT - By -

ALL RIGHTS RESERVED.

P	LTR	DESCRIPTION	DATE	DWN	APVD
	F	ECR-18-000146	05JAN2018	RSM	KN

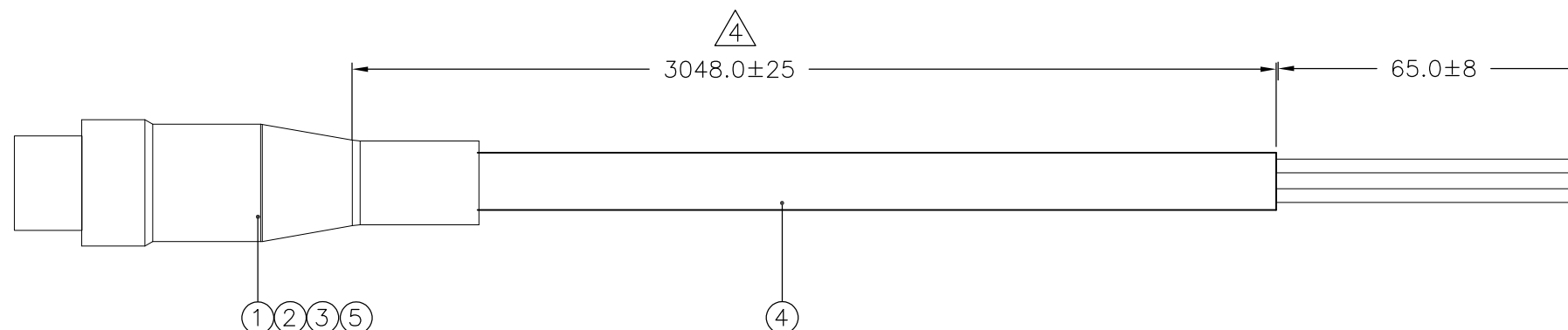
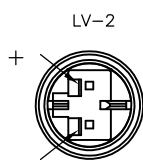

WIRING SCHEDULE  $\triangle 3$

SIDE	A	COLOR
+		WHT
-		BLK

NOTE:

- $\triangle 1$  PACKAGING: ACCORDING TO TE SPEC. 107-18032 BUNDLE EVERY 25 ASSEMBLIES WITH A RUBBER BANDS.
- 2. ELECTRICAL TEST CONTAINING "SHORT CIRCUIT TEST, CONTINUITY AND ACCURATE CAVITY ASSIGNMENT TEST" ACC. TO TE-SPEC.108-18857, SUB-SECTION 3.1.1
- $\triangle 3$  WIRING SCHEDULE AS SHOWN
- $\triangle 4$  LENGTH DIMENSIONS ARE MEASURED FROM THE BACK END OF THE CONNECTOR PRIOR TO BOOT INSTALLATION.

1	1013035	2231986-1
CUST REV	CUST P/N	TE P/N

U/M	QTY	DESCRIPTION	ITEM
PC	1	CABLE TIE, 5.90" LENGTH, NATURAL	6
PC	1	BOOT, IP65	5
MM	3060.7	CABLE, SVT, 2X18AWG, UL, WHITE	4
PC	2	MICRO QUADLOCK SYSTEM PIN CONTACT	3
PC	1	TUBE FOR SVT CABLE	2
PC	1	OUTLET, MINI HVL 7.5MM, LV-2	1

THIS DRAWING IS A CONTROLLED DOCUMENT.		DWN D. MCCLURE 24MAR14	<b>STE</b> TE Connectivity	
		CHK D. MCCLURE 24MAR14		
		APVD D. MCCLURE 24MAR14	NAME	
DIMENSIONS: mm		PRODUCT SPEC	CABLE ASSY, NECTOR S OUTLET TO PIGTAIL W/IP65 BOOT	
TOLERANCES UNLESS OTHERWISE SPECIFIED:		APPLICATION SPEC		
0 PLC ± -		WEIGHT	SIZE	RESTRICTED TO
1 PLC ±			CAGE CODE	
2 PLC ± -			DRAWING NO	
3 PLC ± -			A300779	
4 PLC ± -			C-2231986	
ANGLES ± -				
MATERIAL			SCALE	SHEET
FINISH			NTS	1 OF 2
		CUSTOMER DRAWING		REV
				F

THIS DRAWING IS UNPUBLISHED.

RELEASED FOR PUBLICATION

-. - .

REVISIONS

© COPYRIGHT - By -

ALL RIGHTS RESERVED.

P	LTR	DESCRIPTION	DATE	DWN	APVD
-	-	SEE SHEET 1	-	-	-

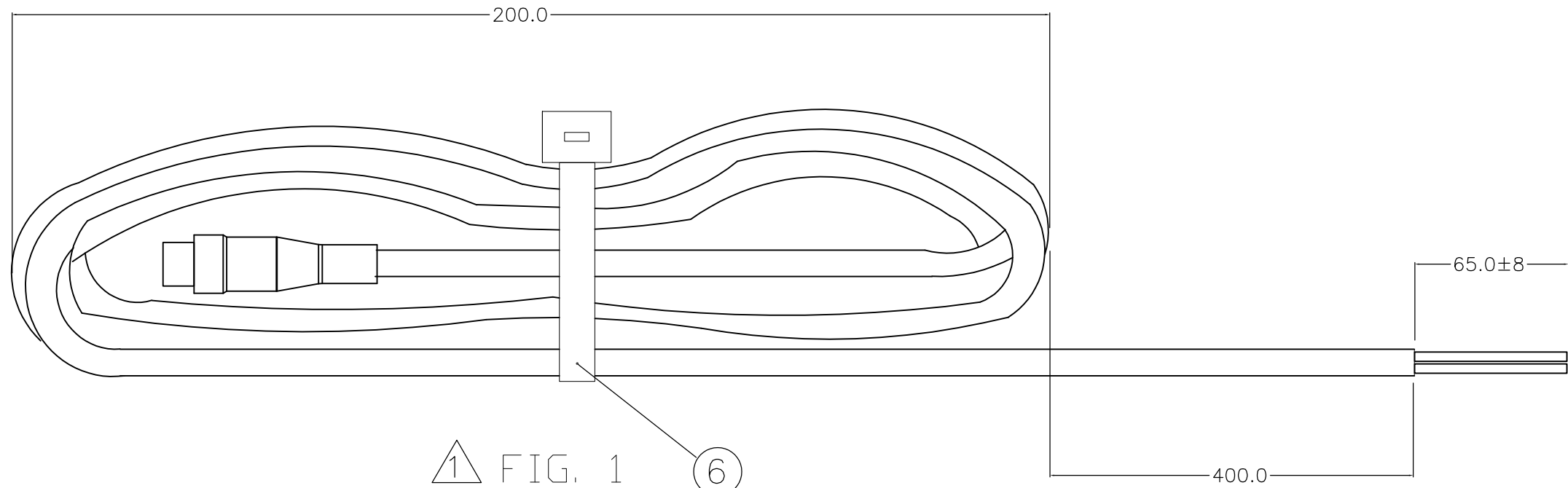

1 FIG. 1 6

THIS DRAWING IS A CONTROLLED DOCUMENT.

DWN D. MCCLURE 24MAR14

CHK D. MCCLURE 24MAR14

APVD D. MCCLURE 24MAR14

PRODUCT SPEC

APPLICATION SPEC

WEIGHT -

CUSTOMER DRAWING



NAME CABLE ASSY, NECTOR S OUTLET TO PIGTAIL W/IP65 BOOT

SIZE CAGE CODE DRAWING NO RESTRICTED TO

A3 00779 C-2231986 -

SCALE NTS SHEET 2 OF 2 REV F

DIMENSIONS: mm

TOLERANCES UNLESS OTHERWISE SPECIFIED:

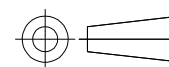

- 0 PLC ± -
- 1 PLC ± 15
- 2 PLC ± -
- 3 PLC ± -
- 4 PLC ± -
- ANGLES ± -

MATERIAL -

FINISH -

## X-ON Electronics

Largest Supplier of Electrical and Electronic Components

*Click to view similar products for [Lighting Cables](#) category:*

*Click to view products by [TE Connectivity](#) manufacturer:*

Other Similar products are found below :

[CL2-EXTEND](#) [96CB-E0605HAA1](#) [ZWF-915-J](#) [68801-4899](#) [68801-2112](#) [68801-2123](#) [68801-4124](#) [68801-4752](#) [68801-4850](#) [ZFS-CH144-12I](#) [96CB-E0405PCA3](#) [96CB-E0405PIC3](#) [96CB-E0605HAB1](#) [SSL11-J2LJ0-022A04](#) [CNXBE4218](#) [1-2058943-7](#) [1-2058943-8](#) [1-2083075-2](#) [1-2083080-1](#) [CNX310-120-X4124](#) [CNX\\_C\\_E\\_4\\_2\\_08](#) [CNXBE4118](#) [CNX\\_310\\_012\\_E\\_4\\_1\\_12](#) [2702306](#) [2702307](#) [SSL12-J4FJ0-000001](#) [180888-0405](#) [SSL12-J2LJ0-020F01](#) [180887-0430](#) [1705131](#) [180887-0410](#) [180778-0405](#) [1-2083029-8](#) [SSL12-J4LJ0-020H01](#) [180778-0430](#) [SSL12-P4LP0-M20H01](#) [SSL12-P4LP0-M20F01](#) [SSL12-P2LP0-M20F01](#) [SSL12-J4LJ0-020F01](#) [SSL11-J2LJ0-B22A04](#) [68801-4037](#) [68801-4039](#) [68801-4053](#) [68801-4055](#) [68801-4057](#) [68801-4059](#) [68801-4061](#) [960026](#) [2-2083030-2](#) [4767](#)