

DRAWING MADE IN THIRD ANGLE PROJECTION

THIS DRAWING IS UNPUBLISHED. RELEASED FOR PUBLICATION .19
 © COPYRIGHT 19 BY AMP INCORPORATED. ALL INTERNATIONAL RIGHTS RESERVED.

LOC	DIST	P	F	ZONE	LTR	DESCRIPTION	DATE	APPD
AJ	16							
		✓	✓		G	REDWN, REV & ADD 1--1, 1--2 & 1--3 PER AJ-4833	3-14-91	BAS
		✓	✓		H	REV PER AJ-5802	11-12-91	JL

- △1 GOLD PLATE PER MIL-G-45204
1.27µm [.000050] MINIMUM THICK
- △2 GOLD PLATE PER MIL-G-45204
2.54µm [.000100] MINIMUM THICK

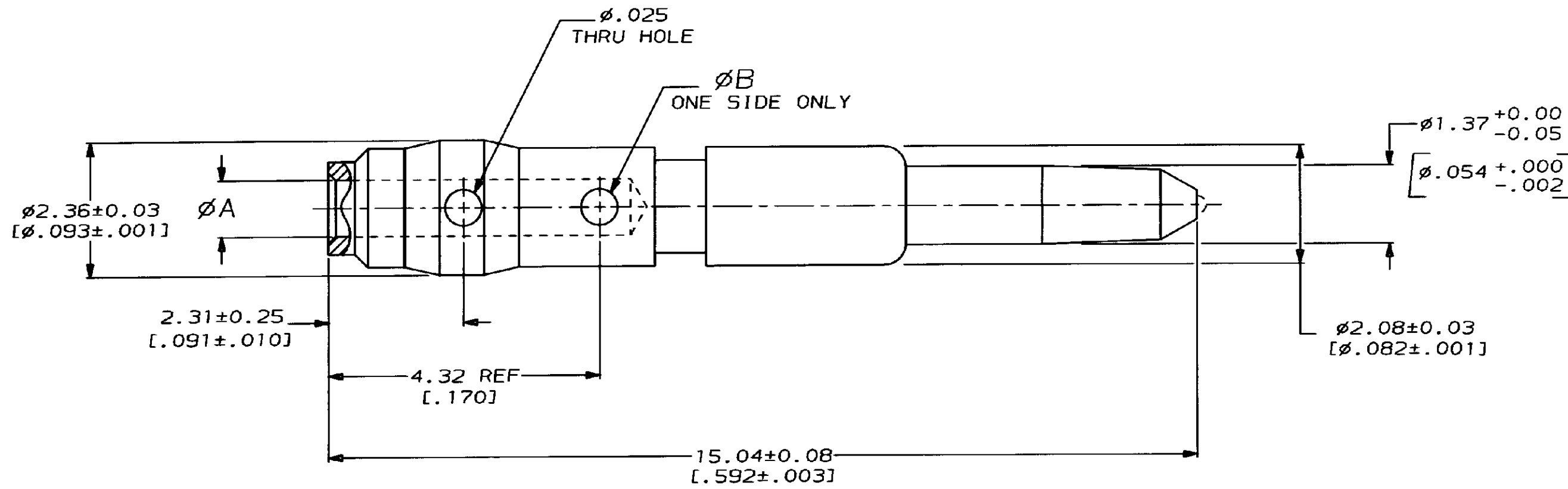

0.64 [.025]	1.07±0.03 [.042±.001]	△1	1-225467-3
0.64 [.025]	0.79±0.03 [.031±.001]	△2	1-225467-2
0.64 [.025]	0.99±0.03 [.039±.001]	△2	1-225467-1
0.38 [.015]	0.46±0.03 [.018±.001]	△1	1-225467-0
0.51 [.020]	0.66±0.03 [.026±.001]	△1	225467-8
0.64 [.025]	1.07±0.03 [.042±.001]	△1	225467-6
0.64 [.025]	0.79±0.03 [.031±.001]	△1	225467-4
0.64 [.025]	0.99±0.03 [.039±.001]	△1	225467-2
B	A	CONTACT PLATING	PART NUMBER

		PART NO	
DO NOT SCALE PRINT. UNLESS SPECIFIED DIMENSIONS IN mm [INCHES] TOLERANCES ON : 2 PLC DEC ± 0.20 [.008] 3 PLC DEC ± - ANGLES ± -	DR 3-14-91 B. SCOTT	AMP Incorporated Harrisburg, PA 17105-3608	
MATERIAL BRASS PER QQ-B-626	CHK 3-21-91 J. LIPPERT		
FINISH △1△2	APPD 4-5-91 M. PHILLIPS	NAME CONTACT, CENTER, DUAL CRIMP, SERIES TNC	
	APPD 4-5-91 J. LIPPERT	SIZE C	CAGE CODE 00779
	PRODUCT SPEC -	APPLICATION SPEC -	DRAWING NO 225467
	WEIGHT -	SCALE 15:1	SHEET 1 OF 1

225467

A

X-ON Electronics

Largest Supplier of Electrical and Electronic Components

Click to view similar products for [RF Connectors / Coaxial Connectors](#) category:

Click to view products by [TE Connectivity](#) manufacturer:

Other Similar products are found below :

[R125315120](#) [8915-1511-000](#) [89674-0827](#) [5916-1103-603](#) [0106-001-000](#) [6-0001-3](#) [6001-7071-019](#) [6002-7051-003](#) [6002-7551-202](#) [6059674-1](#) [619550-1](#) [630059-000](#) [M39012/25-0021](#) [M39012/79-3008](#) [M39030/3-01N](#) [M39030/3-03N](#) [M3933/25-29N](#) [M3933/25-36N](#) [6500-7071-046](#) [6501-1071-002](#) [M83723/72W24576](#) [M83723/72W2457N](#) [6769](#) [CX050L2AQ](#) [7002-1541-010](#) [7003-1572-002](#) [7004-1512-000](#) [7009-1511-004](#) [7010-1511-000](#) [7029-1511-060](#) [7101-1541-010](#) [7101-1571-002](#) [7105-1521-002](#) [7145-1521-002](#) [7209-1511-011](#) [7210-1511-012](#) [7210-1511-015](#) [7210-1511-019](#) [7210-1511-040](#) [7225-1512-050](#) [7242-1511-000](#) [73137-5015](#) [73216-2241](#) [73251-0111](#) [73251-0672](#) [73276-1501](#) [73366-0013](#) [73404-2300](#) [73413-6080](#) [734151610](#)