

REVISIONS

P	LTR	DESCRIPTION	DATE	DWN	APVD
	C9	HOUSING COLOR ADDED	030CT2019	RK	PS

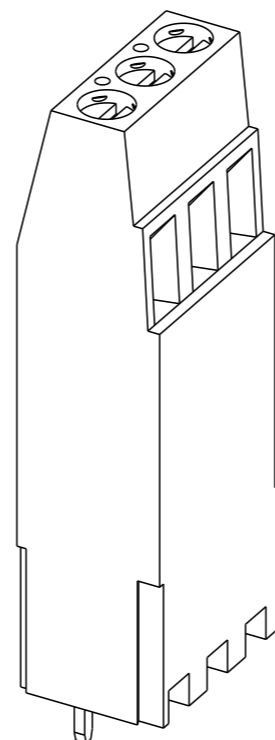

282925-3 AS SHOWN

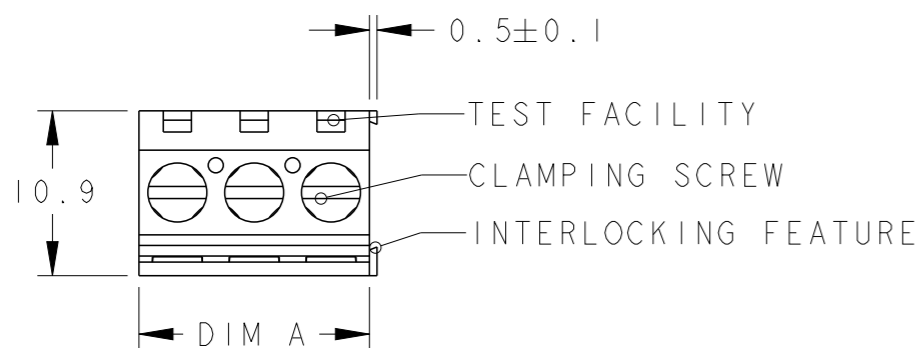
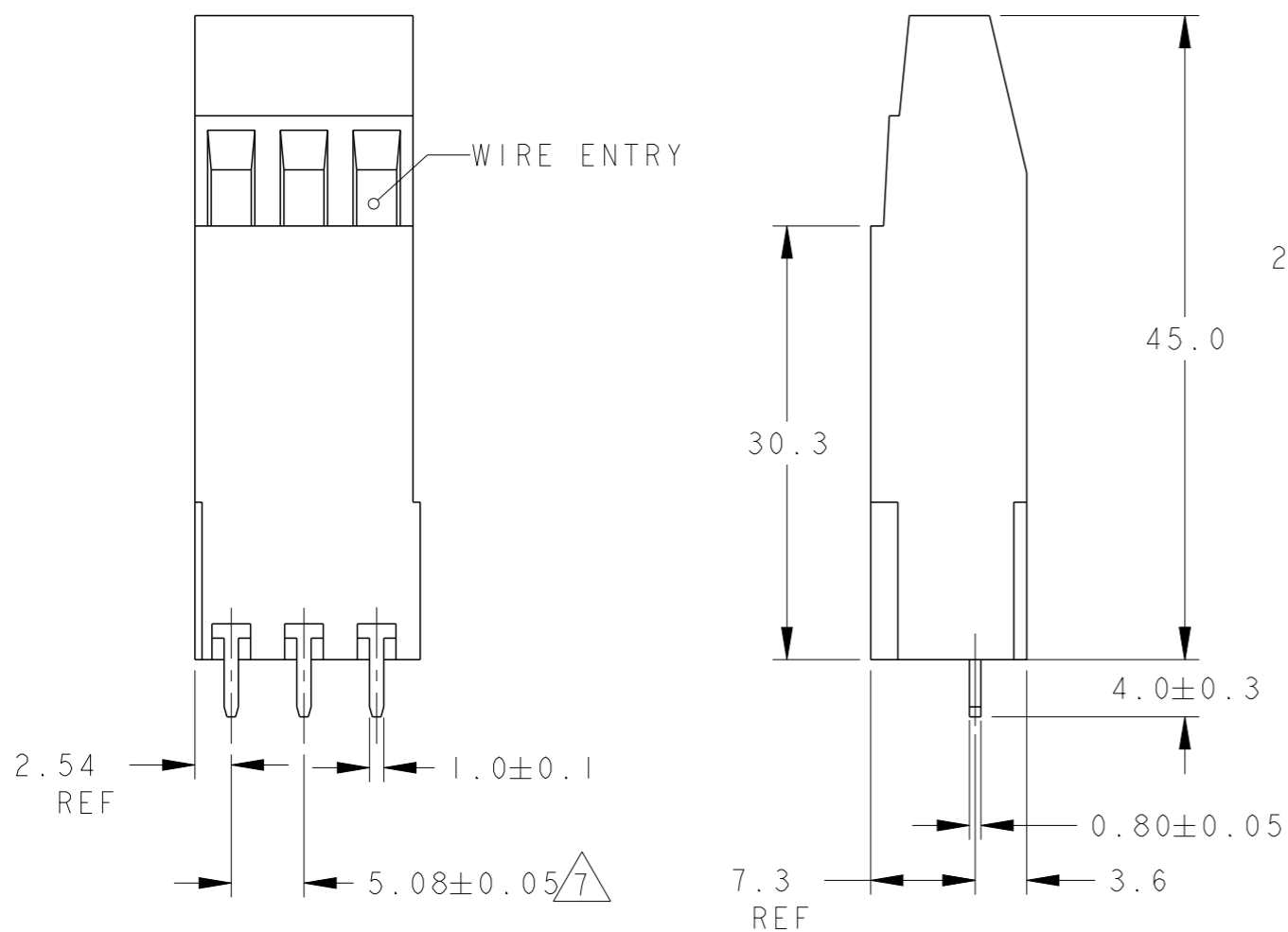

9	SEE DETAIL F	60.96	12	2-282925-3
9	SEE DETAIL E	76.20	15	2-282925-2
12/10/9	SEE DETAIL D	106.68	21	2-282925-1
12/10/9	SEE DETAIL C	76.20	15	1-282925-5
12/9	SEE DETAIL B	60.96	12	1-282925-2
8/7		828.04	163	1-282925-0
OBSOLETE		15.24	3	<del>282925-3</del>
		10.16	2	<del>282925-2</del>
	<b>DIM.A</b>		<b>NO OF POS.</b>	<b>PART NUMBER</b>

RECOMMENDED PC BOARD LAYOUT

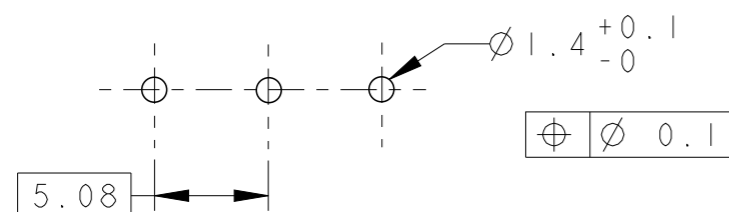

THIS DRAWING IS A CONTROLLED DOCUMENT.

DIMENSIONS:	TOLERANCES UNLESS OTHERWISE SPECIFIED:
mm	
0 PLC	±
1 PLC	±0.3
2 PLC	±0.25
3 PLC	±
4 PLC	±
ANGLES	±2°
MATERIAL	FINISH
SEE NOTES	SEE NOTES

DWN	09NOV2001
E. ZANOLINI	
CHK	09NOV2001
D. BIEVENOUR	
APVD	09NOV2001
D. BIEVENOUR	
PRODUCT SPEC	-
APPLICATION SPEC	-
WEIGHT	-
CUSTOMER DRAWING	

<b>STE</b> TE Connectivity			
NAME TERMINAL BLOCK, PCB MOUNT 3RD LEVEL, STACKING W/INTERLOCK, 5.08mm PITCH			
SIZE	CAGE CODE	DRAWING NO	RESTRICTED TO
A3	00779	C-282925	-
SCALE		SHEET	REV
2:1		1 OF 4	C9

THIS DRAWING IS UNPUBLISHED.

RELEASED FOR PUBLICATION

20

© COPYRIGHT 20 BY -

ALL RIGHTS RESERVED.

REVISIONS

P	LTR	DESCRIPTION	DATE	DWN	APVD
-		SEE SHEET 1	-	-	-

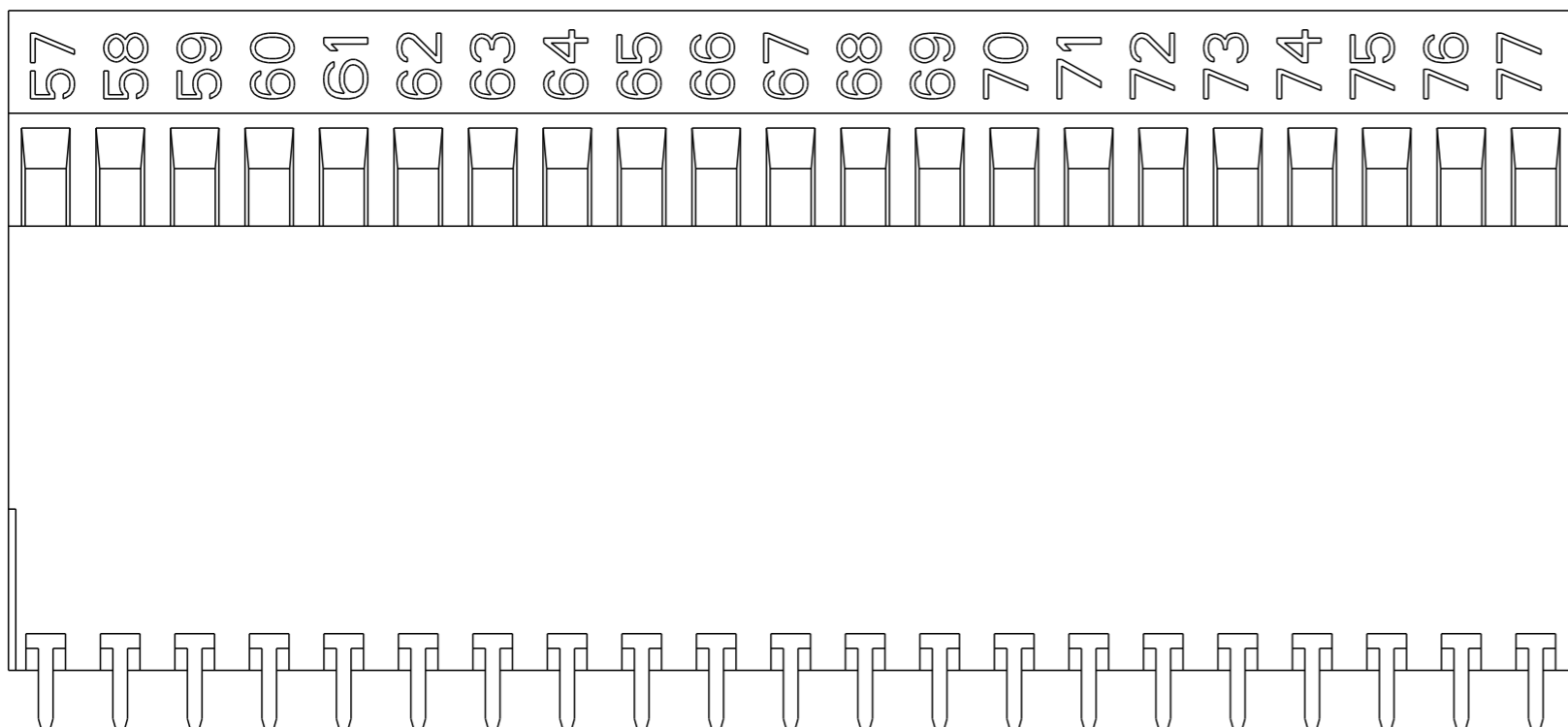

DETAIL D  
SCALE 2:1

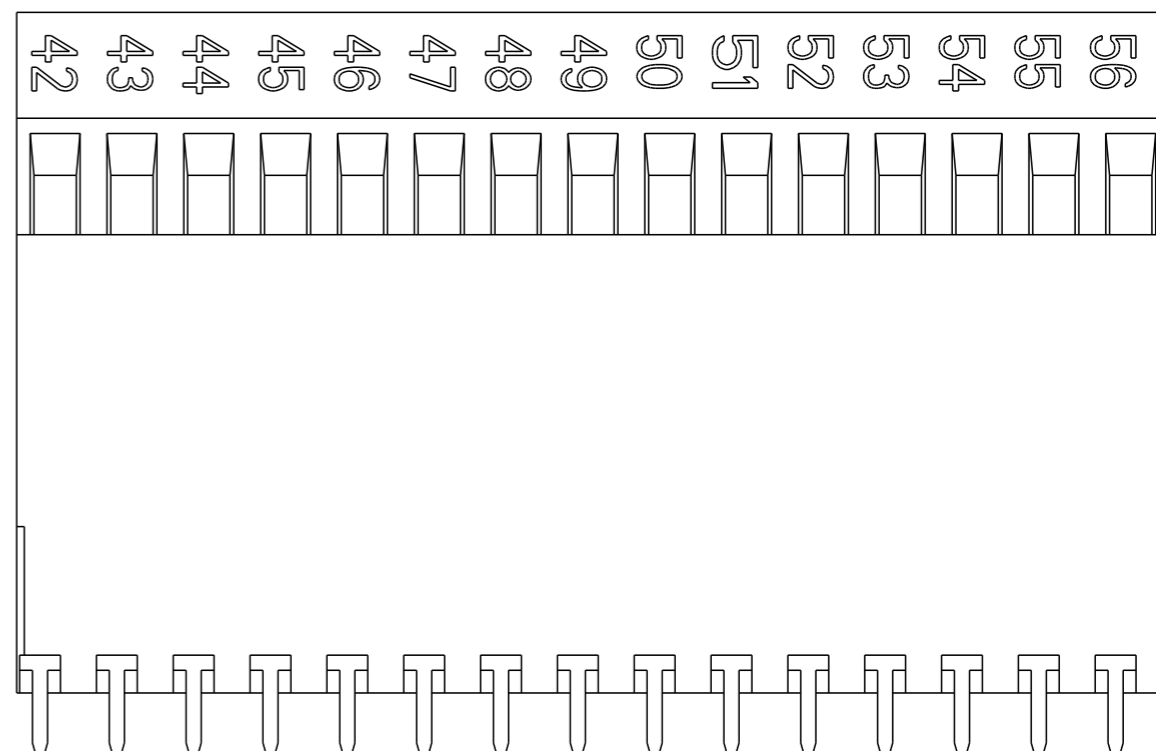

DETAIL C  
SCALE 2:1

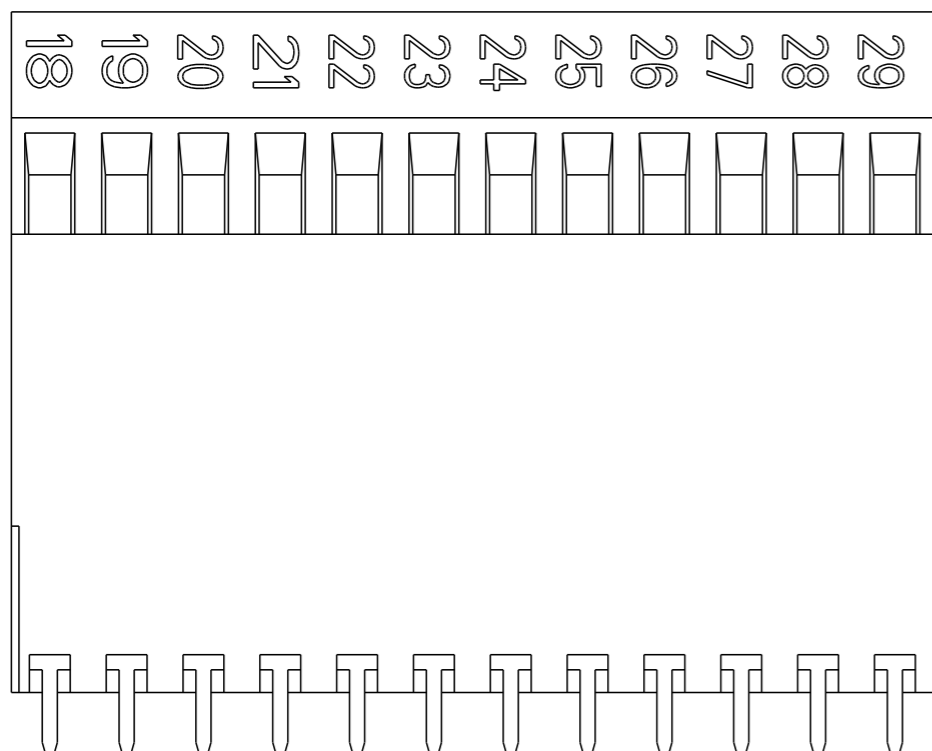

DETAIL B  
SCALE 2:1

THIS DRAWING IS A CONTROLLED DOCUMENT.

DIMENSIONS:  
mm

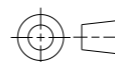

TOLERANCES UNLESS OTHERWISE SPECIFIED:

- 0 PLC ±0.3
- 1 PLC ±0.3
- 2 PLC ±0.25
- 3 PLC ±0.25
- 4 PLC ±0.25
- ANGLES ±2°

MATERIAL  
SEE NOTES

FINISH  
SEE NOTES

DWN 09NOV2001  
E. ZANOLINI

CHK 09NOV2001  
D. BIEVENOUR

APVD 09NOV2001  
D. BIEVENOUR

PRODUCT SPEC

APPLICATION SPEC

WEIGHT

CUSTOMER DRAWING



TE Connectivity

NAME  
TERMINAL BLOCK, PCB MOUNT  
3RD LEVEL, STACKING W/INTERLOCK,  
5.08mm PITCH

SIZE CAGE CODE DRAWING NO RESTRICTED TO

A300779 C-282925

SCALE 2:1 SHEET 2 OF 4 REV C9

THIS DRAWING IS UNPUBLISHED.

RELEASED FOR PUBLICATION

20

© COPYRIGHT 20 BY -

ALL RIGHTS RESERVED.

REVISIONS

P	LTR	DESCRIPTION	DATE	DWN	APVD
-	-	SEE SHEET 1	-	-	-

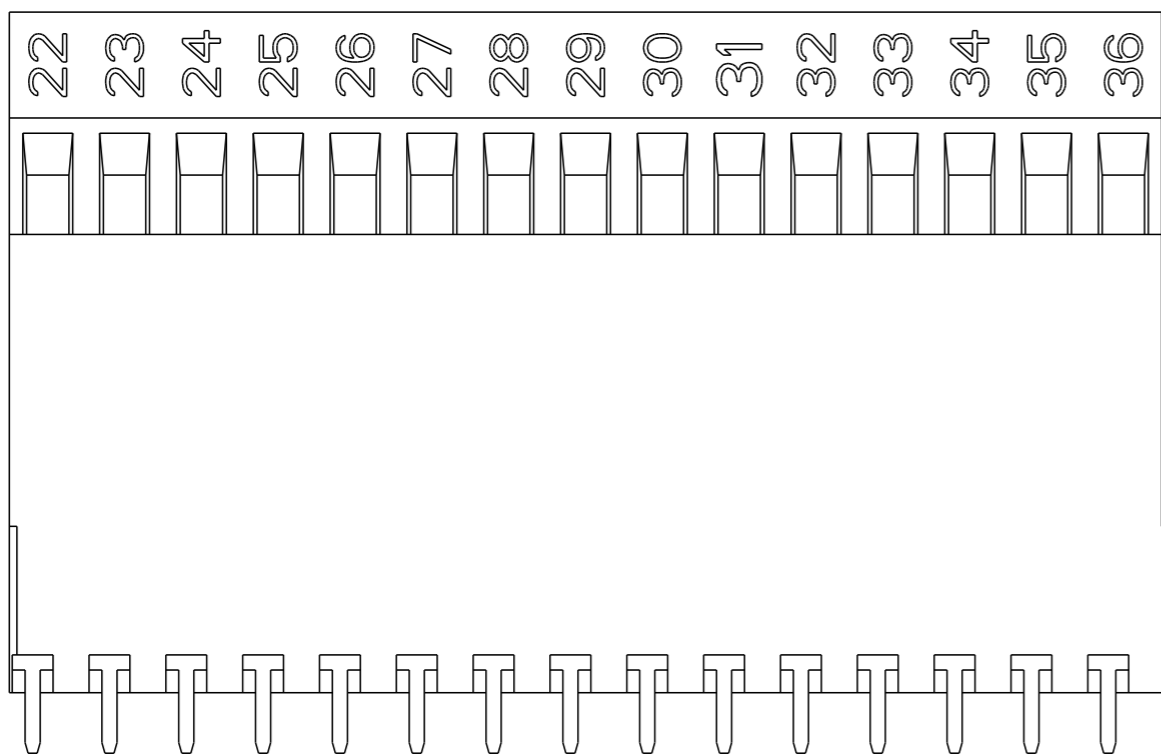

DETAIL E  
SCALE 2:1

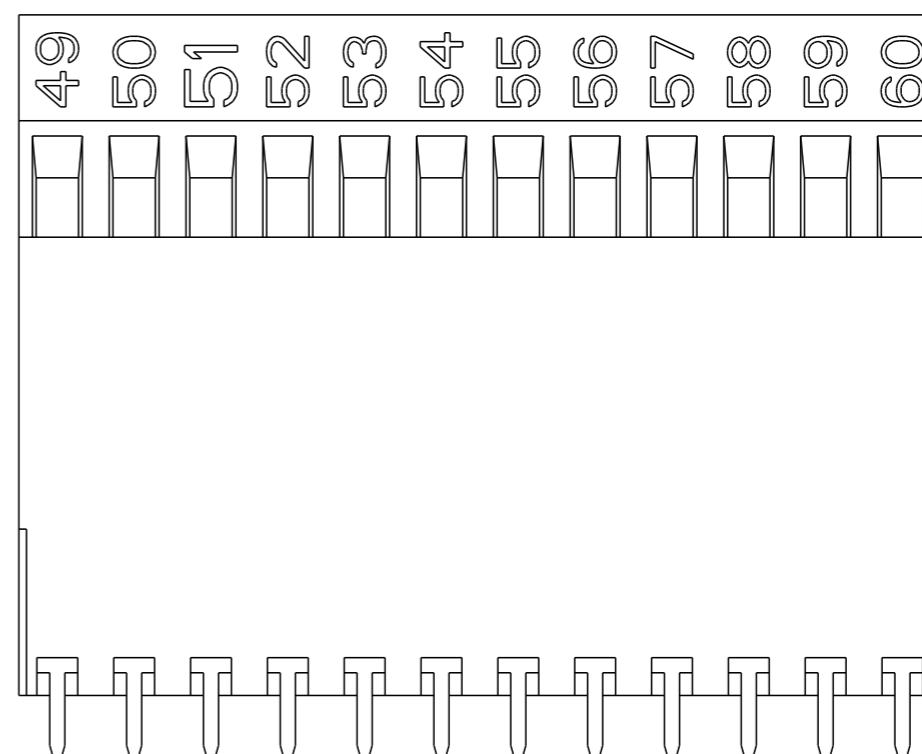

DETAIL F  
SCALE 2:1

THIS DRAWING IS A CONTROLLED DOCUMENT.

DIMENSIONS: mm	TOLERANCES UNLESS OTHERWISE SPECIFIED: 0 PLC ± 1 PLC ±0.3 2 PLC ±0.25 3 PLC ± 4 PLC ± ANGLES ±2°
MATERIAL SEE NOTES	FINISH SEE NOTES

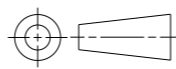

DWN E. ZANOLINI 09NOV2001	 TE Connectivity
CHK D. BIEVENOUR 09NOV2001	
APVD D. BIEVENOUR 09NOV2001	
PRODUCT SPEC -	
APPLICATION SPEC -	NAME TERMINAL BLOCK, PCB MOUNT 3RD LEVEL, STACKING W/INTERLOCK, 5.08mm PITCH
WEIGHT -	SIZE A300779
CUSTOMER DRAWING	CAGE CODE G-282925
	DRAWING NO -
	RESTRICTED TO -
	SCALE 2:1
	SHEET 3 OF 4
	REV C9



TE Connectivity

TERMINAL BLOCK, PCB MOUNT  
3RD LEVEL, STACKING W/INTERLOCK,  
5.08mm PITCH

SIZE A300779	CAGE CODE G-282925	DRAWING NO -	RESTRICTED TO -
SCALE 2:1		SHEET 3 OF 4	REV C9

THIS DRAWING IS UNPUBLISHED.

RELEASED FOR PUBLICATION

20

© COPYRIGHT 20 BY - ALL RIGHTS RESERVED.

REVISIONS

P	LTR	DESCRIPTION	DATE	DWN	APVD
-		SEE SHEET 1	-	-	-

- 1. MATERIALS AND FINISH  
HOUSING: PA 66, UL 94-V0, COLOR: GREEN.  
CLAMP: BRASS, NICKEL PLATED.  
TERMINAL: BRASS, TIN PLATED.  
CLAMPING SCREW: M3, BRASS, NICKEL PLATED.
- 2. MECHANICAL:  
RECOMENDED TIGHTENING TORQUE : 0.5Nm  
WIRE STRIPPING LENGTH : 6.5-7.0mm  
MIN. PC BOARD HOLES DIAMETER : 1.4mm  
MAX. PC BOARD THICKNESS : 2.4mm
- 3. ELECTRICAL  
WIRE RANGE : 16-30 AWG  
MAX. VOLTAGE : 300 V  
MAX CURRENT : 24 A  
CONTACT RESISTANCE : < 15 m Ohm  
INSULATION RESISTANCE : > 1000 M Ohm (500V DC)

4. OPERATING TEMPERATURE RANGE: -40C TO +105C.

5. RECOGNIZED UNDER THE COMPONENT PROGRAM OF UNDERWRITERS LABORATORIES INC., FILE NO E60677

- 6. NOT CUMULATIVE TOLERANCE.
- 7. P/N 1-282925-0 IS A KIT PACKAGE COMPRISED OF THE FOLLOWING:(3) OF 25 POS. GLUED ASSEMBLIES AND (4) OF 22 POS. GLUED ASSEMBLIES. EACH GLUED ASSEMBLY IS PACKAGED SEPERATLY IN A UNIT BOX.
- 8. INK MARKING, BLACK COLOR. NUMERICAL SEQUENCE: FROM LEFT TO RIGHT FOR EACH GLUED ASSEMBLY.
- 9. INK MARKING, BLACK COLOR. SEE DETAIL FOR MARKING.
- 10. PARTS TO BE SHIPPED WITH CAGES IN THE CLOSED POSITION WITH SCREW TORQUE TO 3 IN-16s MIN.
- 11. DELETED
- 12. SECTION GLUED USING CYANOLIT 241F OR TE ENGINEERING APPROVED EQUIVALENT.

THIS DRAWING IS A CONTROLLED DOCUMENT.

DWN 09NOV2001  
E. ZANOLINI  
CHK 09NOV2001  
D. BIEVENOUR  
APVD 09NOV2001  
D. BIEVENOUR



DIMENSIONS:  
mm

TOLERANCES UNLESS OTHERWISE SPECIFIED:

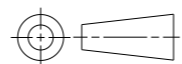

0 PLC ±  
1 PLC ±0.3  
2 PLC ±0.25  
3 PLC ±  
4 PLC ±  
ANGLES ±2°

MATERIAL  
SEE NOTES

FINISH  
SEE NOTES

PRODUCT SPEC -  
APPLICATION SPEC -  
WEIGHT -

NAME  
TERMINAL BLOCK, PCB MOUNT  
3RD LEVEL, STACKING W/INTERLOCK,  
5.08mm PITCH

SIZE	CAGE CODE	DRAWING NO	RESTRICTED TO
A3	00779	C-282925	-

CUSTOMER DRAWING SCALE 2:1 SHEET 4 OF 4 REV C9

## X-ON Electronics

Largest Supplier of Electrical and Electronic Components

*Click to view similar products for [Fixed Terminal Blocks](#) category:*

*Click to view products by [TE Connectivity](#) manufacturer:*

Other Similar products are found below :

[MBE-1512](#) [MBE-154](#) [MBE-156](#) [MBES-153](#) [MBES-156](#) [MH-2512](#) [MHE-132](#) [MHE-163](#) [MI-254 \(35\)](#) [MI-272](#) [880507](#) [MPT-275](#)  
[15602-04-08-21](#) [ELM023100](#) [BA311TU](#) [BA411SU](#) [MV-152](#) [MV-252-D](#) [MV-253/NCNOC](#) [MV-254-D](#) [MV-255](#) [MV-462](#) [MV-493](#) [MVE-](#)  
[252](#) [MVE-253](#) [MVE-273](#) [MVEB-153](#) [1700096](#) [1705142](#) [1712417](#) [1713020](#) [1713088](#) [1745195](#) [1760594](#) [1776118-2](#) [1790852](#) [1-796689-8](#)  
[1-796692-6](#) [1800001](#) [1800114](#) [1995279](#) [20020314-C121B01LF](#) [20020316-G041B01LF](#) [CB2-12](#) [KP03215000J0G](#) [KP04215000J0G](#) [S451](#)  
[282802-2](#) [29.007](#) [29.116](#)