

THIS DRAWING IS UNPUBLISHED. RELEASED FOR PUBLICATION 20
 © COPYRIGHT 20 BY - ALL RIGHTS RESERVED.

REVISIONS				
P	LTR	DESCRIPTION	DATE	APVD
	A	RELEASED	11APR2018	KM DW

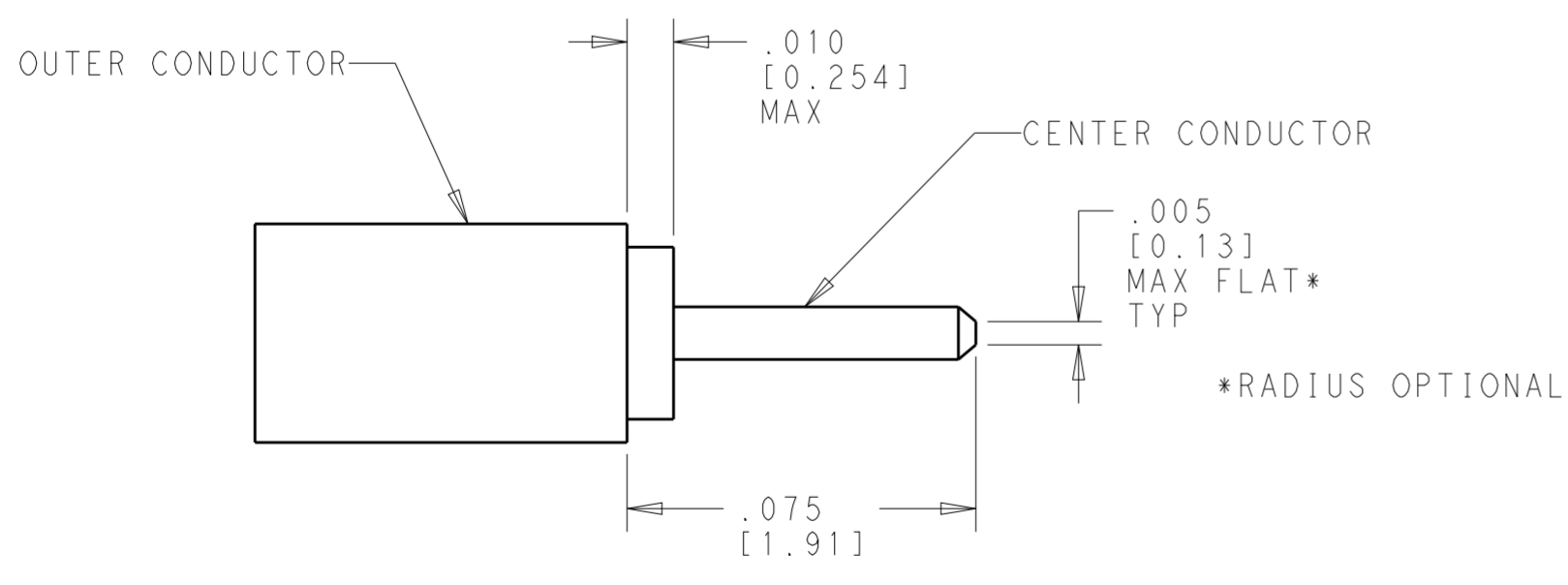
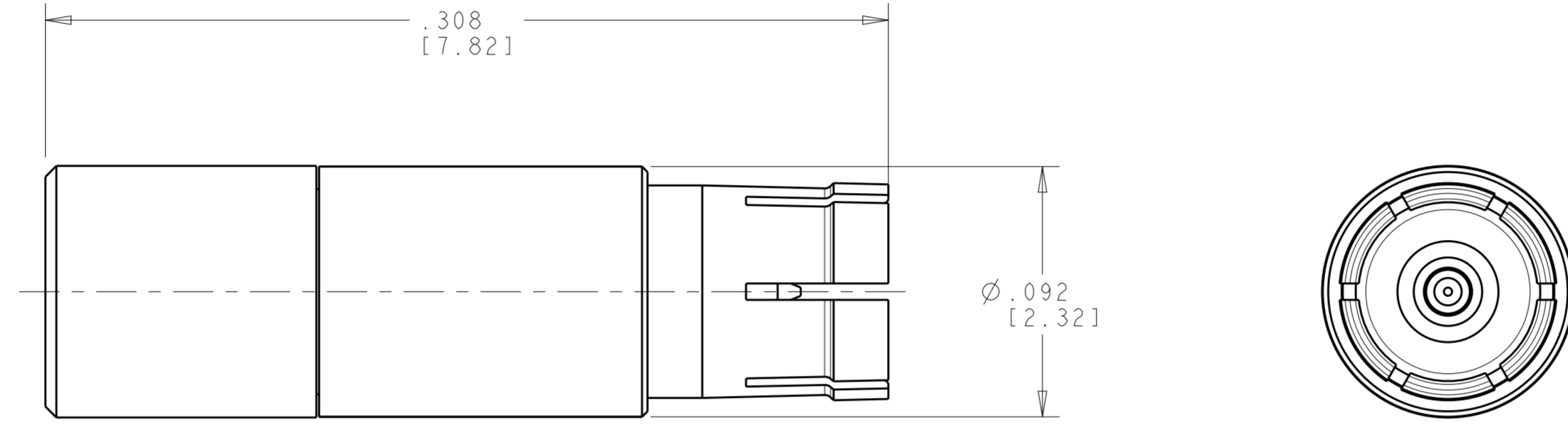

- 1 MATERIAL:
 BODY AND CENTER CONTACT: COPPER ALLOY
 INSULATOR: TEFLON (PTFE)
- 2 FINISH: FRONT BODY AND CENTER CONTACT: 50-90 μIN GOLD PLATE OVER NICKEL
 REAR BODY: 3-15 μIN GOLD PLATE OVER NICKEL

SCALE 25:1
 CABLE PREPARATION FOR
 Ø.047 SEMI-RIGID CABLES

2302339-1
 PART NO.

THIS DRAWING IS A CONTROLLED DOCUMENT.		DWN K. MILLER 31MAY2016	STE TE Connectivity	
DIMENSIONS: INCHES [mm]		CHK D. WILSON 31MAY2016		
TOLERANCES UNLESS OTHERWISE SPECIFIED:		APVD D. WILSON 11APR2018	NAME NanoRF SOCKET CONTACT ASSEMBLY	
0 PLC ±	1 PLC ±	PRODUCT SPEC 108-163006	SIZE A2	CAGE CODE 00779
2 PLC ±	3 PLC ±.005[0.13]	APPLICATION SPEC 408-163016	DRAWING NO C-2302339	RESTRICTED TO -
4 PLC ±	ANGLES ±	WEIGHT -	SCALE 20:1 SHEET 1 OF 1 REV A	
MATERIAL 1	FINISH 2	CUSTOMER DRAWING		

X-ON Electronics

Largest Supplier of Electrical and Electronic Components

Click to view similar products for [RF Connectors](#) / [Coaxial Connectors](#) category:

Click to view products by [TE Connectivity](#) manufacturer:

Other Similar products are found below :

[8915-1511-000](#) [89674-0827](#) [6001-7071-019](#) [6002-7051-003](#) [6002-7551-202](#) [6059674-1](#) [619550-1](#) [630059-000](#) [M39030/3-01N](#) [6500-7071-046](#) [6769](#) [CX050L2AQ](#) [7002-1541-010](#) [7002-1542-011](#) [7004-1512-000](#) [7009-1511-004](#) [7010-1511-000](#) [7029-1511-060](#) [7101-1541-010](#) [7101-1571-002](#) [7145-1521-002](#) [7203-1571-003](#) [7209-1511-011](#) [7210-1511-015](#) [7210-1511-019](#) [73137-5015](#) [73216-2241](#) [73404-2300](#) [7405-1521-005](#) [7405-1521-802](#) [8527](#) [8547](#) [FS11V](#) [877931](#) [8808-1511-001](#) [9049-9513-000](#) [9074-9513-000](#) [9101-9573-002](#) [910A205F](#) [9130-9573-002](#) [PL11SC-026](#) [PL375-33](#) [PL40-5](#) [PL74C-221](#) [PL75MC-217](#) [PL803-7](#) [1200690078](#) [1-201144-1](#) [R107003010W](#) [R110A172100](#)