

RECOMMENDED PCB LAYOUT TOLERANCE IS ±0.05

REVISIONS				
P	LTR	DESCRIPTION	DATE	APVD
E		REVISED PER ECO-18-008015	24MAY2018	AP DG

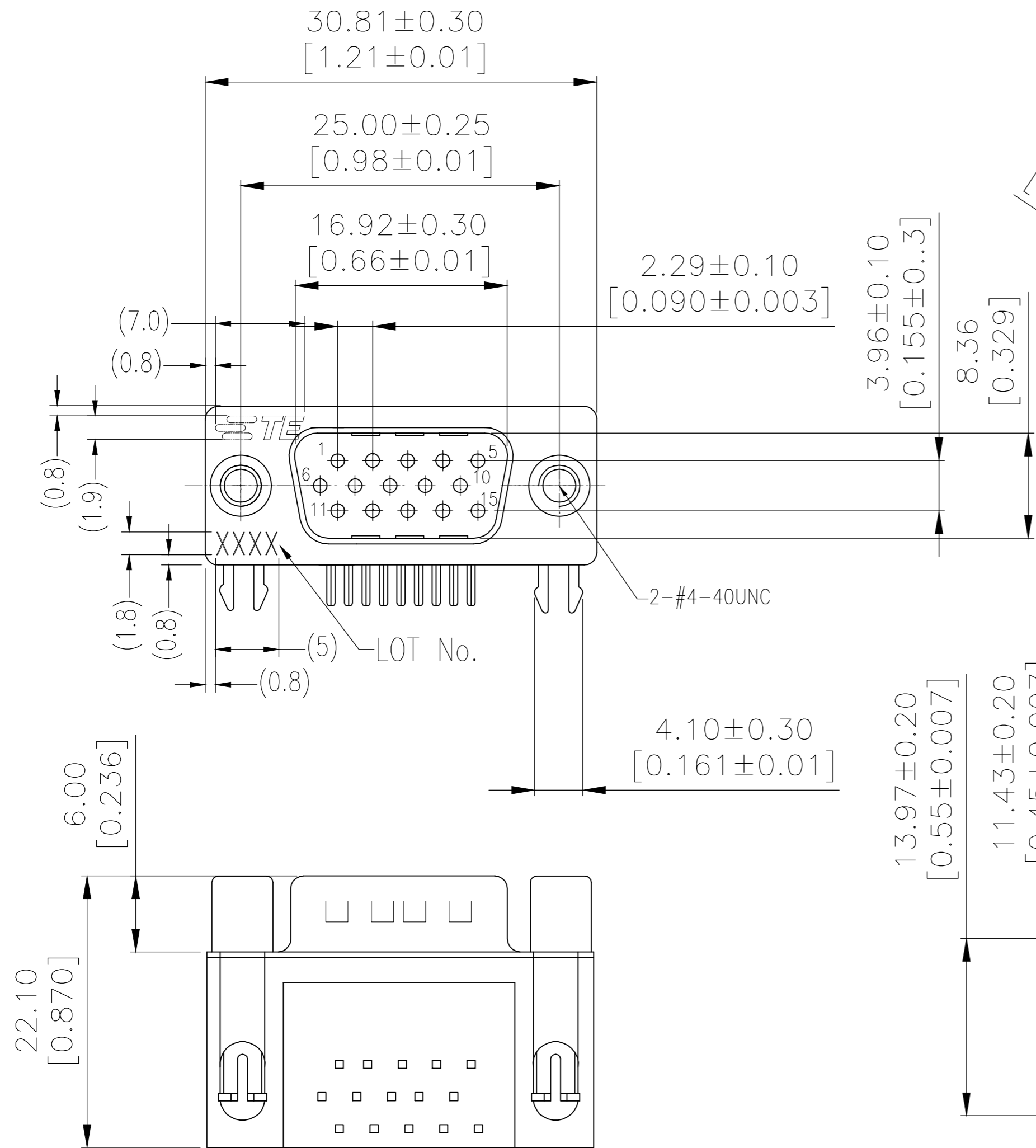

NOTES:

- Housing: PBT+30%GF(UL94V-0) BLACK
- Contact: Brass
- " GOLD PLATING ON CONTACT AREA
- 100u" MATTE TIN PLATING ON SOLDER TAIL
- 50u" NICKEL UNDERPLATED OVERALL
- Holddown: Brass, 100u" TIN OVER 50u" NICKEL
- Shell: Cold Roller Steel, Ni Plated
- Revit: Brass, Nickel Plating
- Nut: Brass, Nickel Plated

LOT NUMBER "XXXX"
 X Stands For Calendar Year
 X Stands For Week Number

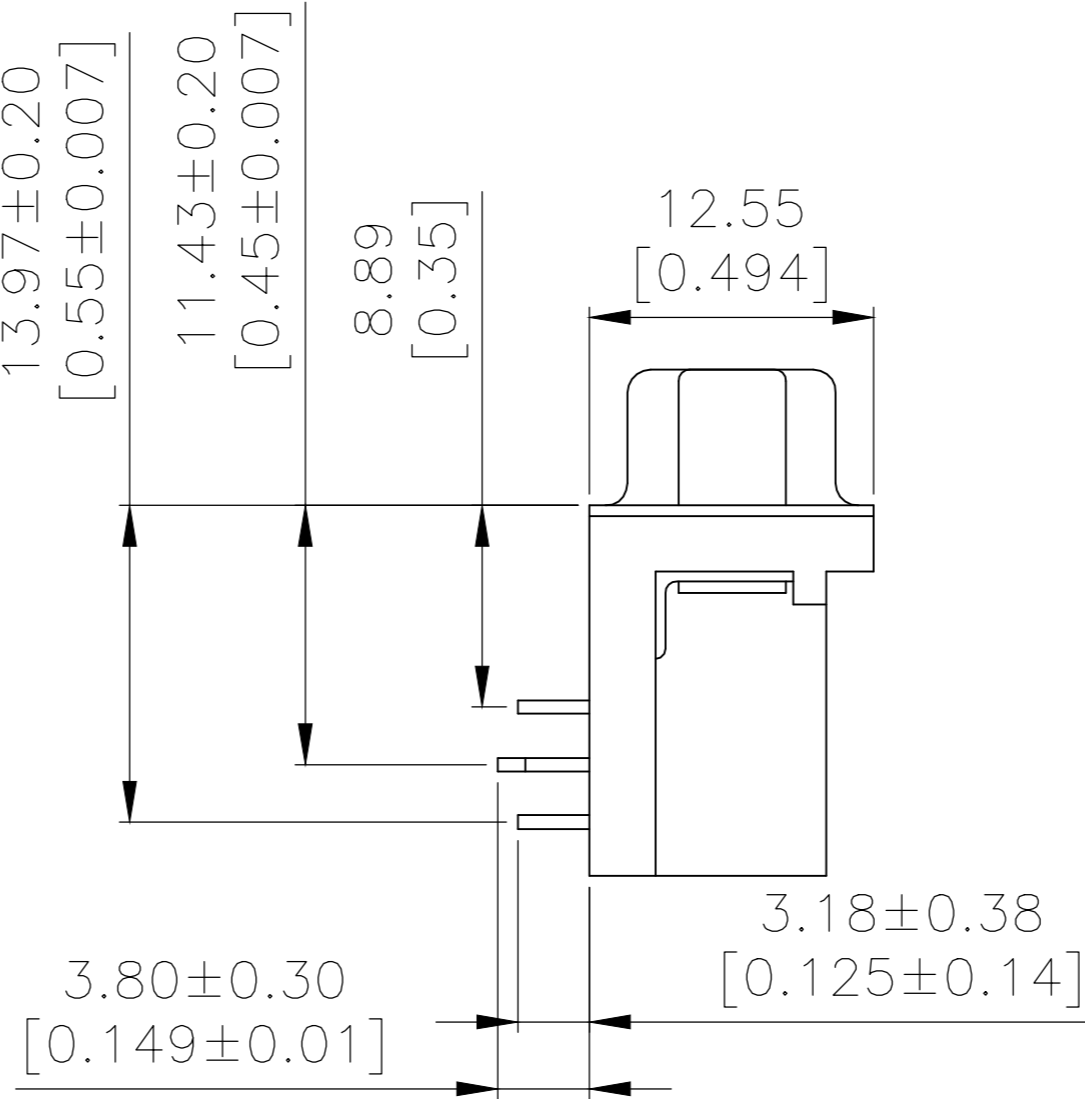
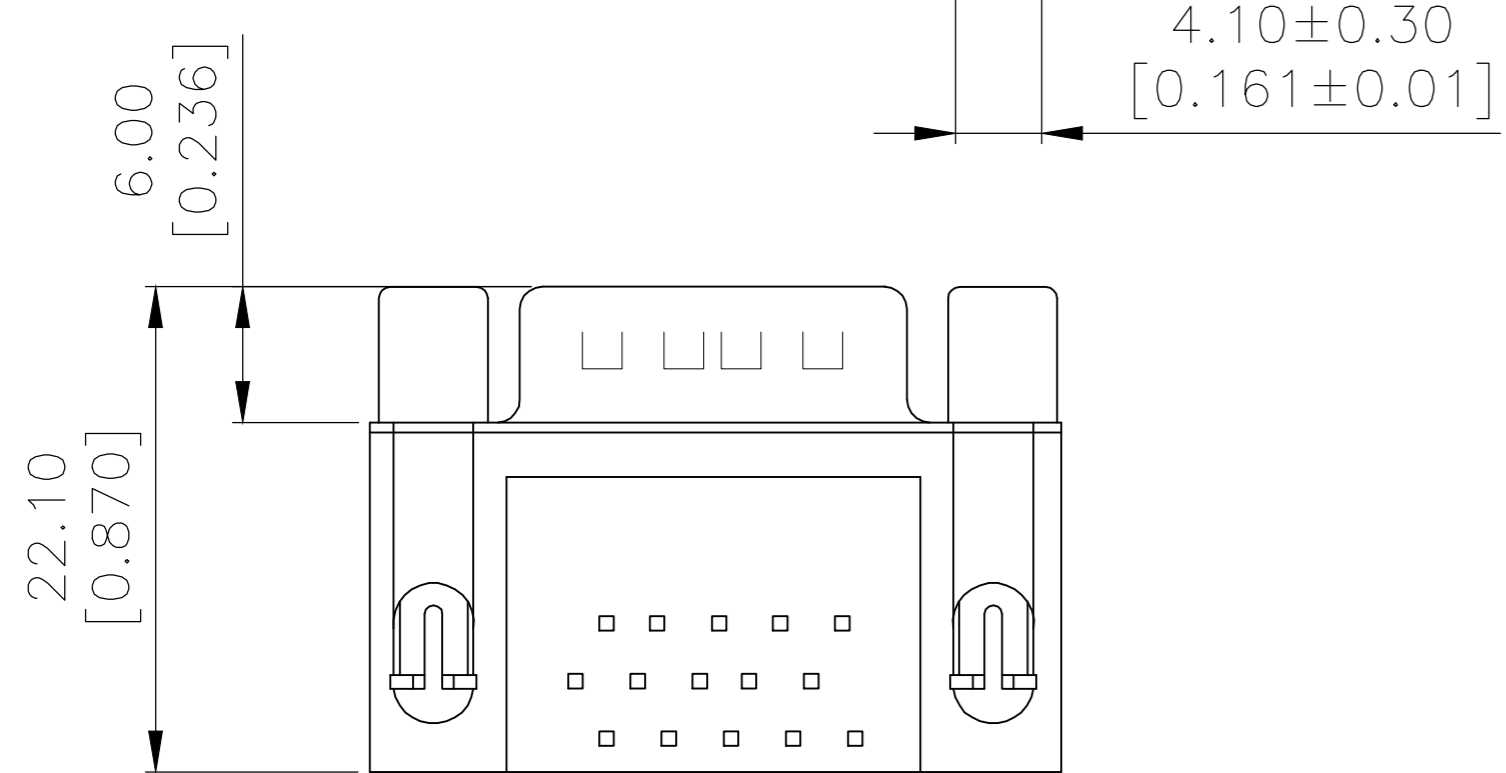

YES	30μ" Au	2311775-1
SCREW LOCK	Contact Area	P/N
	Plating	

THIS DRAWING IS A CONTROLLED DOCUMENT.		DWN 07MAR2017 AJITH PAI		TE Connectivity			
DIMENSIONS: mm		CHK 07MAR2017 DANIEL GORENC				NAME	
TOLERANCES UNLESS OTHERWISE SPECIFIED:		APVD 07MAR2017 DANIEL GORENC				PRODUCT SPEC	
0 PLC ± - 1 PLC ± - 2 PLC ± 0.25 3 PLC ± - 4 PLC ± - ANGLES ± - FINISH -		APPLICATION SPEC 108-130023				AMPLIMITE PLUG, HD22, RIGHT ANGLE, 15P	
MATERIAL		WEIGHT		SIZE			
				A2			
		CUSTOMER DRAWING		CAGE CODE			
				00779			
		SCALE 1:1		DRAWING NO			
				C=2311775			
		SHEET 1 OF 1		RESTRICTED TO			
		REV E					

X-ON Electronics

Largest Supplier of Electrical and Electronic Components

Click to view similar products for [D-Sub High Density Connectors](#) category:

Click to view products by [TE Connectivity](#) manufacturer:

Other Similar products are found below :

[97-3250-11](#) [163A16809X](#) [163A17089X](#) [164A17199X](#) [164C18629X](#) [242A25680X](#) [L717HDB44POL2R210](#) [L717HDEH15POL2](#)
[L777HDE15P](#) [L77HDE15SC309](#) [163A16759X](#) [163A16839X](#) [163A16989X](#) [163A17079X](#) [164A17329X](#) [164A18219X](#) [241A16440X](#)
[241A16550X](#) [241A16680X](#) [241A20810X](#) [241A25740X](#) [CT25-44P](#) [MDBE15PE766](#) [L177HDE15SOL2RM23](#) [L177HRC62S](#)
[L177HRC62SVFM](#) [L177HRCG62S](#) [L717HDEG15POL2RM5](#) [L77HDA26SVF](#) [L77HDE15SD1CO](#) [L77HDEH15SOL2RM832](#) [443895-3](#)
[106698-1](#) [280-012K2C](#) [L177HRB44S](#) [164A17039X](#) [09562004701510](#) [164A17969X](#) [L777HRC62P](#) [241A17960X](#) [164A18269X](#)
[L777HDEG15P](#) [280-018P3S25MEGN](#) [206504-2](#) [40-9515HDSP](#) [2057140-1](#) [C115370-6002](#) [DFMA104SNMBFR172FR022](#) [HDC9F200E2S](#)
[L717HDAG26POL2RM8](#)