

REVISIONS				
P	LTR	DESCRIPTION	DATE	APVD
D		REVISED PER ECO-18-008015	24MAY2018	AP DG

RECOMMENDED PCB LAYOUT
 TOLERANCE IS ±0.05

$\phi 1.19 \pm 0.05$
 $[0.046 \pm 0.001]$
 $\phi 3.18 \pm 0.08$
 $[0.122 \pm 0.003]$

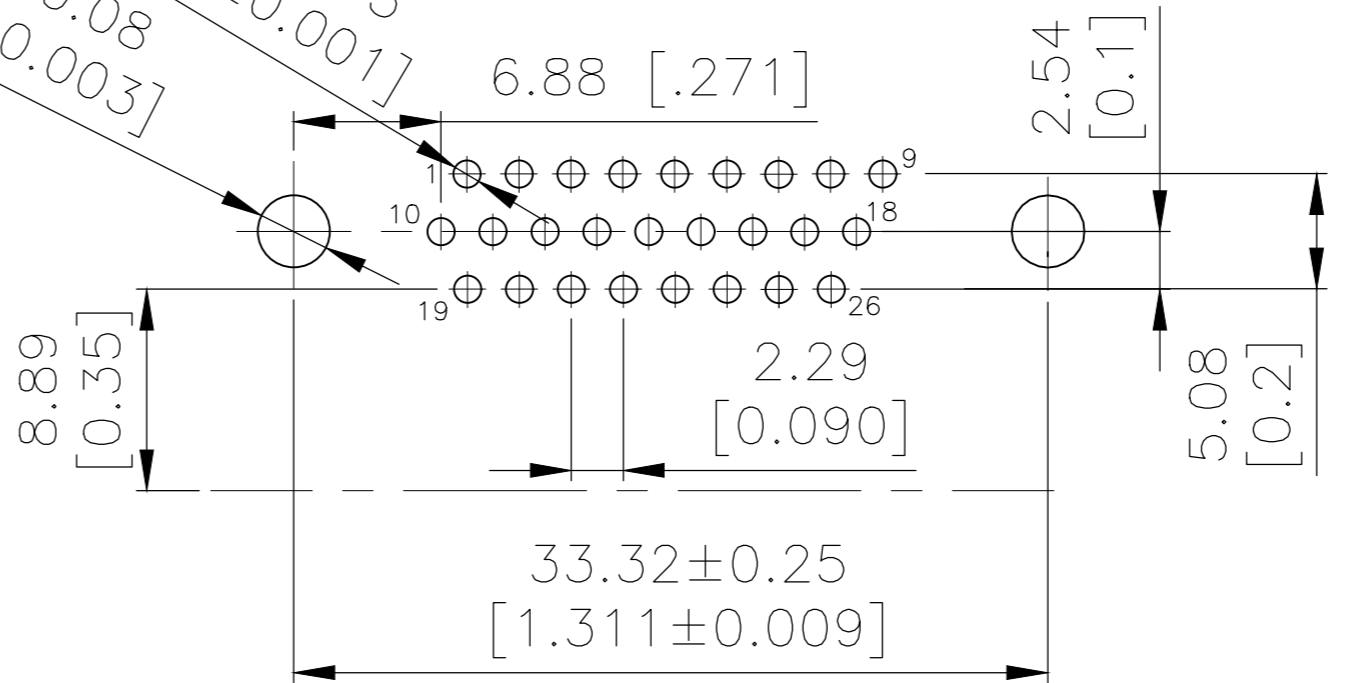
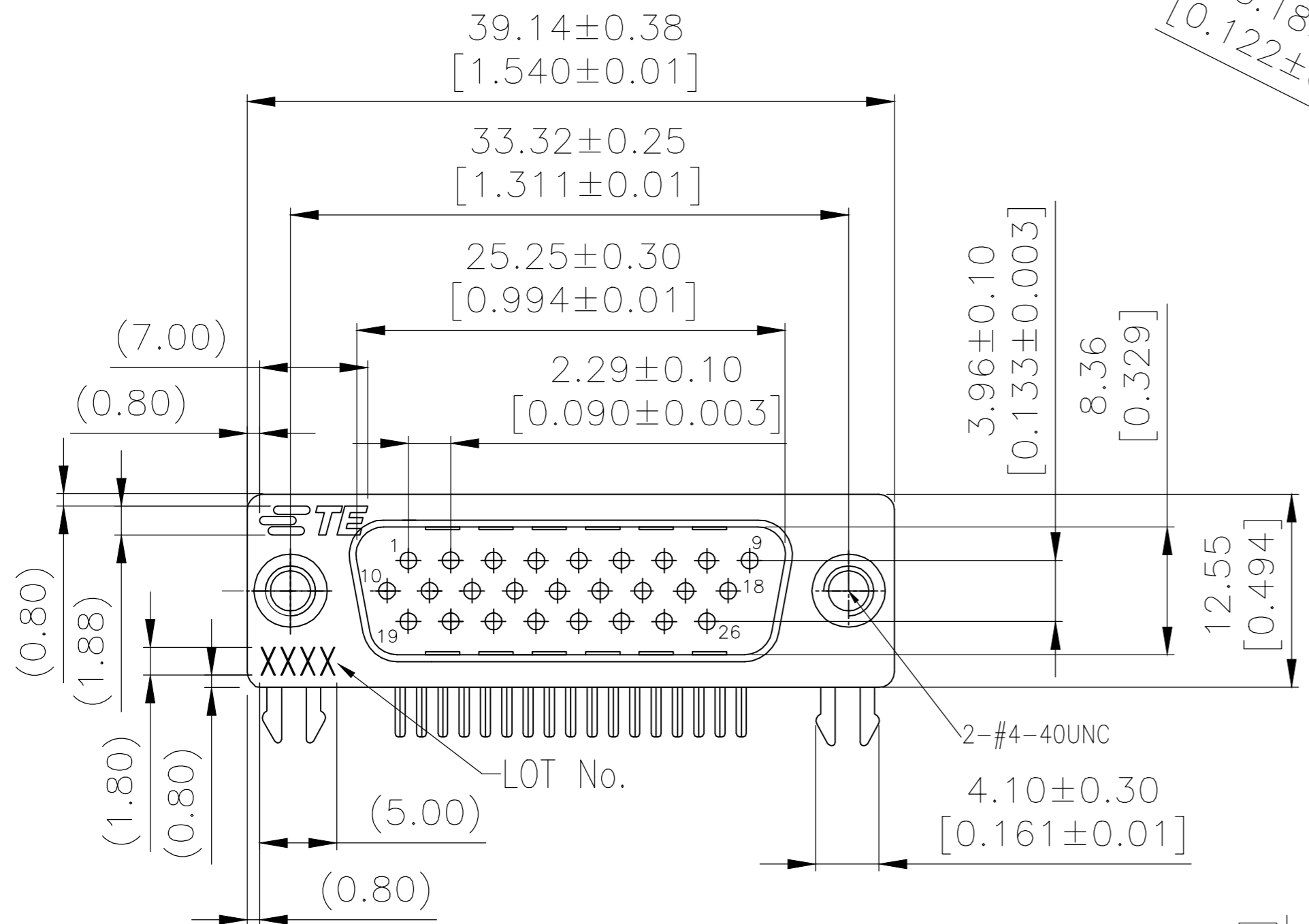

NOTES:
 Housing: PBT+30%GF(UL94V-0) BLACK
 Contact: Brass
 " GOLD PLATING ON CONTACT AREA
 100u" MATTE TIN PLATING ON SOLDER TAIL
 50u" NICKEL UNDERPLATED OVERALL
 Holddown: Brass, 100u" TIN OVER 50u" NICKEL
 Shell: Cold Roller Steel, Ni Plated
 Revit: Brass, Nickel Plating
 LOT NUMBER "XXXX"
 └── Stands For Calendar Year
 └── Stands For Week Number

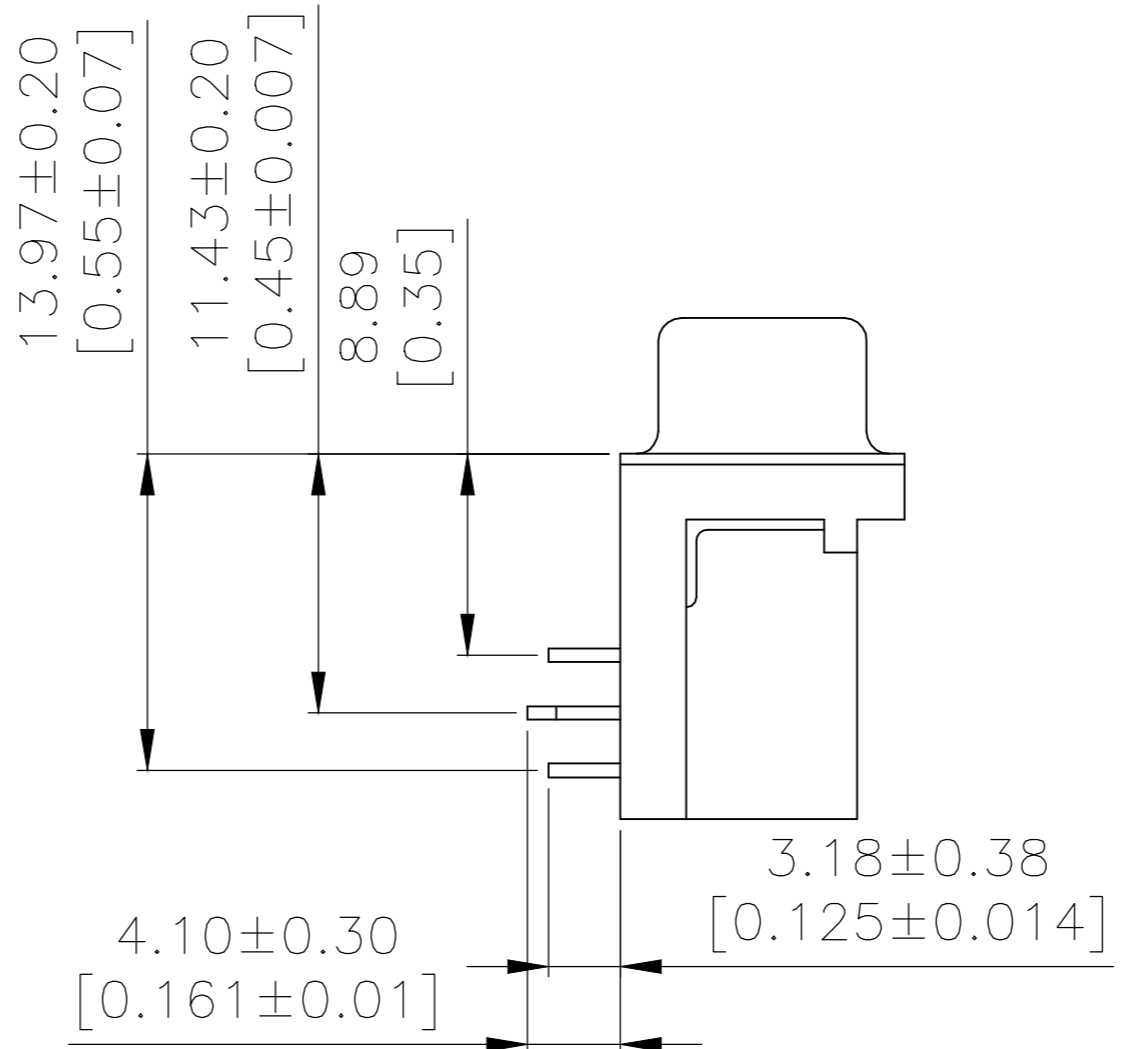
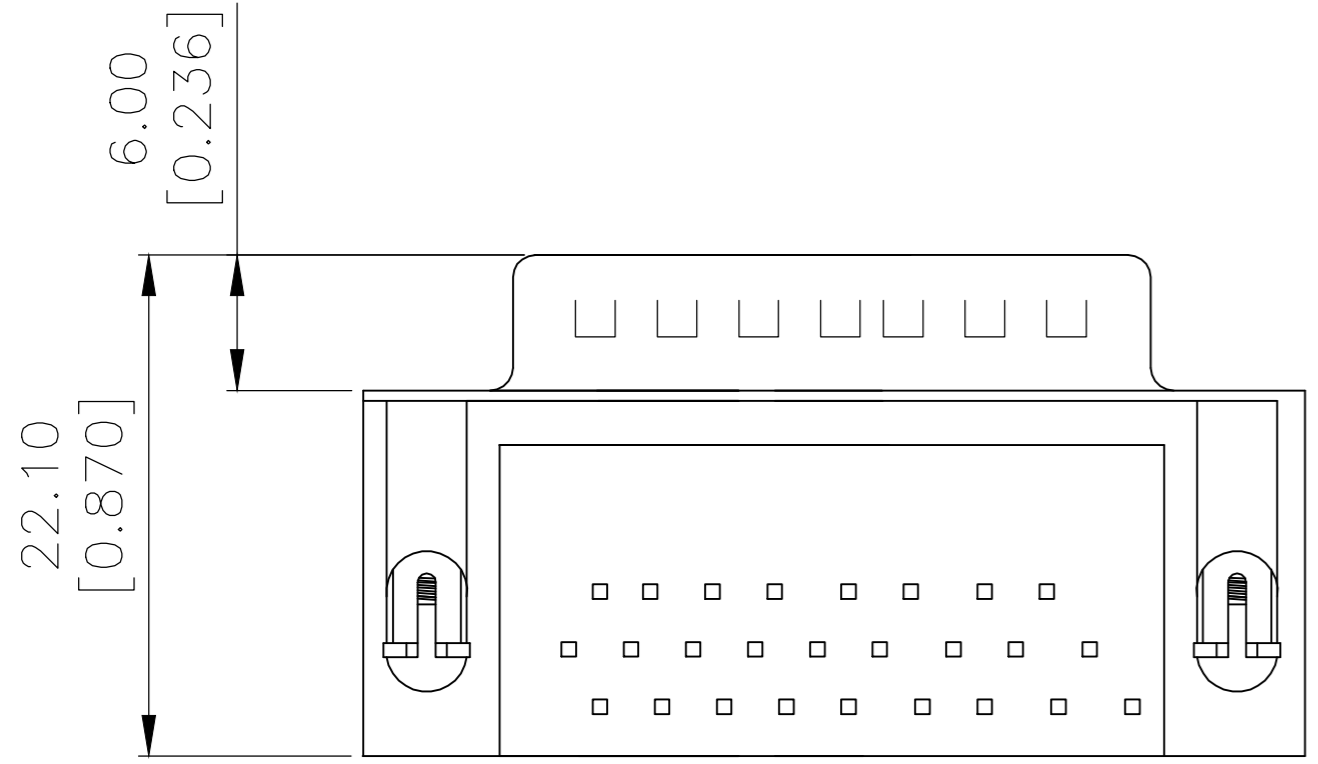

THREADED TYPE	30μ" Au Contact Area Plating	2311776-1 P/N
---------------	------------------------------	---------------

THIS DRAWING IS A CONTROLLED DOCUMENT.		DWN 25FEB2017 AJITH PAI	TE Connectivity	
DIMENSIONS: mm		CHK 25FEB2017 DANIEL GORENC		
TOLERANCES UNLESS OTHERWISE SPECIFIED:		APVD 25FEB2017 DANIEL GORENC	NAME AMPLIMITE PLUG, HD22, RIGHT ANGLE, 26P THREADED	
0 PLC ± -	1 PLC ± -	PRODUCT SPEC 108-130023	SIZE A2	CAGE CODE 00779
2 PLC ± 0.25	3 PLC ± -	APPLICATION SPEC	DRAWING NO C=2311776	RESTRICTED TO -
4 PLC ± -	ANGLES ± -	MATERIAL -	WEIGHT	SCALE 1:1
FINISH -			CUSTOMER DRAWING	SHEET 1 of 1
				REV D

X-ON Electronics

Largest Supplier of Electrical and Electronic Components

Click to view similar products for [D-Sub High Density Connectors](#) category:

Click to view products by [TE Connectivity](#) manufacturer:

Other Similar products are found below :

[1484349-1](#) [163A16769X](#) [163A16809X](#) [163A17089X](#) [164A17199X](#) [164A17209X](#) [164A17479X](#) [164A18209X](#) [17BH-044S-AA110](#) [K86X-AD-26S](#) [KF66X-A26P-NJ](#) [KF66X-E15P-N](#) [241A17320X](#) [242A18390X](#) [242A25740X](#) [L717HDB44POL2R210](#) [L717HDCH62POL2RM5](#) [L717HDEH15POL2](#) [L777HDE15P](#) [L77HDC62S](#) [L77HDE15SC309](#) [163A16779X](#) [163A16839X](#) [163A17049X](#) [163A17079X](#) [164A17309X](#) [164A17329X](#) [164A18219X](#) [241A16440X](#) [241A16550X](#) [241A16680X](#) [241A17390X](#) [241A20810X](#) [241A25740X](#) [CT25-44P](#) [K66X-E15S-N30](#) [K86X-BA-44S](#) [K86X-ED-15S-BR15](#) [K86X-ED-15SK](#) [L177HDE15SOL2RM23](#) [L177HRC62S](#) [L177HRC62SVFM](#) [L177HRCG62S](#) [L717HDBH44POL2RM5](#) [L717HDEG15POL2RM5](#) [L77HDA26SVF](#) [L77HDE15SD1CO](#) [L77HDEH15SOL2RM832](#) [DAMA-15S-WS](#)
[443895-3](#)