

LOC		DIST		REVISIONS			
P	LTN	DESCRIPTION	DATE	DWN	APVD		
A		FIRST RELEASE	08JUN2018	SZ	SZ		

NOTES, UNLESS OTHERWISE SPECIFIED

1. MATERIAL:
 HOUSING - THERMOPLASTIC, GLASS PREINFORCED, COLOR, BLACK, UL 94V-0
 CONTACTS- COPPER ALLOY.

2. FINISH:
 MATING AREA - NOBLE METAL OVERALL NICKEL.
 SOLDER TAIL - MATTE TIN OVERALL NICKEL.

△ MARK P/N AND DATA CODE IN APPROX. AREA AS SHOWN.

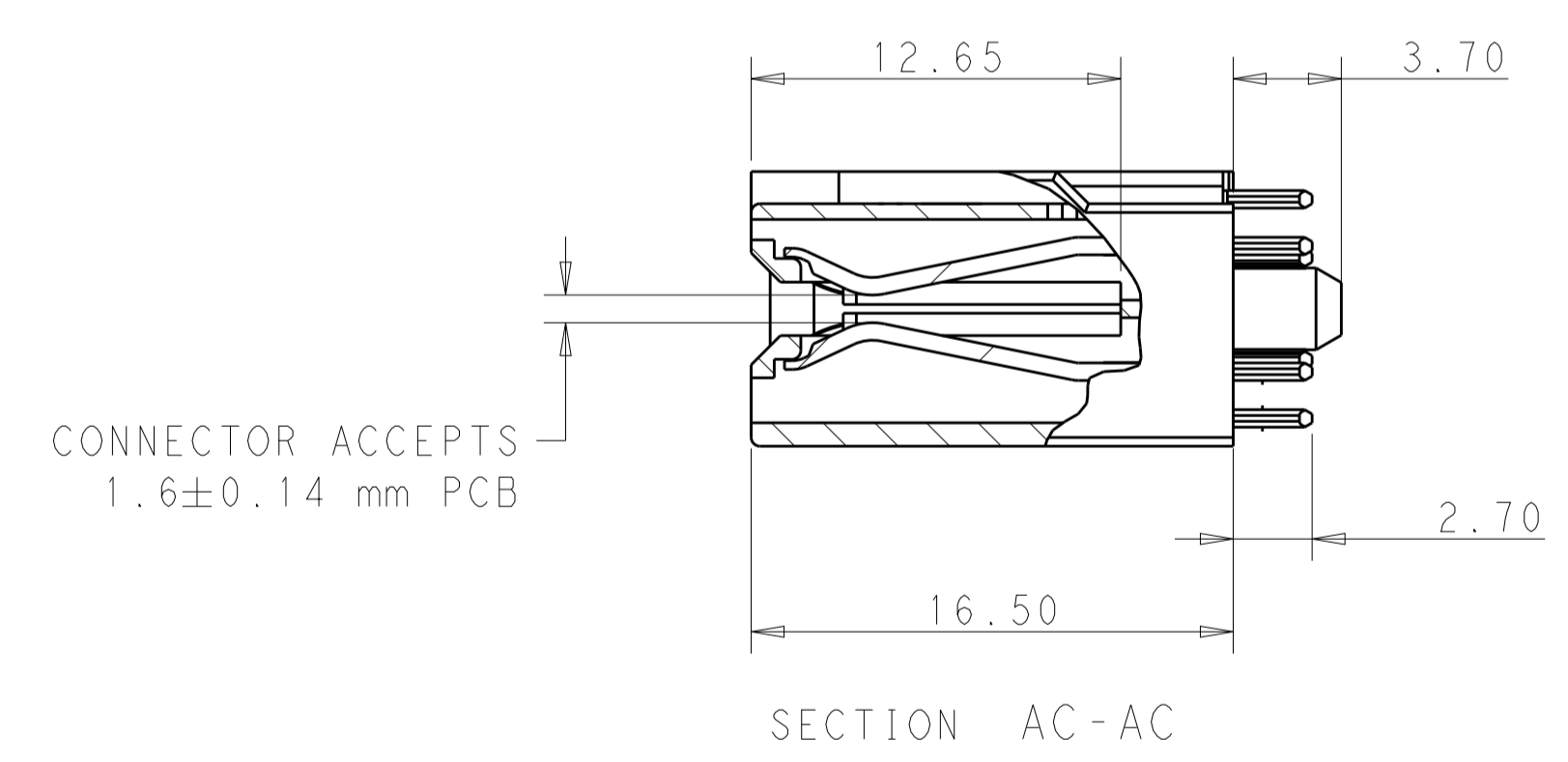
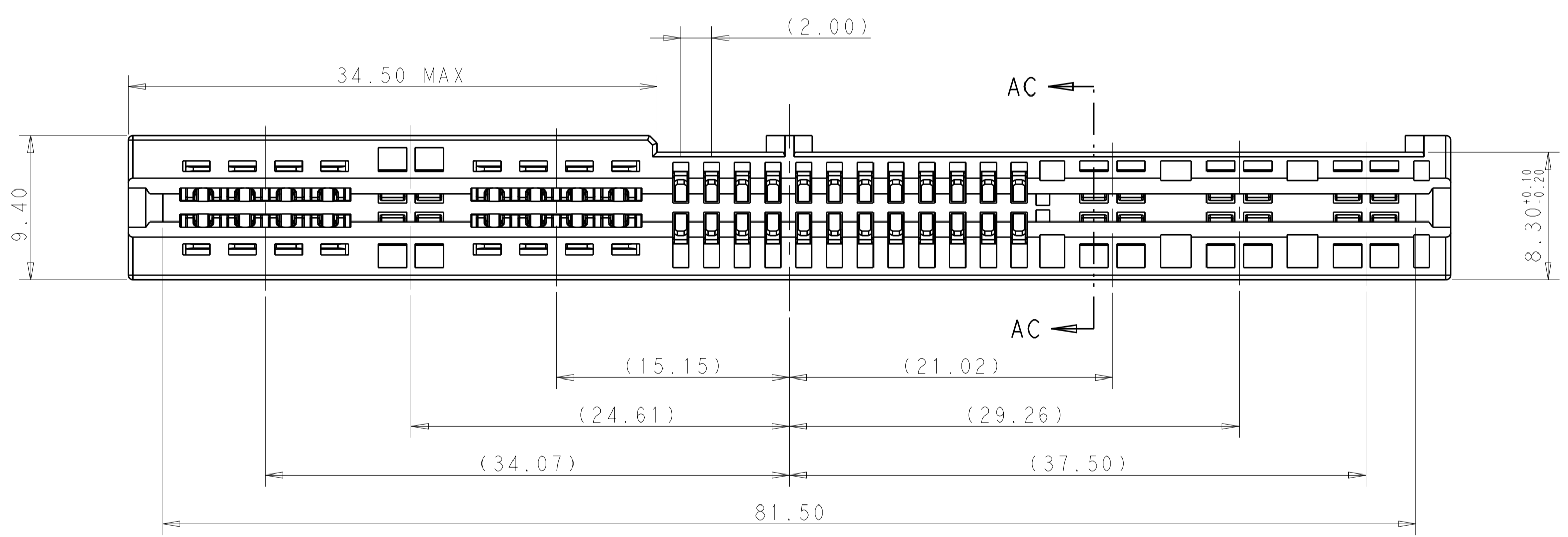
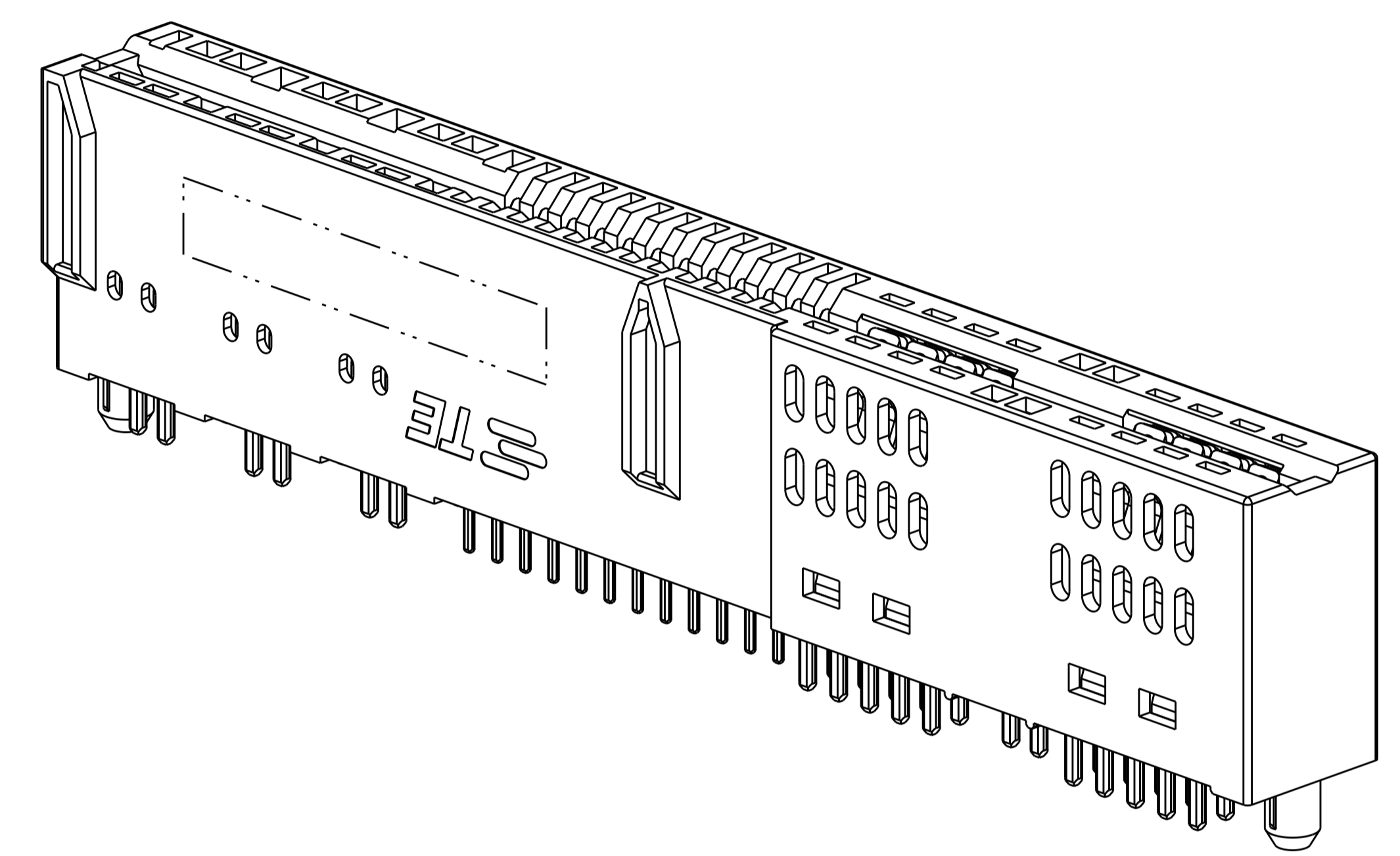
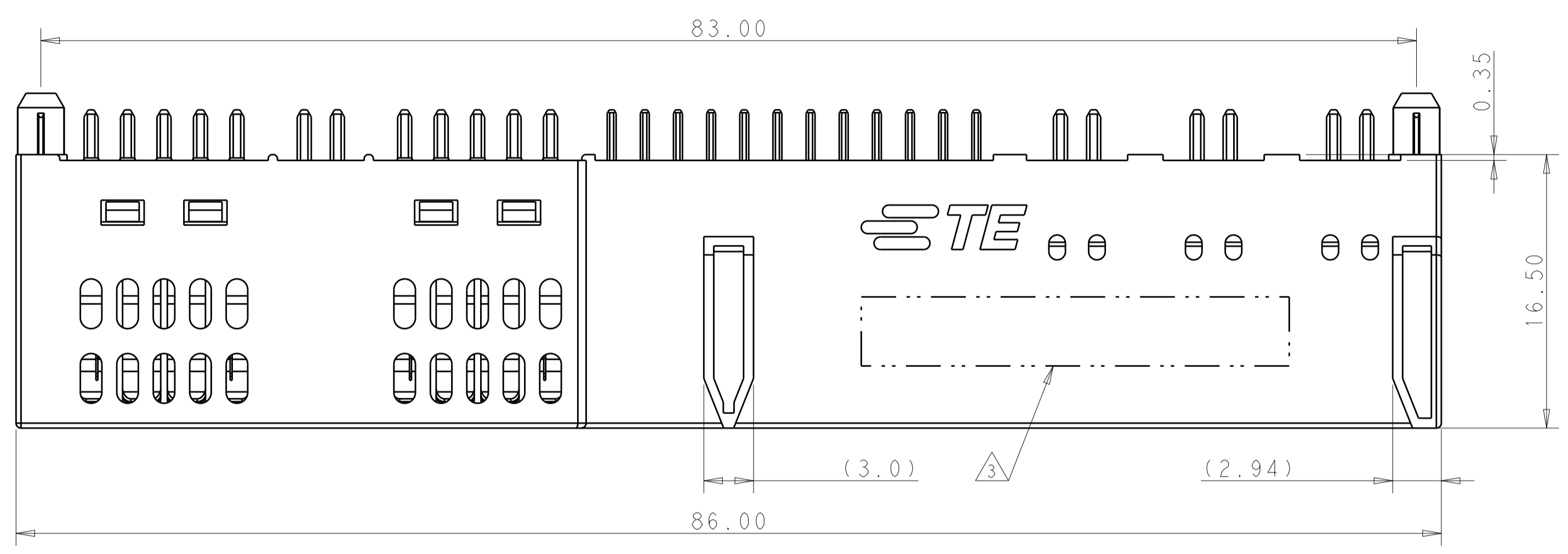

PART NUMBER 2322260-1

THIS DRAWING IS A CONTROLLED DOCUMENT.		DWN: SEAN ZHANG 01SEP2017		CHK: SUNY ZHAO 01SEP2017		NAME: HIGE DENSITY HYBRID POWER CARD EDGE SOLDER TYPE LOW PROFILE															
DIMENSIONS: mm		TOLERANCES UNLESS OTHERWISE SPECIFIED:		PRODUCT SPEC: 108-128060		APPLICATION SPEC:															
<table border="1"> <tr><td>0 PLC</td><td>±</td></tr> <tr><td>1 PLC</td><td>±0.40</td></tr> <tr><td>2 PLC</td><td>±0.70</td></tr> <tr><td>3 PLC</td><td>±1.0</td></tr> <tr><td>4 PLC</td><td>±</td></tr> <tr><td>ANGLES</td><td>±</td></tr> <tr><td>FINISH</td><td>±2</td></tr> </table>		0 PLC	±	1 PLC	±0.40	2 PLC	±0.70	3 PLC	±1.0	4 PLC	±	ANGLES	±	FINISH	±2	MATERIAL: -		WEIGHT: -		RESTRICTED TO: -	
0 PLC	±																				
1 PLC	±0.40																				
2 PLC	±0.70																				
3 PLC	±1.0																				
4 PLC	±																				
ANGLES	±																				
FINISH	±2																				
CUSTOMER DRAWING		SCALE: 1:1		SHEET: 1 OF 2		REV: A															

LOC		DIST		REVISIONS			
				REV	DATE	BY	APPD
-	-	-	-	-	-	-	-
-	-	-	-	SEE SHEET 1	-	-	-

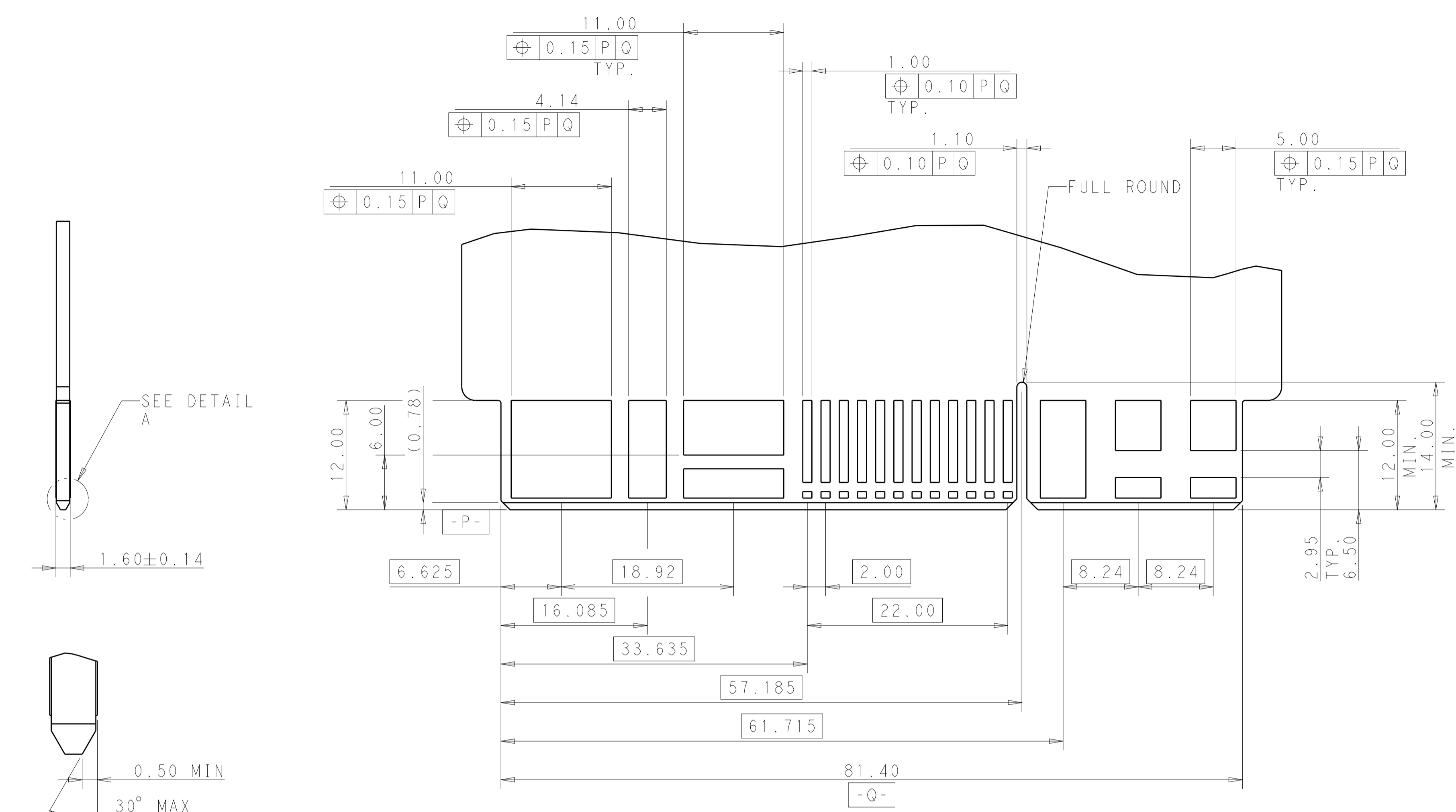

DETAIL A
SCALE 10:1

RECOMMENDED CARD EDGE CONFIGURATION
TYP. BOTH SIDE

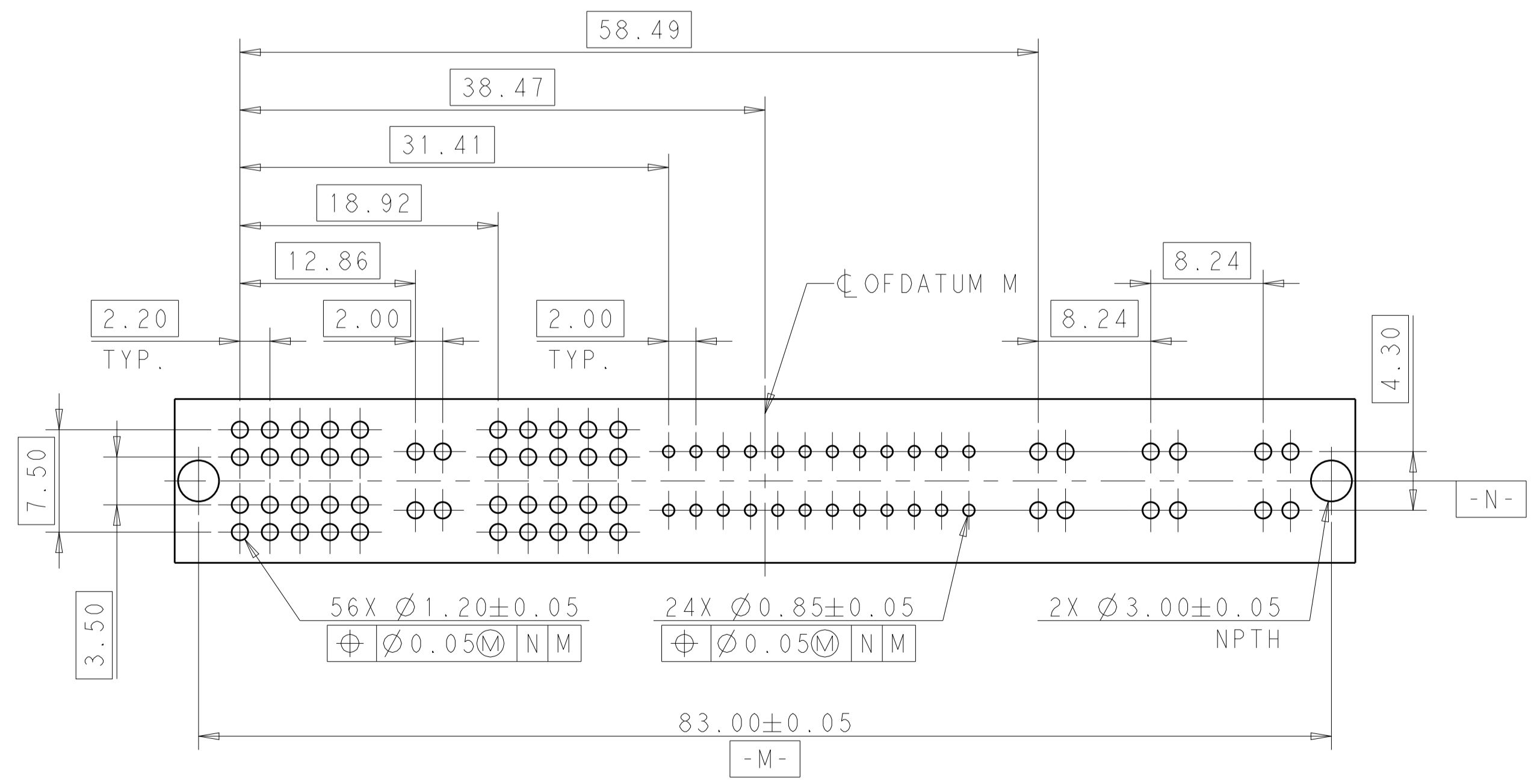

RECOMMENDED MOUNTING BOARD LAYOUT
COMPONENT SIDE

- NOTES FOR MOUNTING BOARD, UNLESS OTHERWISE SPECIFIED:
1. PLATED THROUGH HOLE, SIGNAL:
FINISHED HOLE SIZE: 0.85mm.
DRILL HOLE SIZE: 0.95 ± 0.025mm.
 2. PLATED THROUGH HOLE, POWER:
FINISHED HOLE SIZE: 1.2mm.
DRILL HOLE SIZE: 1.3 ± 0.025mm.
 3. COPPER PLATING THICKNESS: 0.025~0.05mm.
 4. SURFACE FINISH: OSP OR IMMERSION TIN PLATING IS RECOMMENDED.

THIS DRAWING IS A CONTROLLED DOCUMENT.		DWG: SEAN_ZHANG_01SEP2017		TE Connectivity	
DIMENSIONS: mm		CHK: SUNY_ZHAO_01SEP2017			
TOLERANCES UNLESS OTHERWISE SPECIFIED:		APVD: SUNY_ZHAO_01SEP2017		NAME: HIGE DENSITY HYBRID POWER CARD EDGE SOLDER TYPE LOW PROFILE	
0 PLC ±0.40		PRODUCT SPEC: 108-128060		SIZE: A1	
1 PLC ±0.20		APPLICATION SPEC:		CAGE CODE: 2322260	
2 PLC ±0.10		WEIGHT:		RESTRICTED TO:	
3 PLC ±0.10		CUSTOMER DRAWING:		SCALE: 1:1 SHEET 2 OF 2 REV A	
4 PLC ±0.10					
ANGLES ±2					
FINISH:					

X-ON Electronics

Largest Supplier of Electrical and Electronic Components

Click to view similar products for [Standard Card Edge Connectors](#) category:

Click to view products by [TE Connectivity](#) manufacturer:

Other Similar products are found below :

[CR7E-30DB-3.96E\(72\)](#) [6364499-1](#) [6565204-6](#) [PKC-156](#) [1437274-4](#) [147889-1](#) [1489165-4](#) [EBT15622B2X](#) [1-582587-1](#) [284-0102-12100](#)
[286-0052-12101A](#) [306022901000000](#) [307-012-502-202](#) [307-056-520-300](#) [2129318-1](#) [245-062-520-350](#) [287-0032-12101](#) [306-028-525-102](#)
[307-072-526-202](#) [345-060-559-303](#) [392-008-559-201](#) [534671-1](#) [341-240-317](#) [345-044-500-300](#) [346-240-318](#) [395-100-524-300](#) [09-07-2032](#)
[10035388-802LF](#) [10115859-011LF](#) [10122859-009LF](#) [10127905-B04B24BLF](#) [530555-1](#) [5-678046-1](#) [73726-0005](#) [66308-1](#) [1-1437275-6](#)
[PEC-07-02-T-S-A](#) [346-014-520-801](#) [307-048-502-202](#) [CE100F22-9-C](#) [CE100F26-7-C](#) [CE100F28-3-D](#) [CE156F18-9-C](#) [CE156F22-5-D](#)
[CE156F22-9-C](#) [CT100F22-2-D](#) [CT100F22-3-D](#) [CT100F24-2-D](#) [CT100F24-3-D](#) [CT100F24-6-C](#)