

REVISIONS					
P	LTR	DESCRIPTION	DATE	DMN	APVD
A1		REVISED PER ECO-17-018762	22DEC2017	J.Z	D.Z

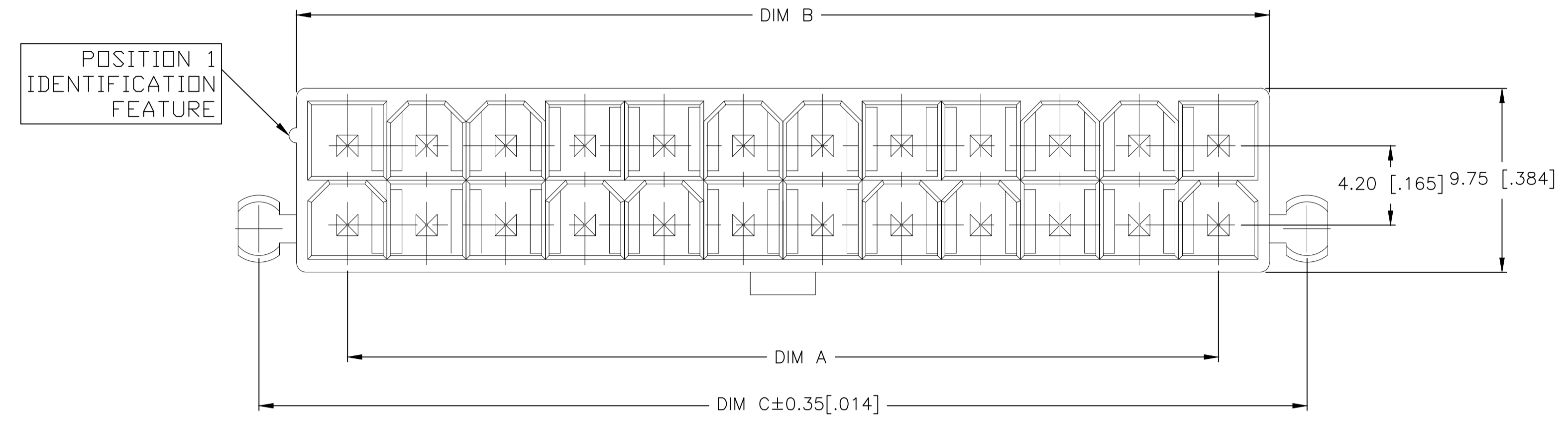

- 1 MATERIAL:  
HOUSING: POLYAMIDE, UL94V-0, NATURAL  
CONTACTS: HIGH PERFORMANCE COPPER ALLOY, TIN PLATED
- 2 GLOW WIRE APPROVED, CONTACT TE ENGINEERING FOR SPECIFICATION.
- 3 MATES WITH VAL-U-LOK(TM) RECEPTACLE HOUSINGS:  
X-1586019-X(UL94-V0)  
X-1586765-X(UL94-V2,GLOW WIRE)

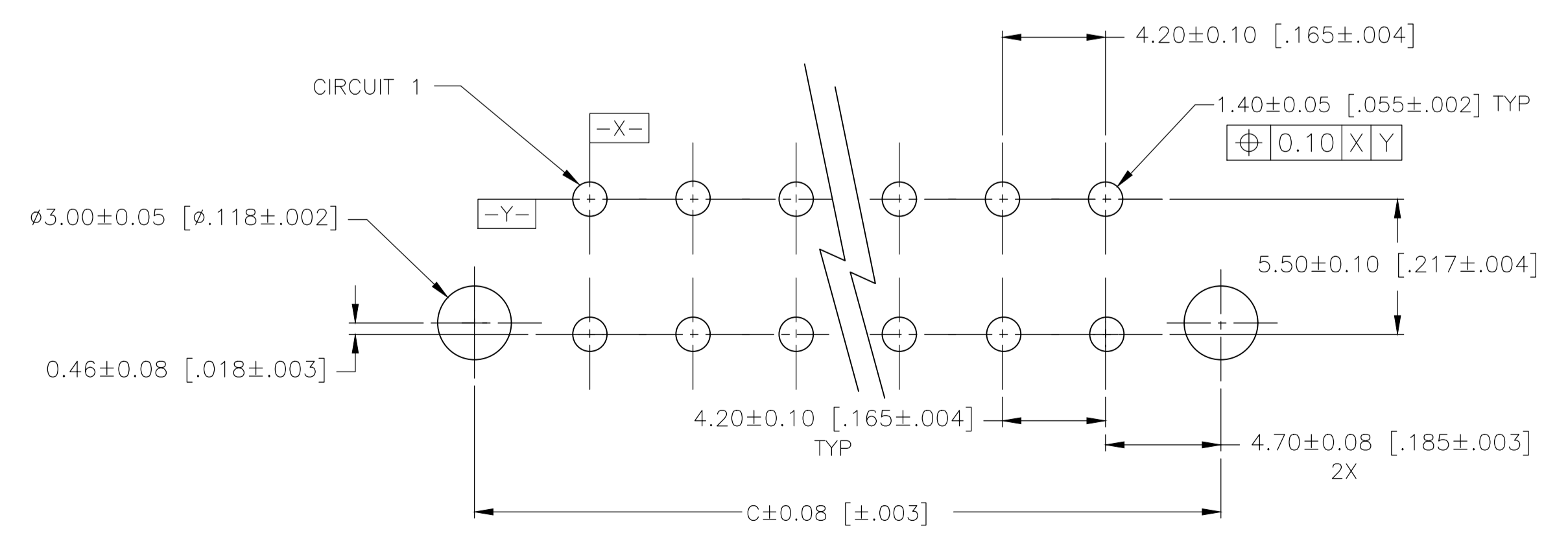
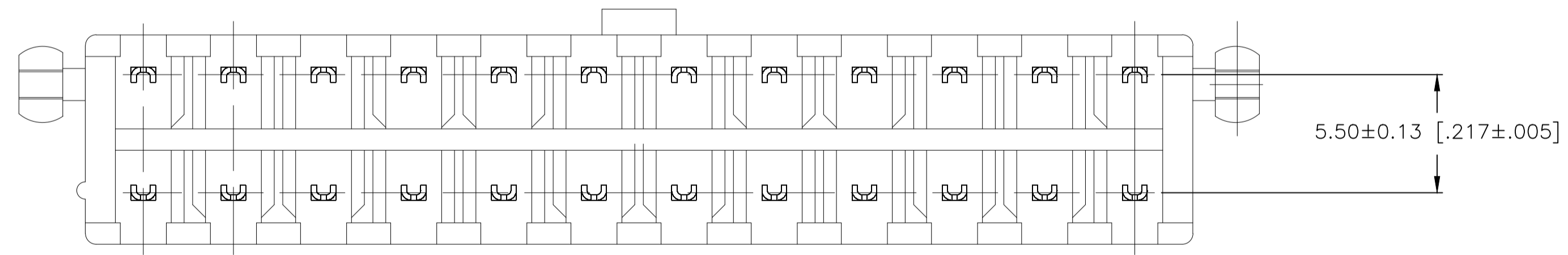
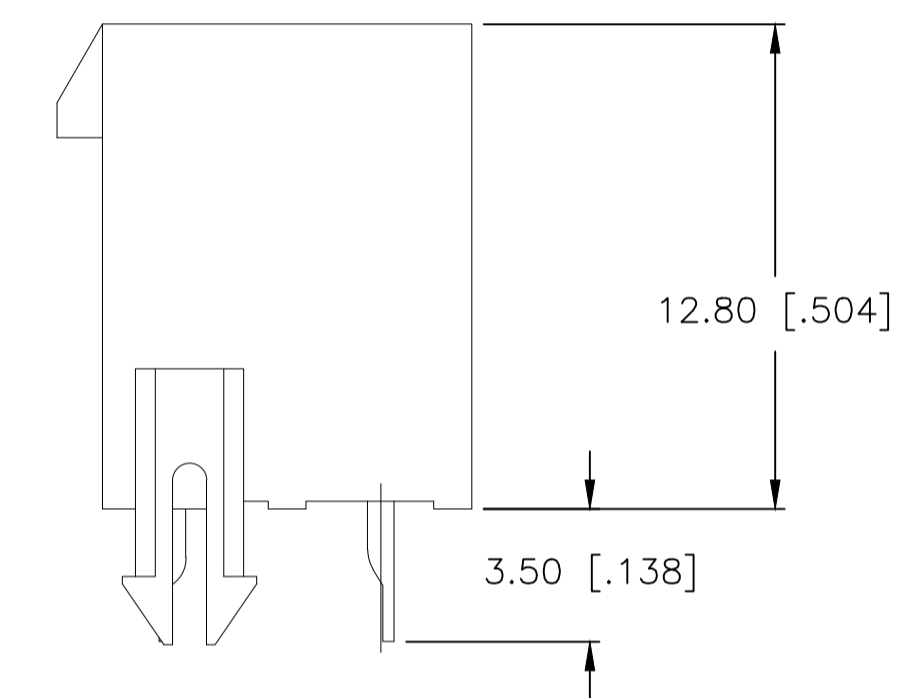
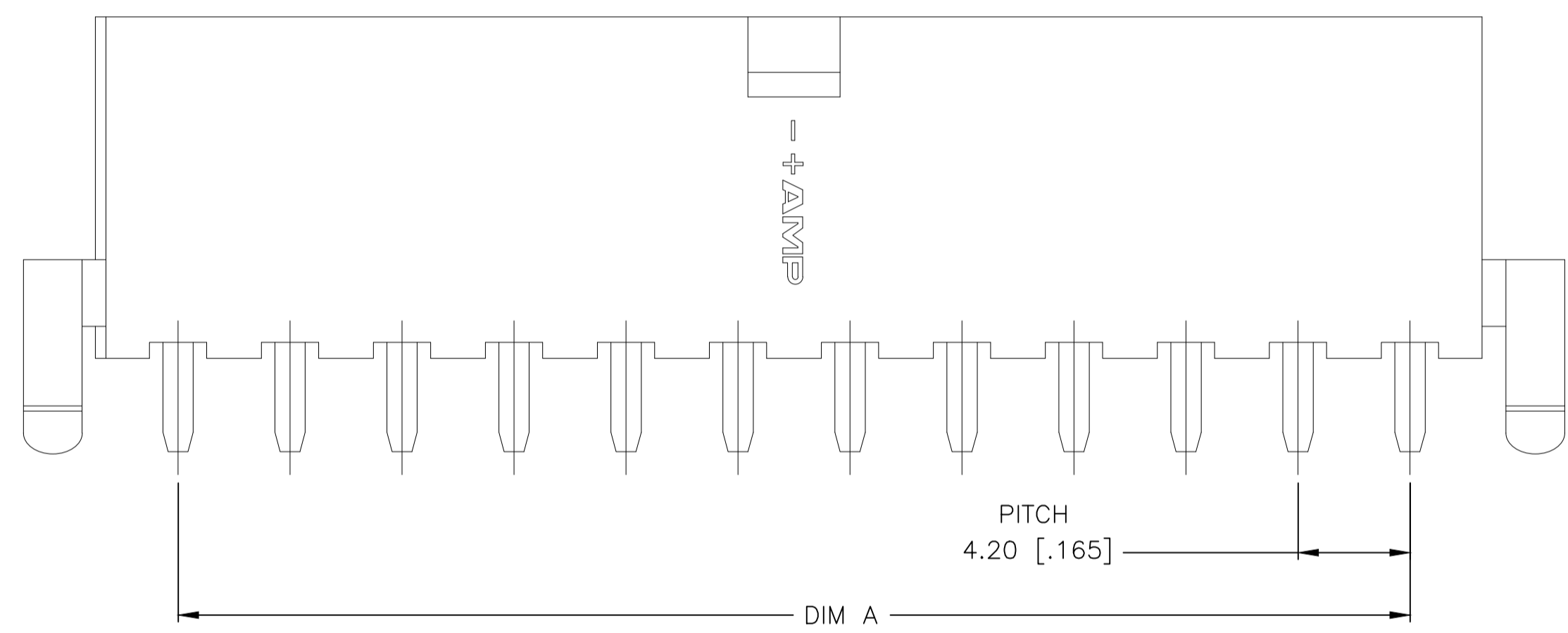
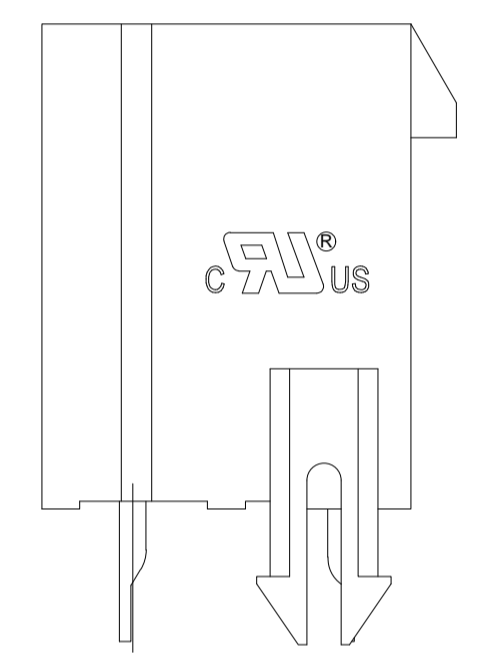

PCB LAYOUT: COMPONENT SIDE  
RECOMMENDED BOARD THICKNESS 1.78 [.070]

POS	DIM A	DIM B	DIM C	PART NUMBER
24	46.2 ± 0.2 [1.819 ± .008]	51.6 <sup>+0.5</sup> / <sub>0</sub> [2.031 <sup>+0.02</sup> / <sub>0</sub> ]	55.6 [2.189]	2-2825274-4
22	42.0 ± 0.2 [1.654 ± .008]	47.4 <sup>+0.5</sup> / <sub>0</sub> [1.866 <sup>+0.02</sup> / <sub>0</sub> ]	51.4 [2.024]	2-2825274-2
20	37.8 ± 0.2 [1.488 ± .008]	43.2 <sup>+0.5</sup> / <sub>0</sub> [1.701 <sup>+0.02</sup> / <sub>0</sub> ]	47.2 [1.858]	2-2825274-0
18	33.6 ± 0.2 [1.323 ± .008]	39.0 <sup>+0.5</sup> / <sub>0</sub> [1.536 <sup>+0.02</sup> / <sub>0</sub> ]	43.0 [1.693]	1-2825274-8
16	29.4 ± 0.2 [1.157 ± .008]	34.8 <sup>+0.5</sup> / <sub>0</sub> [1.370 <sup>+0.02</sup> / <sub>0</sub> ]	38.8 [1.528]	1-2825274-6
14	25.2 ± 0.2 [.992 ± .008]	30.6 <sup>+0.5</sup> / <sub>0</sub> [1.205 <sup>+0.02</sup> / <sub>0</sub> ]	34.6 [1.362]	1-2825274-4
12	21.0 ± 0.2 [.827 ± .008]	26.4 ± 0.2 [1.039 ± .008]	30.4 [1.197]	1-2825274-2
10	16.8 ± 0.1 [.661 ± .004]	22.2 ± 0.2 [.874 ± .008]	26.2 [1.031]	1-2825274-0
8	12.6 ± 0.1 [.496 ± .004]	18.0 ± 0.2 [.709 ± .008]	22.0 [.866]	2825274-8
6	8.4 ± 0.1 [.331 ± .004]	13.8 ± 0.2 [.543 ± .008]	17.8 [.701]	2825274-6
4	4.2 ± 0.1 [.165 ± .004]	9.6 ± 0.2 [.378 ± .008]	13.6 [.535]	2825274-4
2		5.4 ± 0.2 [.213 ± .008]	9.4 [.370]	2825274-2

THIS DRAWING IS A CONTROLLED DOCUMENT.

DIMENSIONS: mm [INCHES]

TOLERANCES UNLESS OTHERWISE SPECIFIED:

0 PL	±	
1 PL	±	0.5 [.02]
2 PL	±	0.25 [.010]
3 PL	±	
4 PL	±	
ANGLES	±	

MATERIAL: 1

FINISH:

WARREN HUO 15AUG2017  
DANIEL ZHANG 15AUG2017  
DANIEL ZHANG 15AUG2017

TE Connectivity

NAME: VERTICAL HEADER WITH PEGS, WITHOUT DRAIN HOLES, VAL-U-LOK(TM), HCS

PRODUCT SPEC: 108-150000

APPLICATION SPEC: 114-13172

SIZE: A1

SCALE: N/A

SHEET: 1 OF 2

REV: A1

REVISIONS				
#	LR	DESCRIPTION	DATE	OWN
-	-	SEE SHEET 1	-	-

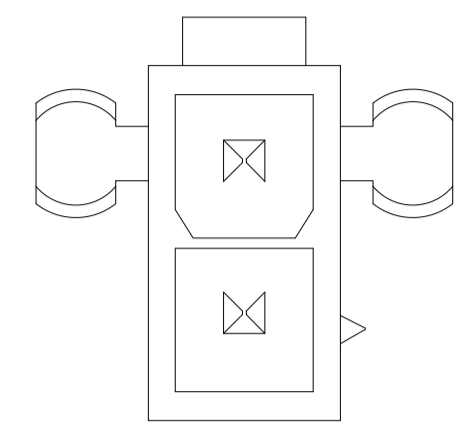

2825274-2

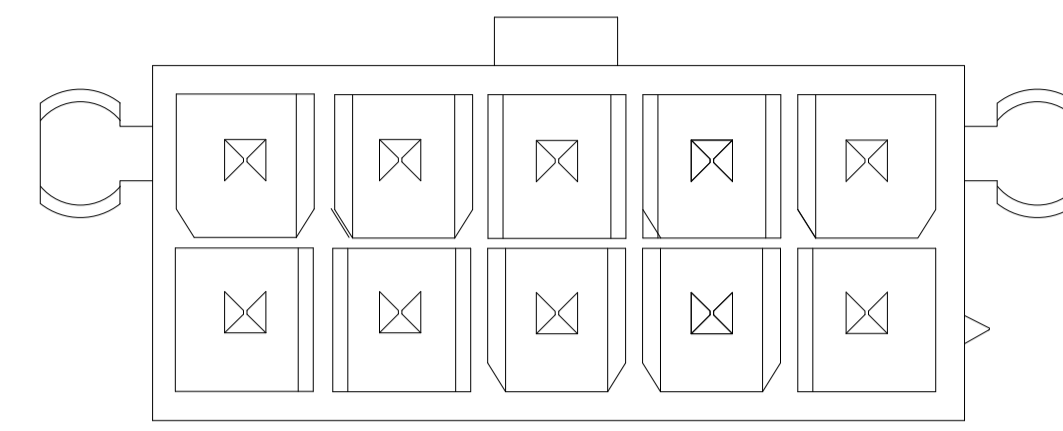

1-2825274-0

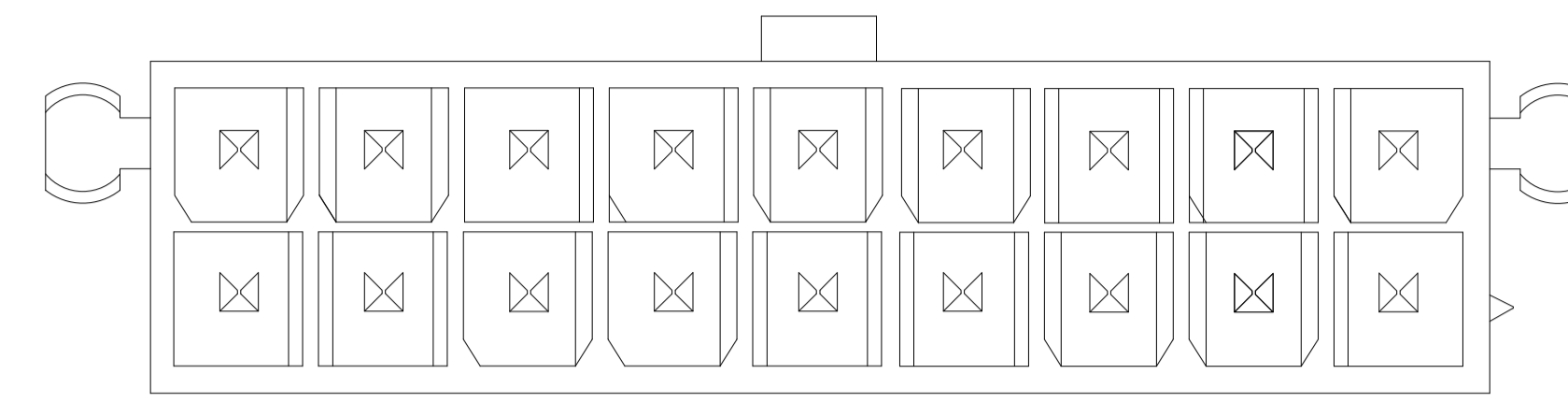

1-2825274-8

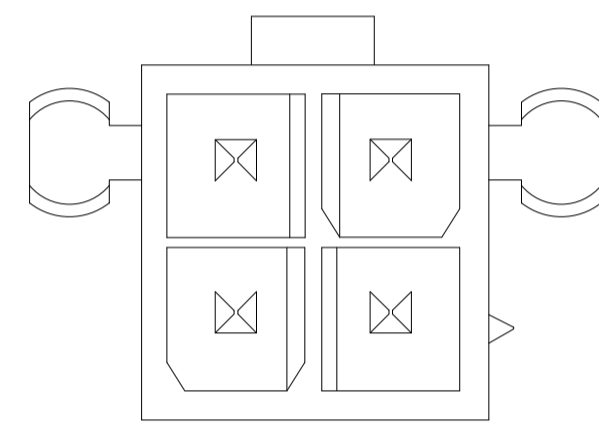

2825274-4

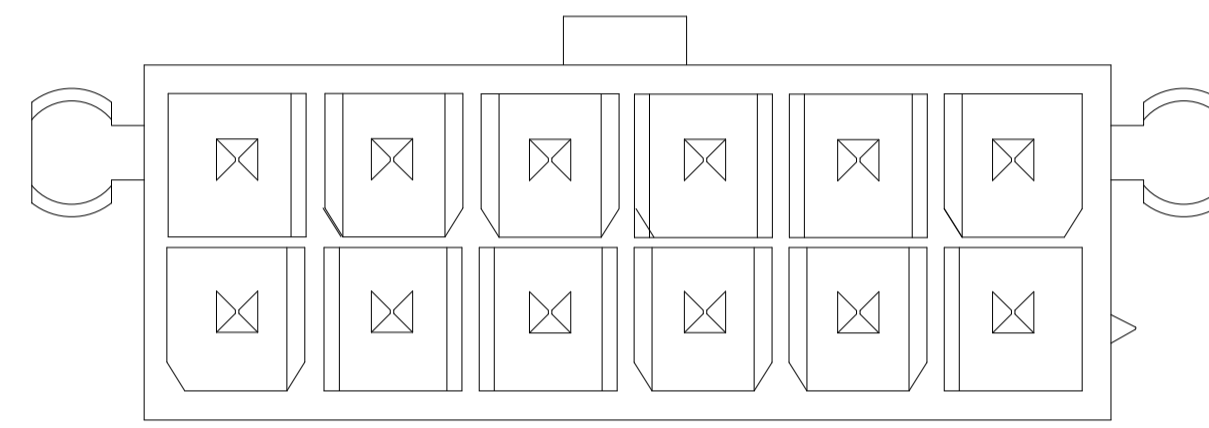

1-2825274-2

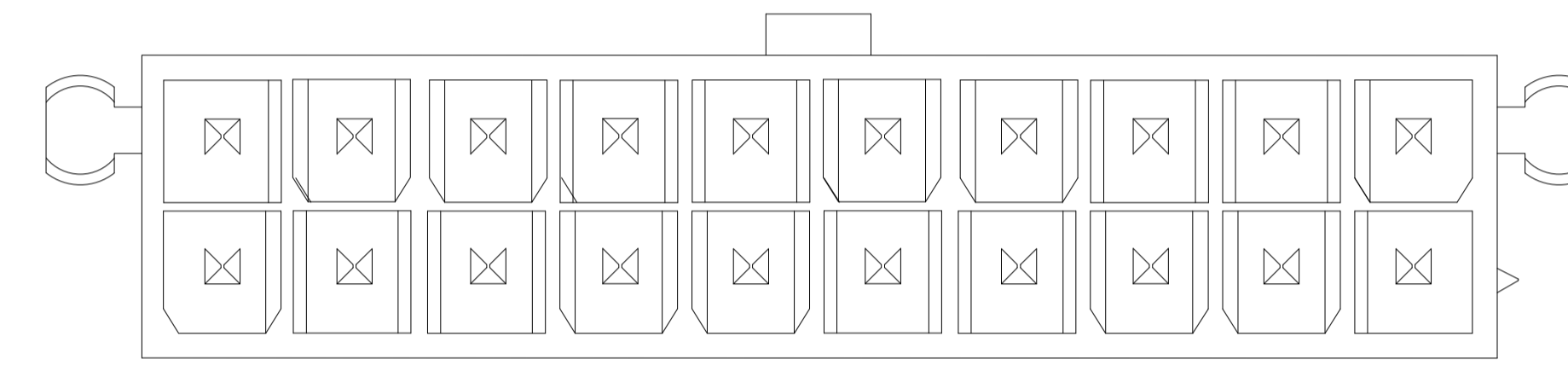

2-2825274-0

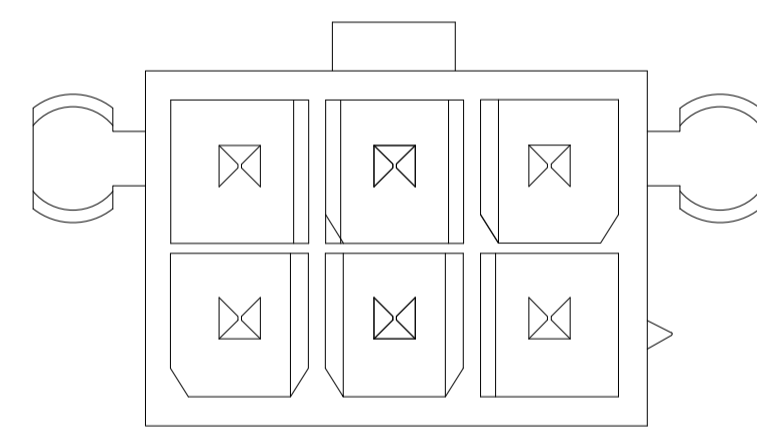

2825274-6

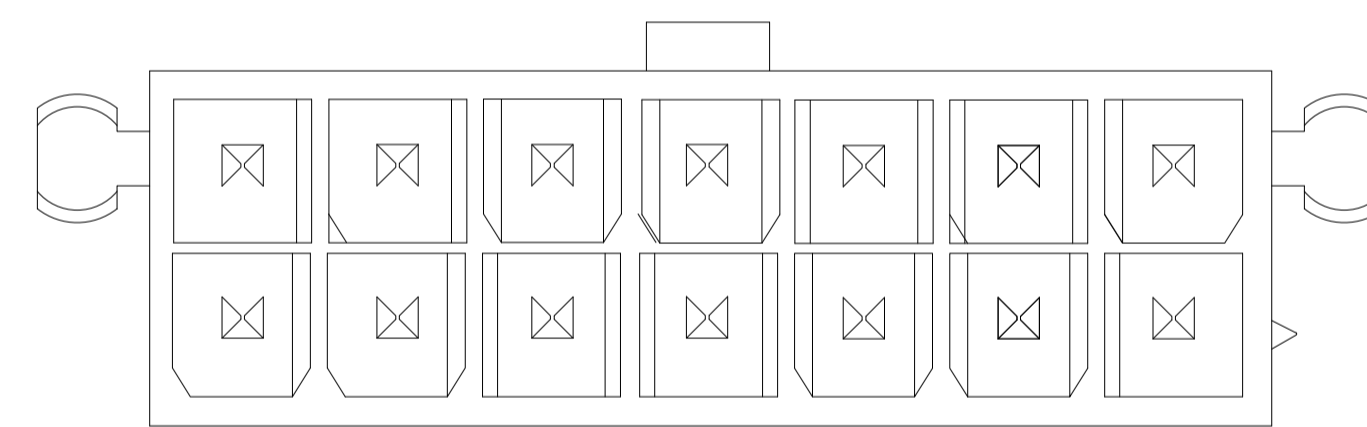

1-2825274-4

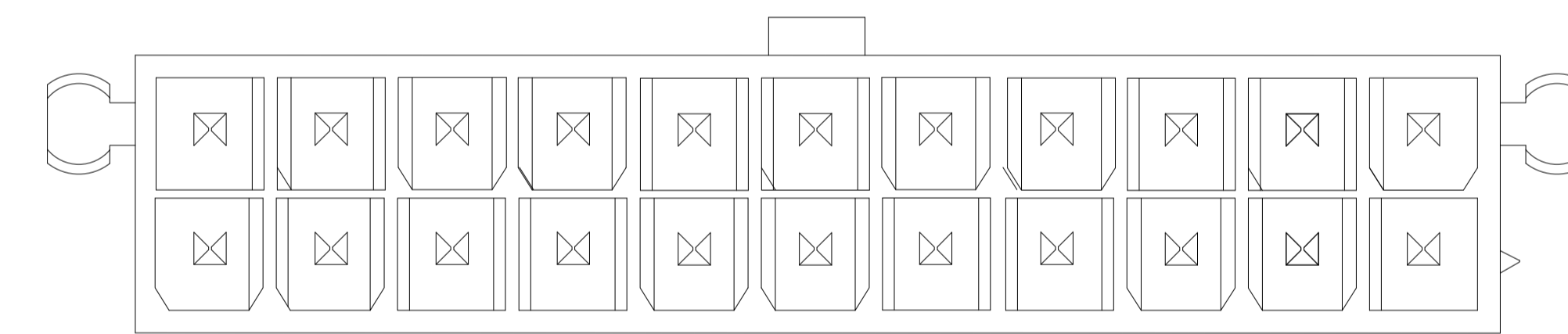

2-2825274-2

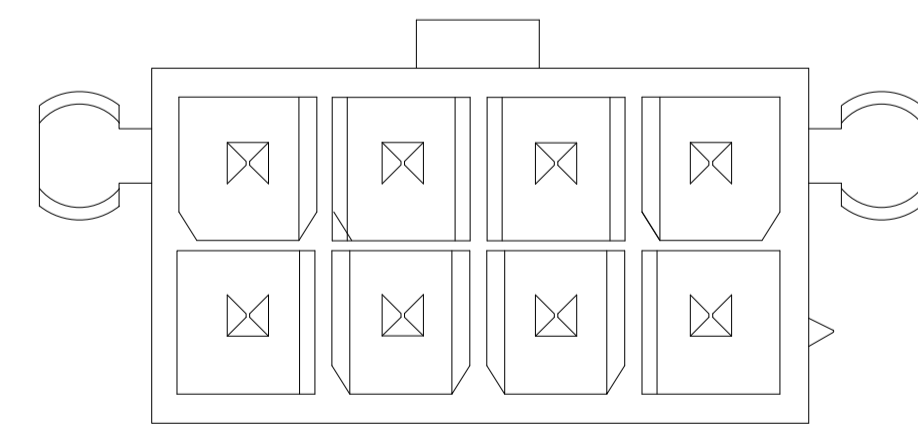

2825274-8

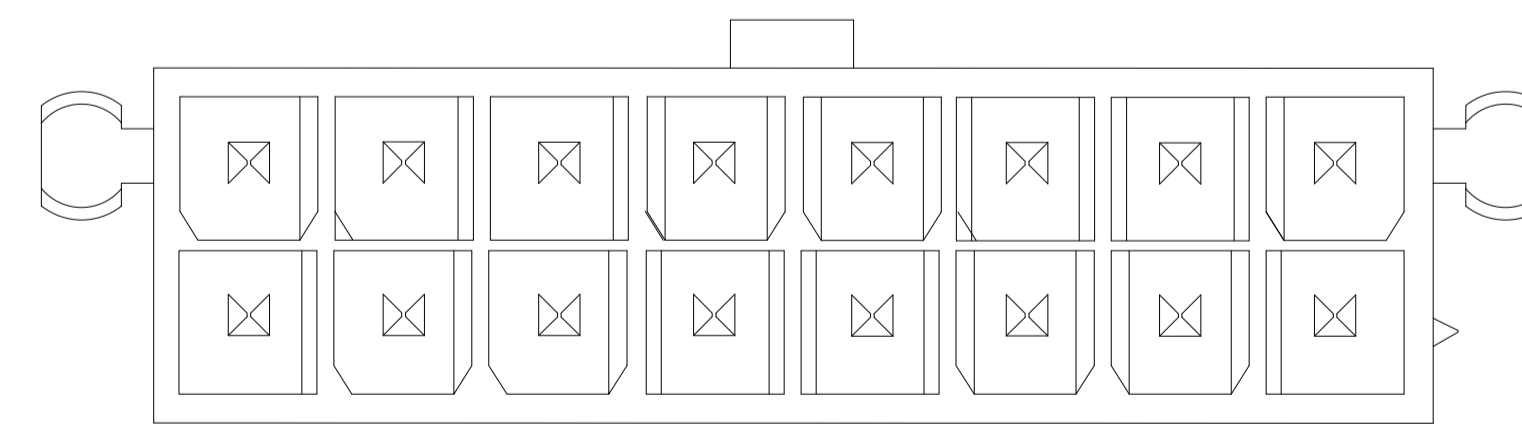

1-2825274-6

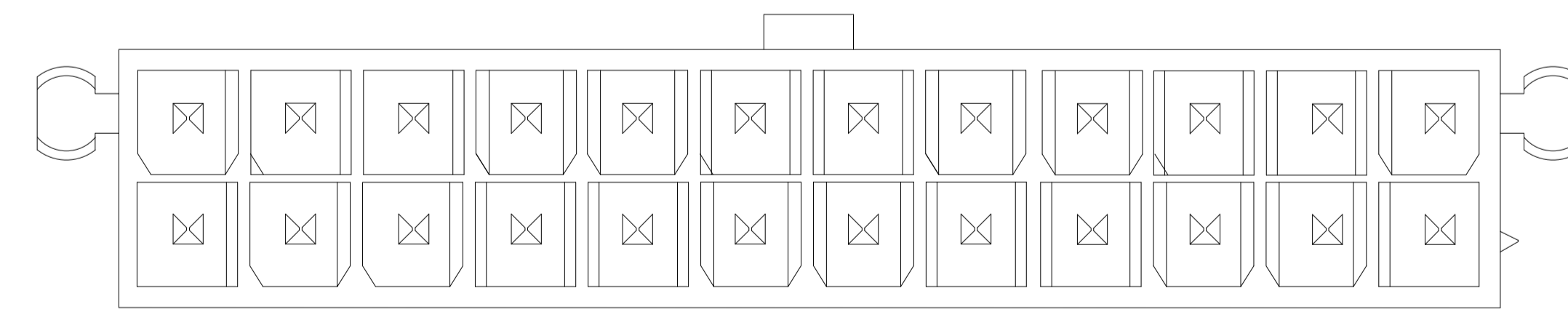

2-2825274-4

THIS DRAWING IS A CONTROLLED DOCUMENT.		DWN WARREN HUO 15AUG2017	TE Connectivity	
DIMENSIONS: mm [INCHES]		CHK DANIEL ZHANG 15AUG2017	NAME DANIEL ZHANG	
TOLERANCES UNLESS OTHERWISE SPECIFIED:		PRODUCT SPEC	108-150000	
0 PLC ±		APPLICATION SPEC	114-13172	
1 PLC ± 0.5 [02]		WEIGHT	A1 00779 ©=2825274	
2 PLC ± 0.25 [010]		CUSTOMER DRAWING	SCALE N/A SHEET 2 OF 2 REV A1	
3 PLC ±				
4 PLC ±				
ANGLES ±				
FINISH				

## X-ON Electronics

Largest Supplier of Electrical and Electronic Components

*Click to view similar products for [Power to the Board](#) category:*

*Click to view products by [TE Connectivity](#) manufacturer:*

Other Similar products are found below :

[10131318-08512GRLF](#) [6450171-4](#) [6450552-7](#) [6600323-8](#) [6643429-1](#) [6646040-2](#) [6651939-1](#) [6766604-1](#) [120959-1](#) [1393557-2](#) [1393532-2](#)  
[1393532-3](#) [1393532-4](#) [1393557-1](#) [1600812-5](#) [1-6450861-2](#) [1645595-1](#) [1743490-1](#) [1744132-7](#) [1761122-1](#) [1766169-1](#) [1766250-1](#) [18362](#)  
[1892109-1](#) [1-967627-6](#) [2226808-1](#) [2-6450860-5](#) [2-6450860-6](#) [2-6450870-0](#) [93003-0502](#) [953552-1](#) [1-6450161-4](#) [1-6450850-6](#) [1645526-2](#) [1-](#)  
[6600130-0](#) [1743419-1](#) [1766150-1](#) [2005243-2](#) [211110-1](#) [2-6600130-2](#) [TE34-12-16P-F0](#) [51700-10201602AALF](#) [5-6450830-6](#) [5646956-4](#)  
[36662-0005](#) [40585-3000](#) [4-6450830-9](#) [4-6600333-3](#) [51142-0214](#) [10125416-4050LF](#)