

REVISIONS					
P	LTR	DESCRIPTION	DATE	DWN	APVD
	E4	PART 3-284046-7 RELEASED FOR PRODUCTION	19FEB2019	RK	PS
	E5	3-2 TO 3-6 PART OBSOLETE	30AUG2020	DV	PS

1. MATERIALS AND FINISH  
HOUSING : PA 6-6, UL 94-V0, COLOR: GREEN.  
CAGE CLAMP : COPPER ALLOY, NICKEL PLATED.  
CONTACT SPRING : COPPER ALLOY, TIN PLATED.  
CLAMPING SCREW : M3, COPPER ALLOY, NICKEL PLATED.
2. MECHANICAL  
RECOMMENDED TIGHTENING TORQUE : 0.5 Nm  
WIRE STRIPPING LENGTH : 6 - 7.5 mm
3. ELECTRICAL  
WIRE RANGE : 12-30 AWG  
VOLTAGE RATING : 300 V  
CURRENT RATING : 15 A  
CONTACT RESISTANCE : <15 m Ohm  
INSULATION RESISTANCE : > 1000 M Ohm (500V DC)

- △4 NOT CUMULATIVE TOLERANCE.
- △6 WIRE ENTRY CLOSED
- △7 PRELIMINARY - NOT RELEASED FOR PRODUCTION
- △8 HOUSING: PA 6-6, UL 94-V0, COLOR:YELLOW

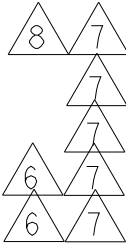
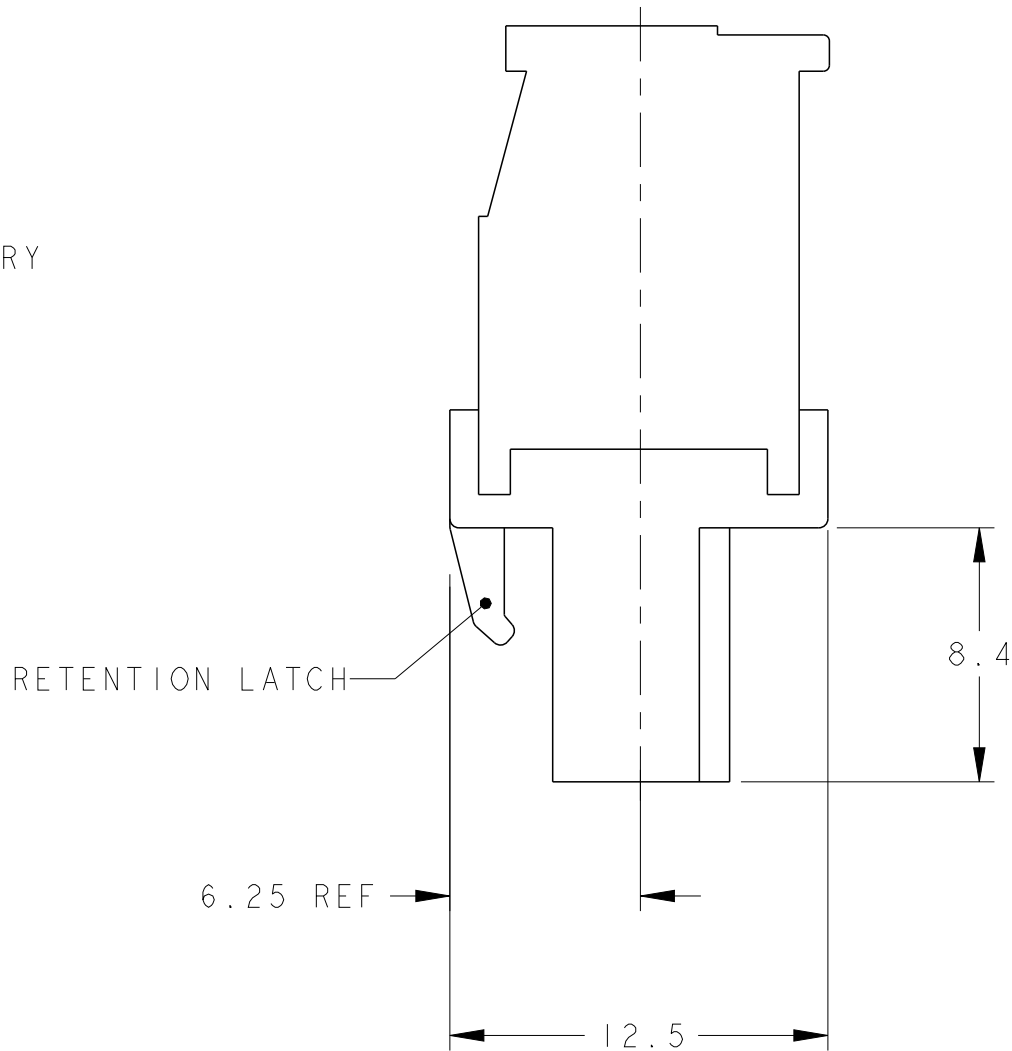
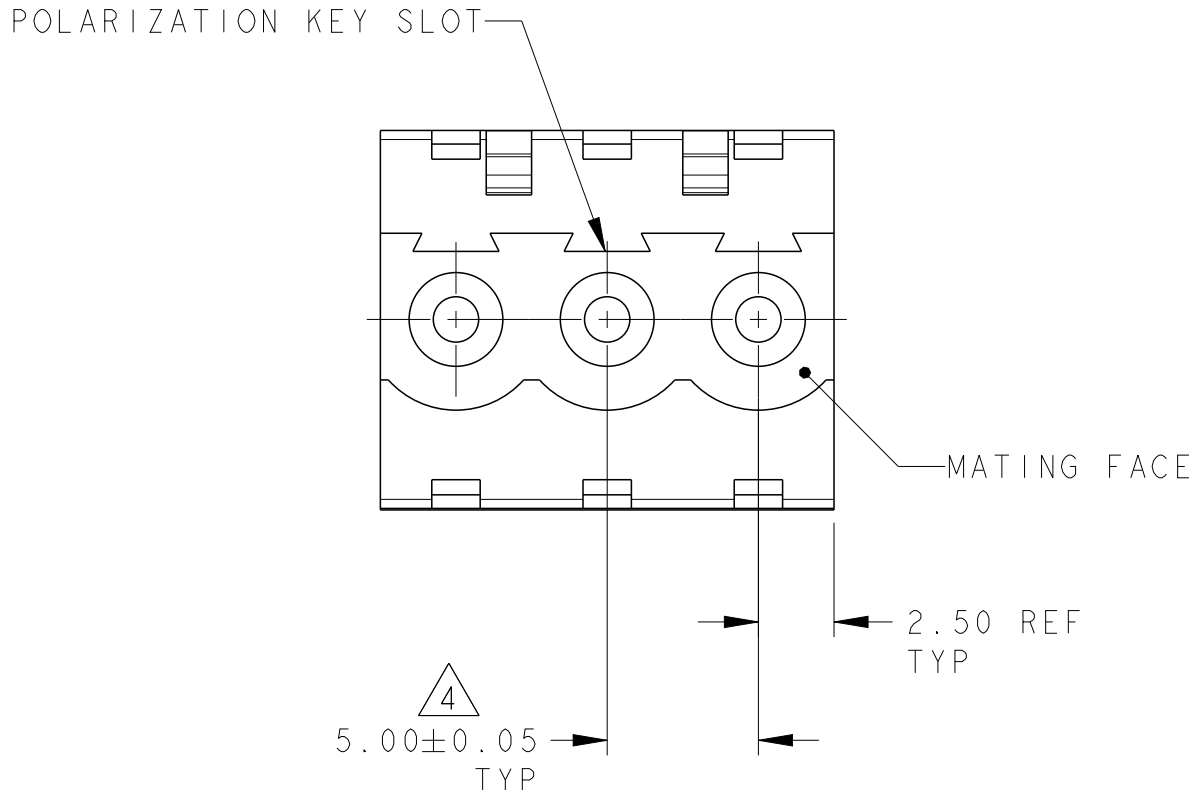
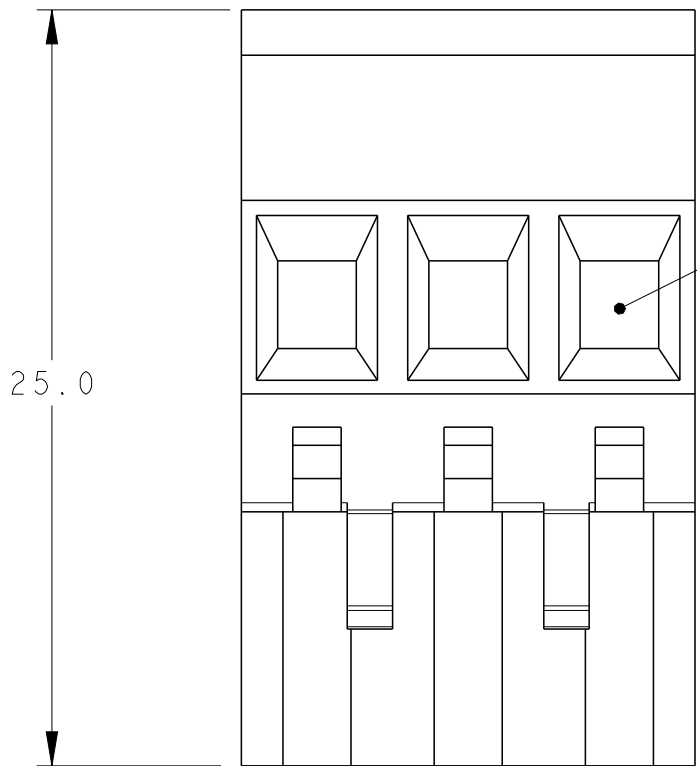
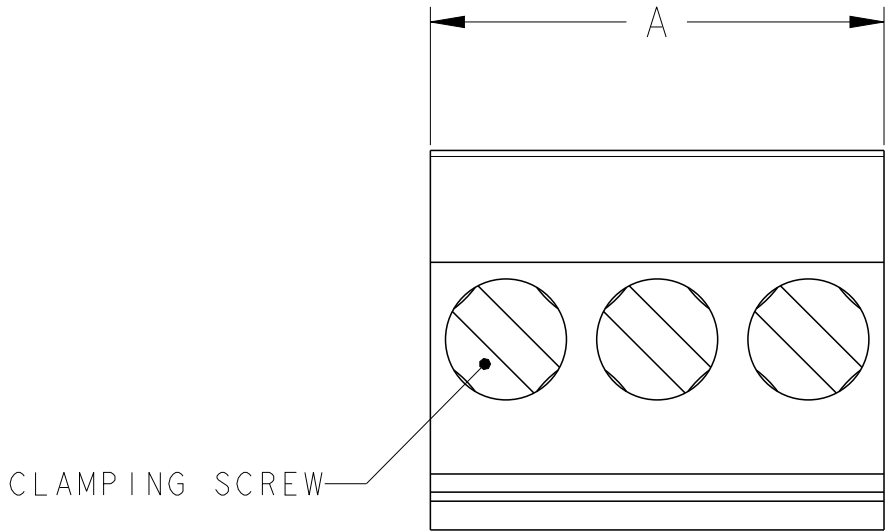

OBSOLETE

TIN PLATED	SEE SHEET 2	25.0	5	3-284046-7
TIN PLATED	-	15.0	3	3-284046-6
TIN PLATED	SEE SHEET 3	70.0	14	3-284046-5
TIN PLATED	SEE SHEET 3	50.0	10	3-284046-4
TIN PLATED	SEE SHEET 3	90.0	18	3-284046-3
TIN PLATED	SEE SHEET 3	80.0	16	3-284046-2
TIN PLATED	SEE SHEET 2	15.0	3	3-284046-1
0.00076[.000030] SELECT GOLD	SEE SHEET 2	10.0	2	3-284046-0
	SEE SHEET 2	25.0	5	2-284046-9
	-	25.0	5	2-284046-8
	SEE SHEET 2	65.0	13	2-284046-7
	SEE SHEET 2	40.0	8	2-284046-6
	-	125.0	25	2-284046-5
	-	120.0	24	2-284046-4
	-	115.0	23	2-284046-3
	-	110.0	22	2-284046-2
	-	105.0	21	2-284046-1
	-	100.0	20	2-284046-0
	-	95.0	19	1-284046-9
	-	90.0	18	1-284046-8
	-	85.0	17	1-284046-7
	-	80.0	16	1-284046-6
	-	75.0	15	1-284046-5
	-	70.0	14	1-284046-4
	-	65.0	13	1-284046-3
	-	60.0	12	1-284046-2
	-	55.0	11	1-284046-1
	-	50.0	10	1-284046-0
	-	45.0	9	284046-9
	-	40.0	8	284046-8
	-	35.0	7	284046-7
	-	30.0	6	284046-6
	-	25.0	5	284046-5
	-	20.0	4	284046-4
	-	15.0	3	284046-3
	-	10.0	2	284046-2
CONTACT FINISH	MARKING	A	NO OF POSN	PART NUMBER

THIS DRAWING IS A CONTROLLED DOCUMENT.

DIMENSIONS:  
mm

MATERIAL  
SEE NOTES

TOLERANCES UNLESS OTHERWISE SPECIFIED:  
0 PLC ±-  
1 PLC ±0.30  
2 PLC ±0.25  
3 PLC ±-  
4 PLC ±-  
ANGLES ±2°  
FINISH  
SEE NOTES

APVD  
C. RICHARD  
05FEB2003

PRODUCT SPEC  
-

APPLICATION SPEC  
-

WEIGHT  
-

NAME  
S. WELDON  
05FEB2003  
C. RICHARD  
05FEB2003

SIZE  
A2

CAGE CODE  
p0779

DRAWING NO  
C-284046

RESTRICTED TO

CUSTOMER DRAWING

SCALE 4:1

SHEET 1 OF 3

REV E5

TE Connectivity

TERMINAL BLOCK, VERTICAL PLUG, STACKING, RIGHT HAND, 5.00mm PITCH

1471-9 (3/13)

REVISIONS					
P	LTR	DESCRIPTION	DATE	DWN	APVD
	-	SEE SHEET 1	-	-	-

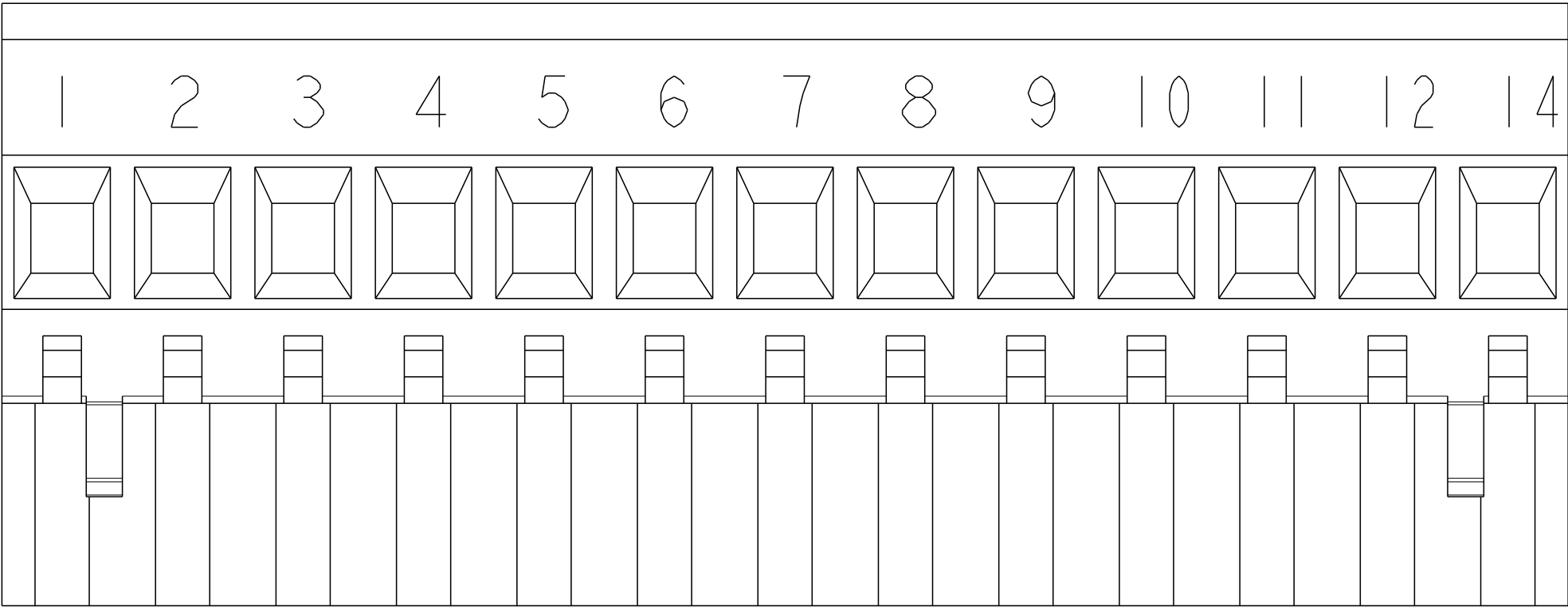

OBSOLETE ~~2-284046-7~~ AS SHOWN

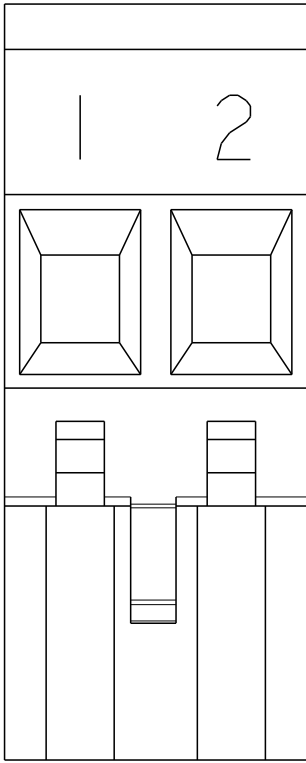

OBSOLETE ~~3-284046-0~~ AS SHOWN

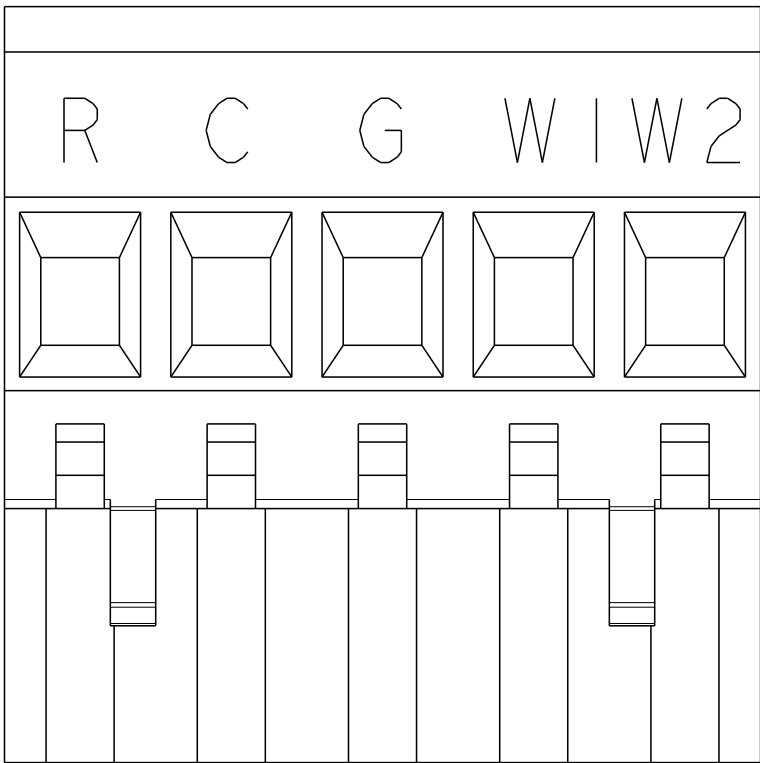

3-284046-7 AS SHOWN

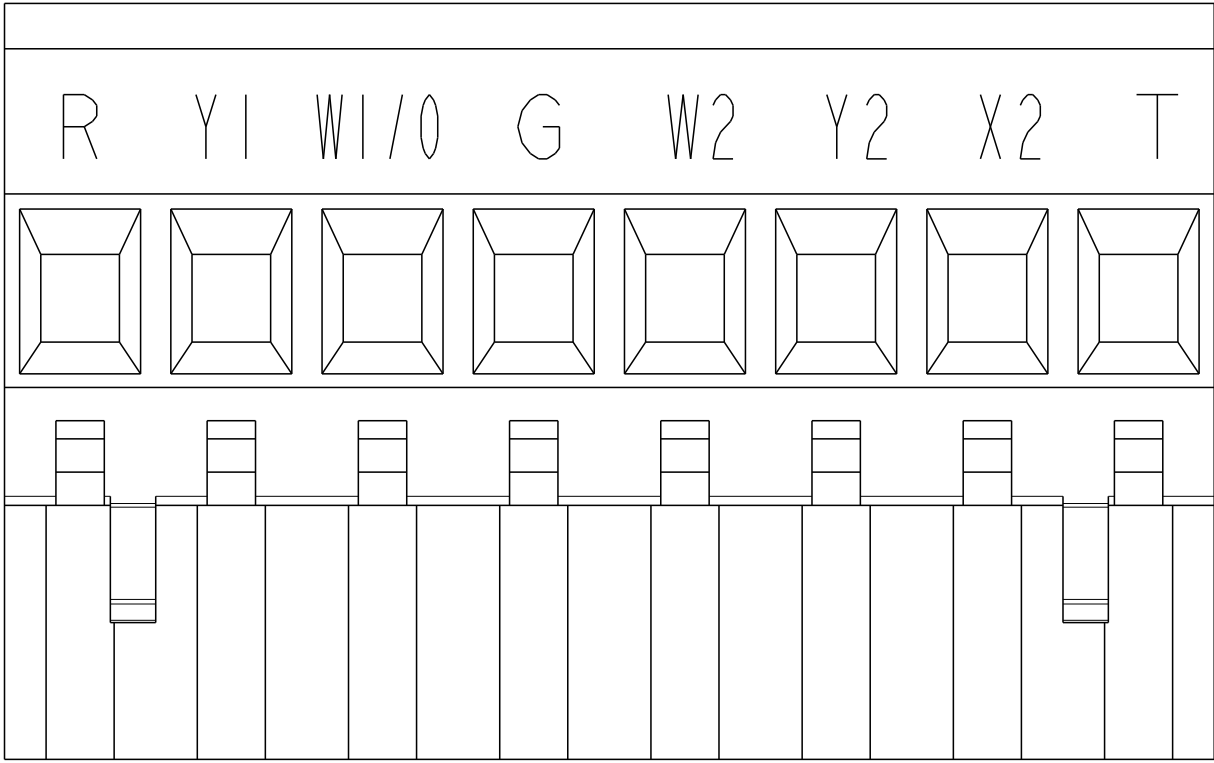

OBSOLETE ~~2-284046-6~~ AS SHOWN

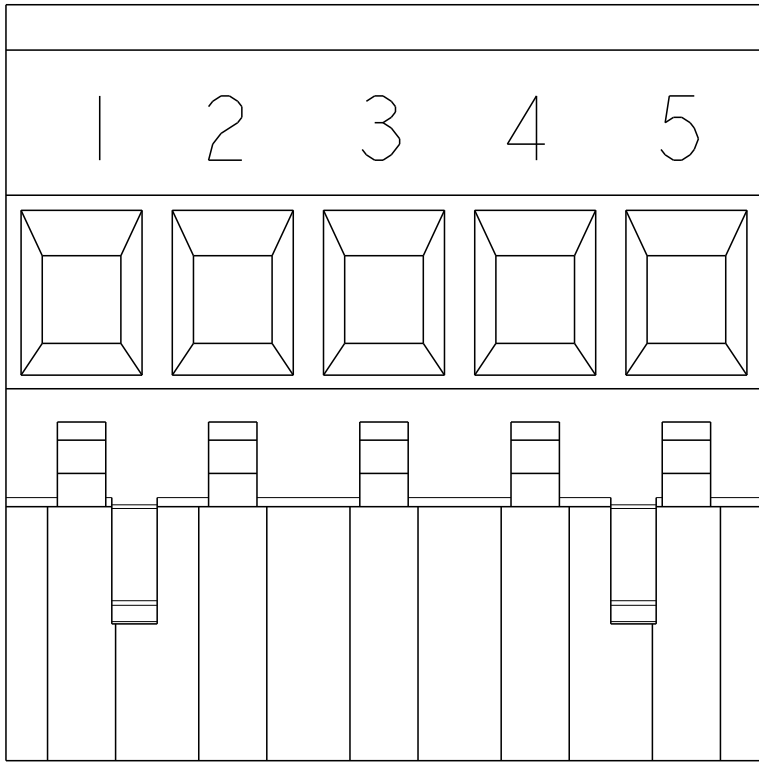

OBSOLETE ~~2-284046-9~~ AS SHOWN

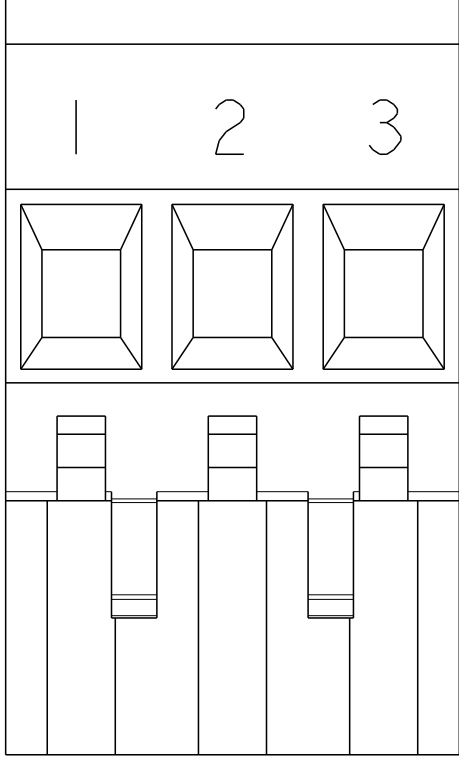

OBSOLETE ~~3-284046-1~~ AS SHOWN

THIS DRAWING IS A CONTROLLED DOCUMENT.

DIMENSIONS:  
mm

MATERIAL  
SEE NOTES

TOLERANCES UNLESS OTHERWISE SPECIFIED:

0 PLC ±-  
1 PLC ±0.30  
2 PLC ±0.25  
3 PLC ±-  
4 PLC ±-  
ANGLES ±2°  
FINISH

SEE NOTES

DWN S. WELDON 05FEB2003  
CHK C. RICHARD 05FEB2003  
APVD C. RICHARD 05FEB2003

PRODUCT SPEC  
APPLICATION SPEC  
WEIGHT -

CUSTOMER DRAWING

TE Connectivity

NAME  
TERMINAL BLOCK, VERTICAL PLUG, STACKING, RIGHT HAND, 5.00mm PITCH

SIZE  
A2

CAGE CODE  
b0779

DRAWING NO  
C-284046

RESTRICTED TO

SCALE 4:1  
SHEET 2 OF 3  
REV E5

REVISIONS					
P	LTR	DESCRIPTION	DATE	DWN	APVD
	-	SEE SHEET 1	-	-	-

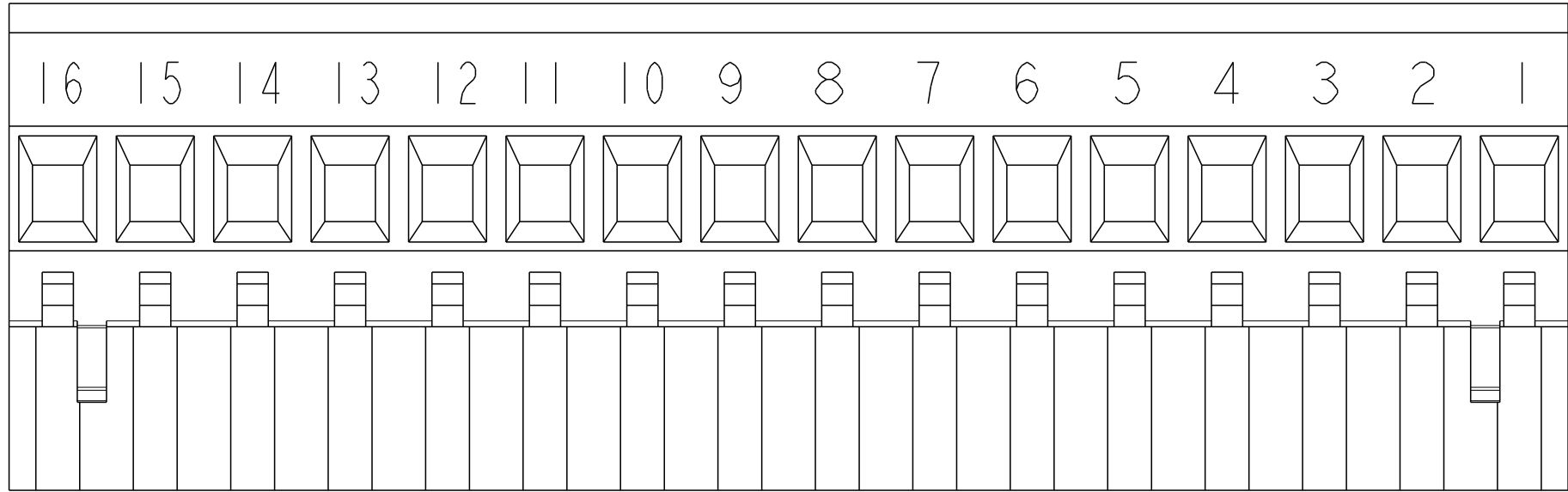

OBSOLETE ~~3-284046-2~~ AS SHOWN

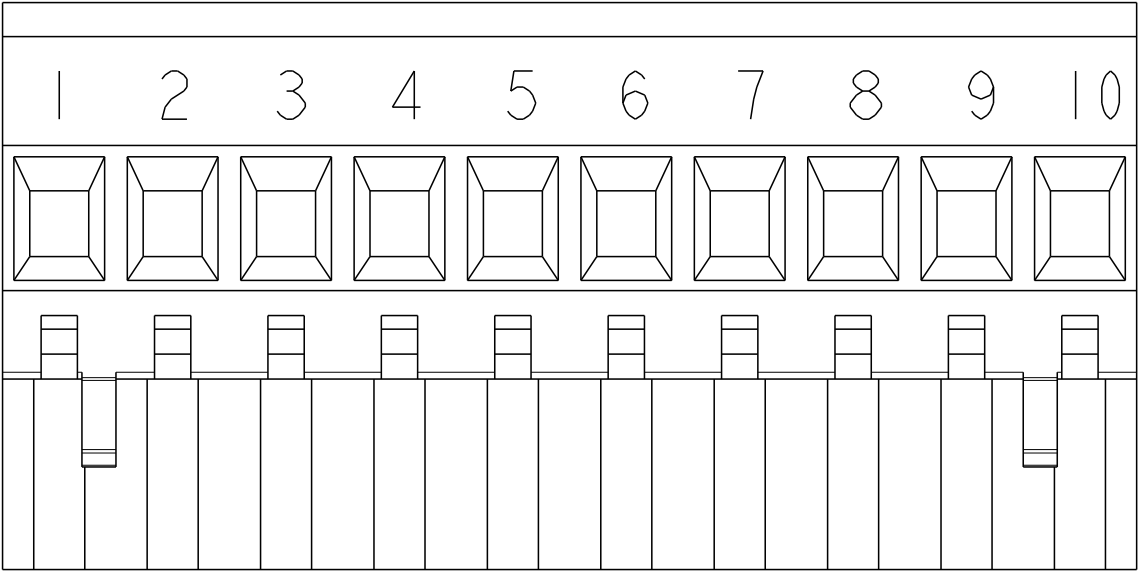

OBSOLETE ~~3-284046-4~~ AS SHOWN

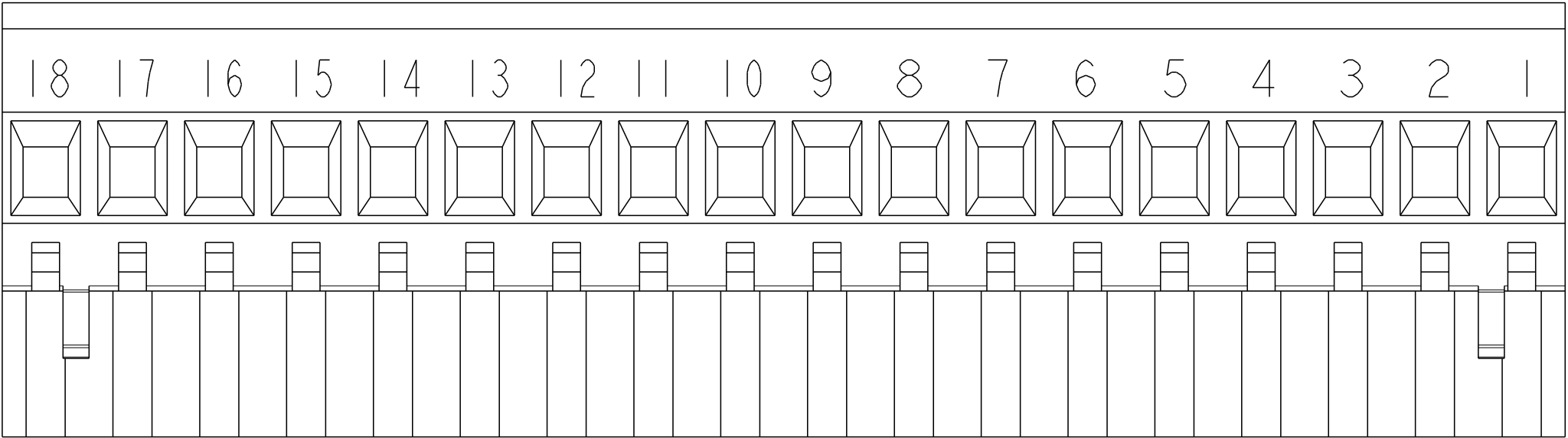

OBSOLETE ~~3-284046-3~~ AS SHOWN

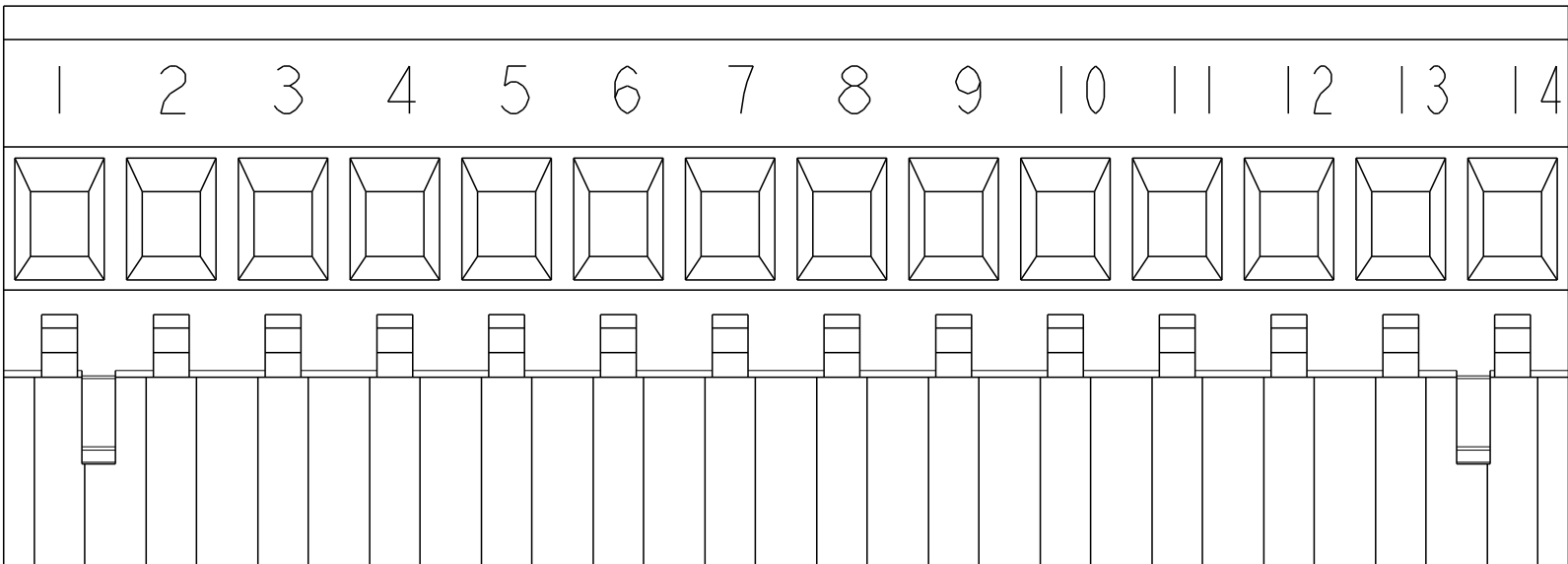

OBSOLETE ~~3-284046-5~~ AS SHOWN

THIS DRAWING IS A CONTROLLED DOCUMENT.

DIMENSIONS:  
mm

MATERIAL  
SEE NOTES

TOLERANCES UNLESS OTHERWISE SPECIFIED:

0 PLC ±  
1 PLC ±0.30  
2 PLC ±0.25  
3 PLC ±  
4 PLC ±  
ANGLES ±2°  
FINISH

SEE NOTES

DWN S. WELDON 05FEB2003  
CHK C. RICHARD 05FEB2003  
APVD C. RICHARD 05FEB2003

PRODUCT SPEC  
APPLICATION SPEC  
WEIGHT -

CUSTOMER DRAWING

TE Connectivity

NAME  
TERMINAL BLOCK, VERTICAL PLUG,  
STACKING, RIGHT HAND,  
5.00mm PITCH

SIZE  
A2

CAGE CODE  
b0779

DRAWING NO  
C-284046

RESTRICTED TO

SCALE 4:1  
SHEET 3 OF 3  
REV E5

## X-ON Electronics

Largest Supplier of Electrical and Electronic Components

*Click to view similar products for [Pluggable Terminal Blocks](#) category:*

*Click to view products by [TE Connectivity](#) manufacturer:*

Other Similar products are found below :

[57.510.0053](#) [MC 1.5/ 6-ST-3.5 GY AU](#) [734-104](#) [734-302](#) [8-141-P](#) [8426620000](#) [860505](#) [860516](#) [860810](#) [GBPACX-12](#) [93.731.4953.0](#) [PV05-5,08-K](#) [PVP03-3,50](#) [PVP04-3,50](#) [PVS02-5,00](#) [1-1986160-3](#) [1377680000](#) [1531000000](#) [1546228-5](#) [ELFH16150](#) [ELFP03110](#) [ELFP10210](#) [ELFT06250](#) [ELVP03100](#) [1700101](#) [1700410](#) [1700425](#) [1702246](#) [1705229](#) [1710175](#) [1714537](#) [1717806](#) [1719600](#) [1728941](#) [1734692](#) [1734795](#) [1736036](#) [1740194](#) [1740291](#) [1740628](#) [1740990](#) [1746952](#) [1750207](#) [1752441](#) [1752865](#) [1754115](#) [1754144](#) [1756913](#) [1760051](#) [1760336](#)