

P	LTR	DESCRIPTION	DATE	DWN	APVD
	B1	REDRAWN PER ECR 09-016745	28JUL09	JR	TM
	B2	REVISED PER ECO-17-007400	27NOV2017	RS	DR

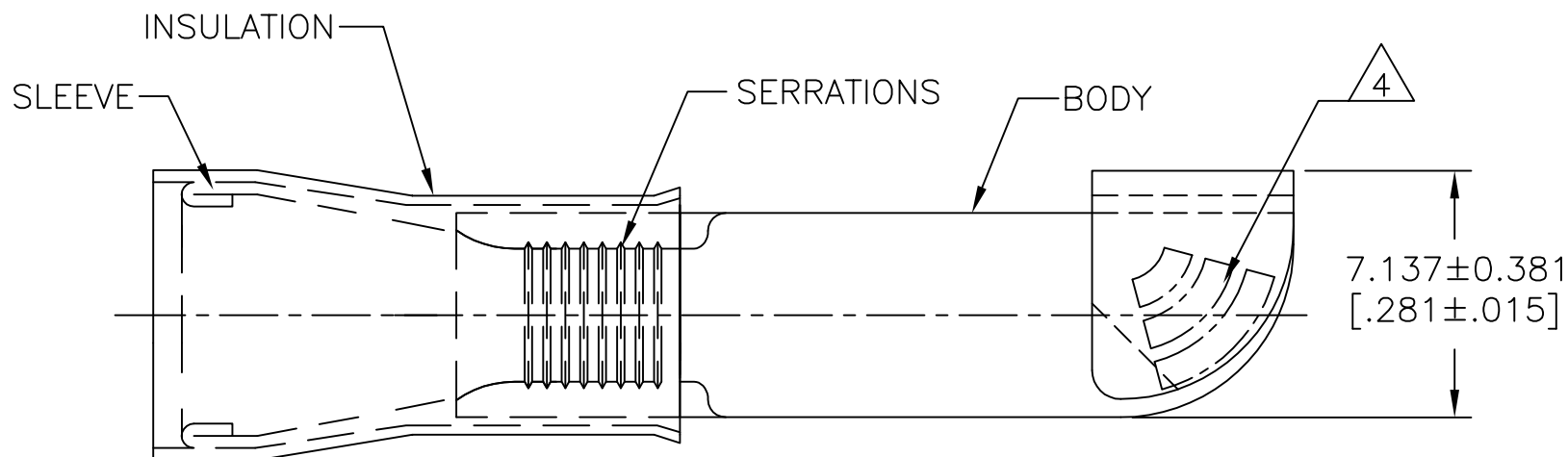

<b>AMP</b> WIRE RANGE	<b>RU</b> FILE E13288
12-10 AWG STRANDED	12-10 AWG STRANDED

- 1 WIRE INSUL  $\phi$ 3.810-5.842 [ $\phi$ .150-.230]
- 2 MATERIAL: BODY - CU PER ASTM B152  
SLEEVE - CU PER ASTM B152  
INSULATION - NYLON ASTM D4066 TYPE 1.
- 3 FINISH: BODY & SLEEVE: TIN PER ASTM B-545  
INSULATION - COLOR: YELLOW.
- 4 STAMP AMP 12-10\* 6-9 APPROX AS SHOWN.

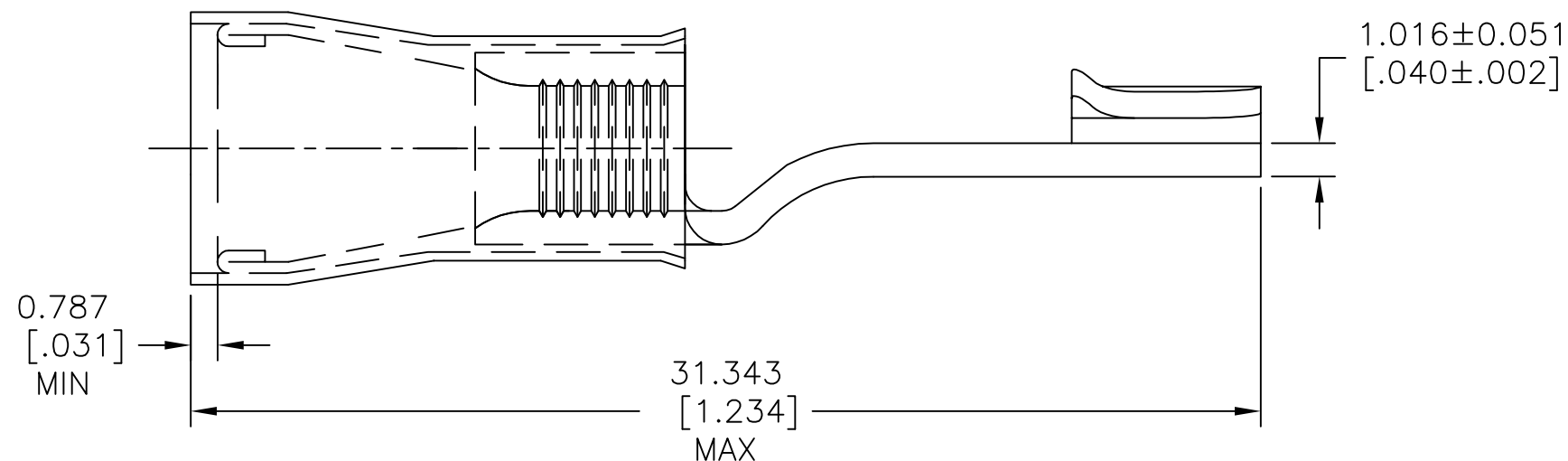

500	LOOSE PIECE	320620
QTY	PACKAGE TYPE	PART NO

MAX RECOMMENDED OPERATING TEMPERATURE: 105°C [221°F]  VOLTAGE RATING: 300 V MAX  CIRCULAR MIL AREA: 2.62-6.64mm <sup>2</sup> [5,180-13,100] STRANDED	THIS DRAWING IS A CONTROLLED DOCUMENT.		DWN jr_ruth 12JUN09	TE Connectivity  NAME TERMINAL, PIDG, KNIFE DISCONNECT, WIRE SIZE: 12-10					
	DIMENSIONS: mm [INCHES]	TOLERANCES UNLESS OTHERWISE SPECIFIED:	CHK TOM MICHIELUTTI 12JUN09						
	MATERIAL	FINISH	APVD TOM MICHIELUTTI 12JUN09	PRODUCT SPEC UL 486A-B	SIZE	CAGE CODE	DRAWING NO	RESTRICTED TO	
			APPLICATION SPEC 114-2157	A3	00779	C=320620			
			WEIGHT -	CUSTOMER DRAWING			SCALE 5:1	SHEET 1 OF 1	REV B2

## X-ON Electronics

Largest Supplier of Electrical and Electronic Components

*Click to view similar products for [Terminals](#) category:*

*Click to view products by [TE Connectivity](#) manufacturer:*

Other Similar products are found below :

[00-054007-01074-6](#) [00-054007-70206-1](#) [00-054007-70210-8](#) [00-054007-70217-7](#) [00-054007-70226-9](#) [00-054007-70228-3](#) [00-054007-70248-1](#) [00-054007-70256-6](#) [00-054007-70301-3](#) [00-054007-70316-7](#) [00-054007-49560-4](#) [00-054007-70209-2](#) [00-054007-70225-2](#) [00-054007-70227-6](#) [00-054007-70231-3](#) [00-054007-70241-2](#) [00-054007-70242-9](#) [00-054007-70244-3](#) [00-054007-70246-7](#) [00-054007-70263-4](#) [00-054007-70288-7](#) [00-054007-70290-0](#) [00-054007-70300-6](#) [00-054007-70304-4](#) [01-2065-1-0216](#) [01-2900-1-04412](#) [00581P0075](#) [600TS-10](#) [60205-1](#) [604200-1](#) [605601-1](#) [60598-1-CUT-TAPE](#) [61314-6-C](#) [61810-3](#) [61-S](#) [61-SN](#) [626-0194](#) [62-NBM-A](#) [62-SN](#) [62-SP](#) [63-S](#) [640179-1](#) [M55155/059I03](#) [M55155/079C01](#) [M55155/099H02](#) [M55155/109H01](#) [M55155/109H02](#) [M55155/12XH05](#) [M55155/16XH02](#) [M55155/29-5S](#)