

THIS DRAWING IS UNPUBLISHED. RELEASED FOR PUBLICATION ,19 .
 © COPYRIGHT 19 BY AMP INCORPORATED. ALL RIGHTS RESERVED.

| LOC | DIST | REVISIONS | | | |
|-----|------|-------------|--------------------------|---------|-------|
| P | LTR | DESCRIPTION | DATE | DWN | APVD |
| G | 14 | F | REDRAWN PER 0720-0377-94 | 25OCT94 | LO ME |

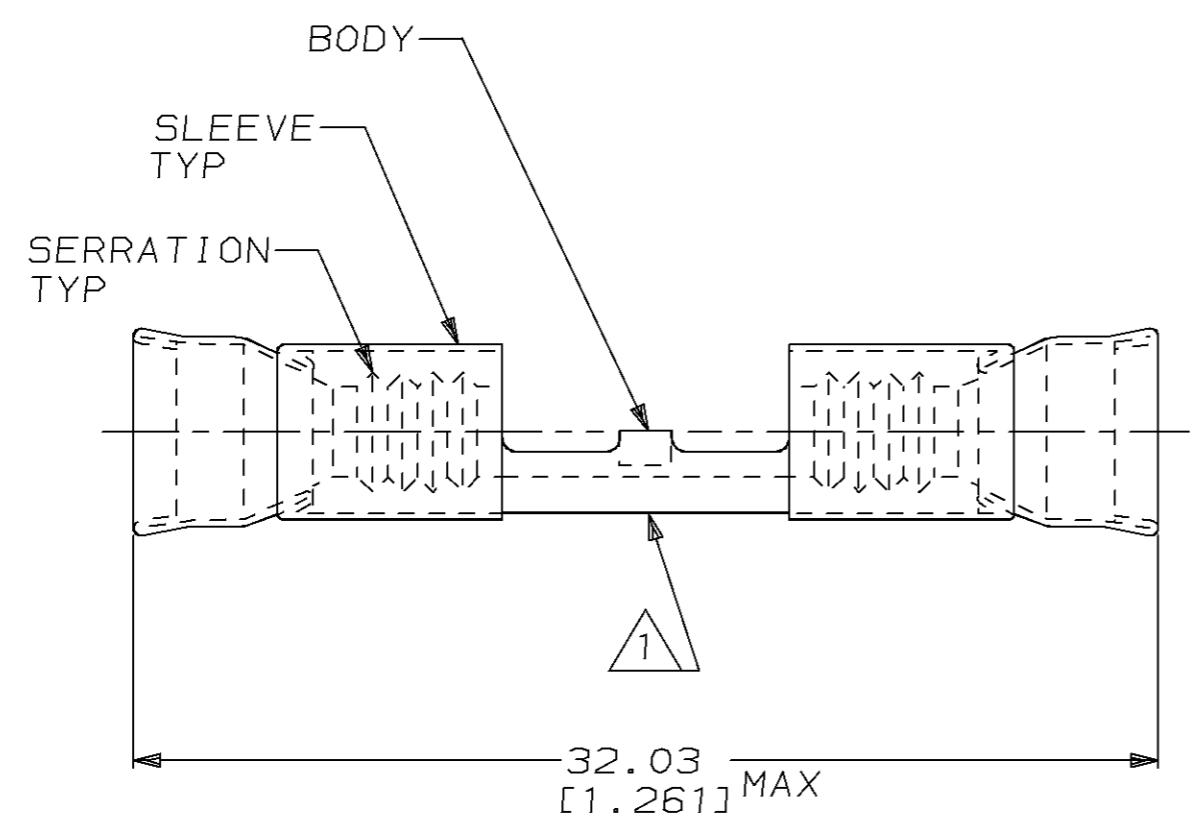

△ 1 STAMP AMP 12-10 APPROX AS SHOWN

- 2. WIRE INSUL DIA, 3.81-5.84 [.150-.230]
- 3. TONGUE MATL THK, 1.02±0.05 [.040±.002]

| | | |
|-----|--------------|---------|
| 500 | LOOSE PIECE | 323699 |
| QTY | PACKAGE TYPE | PART NO |

| | | | | | | | |
|--|--|---|--|--|--|---|-----------------------------|
| AMP INCORPORATED CUSTOMER SERVICE SYSTEM | | MAX RECOMMENDED OPERATING TEMPERATURE: 649°C [1200°F] | THIS DRAWING IS A CONTROLLED DOCUMENT FOR AMP INCORPORATED. IT IS SUBJECT TO CHANGE AND THE CONTROLLING ENGINEERING ORGANIZATION SHOULD BE CONTACTED FOR THE LATEST REVISION. | | DWN L OLMEDA 25OCT94 | AMP AMP Incorporated Harrisburg, PA 17105-3608 | |
| FOR ADDITIONAL PRODUCT INFORMATION OR COPIES OF DRAWINGS AND TECHNICAL DOCUMENTS | PRODUCT INFORMATION CENTER 1-800-522-6752 | | VOLTAGE RATING: - | DIMENSIONS: mm [in] | TOLERANCES UNLESS OTHERWISE SPECIFIED: | | CHK M ELLIS 25OCT94 |
| FOR APPLICATION TOOLING INFORMATION | TOOLING ASSISTANCE CENTER 1-800-722-1111 | CIRCULAR MIL AREA: 2.62mm ² -6.64mm ² [5180-13100] | | 0 PLC ±- | 1 PLC ±- | 2 PLC ±0.20 [.008] | APVD S BORTNER 25OCT94 |
| FOR ORDER ENTRY | 1-800-526-5142 | STRANDED WIRE | | MATERIAL BODY, NI PER ASTM B162 SLEEVE, NI SIL PER ASTM B122 | 3 PLC ±- | 4 PLC ±- | FINISH SLV COLOR, ORANGE |
| | | | | | APPLICATION SPEC - | NAME WIRE SPLICE, STRATOTHERM DIAMOND GRIP, WIRE SIZE, 12-10 AWG | |
| | | | | | WEIGHT - | SIZE A3 | |
| | | | | | CUSTOMER DRAWING | CAGE CODE 00779 | |
| | | | | | SCALE 4:1 | DRAWING NO C-323699 | |
| | | | | | SHEET 1 OF 1 | REV F | |

X-ON Electronics

Largest Supplier of Electrical and Electronic Components

Click to view similar products for [Terminals](#) category:

Click to view products by [TE Connectivity](#) manufacturer:

Other Similar products are found below :

[HT-13-10](#) [71M-250-32-NB](#) [01-2065-1-0216](#) [00581P0075](#) [M10-10RX](#) [M10BCK](#) [60205-1](#) [604200-1](#) [60598-1-CUT-TAPE](#) [60617-1-C](#) [60873-1](#) [M14-516R/SK](#) [M14-6RSX](#) [M18-8FBX](#) [M18-8R/LX](#) [M18BCK](#) [61314-6-C](#) [61-S](#) [61-SN-A](#) [62-NBM-A](#) [63-S](#) [640179-1](#) [640917-2-CUT-TAPE](#) [6501550002](#) [66107-2-C](#) [696683-1](#) [696834-1](#) [696861-1](#) [696931-1](#) [696999-1](#) [M8-516RK](#) [M86700006](#) [MA250DMFMX-A](#) [701-2007](#) [701-2307](#) [701-7761-03](#) [70F-110-32-PB](#) [718-N-A](#) [71M-187-20-NBL](#) [71M-250-32-NBL](#) [72F-187-20-NBL](#) [72M-250-32-NBL](#) [7310](#) [73F-250-32](#) [73F-250-32-NL](#) [F14-10C](#) [F-1M](#) [751-250](#) [76650-5002](#) [76828-149](#)