

P	LTR	DESCRIPTION	DATE	DWN	APVD
	C3	REVISED PER ECO-14-003457	11MAR2014	NK	DR
	C4	REVISED PER ECO-17-007400	24NOV2017	RS	DR

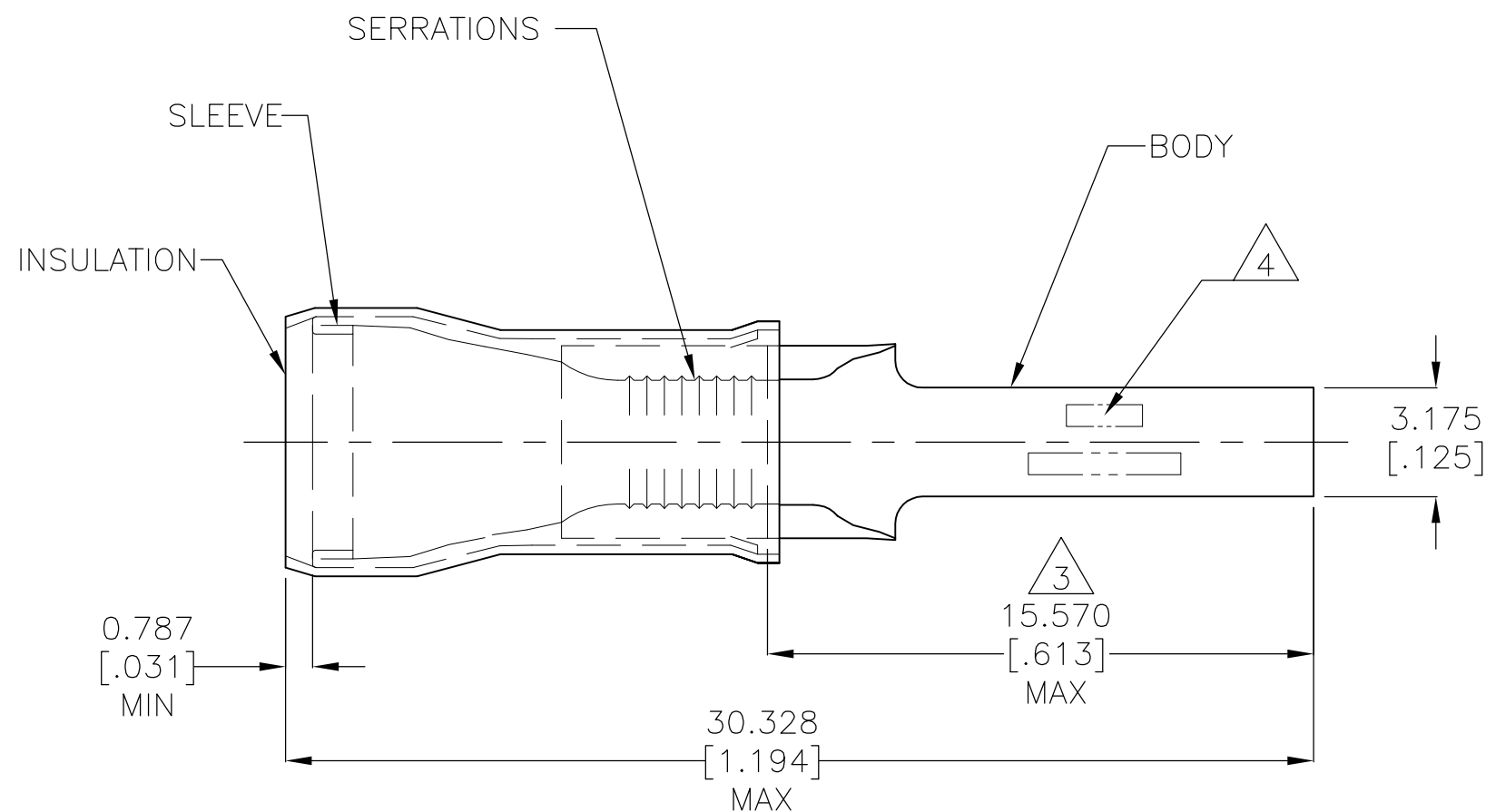

- 1 BODY MATERIAL THK IS 1.016±0.051[.040±.002]
- 2 WIRE INSULATION DIA RANGE IS FOR  $\phi 3.810[\phi.150]$  TO  $\phi 5.842[\phi.230]$
- 3 APPLIES FROM EDGE OF METAL WIRE BARREL TO END OF TAB
- 4 STAMP AMP 12-10\* APPROX AS SHOWN
- 5 MATERIAL:  
BODY & SLEEVE: COPPER PER ASTM B-152  
INSULATION: NYLON
- 6 FINISH:  
BODY & SLEEVE: TIN PLATED PER ASTM B-545  
INSULATION: COLOR-YELLOW

TAPE & REEL	2500	2-324543-1
LOOSE PIECE	500	324543
PACKAGE TYPE	QTY	PART NO

THIS DRAWING IS A CONTROLLED DOCUMENT.		DWN JR RUTH 22MAR07	<b>STE</b> TE Connectivity														
DIMENSIONS: mm [INCHES]		CHK T MICHELUTTI 22MAR07															
TOLERANCES UNLESS OTHERWISE SPECIFIED:		APVD T MICHELUTTI 22MAR07	NAME WIRE TERMINAL TAB, PIDG, WIRE SIZE: 12-10														
<table border="0"> <tr><td>0 PLC</td><td>± -</td></tr> <tr><td>1 PLC</td><td>± -</td></tr> <tr><td>2 PLC</td><td>± -</td></tr> <tr><td>3 PLC</td><td>± 0.127[.005]</td></tr> <tr><td>4 PLC</td><td>± -</td></tr> <tr><td>ANGLES</td><td>± 1°</td></tr> </table>		0 PLC	± -	1 PLC	± -	2 PLC	± -	3 PLC	± 0.127[.005]	4 PLC	± -	ANGLES	± 1°	PRODUCT SPEC -	APPLICATION SPEC 114-2157		
0 PLC	± -																
1 PLC	± -																
2 PLC	± -																
3 PLC	± 0.127[.005]																
4 PLC	± -																
ANGLES	± 1°																
MATERIAL 5		FINISH 6	SIZE A3	CAGE CODE 00779	DRAWING NO C-324543												
CUSTOMER DRAWING			RESTRICTED TO -	SCALE 5:1	SHEET 1 OF 1												
			REV C4														

## X-ON Electronics

Largest Supplier of Electrical and Electronic Components

*Click to view similar products for [Terminals](#) category:*

*Click to view products by [TE Connectivity](#) manufacturer:*

Other Similar products are found below :

[00-054007-01074-6](#) [00-054007-70206-1](#) [00-054007-70210-8](#) [00-054007-70217-7](#) [00-054007-70226-9](#) [00-054007-70228-3](#) [00-054007-70248-1](#) [00-054007-70256-6](#) [00-054007-70301-3](#) [00-054007-70316-7](#) [0-0320562-0](#) [00-054007-49560-4](#) [00-054007-70209-2](#) [00-054007-70225-2](#) [00-054007-70227-6](#) [00-054007-70231-3](#) [00-054007-70241-2](#) [00-054007-70242-9](#) [00-054007-70244-3](#) [00-054007-70246-7](#) [00-054007-70263-4](#) [00-054007-70288-7](#) [00-054007-70290-0](#) [00-054007-70300-6](#) [00-054007-70304-4](#) [01-2065-1-0216](#) [01-2900-1-04412](#) [00581P0075](#) [600TS-10](#) [60205-1](#) [604200-1](#) [605601-1](#) [60598-1-CUT-TAPE](#) [61314-6-C](#) [61810-3](#) [61-S](#) [61-SN](#) [626-0194](#) [62-NBM-A](#) [62-SN](#) [62-SP](#) [63-S](#) [640179-1](#) [M55155/059I03](#) [M55155/079C01](#) [M55155/099H02](#) [M55155/109H01](#) [M55155/109H02](#) [M55155/12XH05](#) [M55155/16XH02](#)