

THIS DRAWING IS UNPUBLISHED. RELEASED FOR PUBLICATION
 © COPYRIGHT - By - ALL RIGHTS RESERVED.

| REVISIONS | | | | | |
|-----------|-----|---------------------------|-----------|-----|------|
| P | LTR | DESCRIPTION | DATE | DWN | APVD |
| | K8 | REVISED PER ECR-17-000959 | 25FEB2017 | RS | DR |
| | K9 | REVISED PER ECO-17-008808 | 28FEB2018 | RS | DR |

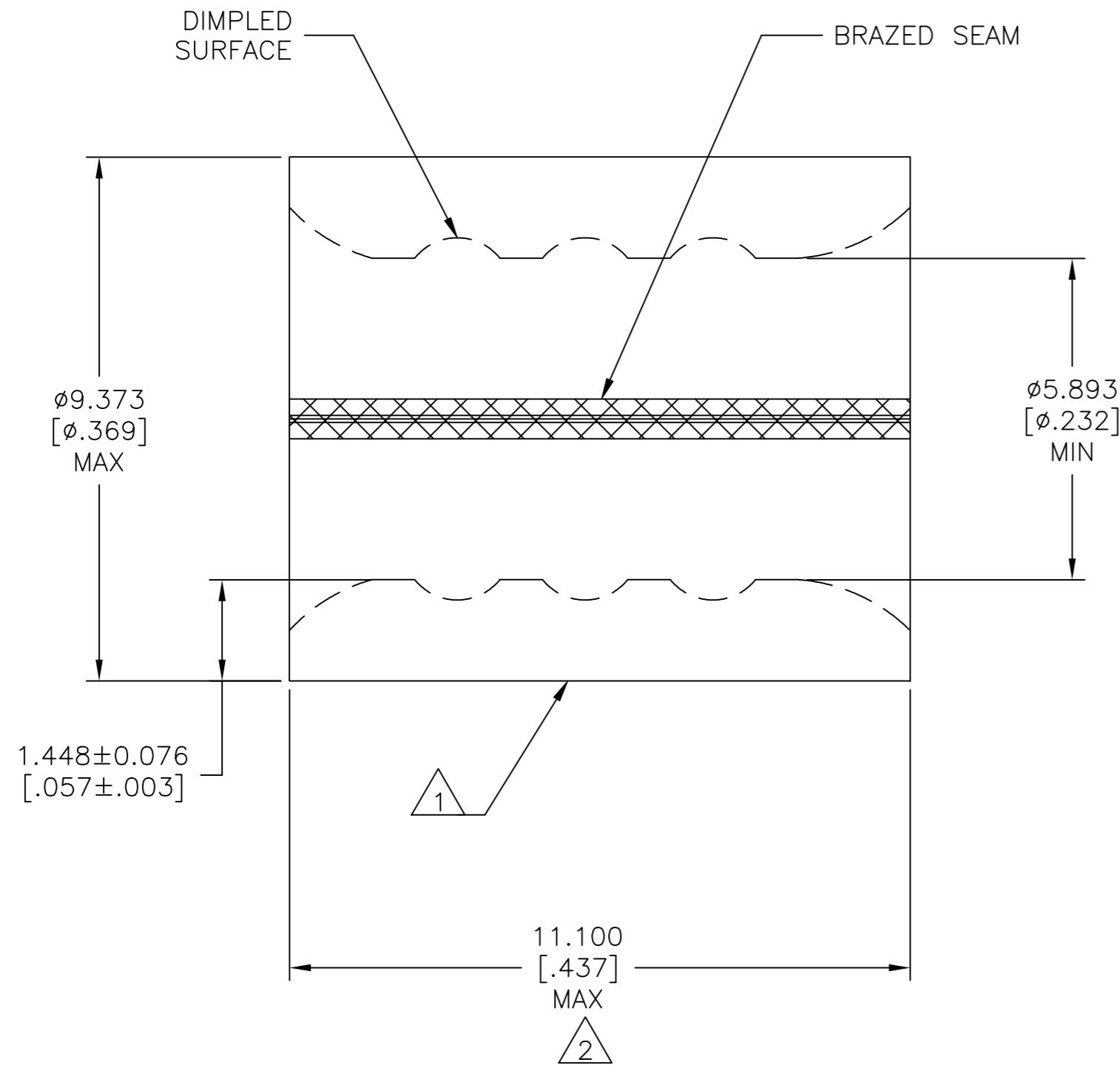
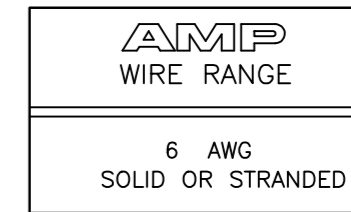

- 1 STAMP AMP 6W* APPROX AS SHOWN.
- 2 MAXIMUM LENGTH DOES NOT INCLUDE MANUFACTURING TABS.
- 3 MATERIAL: COPPER PER ASTM B-152 ANNEALED.
- 4 UL LISTED E13288, 6 AWG STRANDED.
- 5 CSA CERTIFIED LR7189, 6 AWG SOLID OR STRANDED.
- 6 0.00254 [.000100] MIN. EXT. THK. TIN PER ASTM B-545.
- 7 TIN/LEAD (60/40) 0.00254 [.000100] MIN. EXT. THK. TIN PER SAE-AMS-P-81728.
- 8 GOLD PLATE 0.00127[.000050] MIN. EXT. THK. PER ASTM B488, TYPE 1, CODE C OVER NICKEL PLATE 0.00127[.000050] MIN. EXT. THK. PER SAE AMS QQ-N-290 OVER Cu FLASH PER SAE AMS 2418.
- 9 NOTE DELETED.
- 10 NICKEL PLATE 0.00762[.000300] MIN. EXT. THK. PER SAE AMS QQ-N-290.

| PRELIMINARY | TEMP. | APPROVALS | QTY | FINISH | PACKAGE TYPE | PART NO. |
|-------------|--------------|-----------|-----|--------|--------------|----------|
| | 343°C[650°F] | --- | 500 | 10 | LOOSE PIECE | 34319-4 |
| | 260°C[500°F] | --- | 500 | 8 | LOOSE PIECE | 34319-3 |
| | 170°C[338°F] | --- | 100 | 7 | LOOSE PIECE | 34319-1 |
| | 170°C[338°F] | 4 5 | 500 | 6 | LOOSE PIECE | 34319 |

| | | |
|--|--|---|
| AMP INCORPORATED CUSTOMER SERVICE SYSTEMS | | MAX RECOMMENDED OPERATING TEMPERATURE: SEE TABLE |
| FOR ADDITIONAL PRODUCT INFORMATION OR COPIES OF DRAWINGS AND TECHNICAL DOCUMENTS | PRODUCT INFORMATION CENTER 1-800-522-6752 | VOLTAGE RATING: N/A |
| FOR APPLICATION TOOLING INFORMATION | TOOLING ASSISTANCE CENTER 1-800-722-1111 | CIRCULAR MIL AREA: 10.5-16.8mm²[20,800-33,100] SOLID OR STRANDED |
| FOR ORDER ENTRY | 1-800-526-5142 | THIS DRAWING IS A CONTROLLED DOCUMENT FOR AMP INCORPORATED. IT IS SUBJECT TO CHANGE AND THE CONTROLLING ENGINEERING ORGANIZATION SHOULD BE CONTACTED FOR THE LATEST REVISION. |

| | | | | |
|---|---------------------|---------------------------------|--|--------------------|
| THIS DRAWING IS A CONTROLLED DOCUMENT. | | DWN TA BRINKMAN 4-14-93 | TE Connectivity Ltd. | |
| DIMENSIONS: mm [INCHES] | | CHK DA PATTERSON 4-14-93 | NAME SPLICE, PARALLEL, SOLISTRAND 6 AWG | |
| TOLERANCES UNLESS OTHERWISE SPECIFIED: 0 PLC ± - 1 PLC ± - 2 PLC ± - 3 PLC ± 0.127[.005] 4 PLC ± - ANGLES ± - | | APVD DA PATTERSON 4-14-93 | PRODUCT SPEC UL 486 C | |
| MATERIAL 3 | FINISH SEE TABLE | WEIGHT - | SIZE A2 | CAGE CODE 00779 |
| CUSTOMER DRAWING | | DRAWING NO C=34319 | RESTRICTED TO - | SCALE 10:1 |
| | | SHEET 1 of 1 | REV K9 | |

X-ON Electronics

Largest Supplier of Electrical and Electronic Components

Click to view similar products for [Terminals](#) category:

Click to view products by [TE Connectivity](#) manufacturer:

Other Similar products are found below :

[HT-13-10](#) [71M-250-32-NB](#) [01-2065-1-0216](#) [00581P0075](#) [M10-10RX](#) [M10BCK](#) [60205-1](#) [604200-1](#) [60598-1-CUT-TAPE](#) [60617-1-C](#) [60873-1](#) [M14-516R/SK](#) [M14-6RSX](#) [M18-10FLX](#) [M18-8FBX](#) [M18-8R/LX](#) [M18BCK](#) [61314-6-C](#) [61-S](#) [61-SN-A](#) [62-NBM-A](#) [63-S](#) [640179-1](#) [640917-2-CUT-TAPE](#) [6501550002](#) [66107-2-C](#) [66107-4-C](#) [696683-1](#) [696834-1](#) [696861-1](#) [696931-1](#) [696999-1](#) [M8-516RK](#) [M86700006](#) [MA250DMFMX-A](#) [701-2007](#) [701-2307](#) [701-7761-03](#) [70F-110-32-PB](#) [718-N-A](#) [71M-187-20-NBL](#) [71M-250-32-NBL](#) [72F-187-20-NBL](#) [72M-250-32-NBL](#) [7310](#) [73F-250-32](#) [73F-250-32-NBL](#) [73F-250-32-NL](#) [F14-10C](#) [F-1M](#)