

METRIOR
DIMENSIONS LISTED IN MM [INCHES]

| | | | |
|--------------------|--|------------------------|--|
| WIRE RANGE | | E13288 Listed | |
| 12-10 AWG STRANDED | | 12-10 AWG STRANDED | |
| LR7189 Certified | | MILITARY P/N AND CLASS | |
| NOT CERTIFIED | | NOT APPLICABLE | |

△ STAMP AMP 12-10* APPROX AS SHOWN

| LOC | DIST | ZONE | LTN | REVISIONS | DATE | APPD |
|-----|------|------|-----|--------------------------|------|------|
| G | 14 | | A | REVISED PER 0720-0230-93 | | |

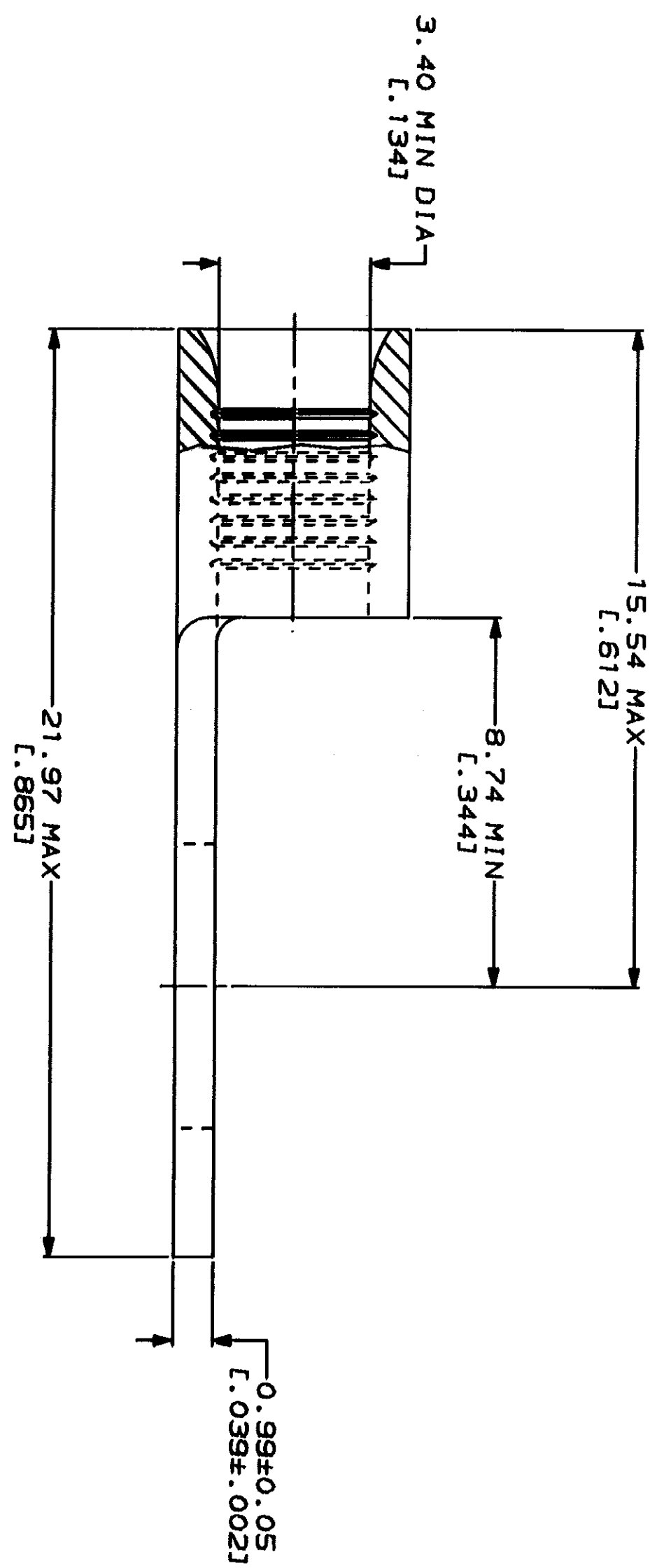

AMP INCORPORATED
CUSTOMER SERVICE SYSTEMS

FOR ADDITIONAL
PRODUCT INFORMATION OR
COPIES OF DRAWINGS
AND TECHNICAL DOCUMENTS

FOR APPLICATION
TOOLING INFORMATION

MAX RECOMMENDED OPERATING
TEMPERATURE:
170°C MAX

VOLTAGE RATING:
NOT APPLICABLE

WIRE CROSS SECTIONAL AREA RANGE:
2.62-6.64mm² [5,180-13,100] CIR MILS
STRANDED

DO NOT SCALE PRINT.
UNLESS SPECIFIED
DIMENSIONS IN MILLIMETERS
TOLERANCES ON:
2 PLG DEC ± .05
3 ANGLES ± .05

FINISH: TIN PLATE
0.00254 [L.000100] MIN
THK PER MIL-T-10727

DR 2-9-93
TA BRINKMAN
CHK 2-9-93
DA PATTERSON
APPD 2-9-93
DE MILLER
APPD 2-9-93
JL NECKLEY
PRODUCT SPEC

AMP Incorporated
Harrisburg, PA 17105-3608

TERMINAL, RING TONGUE,
BUDGET

SIZE: 00779
CAGE CODE: 00779
DRAWING NO: 34965
SCALE: 8:1

34965
PART NO

34965

CUSTOMER DRAWING

1 OF 1

X-ON Electronics

Largest Supplier of Electrical and Electronic Components

Click to view similar products for [Terminals](#) category:

Click to view products by [TE Connectivity](#) manufacturer:

Other Similar products are found below :

[00-054007-01074-6](#) [00-054007-70206-1](#) [00-054007-70210-8](#) [00-054007-70217-7](#) [00-054007-70226-9](#) [00-054007-70228-3](#) [00-054007-70248-1](#) [00-054007-70256-6](#) [00-054007-70301-3](#) [00-054007-70316-7](#) [00-054007-49560-4](#) [00-054007-70209-2](#) [00-054007-70225-2](#) [00-054007-70227-6](#) [00-054007-70231-3](#) [00-054007-70241-2](#) [00-054007-70242-9](#) [00-054007-70244-3](#) [00-054007-70246-7](#) [00-054007-70263-4](#) [00-054007-70288-7](#) [00-054007-70290-0](#) [00-054007-70300-6](#) [00-054007-70304-4](#) [01-2065-1-0216](#) [01-2900-1-04412](#) [00581P0075](#) [600TS-10](#) [60205-1](#) [604200-1](#) [605601-1](#) [60598-1-CUT-TAPE](#) [61314-6-C](#) [61810-3](#) [61-S](#) [61-SN](#) [626-0194](#) [62-NBM-A](#) [62-SN](#) [62-SP](#) [63-S](#) [640179-1](#) [M55155/059I03](#) [M55155/079C01](#) [M55155/099H02](#) [M55155/109H01](#) [M55155/109H02](#) [M55155/12XH05](#) [M55155/16XH02](#) [M55155/29-5S](#)