

© COPYRIGHT 1976 BY AMP INCORPORATED, HARRISBURG, PA.  
 ALL INTERNATIONAL RIGHTS RESERVED. AMP INCORPORATED PRODUCTS  
 COVERED BY U. S. AND FOREIGN PATENTS AND/OR PATENTS PENDING.

		REVISIONS				
P	F	ZONE	LTR	DESCRIPTION	DATE	APPROVED
✓	✓		F	REDRAWN & UPDATED M-6457	6-5-81	MSF/SJH
✓			G	REVISED AG 57	10/21/83	S.P. Riddle
✓			G1	RESTORATION	4-23-85	SJ 10/8
✓			H	OBSOLETE -7 PER CM-1372	7-5-88	PH RS
✓			J	REV PER EC 0730-3607-91	1-6-94	RV RS
			K	REV PER EC 0130-0020-96	8-1-96	JH RS

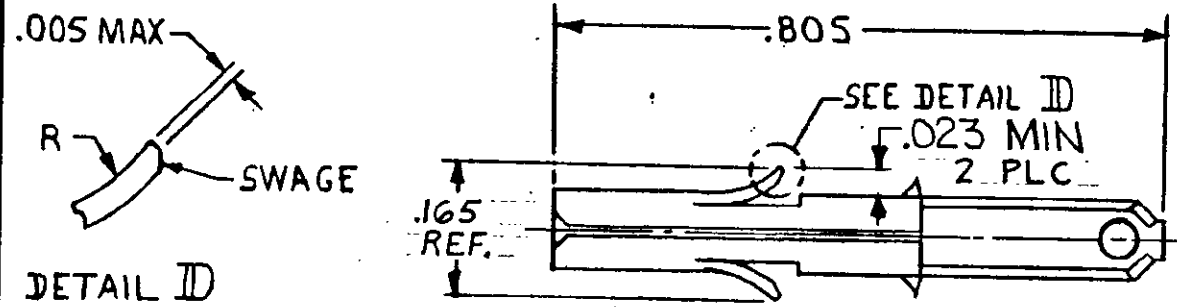

DETAIL ID

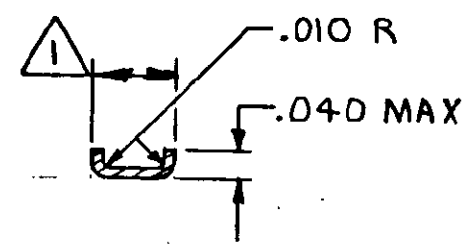
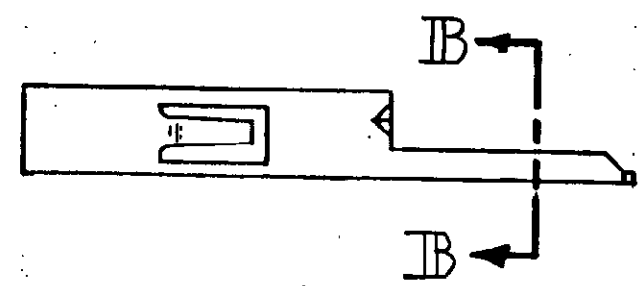
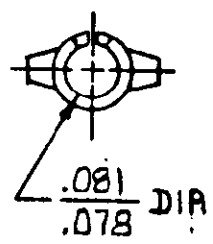

SECTION B-B

⚠ FITS INTO "110" SERIES FASTON RECEPTACLE 350871-1.

PRE-TIN	.012 BRASS	350877-1
FINISH	MATERIAL	PART NO

UNLESS OTHERWISE SPECIFIED DIMENSIONS ARE IN INCHES. TOLERANCES ON: DECIMALS ±.015 ANGLES ±	CONTRACT NO	<b>AMP</b>   AMP INCORPORATED Harrisburg, Pa.	
	DR <i>m. Feher 4-20-81</i>		
WIRE RANGE	CHK <i>D.S. Heide 6/10/81</i>	NAME SOCKET, SPECIAL, UNIVERSAL MATE-N-LOK™	
	APPD <i>R. Polshuk 6-10-81</i>	SIZE <b>B</b>	CODE IDENT NO <b>00779</b>
INSULATION RANGE	DSGN APPD	DRAWING NO <b>350877</b>	
	OTHER APPD	SCALE 4-1	SHEET

## X-ON Electronics

Largest Supplier of Electrical and Electronic Components

*Click to view similar products for [Pin & Socket Connectors](#) category:*

*Click to view products by [TE Connectivity](#) manufacturer:*

Other Similar products are found below :

[6450822-1](#) [770392-1](#) [794042-1](#) [796885-1](#) [8-794535-1](#) [881459-2](#) [R929993003](#) [1-350779-3](#) [1403611-1](#) [1-480349-5](#) [1586092-1](#) [1586129-1](#)  
[1586487-1](#) [1586681-4](#) [1586700-1](#) [1586065-1](#) [1586077-1](#) [1586368-1](#) [1586380-1](#) [1586680-5](#) [1586681-2](#) [1604996-1](#) [16-06-0038](#) [164164-5](#) [1-](#)  
[6609930-1](#) [172296-1](#) [1-794714-6](#) [19-09-2035](#) [1969804-1](#) [200503-1](#) [200788-2](#) [201046-7](#) [202648-4](#) [2029076-2](#) [2029090-4](#) [2029095-4](#) [2-](#)  
[66102-6](#) [925061-7](#) [926681-1](#) [293734-4](#) [293737-2](#) [1-765362-4](#) [1-794606-3](#) [1871534-1](#) [1969795-1](#) [1969798-1](#) [1969800-1](#) [200833-4](#)  
[2008625-2](#) [2029027-2](#)